

# Accessories for Genelec monitors



Classic studio monitors



The Ones and other coaxial SAM™ monitors



Classic and SAM™ series studio subwoofers



SAM™ master studio monitors

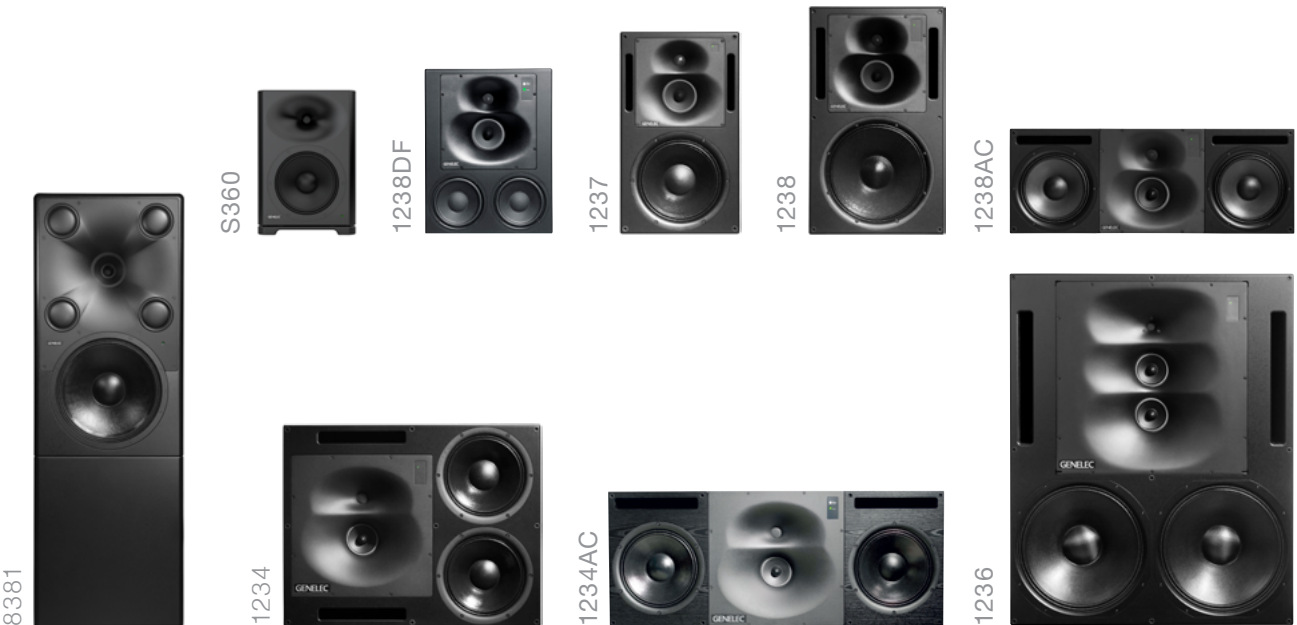

## Contents

8010, 4010 & G One .....	5
8020, 8320, 4020 & G Two .....	13
8030, 8330, 4030 & G Three .....	21
8040, 8340, 4040 & G Four .....	31
8050, 8350 & G Five.....	41
8331, 8341, 8351, 8361 .....	51
S360 .....	67
Other .....	71
Drawings and measurements monitor models .....	76







## ACCESSORIES FOR GENELEC MONITORS

8010

4010

4410

G One

# Table stands

## Short table stand

Short table stand providing a raised position for near-field monitors. Suitable for XX10, XX20, XX30 and XX40. Heavy black cast iron base with anti-vibration rubber ring, diameter 17 mm. Mounting 3/8" thread on the tube top. Preferably used together with stand plates for better positioning. The 8020 and 8030 models have an integrated 3/8" thread for possible direct fixing without stand plate. The XX40 model must be installed with a stand plate. Not to be used with 8331, 8341, 8351 or 8361.

**8000-406** Short table stand (17 cm) (K&M 23310-370-55)

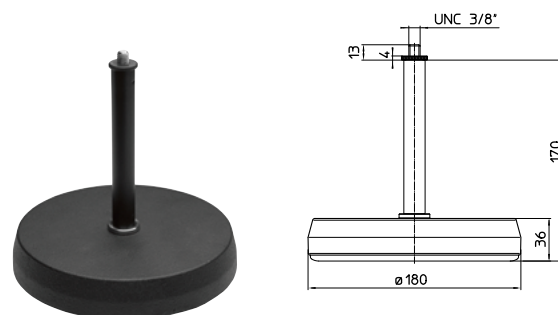

8000-406

### Associated products



8010-408, 8010-438W

8000-406 with stand plate.



## Adjustable height table stand

Adjustable height table stand for XX10, XX20 and XX30 with a base plate that can be attached to a table or flat surface. Preferably used with stand plate and Iso-Pod for better monitor orientation (see picture below). The telescopic tube length (301 to 527 mm) is designed for optimum monitor positioning behind or above computer screens. Screws and fixing nuts for a 40 mm thick table are included.

**8000-425B** Adjustable height table stand (301-527 mm) (K&M 23360-300-55)

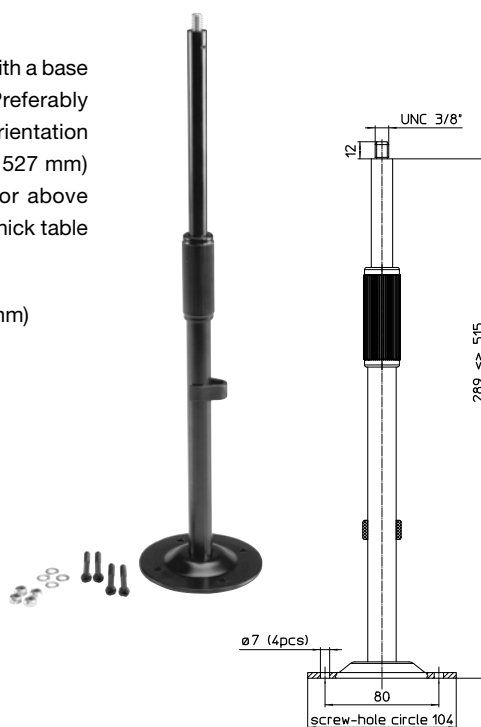

Speaker fitted on 8000-425B with stand plate.

### Associated products



8010-408, 8010-438W



## L-shape table stands

With these stands it is easy to position the speaker on a table with better aiming to the listening position, causing less reflections from the table surface. All stands have 0-20 degree tilt angle adjustment upwards.

For XX10 and XX20 sizes vertical mounting. For 8X3X, 8X4X and 8X5X sizes vertical and also horizontal mounting is possible.

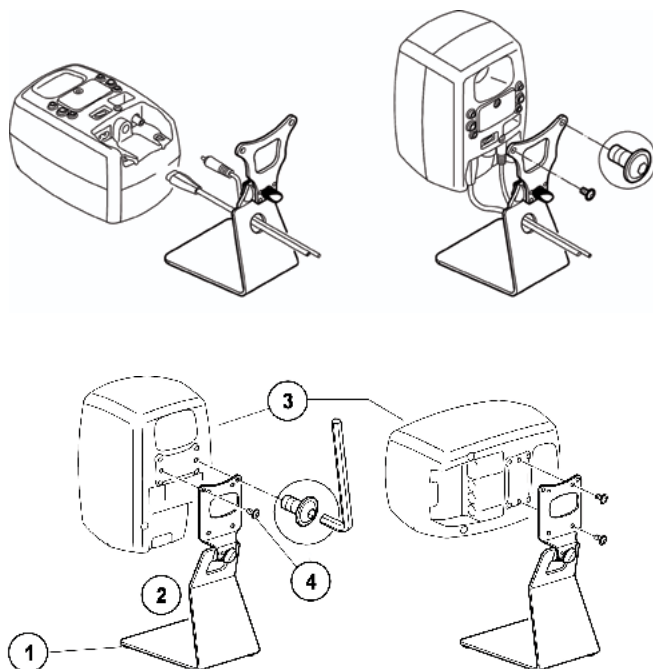

L-shape stand 8010-320W and 8010



L-shape stand 8000-333B and 8331



L-shape stand 8000-325W and 8341



L-shape stand 8000-325B and 8351

## Table stand L-shape for 8010, G One, 4010 and 4410

Design L-shape table stand with adjustable tilt angle up. Available in black and white powder coat finish.

**8010-320B** Table stand L-shape for 8010, black (K&M 23271-000-56)

**8010-330W** Table stand L-shape for 8010, white (K&M 23271-000-66)



8010-320B

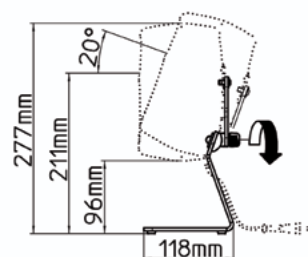
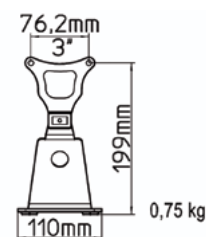

# Floor stands

## Floor stand

Floor stand for XX10, XX20 and XX30, preferably used together with stand plates. Cast iron base with anti-vibration rubber ring. Weight: 5.4 kg. Height: 870 to 1565 mm. Base diameter: 250 mm. Packing: single cardboard box. Suitable for all models between 8010 – 8330. Not to be used with 8331.

**8000-403** Floor stand (mic stand) (K&M 26000-329-55)

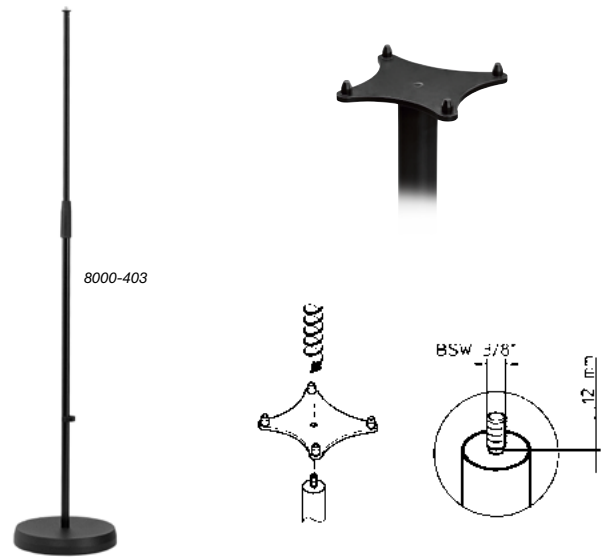

# Stand plates

## Stand plate for 8010

Genelec stand plates are designed for use together with the Iso-Pod that comes with 8010-8050, and 8331-8361 monitors. The Iso-Pod allows you to tilt the monitor for optimal alignment. Simply mount the stand plate onto the 3/8" thread on the tube and ensure tight screw connection. Place the Iso-Pod over the four pins of the stand plate.

**8010-408** Stand plate for 8010 Iso-Pod, black (K&M 19621-329-55)  
**8010-438W** Stand plate for 8010 Iso-Pod, white (K&M 19621-329-66)

	8010
A	93
B	88
C	77
D	66
E	72
F	ø7,5
G	207

(mm)

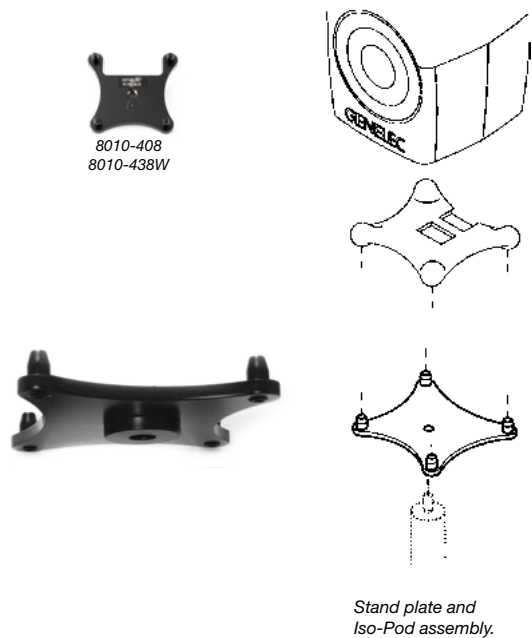
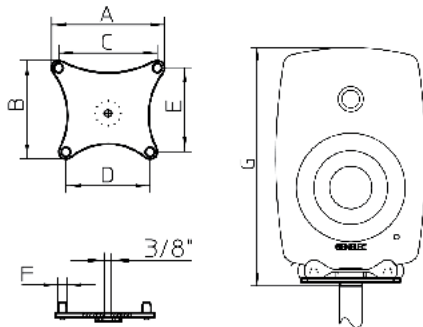



# Ceiling mounts

## Short ceiling mount

Short and versatile ceiling mount, with a ball joint enabling 360 degree rotation and maximum 90 degree tilt, depending on the loud-speaker model and mounting. Suitable for XX10 and XX20 sizes. Available in black and white powder coat finish.

**8000-202B** Short ceiling mount ball joint, black (K&M 24476-000-55)

**8000-202W** Short ceiling mount ball joint, white (K&M 24476-000-57)

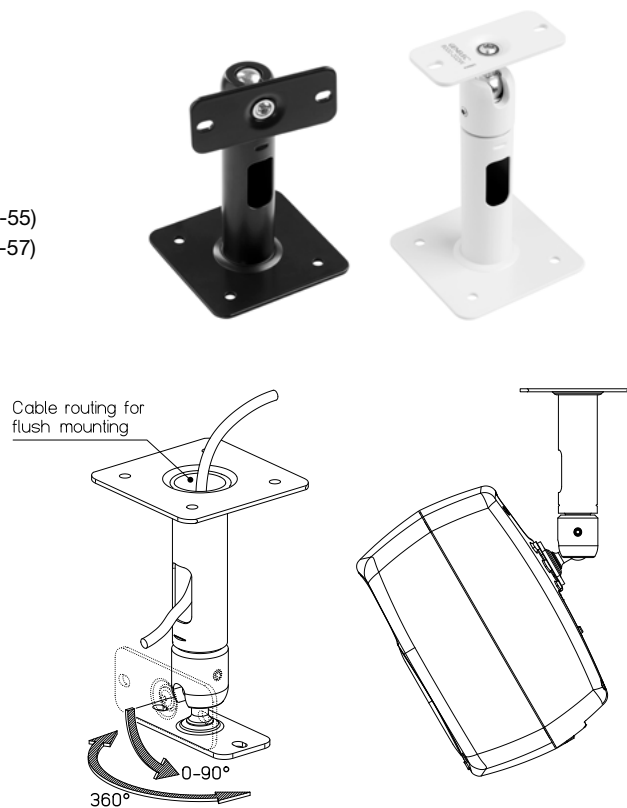
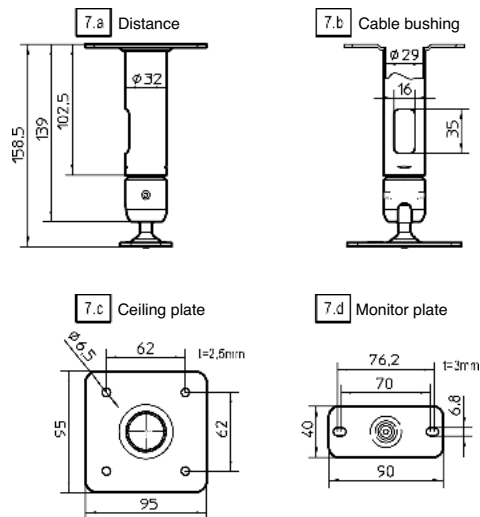

## Short truss mount

Short truss mount with clamp for  $\phi 50$  mm tube. Adaptable for 8000 and 4000 series.

**8000-416C** Short truss mount with clamp (K&M 24493-000-55)

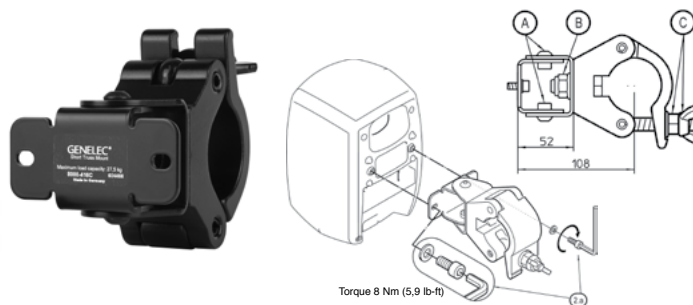

# Wall mounts

## Fixed wall mount

Wall mount bracket for 4010. Tilttable 30°. Available in black and white. Included with each 4010.

- 8010-410B** Wall mount bracket, black (Genelec)  
**8010-410W** Wall mount bracket, white (Genelec)



## Fixed wall mount

Wall mount for 8020 and 8030/8130. Available in black and white. Included with each 8020.

- 4000-410B** Wall mount (simple bracket), black (Genelec)  
**4000-410W** Wall mount (simple bracket), white (Genelec)

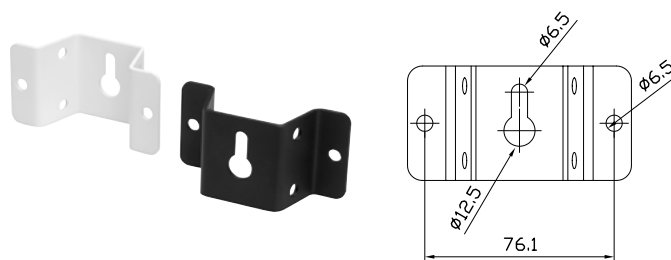

## Short wall mount

Short and versatile wall mount, with a ball joint enabling 360 degree rotation and maximum 90 degree tilt, depending on the loudspeaker model and mounting. Suitable for XX10 and XX20 sizes. Available in black and white powder coat finish.

- 8000-420CB** Short wall mount, black (K&M 24469-019-55)  
**8000-420CW** Short wall mount, white (K&M 24469-019-57)

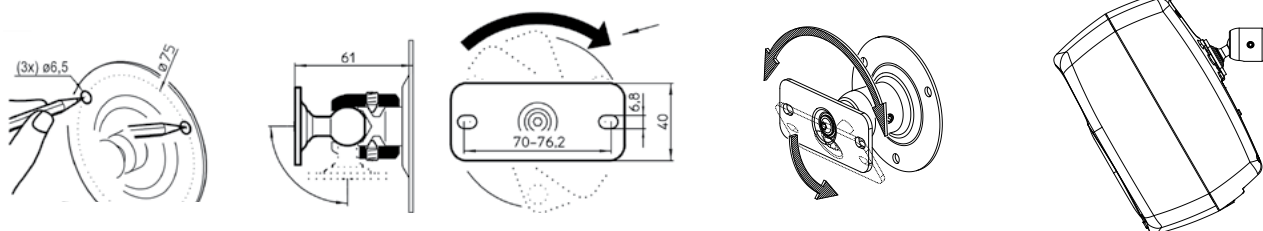



## VESA-adapter for 8000-series

Today many broadcast environments and post-production studios have changed the way of installing video monitors. Instead of using 19" rack systems such LCD / Plasma screens are now placed in so-called flat "media walls". All of them feature the international mechanical mounting system called VESA standard.

We all know pictures need to be completed with sound, and therefore we have made a simple adapter fitting Genelec 8010-8050 and 8331-8351 speakers. With this small adapter one can mount 8000 series monitors into any kind of VESA 75/100 based accessories.

**8000-437B** VESA adapter 75/100 mm (K&M 24483-015-55)

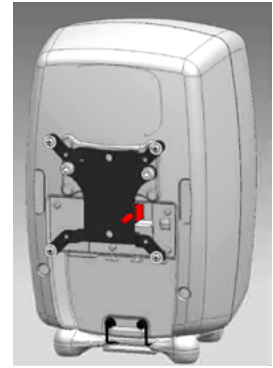
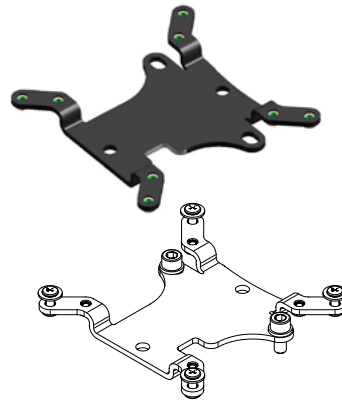

# Carrying accessories

## Bags for Genelec loudspeakers

Soft transportation bags for Genelec loudspeakers.

**8010-424** Soft carrying bag for two pcs XX10 or G One (Genelec)



## ACCESSORIES FOR GENELEC MONITORS

8020

8320

4020

4420

G Two

# Table stands

## Short table stand

Short table stand providing a raised position for near-field monitors. Suitable for XX10, XX20, XX30 and XX40. Heavy black cast iron base with anti-vibration rubber ring, diameter 17 mm. Mounting 3/8" thread on the tube top. Preferably used together with stand plates for better positioning. The 8020 and 8030 models have an integrated 3/8" thread for possible direct fixing without stand plate. The XX40 model must be installed with a stand plate. Not to be used with 8331, 8341, 8351 or 8361.

**8000-406** Short table stand (17 cm) (K&M 23310-370-55)

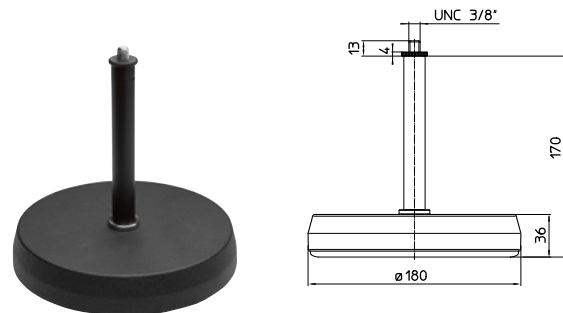

8000-406

### Associated products



8020-408, 8020-438W

8000-406 with stand plate.



## Adjustable height table stand

Adjustable height table stand for XX10, XX20 and XX30 with a base plate that can be attached to a table or flat surface. Preferably used with stand plate and Iso-Pod for better monitor orientation (see picture below). The telescopic tube length (301 to 527 mm) is designed for optimum monitor positioning behind or above computer screens. Screws and fixing nuts for a 40 mm thick table are included.

**8000-425B** Adjustable height table stand (301-527 mm) (K&M 23360-300-55)

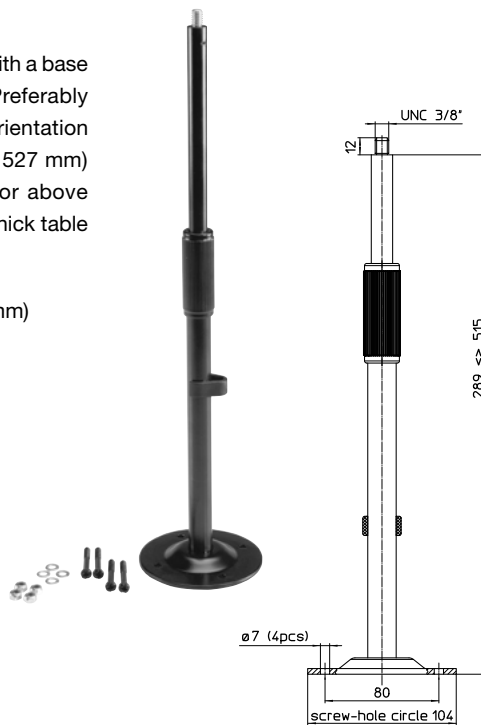

Speaker fitted on 8000-425B with stand plate.

### Associated products



8020-408, 8020-438W



## L-shape table stands

With these stands it is easy to position the speaker on a table with better aiming to the listening position, causing less reflections from the table surface. All stands have 0-20 degree tilt angle adjustment upwards.

For XX10 and XX20 sizes vertical mounting. For 8X3X, 8X4X and 8X5X sizes vertical and also horizontal mounting is possible.

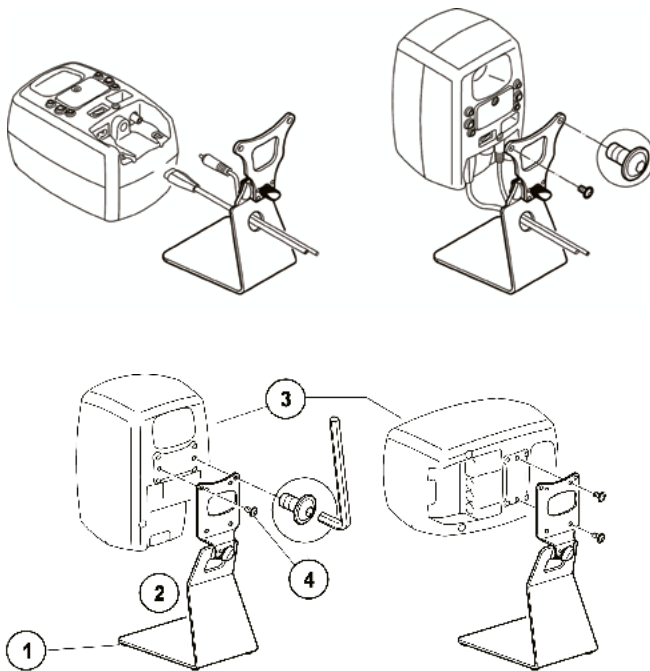

L-shape stand 8010-320W  
and 8010



L-shape stand 8000-325W  
and 8341



L-shape stand 8000-333B  
and 8331



L-shape stand 8000-325B  
and 8351

## Table stand L-shape for 8020

Design L-shape table stand for 8X2X, with adjustable tilt angle up.  
Available in black and white powder coat finish.

**8020-320B** Table stand L-shape for 8020, black  
(K&M 23274-015-56)

**8020-330W** Table stand L-shape for 8020, white  
(K&M 23274-015-66)



8020-320B

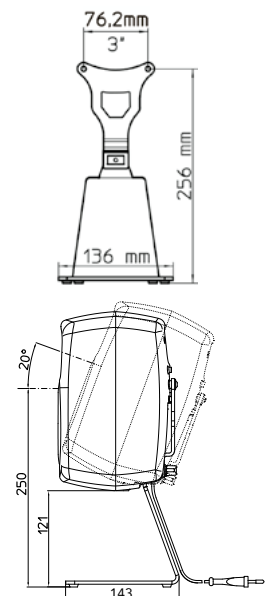

# Floor stands

## Floor stand

Floor stand for XX10, XX20 and XX30, preferably used together with stand plates. Cast iron base with anti-vibration rubber ring. Weight: 5.4 kg. Height: 870 to 1565 mm. Base diameter: 250 mm. Packing: single cardboard box. Suitable for all models between 8010 – 8330. Not to be used with 8331.

**8000-403** Floor stand (mic stand) (K&M 26000-329-55)

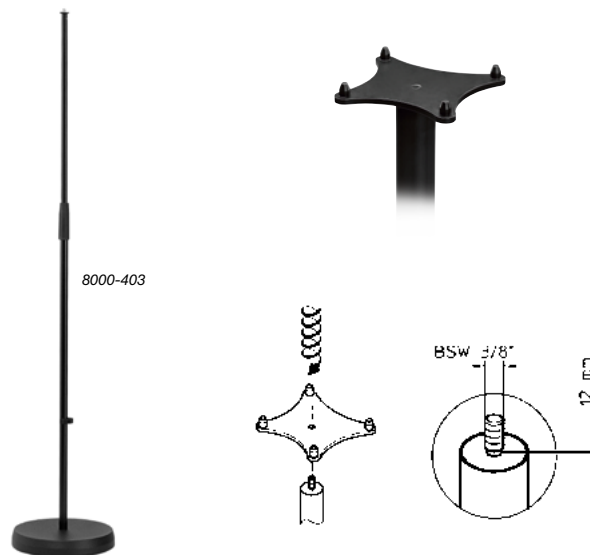

# Stand plates

## Stand plate for 8020

Genelec stand plates are designed for use together with the Iso-Pod that comes with all 8000 series monitors. The Iso-Pod allows you to tilt the monitor for optimal alignment. Simply mount the stand plate onto the 3/8" thread on the tube and ensure tight screw connection. Place the Iso-Pod over the four pins of the stand plate.

**8020-408** Stand plate for 8020 Iso-Pod, black (K&M 19622-329-55)

**8020-438W** Stand plate for 8020 Iso-Pod, white (K&M 19622-329-66)

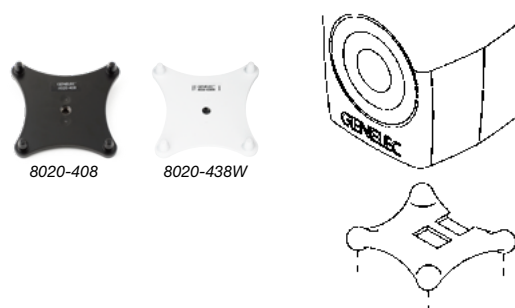

8020	
A	114
B	108
C	96
D	82
E	90
F	ø 10
G	254
(mm)	

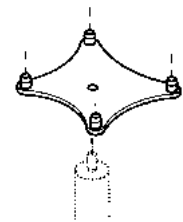
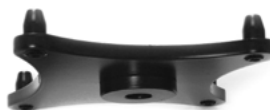
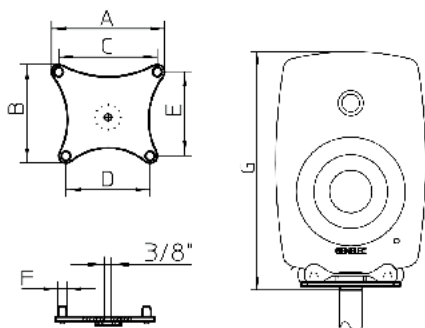

Stand plate and Iso-Pod assembly.

# Ceiling mounts

## Short ceiling mount

Short and versatile ceiling mount, with a ball joint enabling 360 degree rotation and maximum 90 degree tilt, depending on the loud-speaker model and mounting. Suitable for XX10 and XX20 sizes. Available in black and white powder coat finish.

- 8000-202B** Short ceiling mount ball joint, black (K&M 24476-000-55)  
**8000-202W** Short ceiling mount ball joint, white (K&M 24476-000-57)

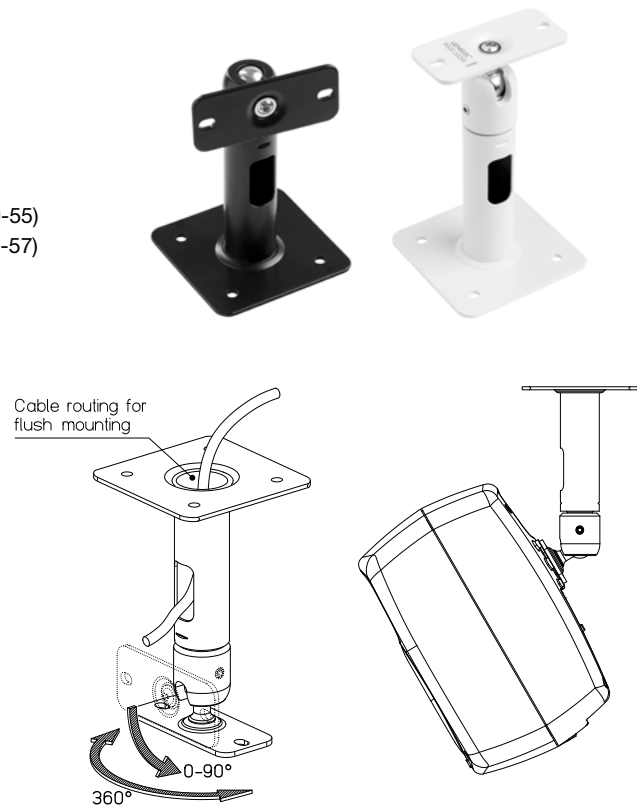
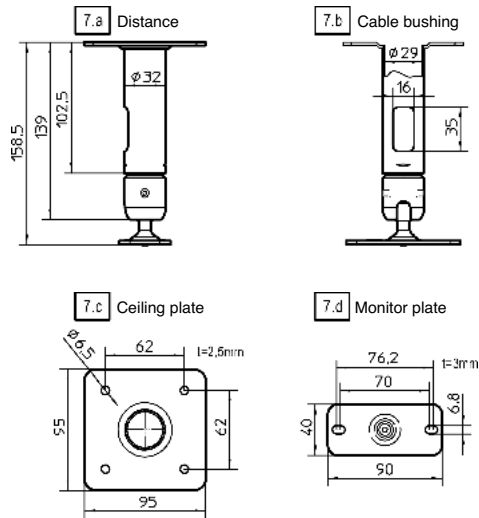

## Short truss mount

Short truss mount with clamp for  $\phi 50$  mm tube. Adaptable for 8000 and 4000 series.

- 8000-416C** Short truss mount with clamp (K&M 24493-000-55)

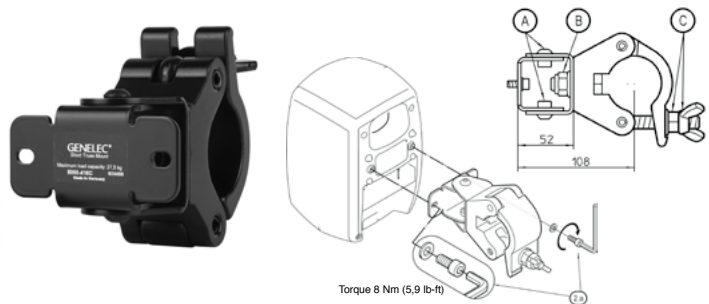

## T-adapter plate

T-adapter plate for Genelec 8320 and 8330.

- 8000-454B** T-adapter plate (K&M 24452-000-55)

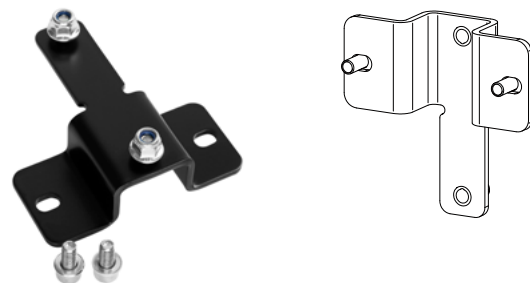

# Wall mounts

## Fixed wall mount

Wall mount for 8020 and 8030/8130. Available in black and white. Included with each 8020.

- 4000-410B** Wall mount (simple bracket), black (Genelec)
- 4000-410W** Wall mount (simple bracket), white (Genelec)

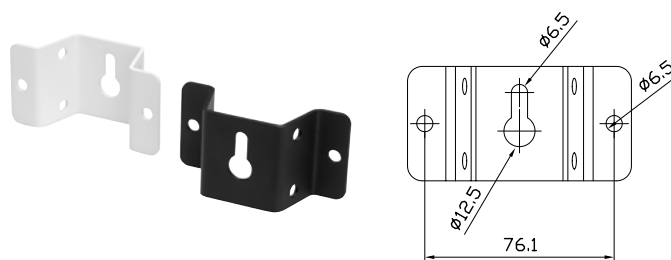

## Short wall mount

Short and versatile wall mount, with a ball joint enabling 360 degree rotation and maximum 90 degree tilt, depending on the loudspeaker model and mounting. Suitable for XX10 and XX20 sizes. Available in black and white powder coat finish.

- 8000-420CB** Short wall mount, black (K&M 24469-019-55)
- 8000-420CW** Short wall mount, white (K&M 24469-019-57)

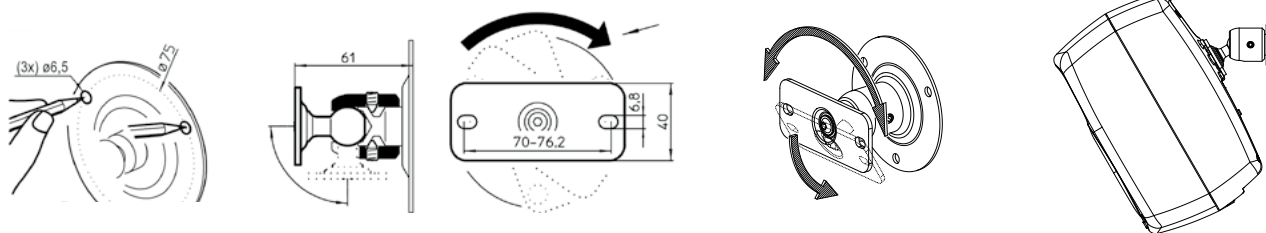

## Adjustable wall mount with T-plate

Wall mount bracket for 8010, 8020 and 8030. Available in black and white.

- 8000-422B** Wall mount with T-plate, black (K&M 24160-000-56)
- 8000-422W** Wall mount with T-plate, white (K&M 24160-000-66)

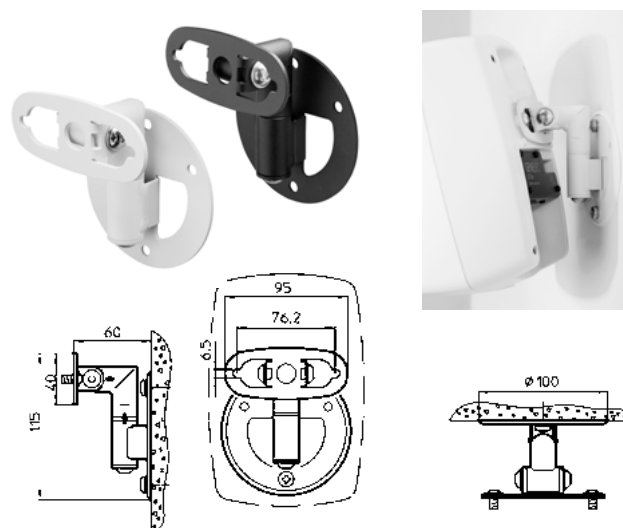



## VESA-adapter for 8000-series

Today many broadcast environments and post-production studios have changed the way of installing video monitors. Instead of using 19" rack systems such LCD / Plasma screens are now placed in so-called flat "media walls". All of them feature the international mechanical mounting system called VESA standard.

We all know pictures need to be completed with sound, and therefore we have made a simple adapter fitting Genelec 8010-8050 and 8331-8351 speakers. With this small adapter one can mount 8000 series monitors into any kind of VESA 75/100 based accessories.

**8000-437B** VESA adapter 75/100 mm (K&M 24483-015-55)

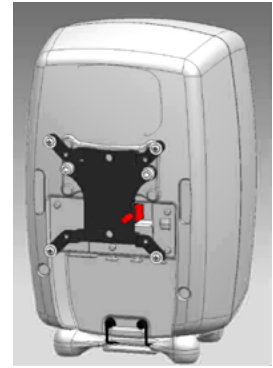
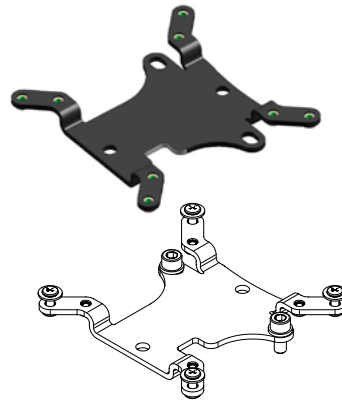

8020  
8320  
4020  
4420  
G Two

# Carrying accessories

## Bags for Genelec loudspeakers

Soft transportation bags for Genelec loudspeakers.

**8020-423** Soft carrying bag for two pcs XX20 or G Two (Genelec)



## ACCESSORIES FOR GENELEC MONITORS

8030

8330

4030

4430

G Three

# Table stands

## Short table stand

Short table stand providing a raised position for near-field monitors. Suitable for XX10, XX20, XX30 and XX40. Heavy black cast iron base with anti-vibration rubber ring, diameter 17 mm. Mounting 3/8" thread on the tube top. Preferably used together with stand plates for better positioning. The 8020 and 8030 models have an integrated 3/8" thread for possible direct fixing without stand plate. The XX40 model must be installed with a stand plate. Not to be used with 8331, 8341, 8351 or 8361.

**8000-406** Short table stand (17 cm) (K&M 23310-370-55)

### Associated products



8030-408, 8030-438W

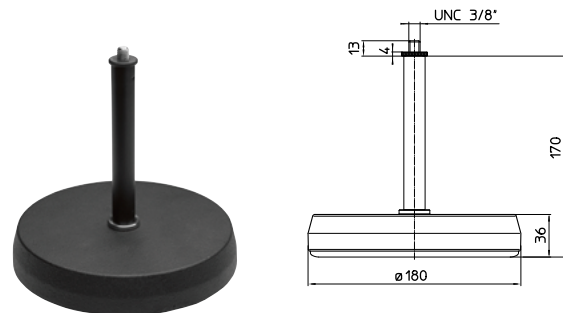

8000-406

8000-406 with stand plate.



## Adjustable height table stand

Adjustable height table stand for XX10, XX20 and XX30 with a base plate that can be attached to a table or flat surface. Preferably used with stand plate and Iso-Pod for better monitor orientation (see picture below). The telescopic tube length (301 to 527 mm) is designed for optimum monitor positioning behind or above computer screens. Screws and fixing nuts for a 40 mm thick table are included.

**8000-425B** Adjustable height table stand (301-527 mm) (K&M 23360-300-55)

### Associated products



8030-408, 8030-438W

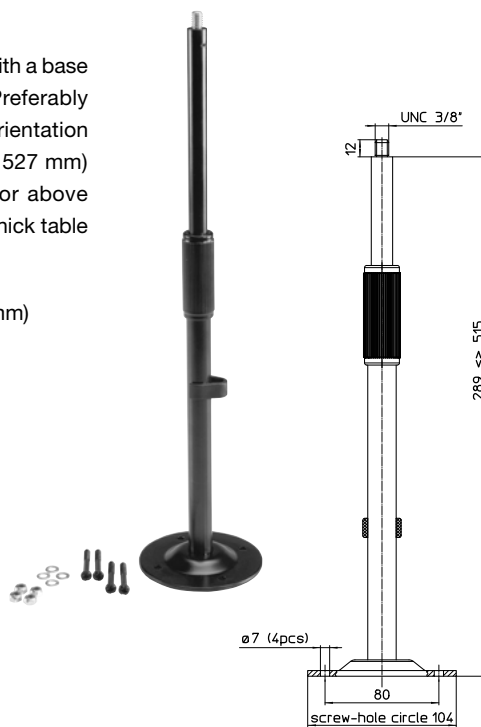

Speaker fitted on 8000-425B with stand plate.





## L-shape table stands

With these stands it is easy to position the speaker on a table with better aiming to the listening position, causing less reflections from the table surface. All stands have 0-20 degree tilt angle adjustment upwards.

For XX10 and XX20 sizes vertical mounting. For 8X3X, 8X4X and 8X5X sizes vertical and also horizontal mounting is possible.

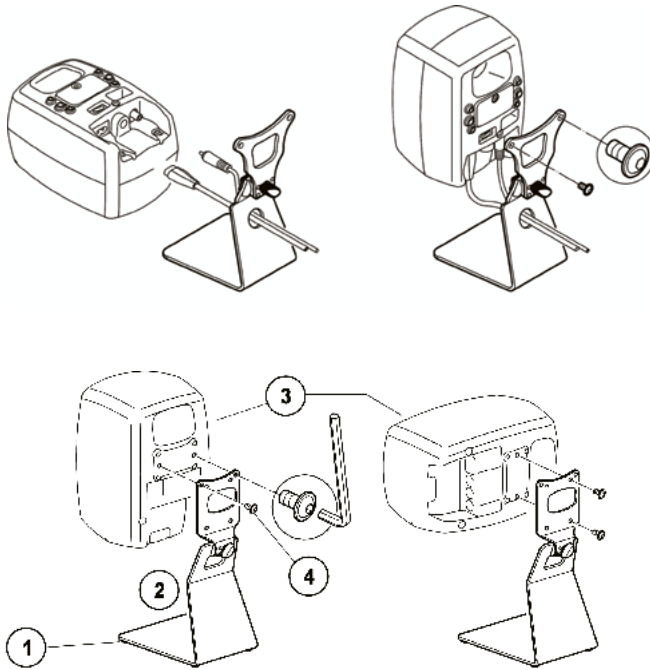

*L-shape stand 8010-320W and 8010*



*L-shape stand 8000-333B and 8331*



*L-shape stand 8000-325W and 8341*



*L-shape stand 8000-325B and 8351*

8030  
8330  
4430  
G Three

## Table stand L-shape for 8X3X

Design L-shape table stand for 8X3X, with adjustable tilt angle up. Available in black and white powder coat finish.

- 8000-333B** Table stand L-shape for 8X3X, black (K&M 23275-022-56)
- 8020-333W** Table stand L-shape for 8X3X, white (K&M 23275-022-66)

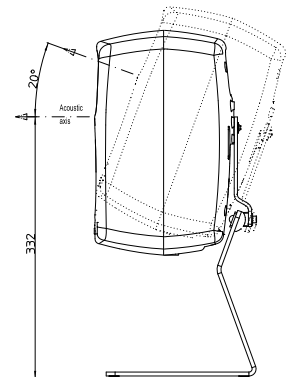

# Floor stands

## Design floor stand

After a long development journey together with K&M, we can finally offer the “Genelec designed floor stand” for the 8000 Series loudspeakers. Harri Koskinen, industrial designer and partner in the design of the 8000 Series loudspeaker made the first drawings several years ago.

This very stable and elegant steel stand has a 420 x 420 mm cast base with an oversized rod combination. Gradual height adjustment is made by a superior positioning and clamping knob. Quick, uncomplicated mounting of the monitor is accomplished using the suspension device. This floor stand is mainly designed for 8040, 8340, 8341, 8350 and 8351. Weight: 13.4 kg, Height: variable between 1100/1700 mm.

**8000-400** Genelec Design stand (K&M 26785-018-56)



## Floor stand

Stable steel stand with a broad round cast iron base. Base diameter 450 mm. Adjustable height using clamping screw and safety pin. Mounting 3/8" thread for any Genelec stand plates, from 8020 to 8050 model. Load capacity: 35 kg. Weight: 10.6 kg. Height: 950 to 1430 mm. Packing: double cardboard packing; iron base in one and stand in the second. Suitable for all models between 8010 – 8351.

**8000-409B** Floor stand (950-1430 mm) for 1032 (K&M 26741-129-55)

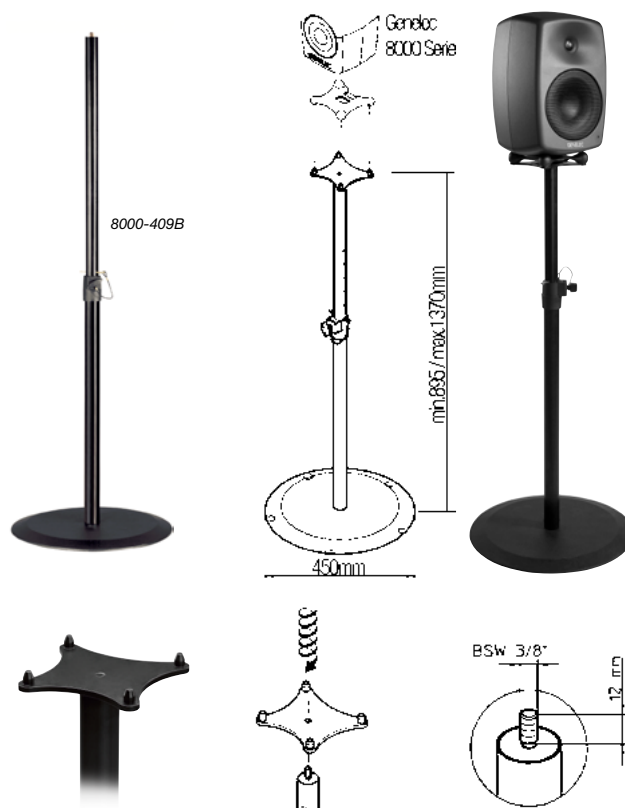

## Associated products



8030-408, 8030-438W

# Stand plates

## Stand plate for 8X30, 8331

Genelec stand plates are designed for use together with the Iso-Pod that comes with all 8000 series monitors. The Iso-Pod allows you to tilt the monitor for optimal alignment. Simply mount the stand plate onto the 3/8" thread on the tube and ensure tight screw connection. Place the Iso-Pod over the four pins of the stand plate.

**8030-408B** Stand plate for 8X30, 8331 Iso-Pod, black (K&M 19623-329-55)

**8030-438W** Stand plate for 8X30, 8331 Iso-Pod, white (K&M 19623-329-66)

	8030
A	126
B	110
C	108
D	93
E	92
F	ø10
G	311
(mm)	

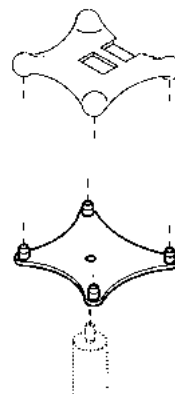
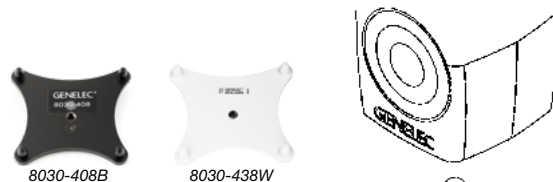
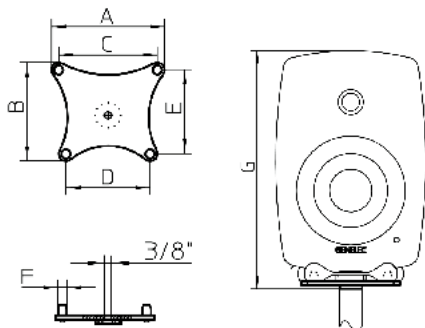

Stand plate and Iso-Pod assembly.

8030  
8330  
4430  
G Three

# Ceiling mounts

## Short ceiling mount

For all 8000 series models. Available in black and white.

**8000-436B** Short ceiling mount, black (K&M 24486-000-55)

**8000-436W** Short ceiling mount, white (K&M 24486-000-57)

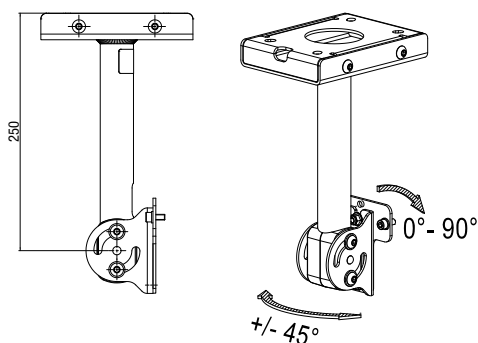

### Associated product

Needed for mounting of 8X20, 8X30, 4X20, 4X30, G Two & G Three only.

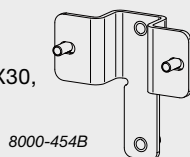

8000-454B

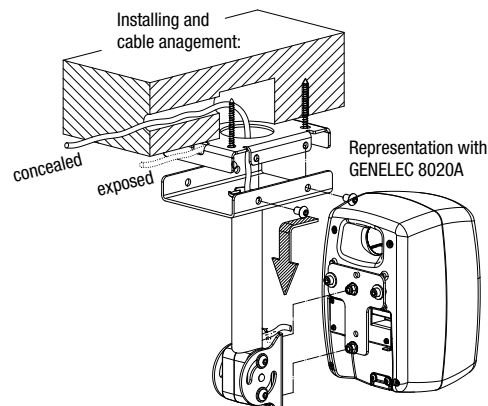

## Short adjustable ceiling mount

Adjustable ceiling mount for all 8000 series models, possible to down tilt up to 90 degrees. The tube have openings in each end, possible to have cables in the 50 mm tube. Available in black and white.

**8000-442B** Short adjustable ceiling mount, black  
(K&M 24491-000-55)

**8000-442W** Short adjustable ceiling mount, white  
(K&M 24491-000-57)

### Associated product

Needed for mounting of 8X20, 8X30,  
4X20, 4X30, G Two & G Three only.

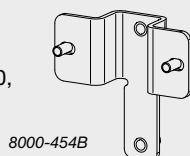

8000-454B

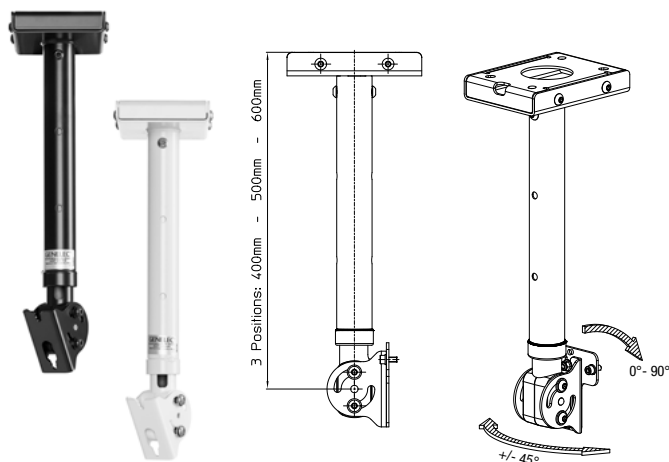

## Long adjustable ceiling mount

Adjustable ceiling mount for all 8000 series models, possible to down tilt up to 90 degrees. The tube have openings in each end, possible to have cables in the 50 mm tube. Available in black and white.

**8000-444B** Long adjustable ceiling mount, black  
(K&M 24494-000-55)

**8000-444W** Long adjustable ceiling mount, white  
(K&M 24494-000-57)

### Associated product

Needed for mounting of 8X20, 8X30,  
4X20, 4X30, G Two & G Three only.

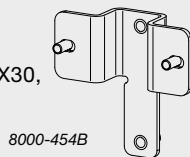

8000-454B

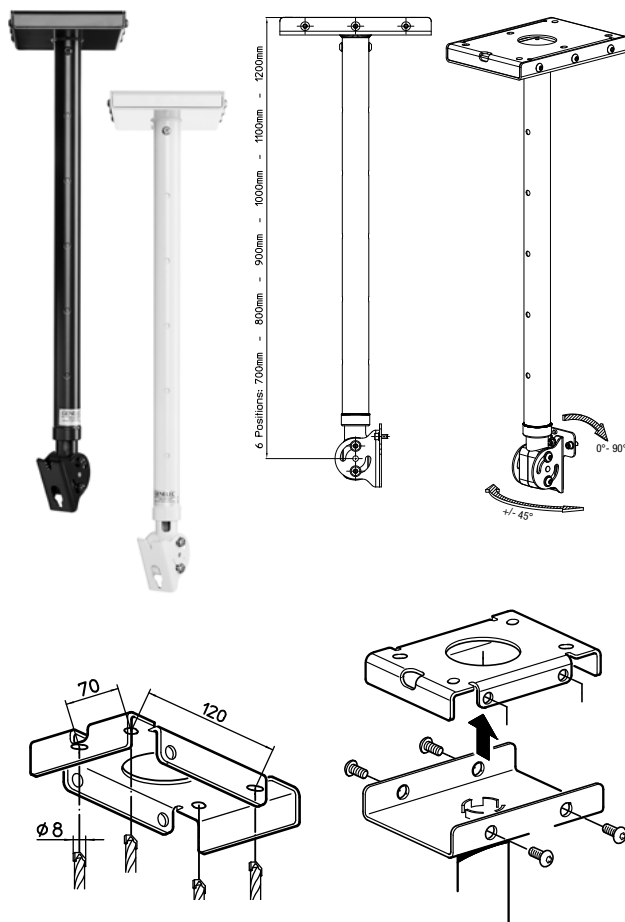



## Truss mount, adjustable length

Truss mount with adjustable length. Clamp for Ø50 mm tube. Adaptable up to 8351 models.

**8000-446C** Truss mount kit, adjustable length, black (K&M 24499-021-55)

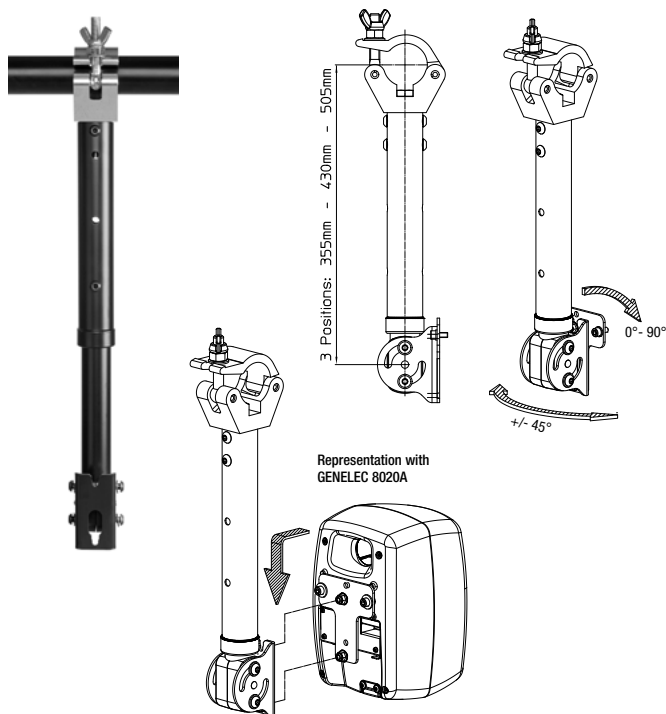

### Associated product

Needed for mounting of 8X20, 8X30, 4X20, 4X30, G Two & G Three only.

8000-454B

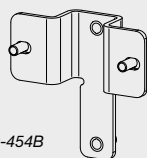

## Short truss mount

Short truss mount with clamp for Ø 50 mm tube. Adaptable for 8000 and 4000 series.

**8000-416C** Short truss mount with clamp (K&M 24493-000-55)

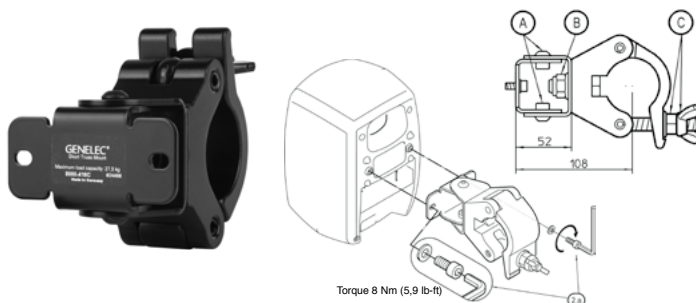

## T-adapter plate

T-adapter plate for Genelec 8320 and 8330.

**8000-454B** T-adapter plate (K&M 24452-000-55)

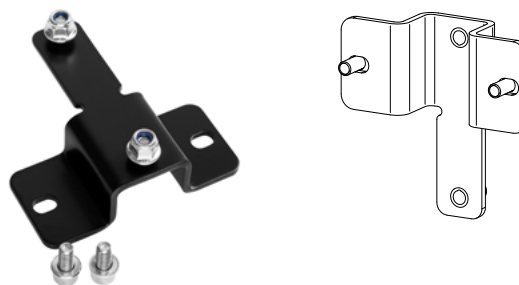

# Wall mounts

8030  
8330  
4030  
4430  
G Three

<b>8000-422B</b>	Wall mount with T-plate, black (K&M 24160-000-56)
<b>8000-422W</b>	Wall mount with T-plate, white (K&M 24160-000-66)

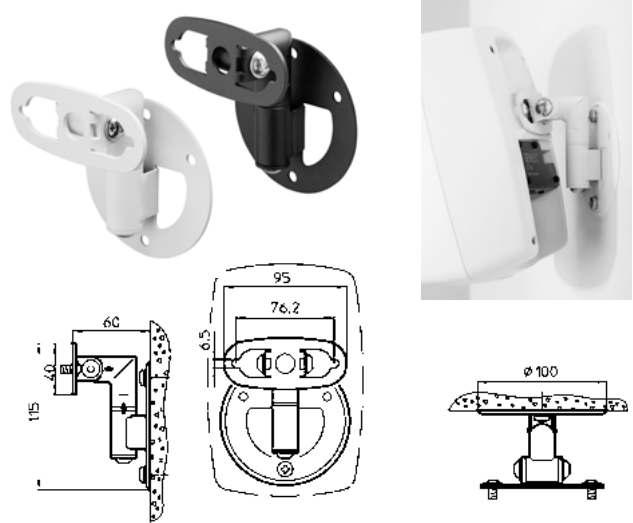

Wall mounting bracket for 8000 series. Available in black and white.  
8X40, 8341, 8X50 and 8351 do not need the included T-plate.

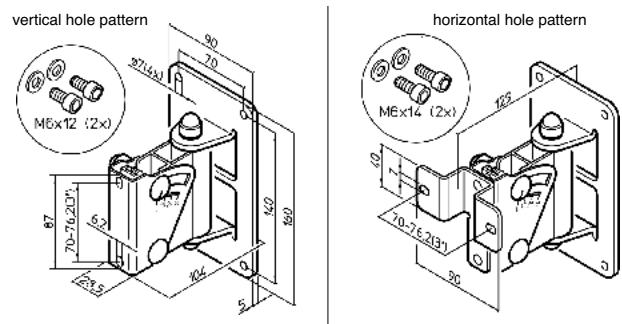

Today many broadcast environments and post-production studios have changed the way of installing video monitors. Instead of using 19" rack systems such LCD /Plasma screens are now placed in so-called flat "media walls". All of them feature the international mechanical mounting system called VESA standard.

# Carrying accessories

## Peli cases

Portable demo cases for easy travelling and demonstrations. Cases with room for mic stands, GLM kit, cables and more.



8030  
8330  
4430  
G Three

### Peli Case 31

Portable demo case for easy travelling and demonstrations. Case 31 has room for two 8X30/8331 plus accessories.

**8000-831** Empty case for two pcs 8X30/8331



## Bags for Genelec loudspeakers

Soft transportation bags for Genelec loudspeakers.

**8030-423** Soft carrying bag for two pcs 8X3X (Genelec)



ACCESSORIES FOR GENELEC MONITORS

8040

8340

4040

G Four

# Table stands

## Short table stand

Short table stand providing a raised position for near-field monitors. Suitable for XX10, XX20, XX30 and XX40. Heavy black cast iron base with anti-vibration rubber ring, diameter 17 mm. Mounting 3/8" thread on the tube top. Preferably used together with stand plates for better positioning. The 8020 and 8030 models have an integrated 3/8" thread for possible direct fixing without stand plate. The XX40 model must be installed with a stand plate. Not to be used with 8331, 8341, 8351 or 8361.

**8000-406** Short table stand (17 cm) (K&M 23310-370-55)

### Associated products



8040-408B, 8040-438W

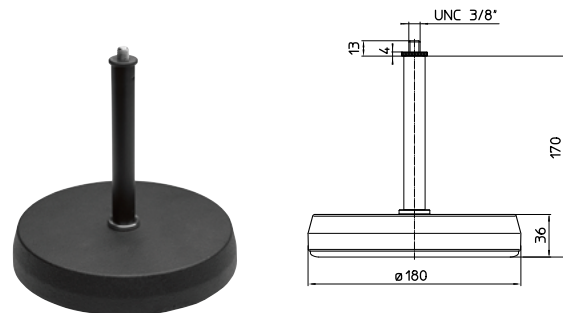

8000-406

8000-406 with stand plate.



## Adjustable height table stand

Adjustable height table stand for XX10, XX20 and XX30 with a base plate that can be attached to a table or flat surface. Preferably used with stand plate and Iso-Pod for better monitor orientation (see picture below). The telescopic tube length (301 to 527 mm) is designed for optimum monitor positioning behind or above computer screens. Screws and fixing nuts for a 40 mm thick table are included.

**8000-425B** Adjustable height table stand (301-527 mm) (K&M 23360-300-55)

### Associated products



8040-408B, 8040-438W

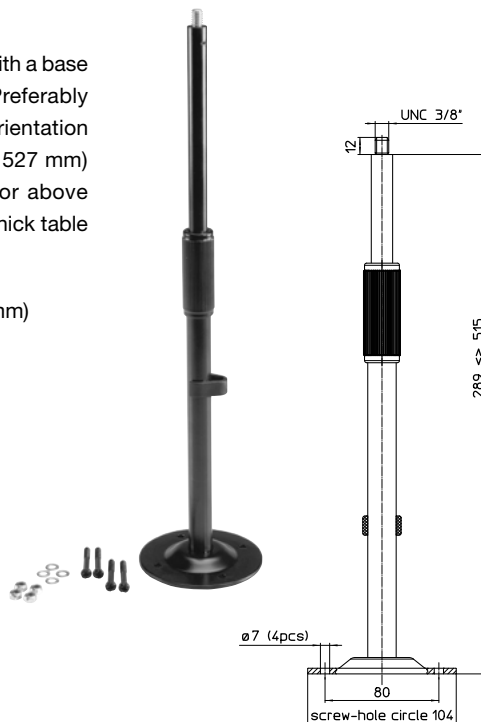

Speaker fitted on 8000-425B with stand plate.





## L-shape table stands

With these stands it is easy to position the speaker on a table with better aiming to the listening position, causing less reflections from the table surface. All stands have 0-20 degree tilt angle adjustment upwards.

For XX10 and XX20 sizes vertical mounting. For 8X3X, 8X4X and 8X5X sizes vertical and also horizontal mounting is possible.

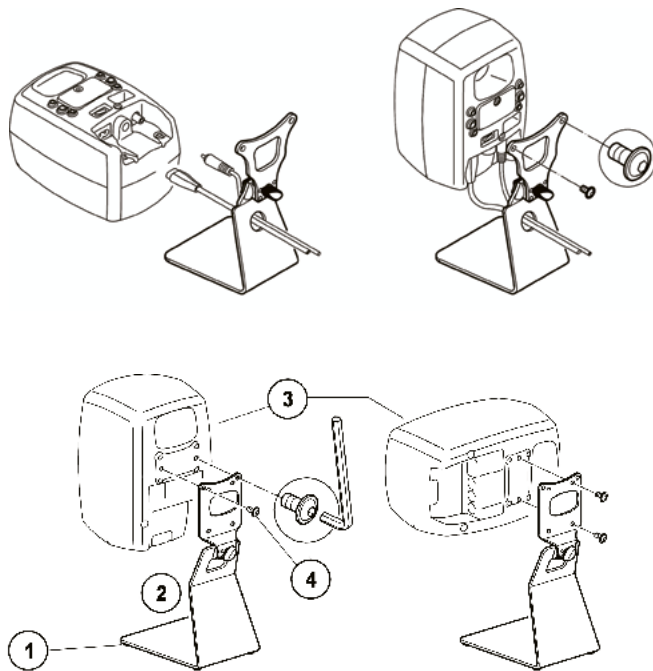

*L-shape stand 8010-320W and 8010*



*L-shape stand 8000-333B and 8331*



*L-shape stand 8000-325W and 8341*



*L-shape stand 8000-325B and 8351*

8040  
8340  
4040  
G Four

## Table stand L-shape for 8X4X and 8X5X

Design L-shape table stand for 8X4X and 8X5X, with adjustable tilt angle up. Available in black and white powder coat finish.

**8000-325B** Table stand L-shape for 8X4X and 8X5X, black (K&M 23276-000-56)

**8000-335W** Table stand L-shape for 8X4X and 8X5X, white (K&M 23276-000-66)

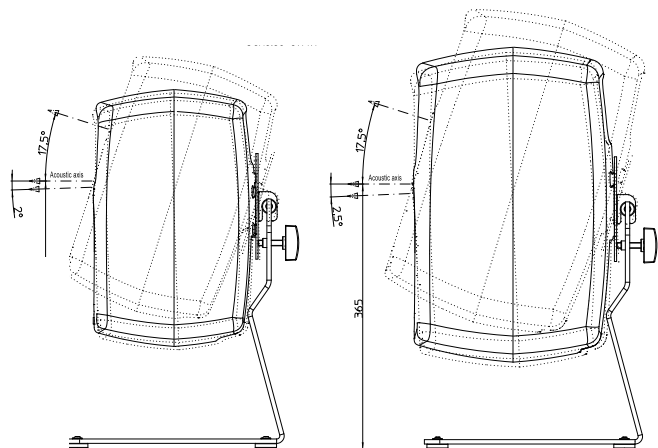

# Floor stands

## Design floor stand

After a long development journey together with K&M, we can finally offer the “Genelec designed floor stand” for the 8000 Series loudspeakers. Harri Koskinen, industrial designer and partner in the design of the 8000 Series loudspeaker made the first drawings several years ago.

This very stable and elegant steel stand has a 420 x 420 mm cast base with an oversized rod combination. Gradual height adjustment is made by a superior positioning and clamping knob. Quick, uncomplicated mounting of the monitor is accomplished using the suspension device. This floor stand is mainly designed for 8040, 8340, 8341, 8350 and 8351. Weight: 13.4 kg, Height: variable between 1100/1700 mm.

**8000-400** Genelec Design stand (K&M 26785-018-56)



## Floor stand

Stable steel stand with a broad round cast iron base. Base diameter 450 mm. Adjustable height using clamping screw and safety pin. Mounting 3/8" thread for any Genelec stand plates, from 8020 to 8050 model. Load capacity: 35 kg. Weight: 10.6 kg. Height: 950 to 1430 mm. Packing: double cardboard packing; iron base in one and stand in the second. Suitable for all models between 8010 – 8351.

**8000-409B** Floor stand (950-1430 mm) for 1032 (K&M 26741-129-55)



## Associated products



8040-408B, 8040-438W

# Stand plates

## Stand plate for 8X40, 8341

Genelec stand plates are designed for use together with the Iso-Pod that comes with all 8000 series monitors. The Iso-Pod allows you to tilt the monitor for optimal alignment. Simply mount the stand plate onto the 3/8" thread on the tube and ensure tight screw connection. Place the Iso-Pod over the four pins of the stand plate.

- 8040-408B** Stand plate for 8X40, 8341 Iso-Pod, black (K&M 19624-329-55)  
**8040-438W** Stand plate for 8X40, 8341 Iso-Pod, white (K&M 19624-329-66)

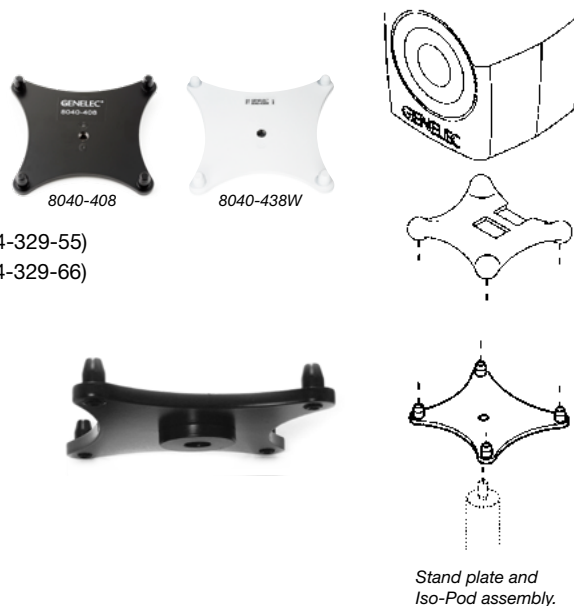
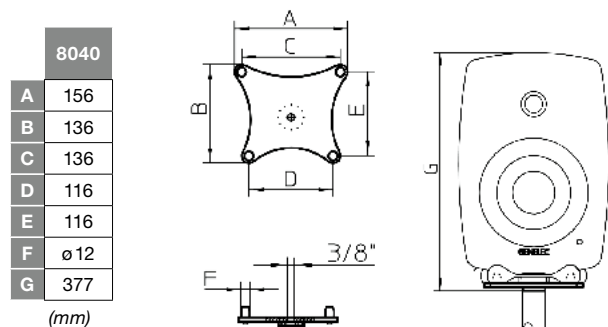

# Ceiling mounts

## Short ceiling mount

For all 8000 series models. Available in black and white.

- 8000-436B** Short ceiling mount, black (K&M 24486-000-55)  
**8000-436W** Short ceiling mount, white (K&M 24486-000-57)

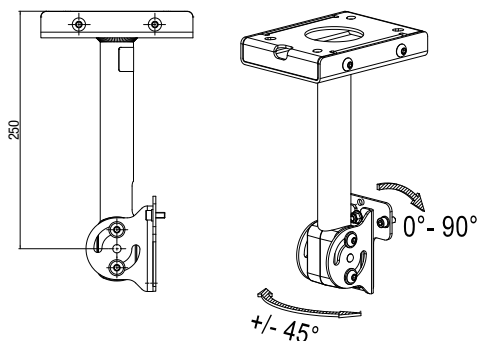

### Associated product

Needed for mounting of 8X20, 8X30, 4X20, 4X30, G Two & G Three only.

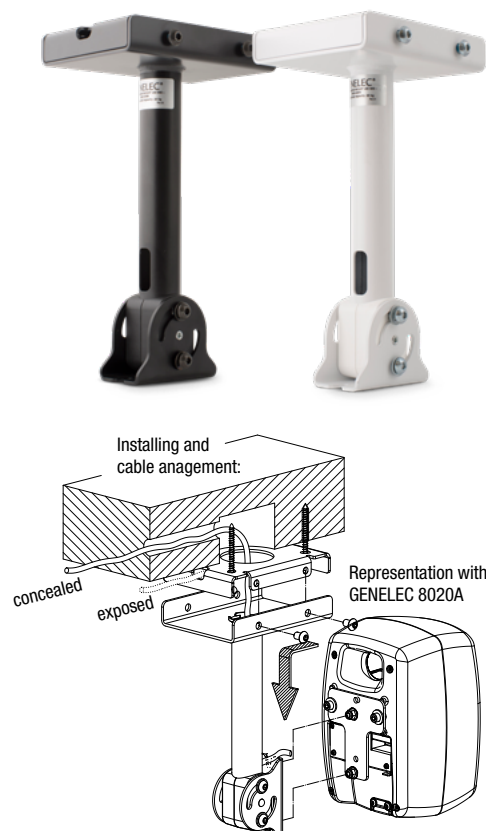
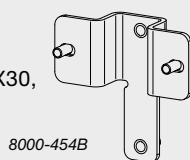

## Short adjustable ceiling mount

Adjustable ceiling mount for all 8000 series models, possible to down tilt up to 90 degrees. The tube have openings in each end, possible to have cables in the 50 mm tube. Available in black and white.

**8000-442B** Short adjustable ceiling mount, black  
(K&M 24491-000-55)

**8000-442W** Short adjustable ceiling mount, white  
(K&M 24491-000-57)

### Associated product

Needed for mounting of 8X20, 8X30,  
4X20, 4X30, G Two & G Three only.

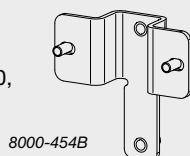

8000-454B

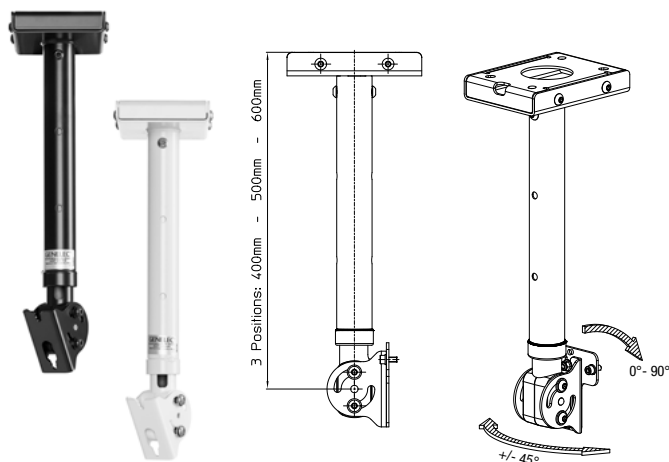

## Long adjustable ceiling mount

Adjustable ceiling mount for all 8000 series models, possible to down tilt up to 90 degrees. The tube have openings in each end, possible to have cables in the 50 mm tube. Available in black and white.

**8000-444B** Long adjustable ceiling mount, black  
(K&M 24494-000-55)

**8000-444W** Long adjustable ceiling mount, white  
(K&M 24494-000-57)

### Associated product

Needed for mounting of 8X20, 8X30,  
4X20, 4X30, G Two & G Three only.

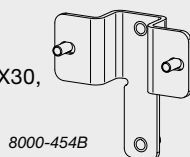

8000-454B

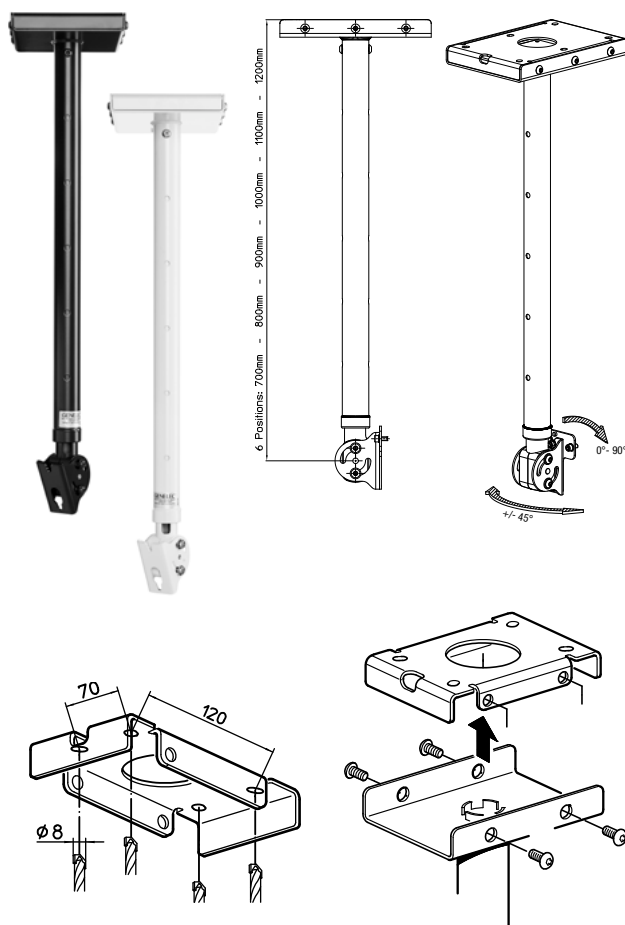

## Truss mount, adjustable length

Truss mount with adjustable length. Clamp for Ø50 mm tube. Adaptable up to 8351 models.

**8000-446C** Truss mount kit, adjustable length, black (K&M 24499-021-55)

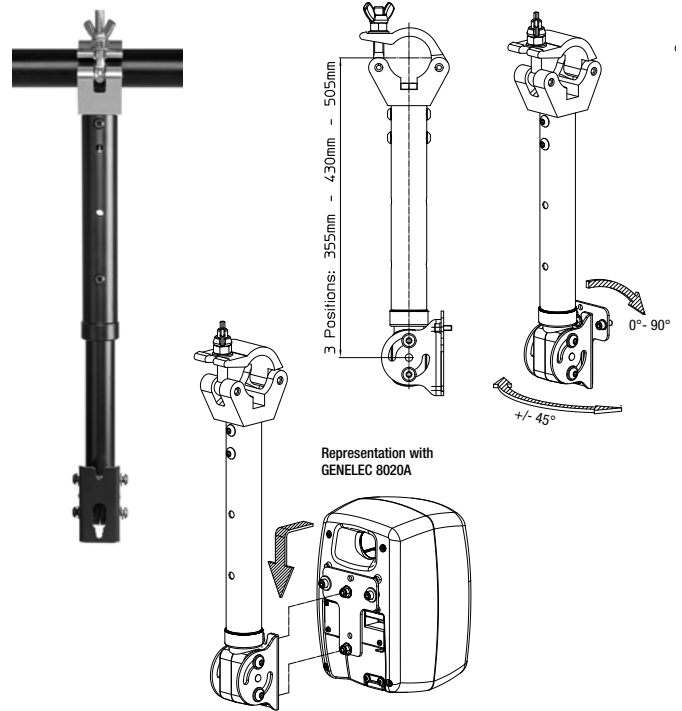

### Associated product

Needed for mounting of 8X20, 8X30, 4X20, 4X30, G Two & G Three only.

8000-454B

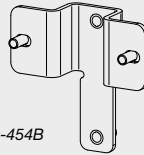

## Short truss mount

Short truss mount with clamp for Ø 50 mm tube. Adaptable for 8000 and 4000 series.

**8000-416C** Short truss mount with clamp (K&M 24493-000-55)

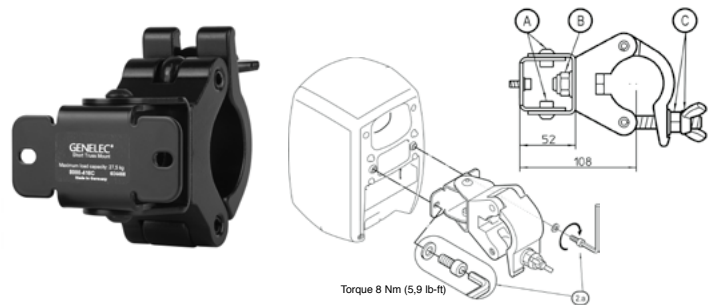

8040  
8340  
4040  
G Four

# Wall mounts

## Adjustable wall mount

Wall mounting bracket for 8000 series. Available in black and white. 8X40, 8341, 8X50 and 8351 do not need the included T-plate.

- 8000-402B** Wall mounting bracket, black (K&M 24475-017-55)  
**8000-402W** Wall mounting bracket, white (K&M 24475-017-57)

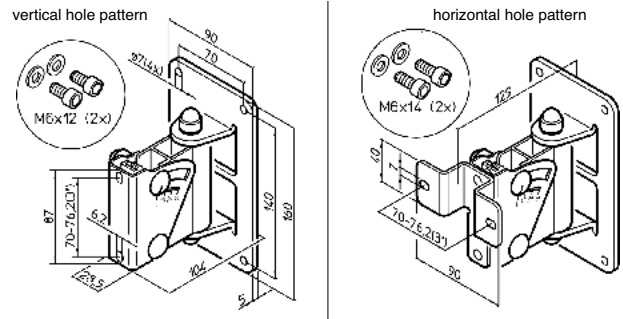

## VESA-adapter for 8000-series

Today many broadcast environments and post-production studios have changed the way of installing video monitors. Instead of using 19" rack systems such LCD / Plasma screens are now placed in so-called flat "media walls". All of them feature the international mechanical mounting system called VESA standard.

We all know pictures need to be completed with sound, and therefore we have made a simple adapter fitting Genelec 8010-8050 and 8331-8351 speakers. With this small adapter one can mount 8000 series monitors into any kind of VESA 75/100 based accessories.

- 8000-437B** VESA adapter 75/100 mm (K&M 24483-015-55)

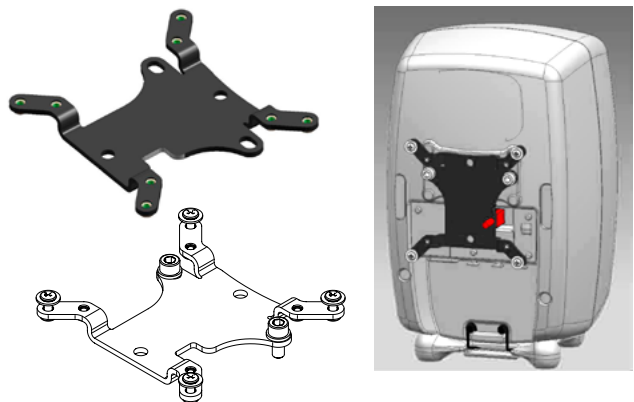



# Flush mounts

## Flush mount kit for 8000-series

Genelec Flush mount kits are designed for mounting Genelec monitors into a sturdy wall structure without changing the acoustic performance of the product. Horizontal mounting is also possible. They may not be used for any other purpose.

**8341-450B** Flush mount kit for 8040/8340/8341 (Genelec)

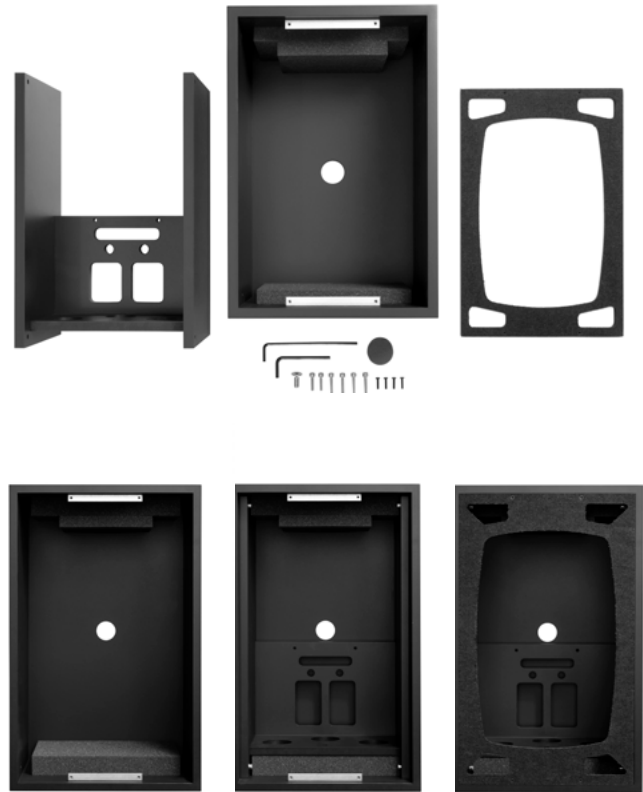
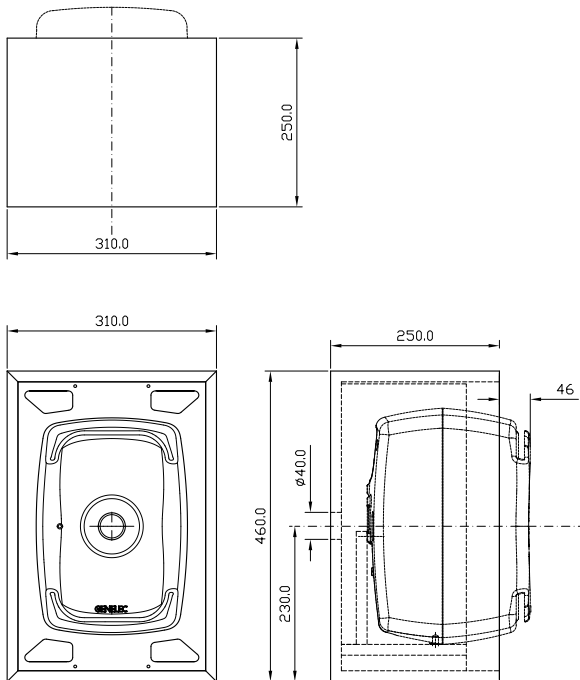

8040  
8340  
4040  
G Four

# Carrying accessories

## Peli cases

Portable demo cases for easy travelling and demonstrations. Cases with room for mic stands, GLM kit, cables and more.



### Peli Case 41

Portable demo case for easy travelling and demonstrations. Case 41 has room for two pcs 8X40/8341 plus accessories.

**8000-841** Empty case for two pcs 8X40/8341



### Bags for Genelec loudspeakers

Soft transportation bags for Genelec loudspeakers.

**8040-423** Soft carrying bag for two pcs 8X4X or 1pc 7040 (Genelec)



ACCESSORIES FOR GENELEC MONITORS

8050

8350

G Five

# Table stands

## L-shape table stands

With these stands it is easy to position the speaker on a table with better aiming to the listening position, causing less reflections from the table surface. All stands have 0-20 degree tilt angle adjustment upwards.

For XX10 and XX20 sizes vertical mounting. For 8X3X, 8X4X and 8X5X sizes vertical and also horizontal mounting is possible.



*L-shape stand 8010-320W  
and 8010*



*L-shape stand 8000-333B  
and 8331*



*L-shape stand 8000-325W  
and 8341*



*L-shape stand 8000-325B  
and 8351*

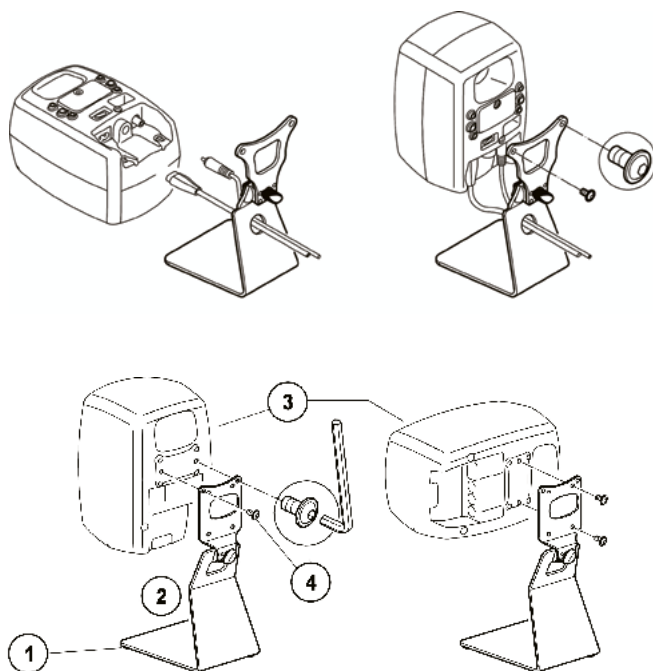

## Table stand L-shape for 8X4X and 8X5X

Design L-shape table stand for 8X4X and 8X5X, with adjustable tilt angle up. Available in black and white powder coat finish.

**8000-325B** Table stand L-shape for 8X4X and 8X5X, black (K&M 23276-000-56)

**8000-335W** Table stand L-shape for 8X4X and 8X5X, white (K&M 23276-000-66)

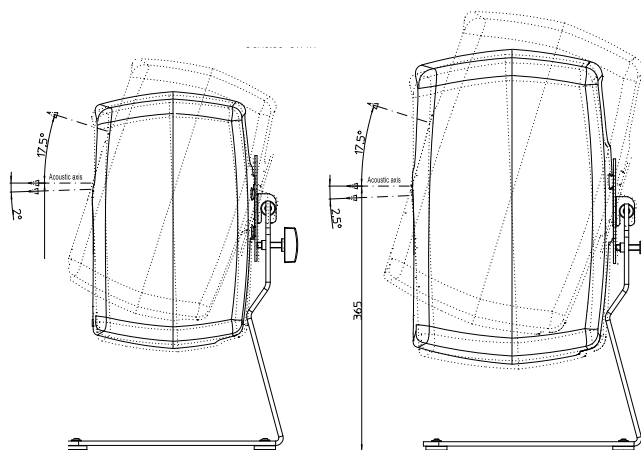

# Floor stands

## Design floor stand

After a long development journey together with K&M, we can finally offer the “Genelec designed floor stand” for the 8000 Series loudspeakers. Harri Koskinen, industrial designer and partner in the design of the 8000 Series loudspeaker made the first drawings several years ago.

This very stable and elegant steel stand has a 420 x 420 mm cast base with an oversized rod combination. Gradual height adjustment is made by a superior positioning and clamping knob. Quick, uncomplicated mounting of the monitor is accomplished using the suspension device. This floor stand is mainly designed for 8040, 8340, 8341, 8350 and 8351. Weight: 13.4 kg, Height: variable between 1100/1700 mm.

**8000-400** Genelec Design stand (K&M 26785-018-56)



## Floor stand

Stable steel stand with a broad round cast iron base. Base diameter 450 mm. Adjustable height using clamping screw and safety pin. Mounting 3/8" thread for any Genelec stand plates, from 8020 to 8050 model. Load capacity: 35 kg. Weight: 10.6 kg. Height: 950 to 1430 mm. Packing: double cardboard packing; iron base in one and stand in the second. Suitable for all models between 8010 – 8351.

**8000-409B** Floor stand (950-1430 mm) for 1032 (K&M 26741-129-55)

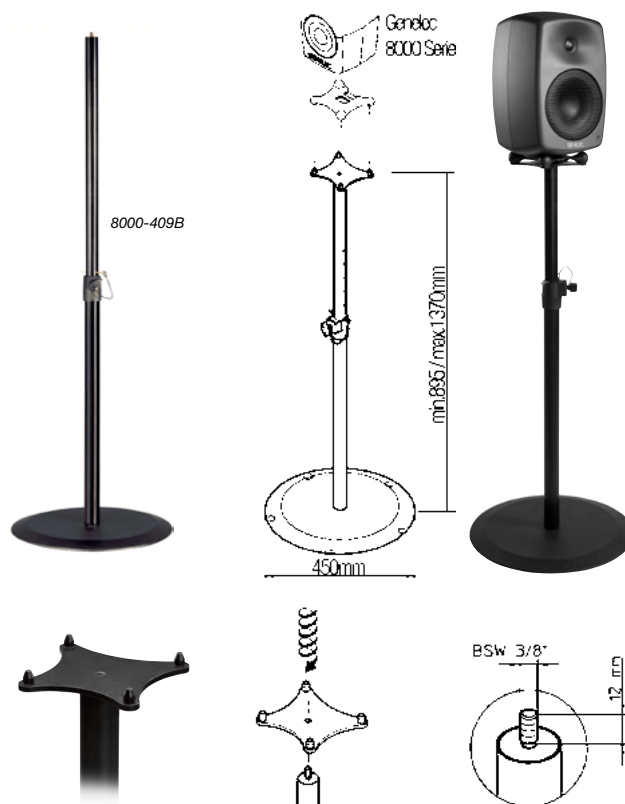

8050  
8350  
G Five

## Associated products



8051-408

## Floor stand for S360 and 8XXX

Genelec designed floor stand with variable height between 644 - 1044mm (650/1050mm with stand plate).

For models 8350, 8351 and G5:

Can be used with Stand plate 8051-408.

For models 8351, 8260 and 8361:

Can be used with Stand plates 8051-408 and 8260-450B.

For model S360:

Can be used with Stand plate S360-408B or with Side-Side mounting bracket S360-450B.

**S360-415B** Floor stand for S360 and 8XXX (K&M 26791-000-56)

### Associated products



8260-450B



8051-408



Stand plate mounting for 8351

# Stand plates

## Stand plate for 8X50, 8351

Genelec stand plates are designed for use together with the Iso-Pod that comes with all 8000 series monitors. The Iso-Pod allows you to tilt the monitor for optimal alignment. Simply mount the stand plate onto the 3/8" thread on the tube and ensure tight screw connection. Place the Iso-Pod over the four pins of the stand plate.

**8051-408** Stand plate for 8X50, 8351 Iso-Pod (K&M 19625-330-56)

	8050 8351
A	195
B	170
C	170
D	145
E	145
F	ø 12
G	464

(mm)

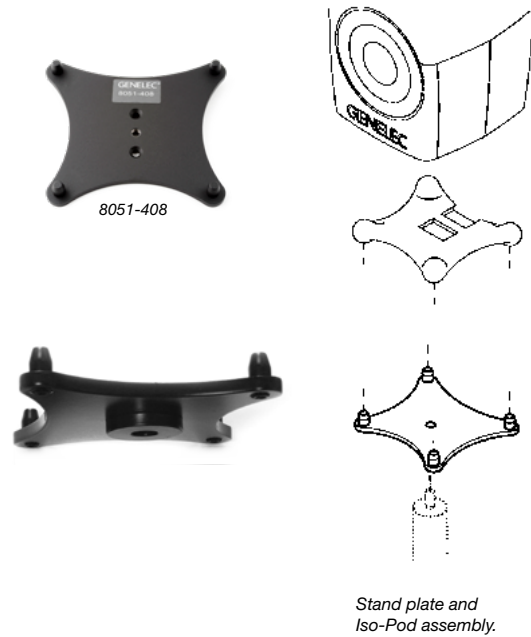
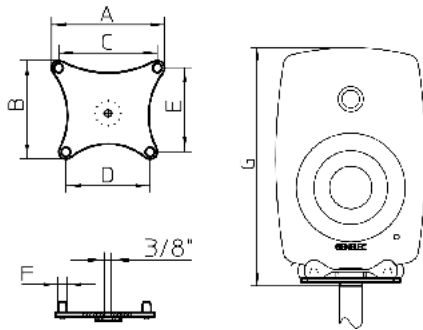

# Ceiling mounts

## Short ceiling mount

For all 8000 series models. Available in black and white.

**8000-436B** Short ceiling mount, black (K&M 24486-000-55)

**8000-436W** Short ceiling mount, white (K&M 24486-000-57)

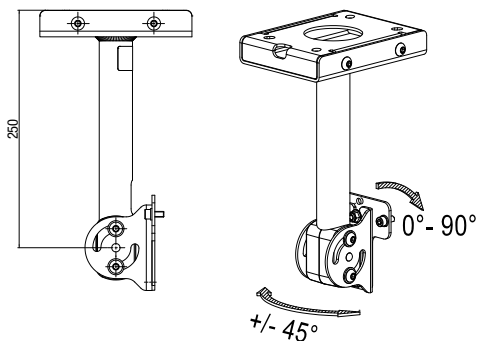

### Associated product

Needed for mounting of 8X20, 8X30, 4X20, 4X30, G Two & G Three only.

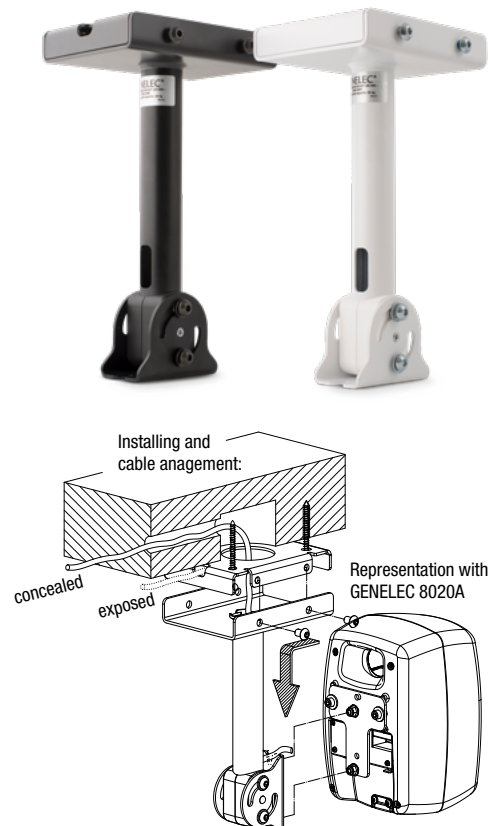
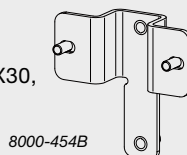

8050  
8350  
G Five



## Short adjustable ceiling mount

Adjustable ceiling mount for all 8000 series models, possible to down tilt up to 90 degrees. The tube have openings in each end, possible to have cables in the 50 mm tube. Available in black and white.

**8000-442B** Short adjustable ceiling mount, black  
(K&M 24491-000-55)

**8000-442W** Short adjustable ceiling mount, white  
(K&M 24491-000-57)

### Associated product

Needed for mounting of 8X20, 8X30,  
4X20, 4X30, G Two & G Three only.

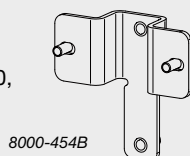

8000-454B

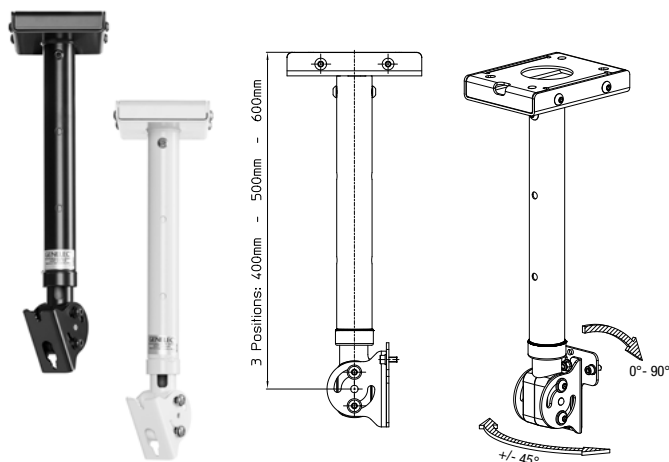

## Long adjustable ceiling mount

Adjustable ceiling mount for all 8000 series models, possible to down tilt up to 90 degrees. The tube have openings in each end, possible to have cables in the 50 mm tube. Available in black and white.

**8000-444B** Long adjustable ceiling mount, black  
(K&M 24494-000-55)

**8000-444W** Long adjustable ceiling mount, white  
(K&M 24494-000-57)

### Associated product

Needed for mounting of 8X20, 8X30,  
4X20, 4X30, G Two & G Three only.

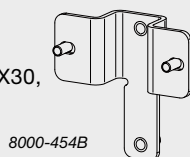

8000-454B

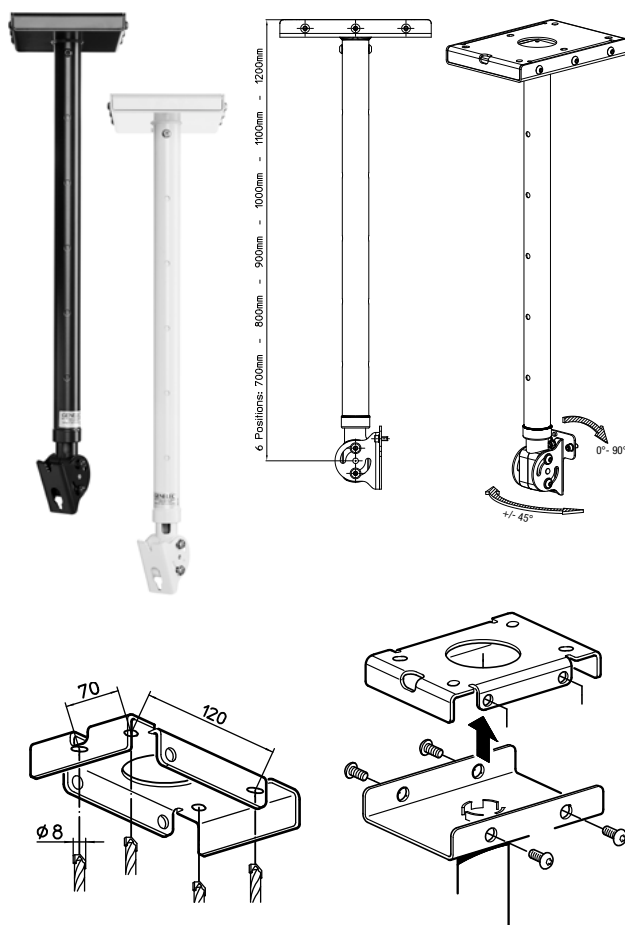

## Truss mount, adjustable length

Truss mount with adjustable length. Clamp for Ø50 mm tube. Adaptable up to 8351 models.

**8000-446C** Truss mount kit, adjustable length, black (K&M 24499-021-55)

### Associated product

Needed for mounting of 8X20, 8X30, 4X20, 4X30, G Two & G Three only.

8000-454B

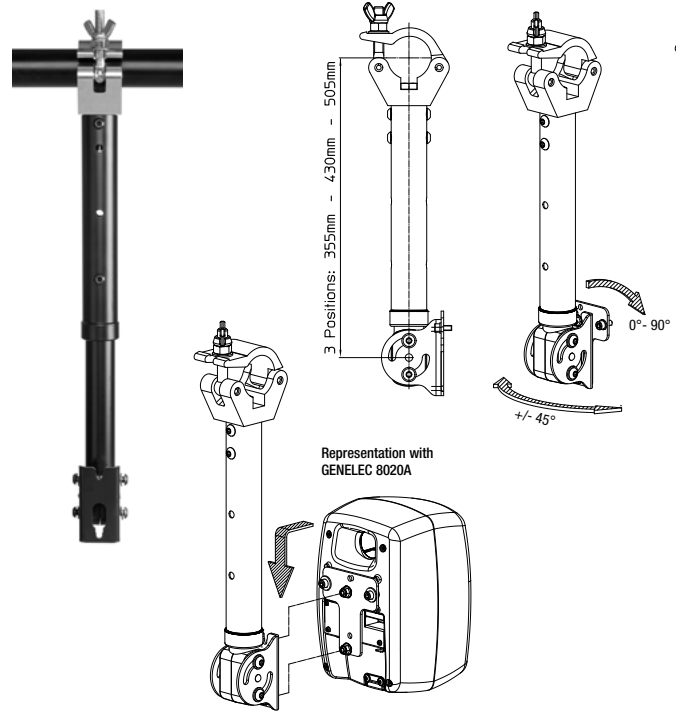
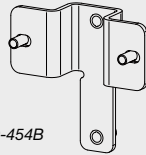

## Short truss mount

Short truss mount with clamp for Ø 50 mm tube. Adaptable for 8000 and 4000 series.

**8000-416C** Short truss mount with clamp (K&M 24493-000-55)

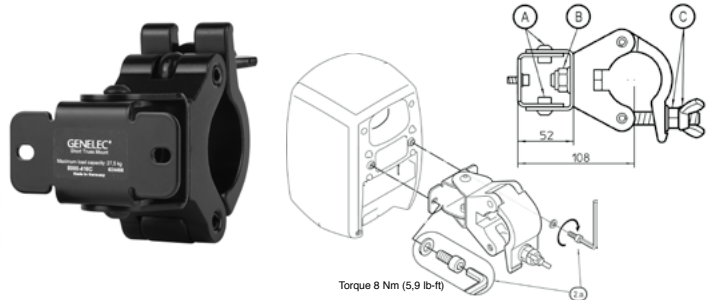

8050  
8350  
G Five

# Wall mounts

## Adjustable wall mount

Wall mounting bracket for 8000 series. Available in black and white. 8X40, 8341, 8X50 and 8351 do not need the included T-plate.

- 8000-402B** Wall mounting bracket, black (K&M 24475-017-55)  
**8000-402W** Wall mounting bracket, white (K&M 24475-017-57)

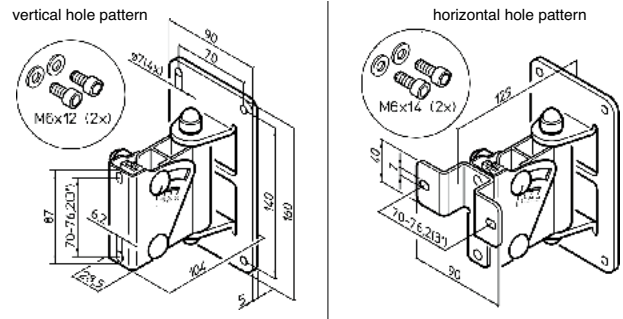

## VESA-adapter for 8000-series

Today many broadcast environments and post-production studios have changed the way of installing video monitors. Instead of using 19" rack systems such LCD / Plasma screens are now placed in so-called flat "media walls". All of them feature the international mechanical mounting system called VESA standard.

We all know pictures need to be completed with sound, and therefore we have made a simple adapter fitting Genelec 8010-8050 and 8331-8351 speakers. With this small adapter one can mount 8000 series monitors into any kind of VESA 75/100 based accessories.

- 8000-437B** VESA adapter 75/100 mm (K&M 24483-015-55)

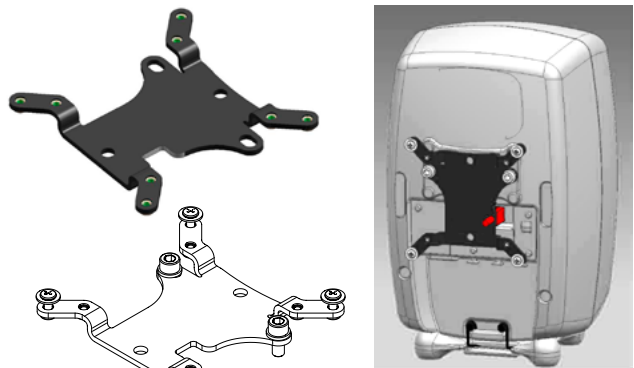

# Flush mounts

## Flush mount kit for 8000-series

Genelec Flush mount kits are designed for mounting Genelec monitors into a sturdy wall structure without changing the acoustic performance of the product. Horizontal mounting is also possible. They may not be used for any other purpose.

**8351-450B** Flush mount kit for 8050/8350/8351 (Genelec)

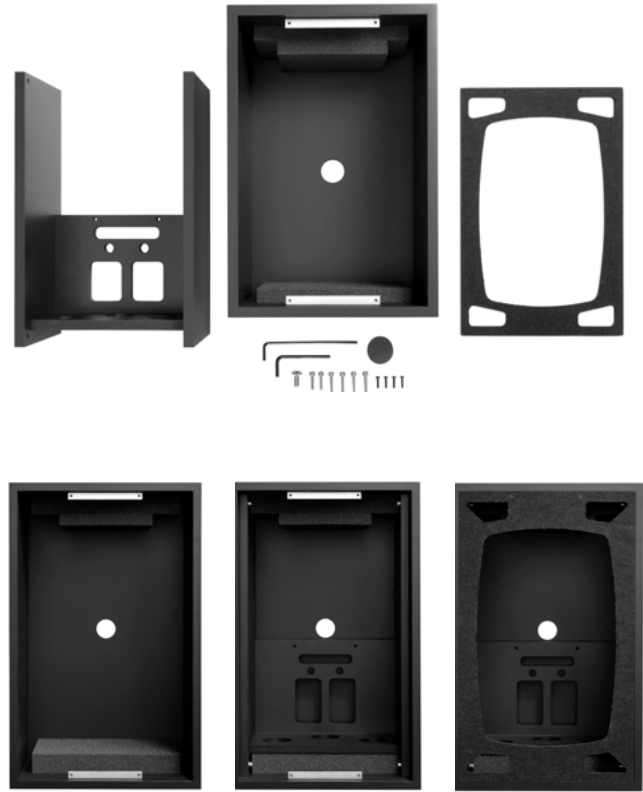
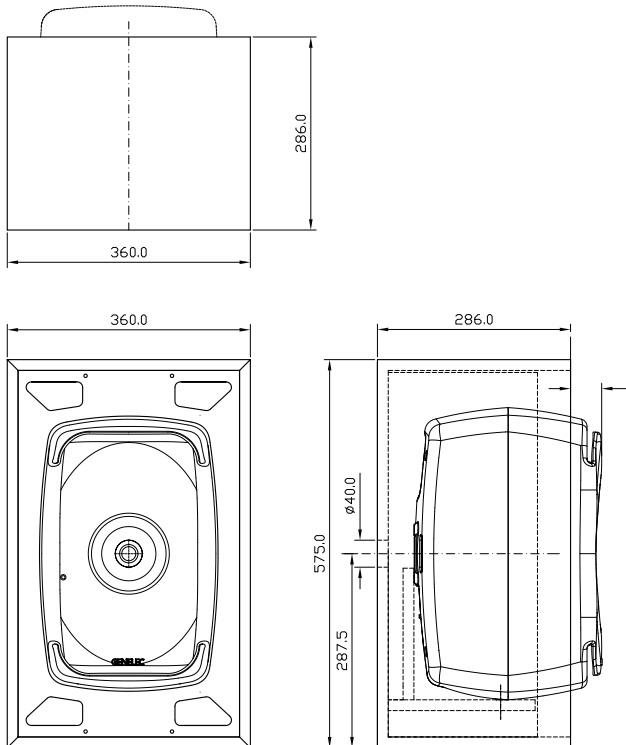

8050  
8350  
G Five

# Carrying accessories

## Peli cases

Portable demo cases for easy travelling and demonstrations. Cases with room for mic stands, GLM kit, cables and more.



### Peli Case 51

Portable demo case for easy travelling and demonstrations. Case 51 has room for one 8X50/8351 plus accessories.

**8000-851** Empty case for one pc 8X50/8351



## Bags for Genelec loudspeakers

Soft transportation bags for Genelec loudspeakers.

**8050-423** Soft carrying bag for one 8X5X (Genelec)



## ACCESSORIES FOR GENELEC MONITORS

8331

8341

8351

8361

# Table stands

## Adjustable height table stand

Adjustable height table stand for XX10, XX20 and XX30 with a base plate that can be attached to a table or flat surface. Preferably used with stand plate and Iso-Pod for better monitor orientation (see picture below). The telescopic tube length (301 to 527 mm) is designed for optimum monitor positioning behind or above computer screens. Screws and fixing nuts for a 40 mm thick table are included.

**8000-425B** Adjustable height table stand (301-527 mm)  
(K&M 23360-300-55)

### Associated products



8030-408, 8030-438W

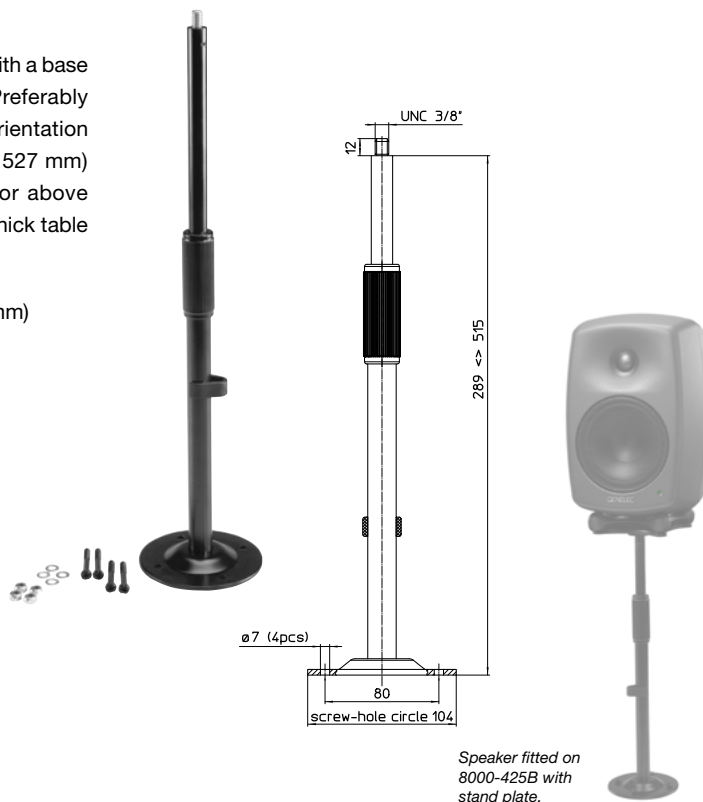

8331  
8341  
8351  
8361  
8260



## L-shape table stands

With these stands it is easy to position the speaker on a table with better aiming to the listening position, causing less reflections from the table surface. All stands have 0-20 degree tilt angle adjustment upwards.

For XX10 and XX20 sizes vertical mounting. For 8X3X, 8X4X and 8X5X sizes vertical and also horizontal mounting is possible.

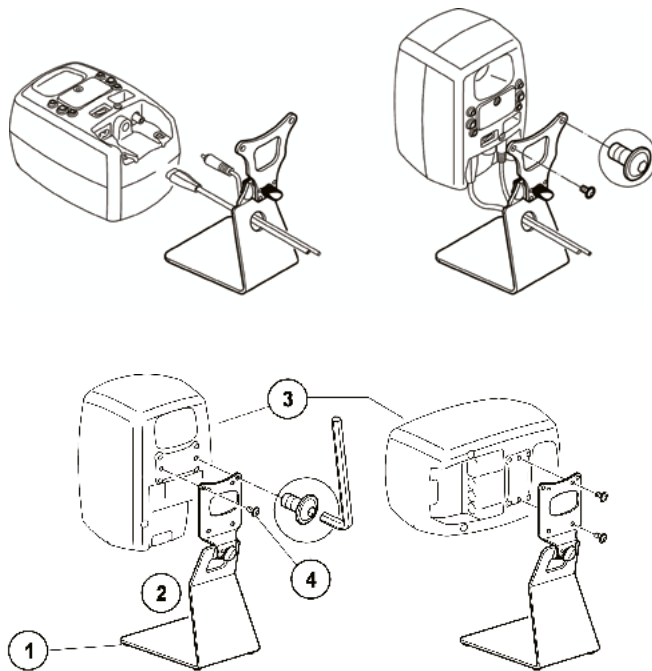

*L-shape stand 8010-320W  
and 8010*



*L-shape stand 8000-333B  
and 8331*



*L-shape stand 8000-325W  
and 8341*



*L-shape stand 8000-325B  
and 8351*

## Table stand L-shape for 8X3X

Design L-shape table stand for 8X3X, with adjustable tilt angle up. Available in black and white powder coat finish.

**8000-333B** Table stand L-shape for 8X3X, black (K&M 23275-022-56)

**8020-333W** Table stand L-shape for 8X3X, white (K&M 23275-022-66)

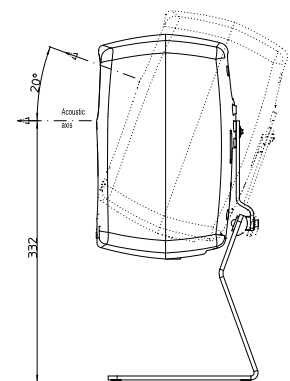

8331  
8341  
8351  
8361  
8260

## Table stand L-shape for 8X4X and 8X5X

Design L-shape table stand for 8X4X and 8X5X, with adjustable tilt angle up. Available in black and white powder coat finish.

**8000-325B** Table stand L-shape for 8X4X and 8X5X, black (K&M 23276-000-56)

**8000-335W** Table stand L-shape for 8X4X and 8X5X, white (K&M 23276-000-66)

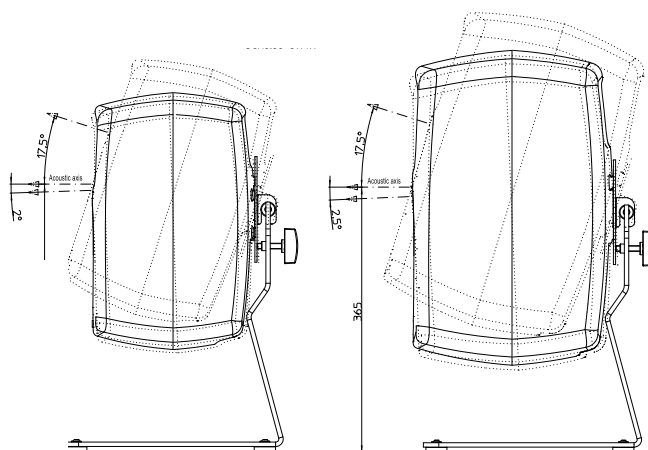

## Floor stands

### Design floor stand

After a long development journey together with K&M, we can finally offer the “Genelec designed floor stand” for the 8000 Series loudspeakers. Harri Koskinen, industrial designer and partner in the design of the 8000 Series loudspeaker made the first drawings several years ago.

This very stable and elegant steel stand has a 420 x 420 mm cast base with an oversized rod combination. Gradual height adjustment is made by a superior positioning and clamping knob. Quick, uncomplicated mounting of the monitor is accomplished using the suspension device. This floor stand is mainly designed for 8040, 8340, 8341, 8350 and 8351. Weight: 13.4 kg, Height: variable between 1100/1700 mm.

**8000-400** Genelec Design stand (K&M 26785-018-56)



## Floor stand

Stable steel stand with a broad round cast iron base. Base diameter 450 mm. Adjustable height using clamping screw and safety pin. Mounting 3/8" thread for any Genelec stand plates, from 8020 to 8050 model. Load capacity: 35 kg. Weight: 10.6 kg. Height: 950 to 1430 mm. Packing: double cardboard packing; iron base in one and stand in the second. Suitable for all models between 8010 – 8351.

**8000-409B** Floor stand (950-1430 mm) for 1032 (K&M 26741-129-55)

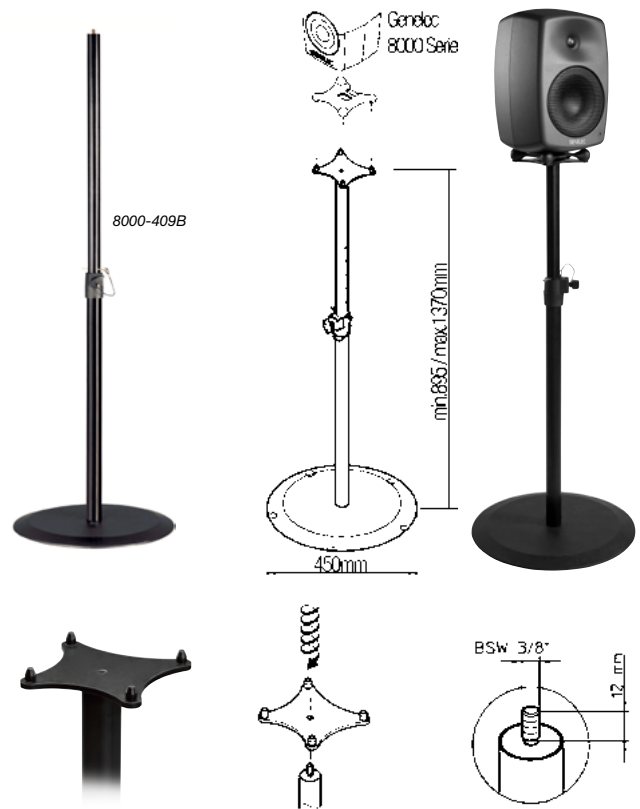

### Associated products



## Floor stand for S360 and 8XXX

Genelec designed floor stand with variable height between 644 - 1044mm (650/1050mm with stand plate).

For models 8350, 8351 and G5:  
Can be used with Stand plate 8051-408.

For models 8351, 8260 and 8361:  
Can be used with Stand plates 8051-408 and 8260-450B.

For model S360:  
Can be used with Stand plate S360-408B or with Side-Side mounting bracket S360-450B.

**S360-415B** Floor stand for S360 and 8XXX (K&M 26791-000-56)



### Associated products



# Stand plates

## Stand plate for 8X30, 8331

Genelec stand plates are designed for use together with the Iso-Pod that comes with all 8000 series monitors. The Iso-Pod allows you to tilt the monitor for optimal alignment. Simply mount the stand plate onto the 3/8" thread on the tube and ensure tight screw connection. Place the Iso-Pod over the four pins of the stand plate.

- 8030-408B** Stand plate for 8X30, 8331 Iso-Pod, black (K&M 19623-329-55)  
**8030-438W** Stand plate for 8X30, 8331 Iso-Pod, white (K&M 19623-329-66)

	8030
A	126
B	110
C	108
D	93
E	92
F	ø10
G	311

(mm)

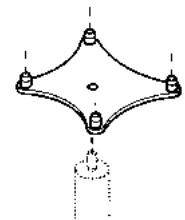
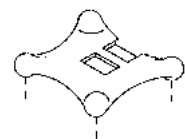
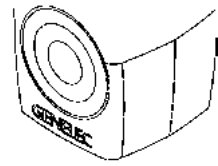
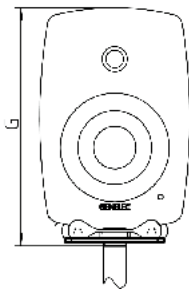
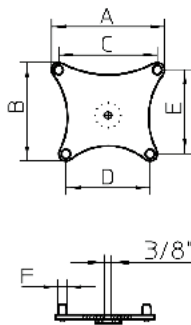

Stand plate and Iso-Pod assembly.

## Stand plate for 8X40, 8341

Genelec stand plates are designed for use together with the Iso-Pod that comes with all 8000 series monitors. The Iso-Pod allows you to tilt the monitor for optimal alignment. Simply mount the stand plate onto the 3/8" thread on the tube and ensure tight screw connection. Place the Iso-Pod over the four pins of the stand plate.

- 8040-408B** Stand plate for 8X40, 8341 Iso-Pod, black (K&M 19624-329-55)  
**8040-438W** Stand plate for 8X40, 8341 Iso-Pod, white (K&M 19624-329-66)

	8040
A	156
B	136
C	136
D	116
E	116
F	ø12
G	377

(mm)

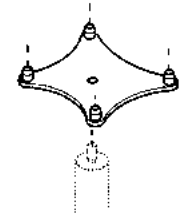
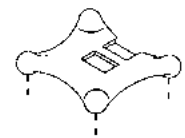
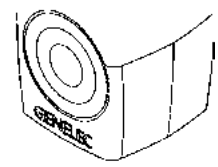
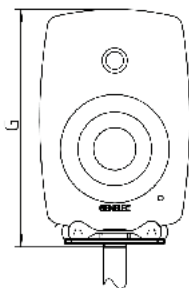
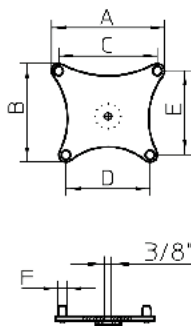

Stand plate and Iso-Pod assembly.

## Stand plate for 8X50, 8351

Genelec stand plates are designed for use together with the Iso-Pod that comes with all 8000 series monitors. The Iso-Pod allows you to tilt the monitor for optimal alignment. Simply mount the stand plate onto the 3/8" thread on the tube and ensure tight screw connection. Place the Iso-Pod over the four pins of the stand plate.

**8051-408** Stand plate for 8X50, 8351 Iso-Pod (K&M 19625-330-56)

	8050 8351
A	195
B	170
C	170
D	145
E	145
F	ø 12
G	464
(mm)	

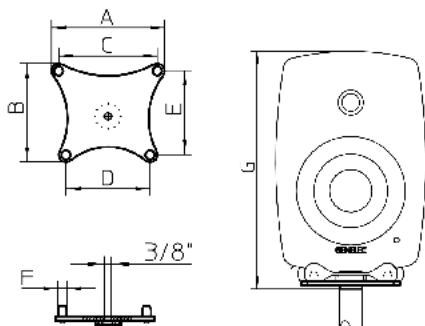

8051-408

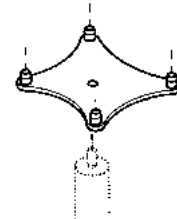
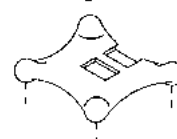
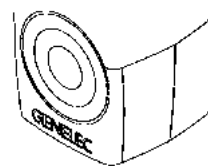

Stand plate and  
Iso-Pod assembly.

## Stand plate for 8361

Genelec stand plates are designed for use together with the Iso-Pod that comes with all 8000 series monitors. The Iso-Pod allows you to tilt the monitor for optimal alignment. Simply mount the stand plate onto the 3/8" thread on the tube and ensure tight screw connection. Place the Iso-Pod over the four pins of the stand plate.

**8260-450B** Stand plate for 8361 Iso-Pod (K&M 19628-300-56)

	8260
A	255,5
B	225
C	212,5
D	182
E	182
F	ø 30
G	593
(mm)	

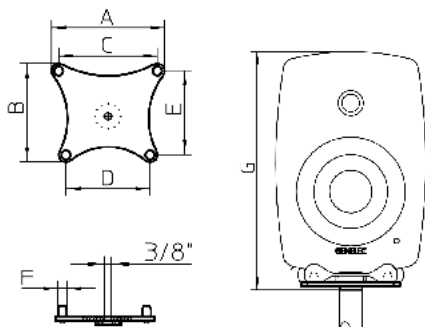

8260-450B

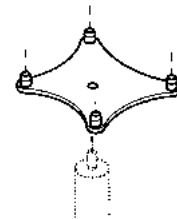
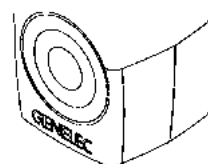

Stand plate and  
Iso-Pod assembly.

8331  
8341  
8351  
8361  
8260

## Adapter for horizontal mounting of 8351

Mounting plate for Design floor stand 8000-400, to be used for horizontal mounting of 8351.

**8000-438** Adapter for horizontal mounting, black (K&M 24454-000-56)

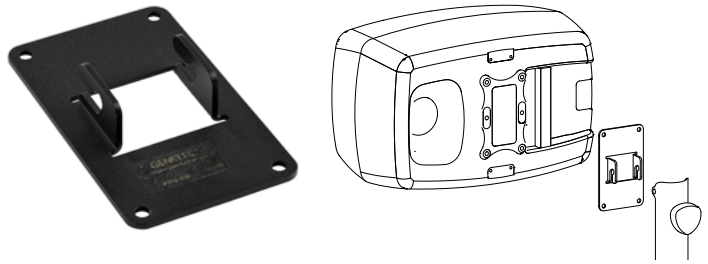

## Ceiling mounts

### Short ceiling mount

For all 8000 series models. Available in black and white.

**8000-436B** Short ceiling mount, black (K&M 24486-000-55)

**8000-436W** Short ceiling mount, white (K&M 24486-000-57)

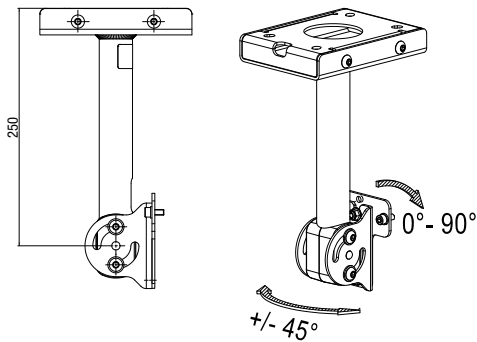

### Associated product

Needed for mounting of 8X20, 8X30, 4X20, 4X30, G Two & G Three only.

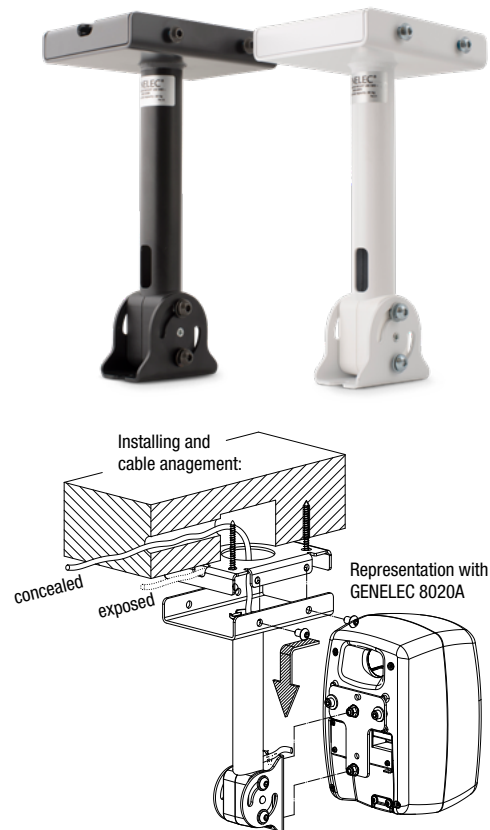
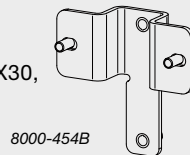

## Short adjustable ceiling mount

Adjustable ceiling mount for all 8000 series models, possible to down tilt up to 90 degrees. The tube have openings in each end, possible to have cables in the 50 mm tube. Available in black and white.

**8000-442B** Short adjustable ceiling mount, black  
(K&M 24491-000-55)

**8000-442W** Short adjustable ceiling mount, white  
(K&M 24491-000-57)

### Associated product

Needed for mounting of 8X20, 8X30,  
4X20, 4X30, G Two & G Three only.

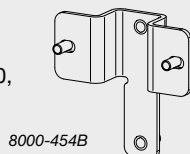

8000-454B

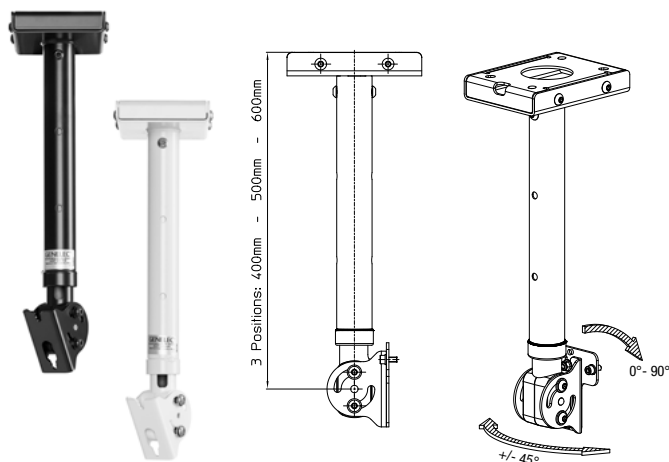

## Long adjustable ceiling mount

Adjustable ceiling mount for all 8000 series models, possible to down tilt up to 90 degrees. The tube have openings in each end, possible to have cables in the 50 mm tube. Available in black and white.

**8000-444B** Long adjustable ceiling mount, black  
(K&M 24494-000-55)

**8000-444W** Long adjustable ceiling mount, white  
(K&M 24494-000-57)

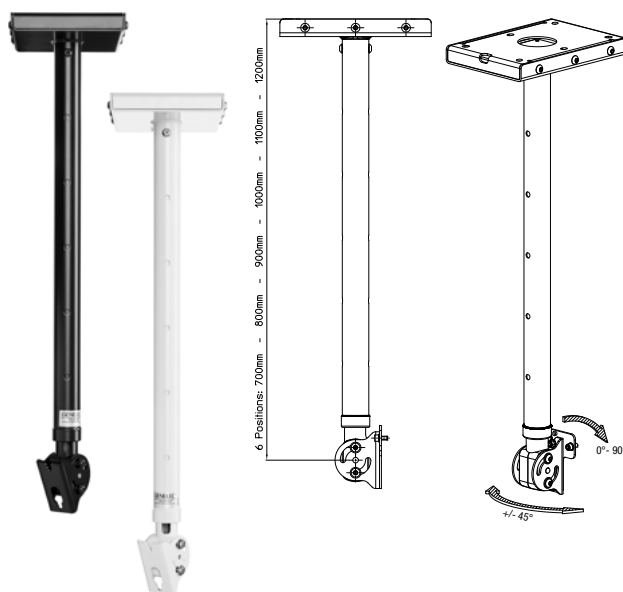

### Associated product

Needed for mounting of 8X20, 8X30,  
4X20, 4X30, G Two & G Three only.

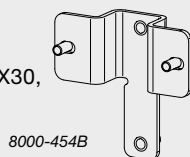

8000-454B

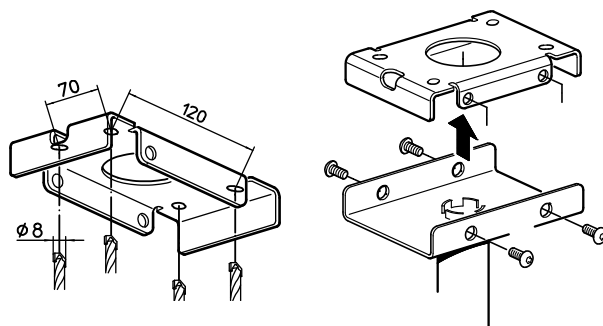

8331  
8341  
8351  
8361  
8260



## Truss mount, adjustable length

Truss mount with adjustable length. Clamp for Ø50 mm tube. Adaptable up to 8351 models.

**8000-446C** Truss mount kit, adjustable length, black (K&M 24499-021-55)

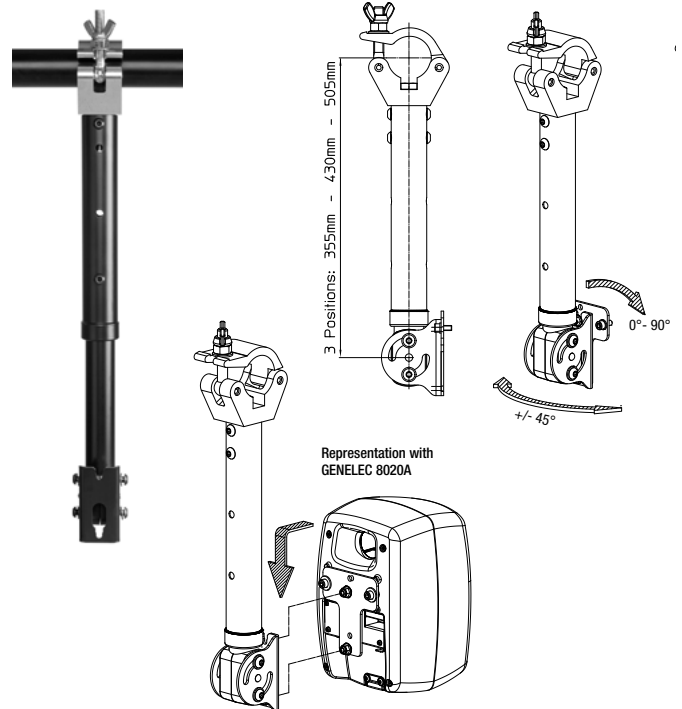

### Associated product

Needed for mounting of 8X20, 8X30, 4X20, 4X30, G Two & G Three only.

8000-454B

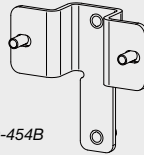

## Short truss mount

Short truss mount with clamp for Ø 50 mm tube. Adaptable for 8000 and 4000 series.

**8000-416C** Short truss mount with clamp (K&M 24493-000-55)

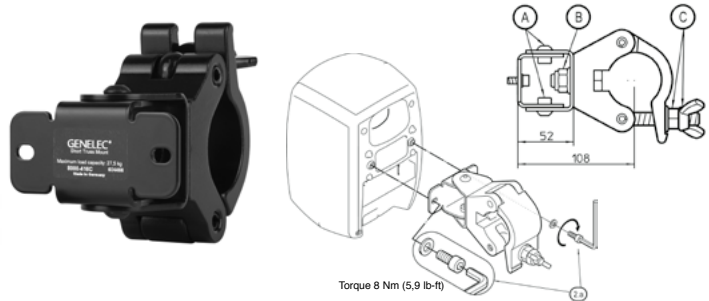

## T-adapter plate

T-adapter plate for Genelec 8320 and 8330.

**8000-454B** T-adapter plate (K&M 24452-000-55)

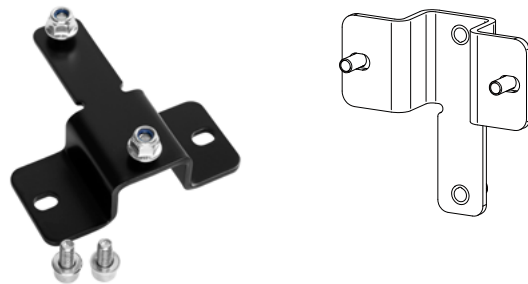

# Wall mounts

## Adjustable wall mount

Wall mounting bracket for 8000 series. Available in black and white. 8X40, 8341, 8X50 and 8351 do not need the included T-plate.

- 8000-402B** Wall mounting bracket, black (K&M 24475-017-55)  
**8000-402W** Wall mounting bracket, white (K&M 24475-017-57)

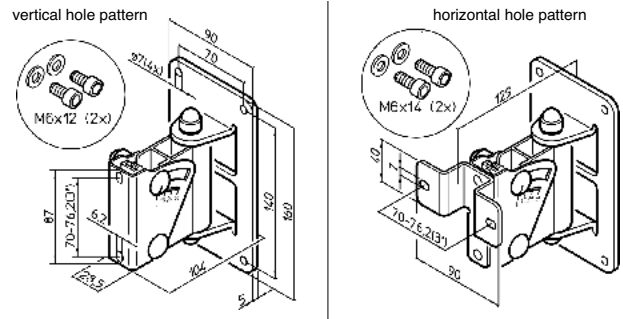

## Wall mount for S360, 8351 and 8361

Adjustable wall mount for S360, to be used with Top-Bottom bracket S360-424B. enables tilting and aiming of the loudspeaker.

- S360-444B** Wall mount for S360, 8351, 8361 (K&M 24478-018-55)

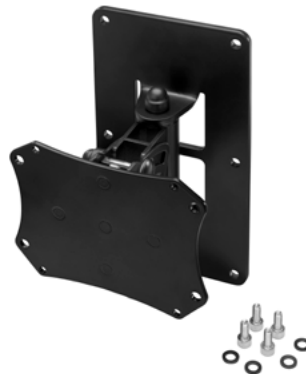

## VESA-adapter for 8000-series

Today many broadcast environments and post-production studios have changed the way of installing video monitors. Instead of using 19" rack systems such LCD / Plasma screens are now placed in so-called flat "media walls". All of them feature the international mechanical mounting system called VESA standard.

We all know pictures need to be completed with sound, and therefore we have made a simple adapter fitting Genelec 8010-8050 and 8331-8351 speakers. With this small adapter one can mount 8000 series monitors into any kind of VESA 75/100 based accessories.

- 8000-437B** VESA adapter 75/100 mm (K&M 24483-015-55)

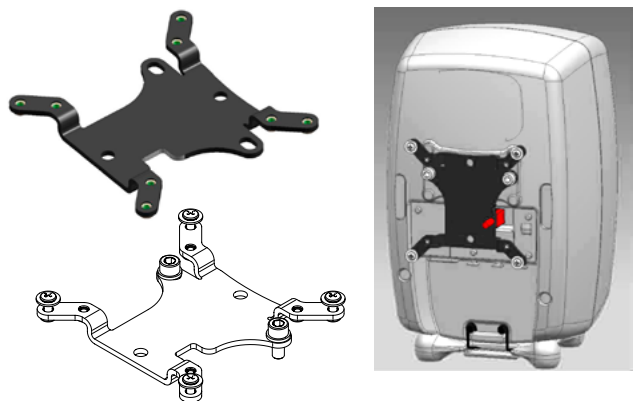

# Flush mounts

## Flush mount kit for 8000-series

Genelec Flush mount kits are designed for mounting Genelec monitors into a sturdy wall structure without changing the acoustic performance of the product. Horizontal mounting is also possible. They may not be used for any other purpose.

**8341-450B** Flush mount kit for 8040/8340/8341 (Genelec)

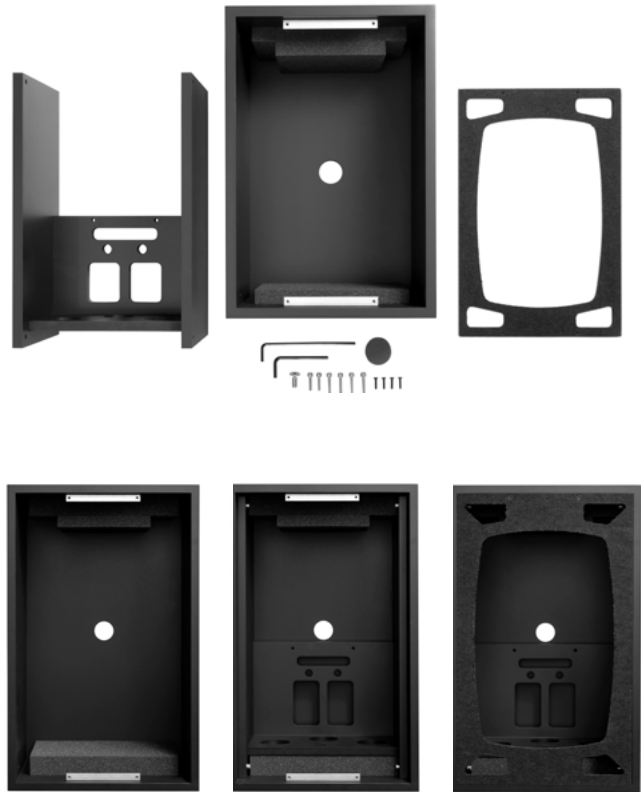
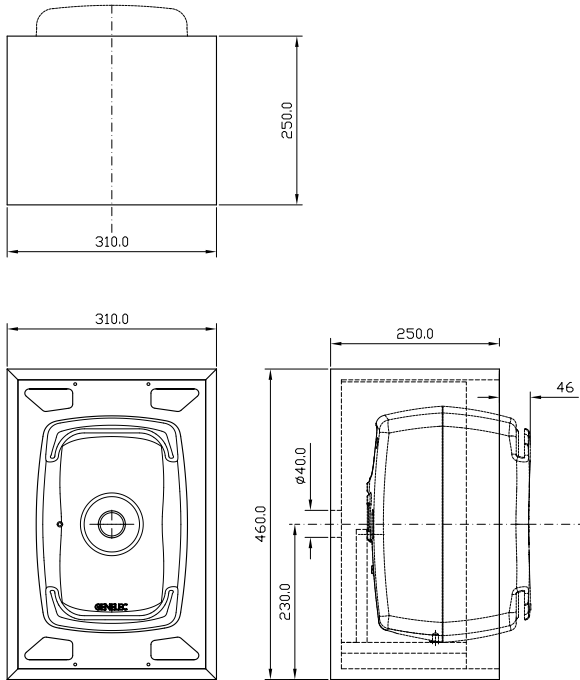

8331  
8341  
8351  
8361  
8260

## Flush mount kit for 8000-series

Genelec Flush mount kits are designed for mounting Genelec monitors into a sturdy wall structure without changing the acoustic performance of the product. Horizontal mounting is also possible. They may not be used for any other purpose.

**8351-450B** Flush mount kit for 8050/8350/8351 (Genelec)

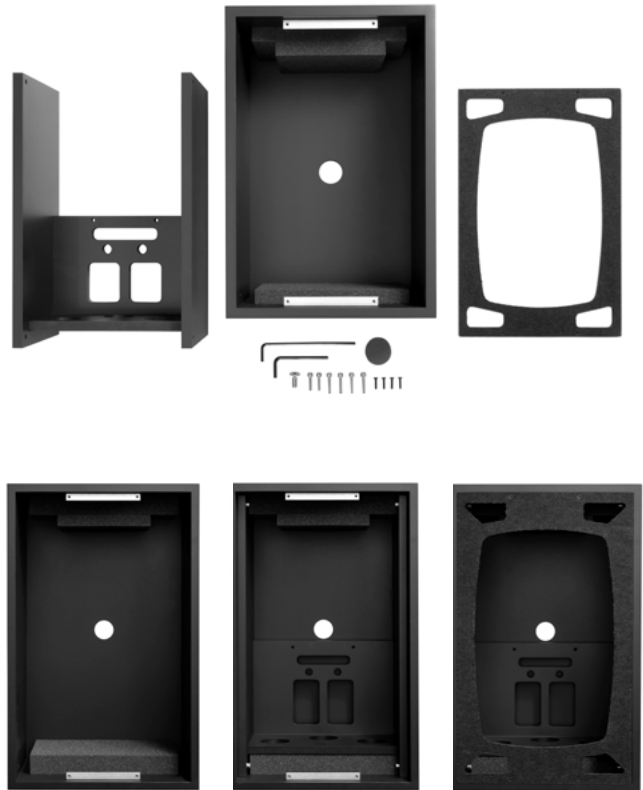
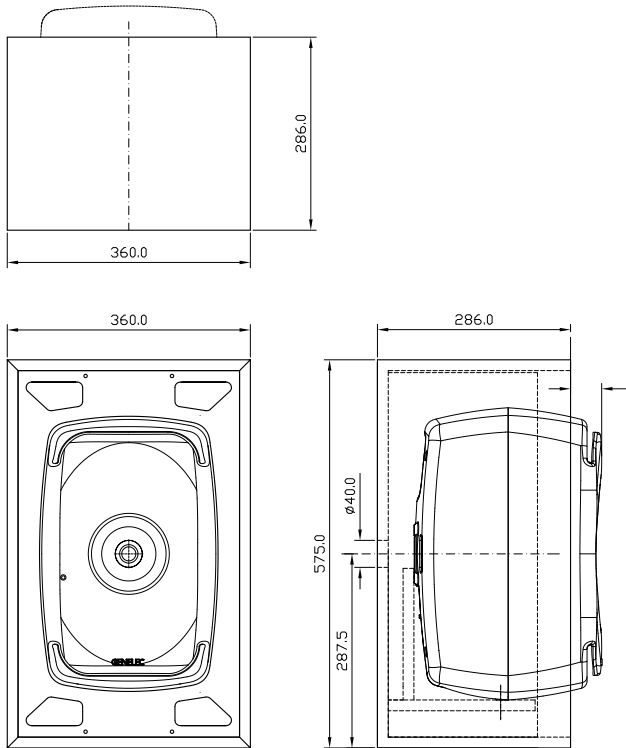

8331  
8341  
8351  
8361  
8260

# Carrying accessories

## Peli cases

Portable demo cases for easy travelling and demonstrations. Cases with room for mic stands, GLM kit, cables and more.



### Peli Case 31

Portable demo case for easy travelling and demonstrations. Case 31 has room for two 8X30/8331 plus accessories.

**8000-831** Empty case for two pcs 8X30/8331



## Peli Case 41

Portable demo case for easy travelling and demonstrations. Case 41 has room for two pcs 8X40/8341 plus accessories.

**8000-841** Empty case for two pcs 8X40/8341



## Peli Case 51

Portable demo case for easy travelling and demonstrations. Case 51 has room for one 8X50/8351 plus accessories.

**8000-851** Empty case for one pc 8X50/8351



8331  
8341  
8351  
8361  
8260

## Bags for Genelec loudspeakers

Soft transportation bags for Genelec loudspeakers.

**8050-423**      Soft carrying bag for one 8X5X (Genelec)



8331  
8341  
8351  
8361  
8260



ACCESSORIES FOR GENELEC MONITORS

S360

# Floor stands

## Floor stand for S360 and 8XXX

Genelec designed floor stand with variable height between 644 - 1044mm (650/1050mm with stand plate).

For models 8350, 8351 and G5:

Can be used with Stand plate 8051-408.

For models 8351, 8260 and 8361:

Can be used with Stand plates 8051-408 and 8260-450B.

For model S360:

Can be used with Stand plate S360-408B or with Side-Side mounting bracket S360-450B.

**S360-415B** Floor stand for S360 and 8XXX (K&M 26791-000-56)



Stand plate mounting for 8351

## Associated products



# Stand plates

## Stand plate for S360

Stand plate to be used with Genelec design floorstand S360-415B for S360. Includes mounting screws to secure to the Iso-Plate of S360.

**S360-408B** Stand plate for S360 (K&M 24458-000-56)

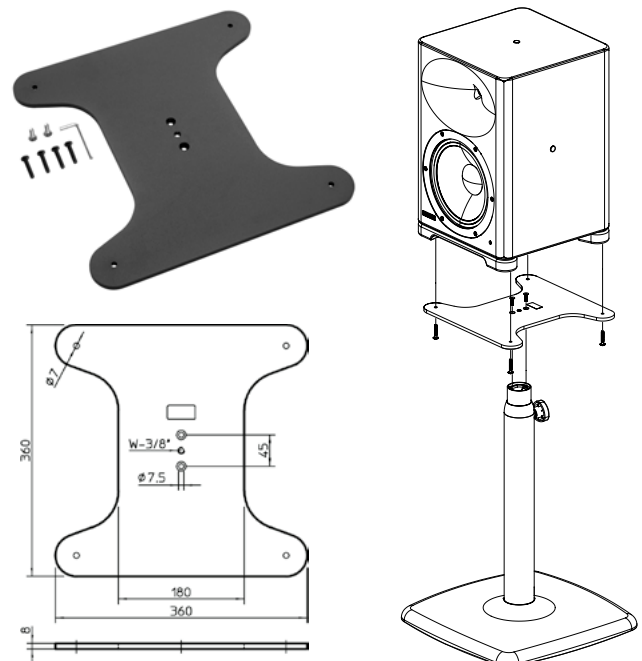

# Ceiling mounts

## Ceiling mount plate for S360 brackets

Adjustable ceiling mount plate for S360, to be used with Side-Side mounting bracket S360-450B. Enables tilting and aiming of the loudspeaker.

**S360-465B** Ceiling mount plate for S360 brackets (K&M 24459-000-56)

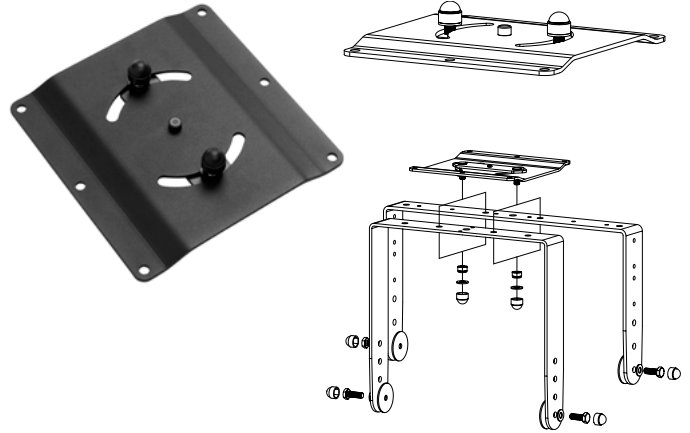

# Wall mounts

## Wall mount for S360, 8351 and 8361

Adjustable wall mount for S360, to be used with Top-Bottom bracket S360-424B. enables tilting and aiming of the loudspeaker.

**S360-444B** Wall mount for S360, 8351, 8361 (K&M 24478-018-55)

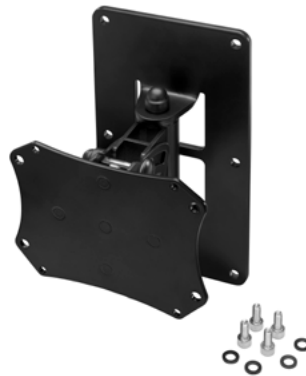

# Multipurpose mounting brackets for S360

## Side-Side bracket for S360

Multipurpose mounting bracket for S360. Can be used as stand-alone mount, with truss clamps or ceiling hang, with design floor stand S360-415B or with adjustable ceiling mount S360-465B. Supplied with M10 mounting bolts and washers.

**S360-450B** Side-Side bracket for S360 (K&M 24467-000-56)

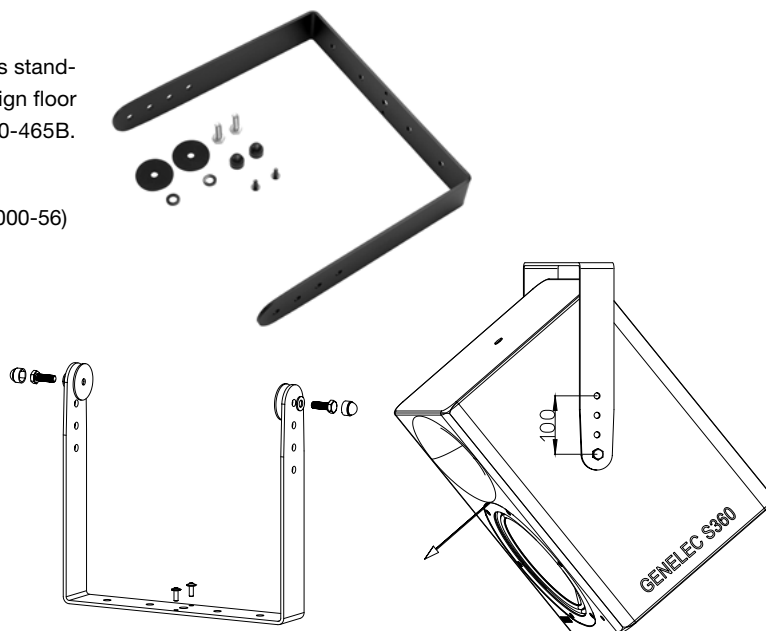

## Top-Bottom bracket for S360

Multipurpose mounting bracket for S360. Can be used as stand-alone mount, with truss clamps, with ceiling mounts 8000-442B and 8000-444B, with wall mount S360-444B or with adjustable ceiling mount S360-465B. Supplied with M10 mounting bolts and washers.

**S360-424B** Top-Bottom bracket for S360 (K&M 24468-000-56)

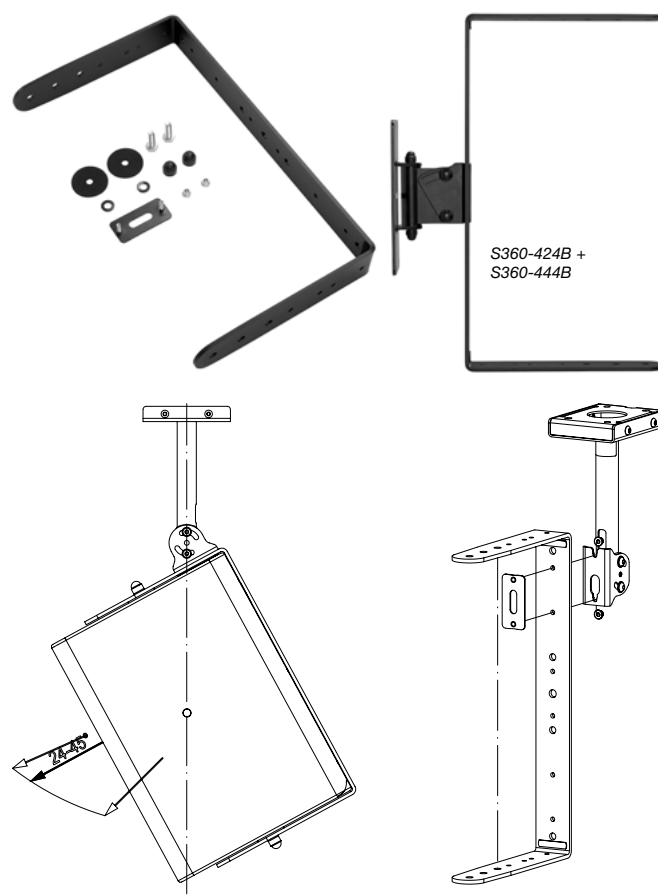

ACCESSORIES FOR GENELEC MONITORS

Other

# Floor stands

## Floor stand

Stable steel stand with a broad round cast iron base. Base diameter 450 mm. Adjustable height using clamping screw and safety pin. Mounting 3/8" thread for any Genelec stand plates, from 8020 to 8050 model. Load capacity: 35 kg. Weight: 10.6 kg. Height: 950 to 1430 mm. Packing: double cardboard packing; iron base in one and stand in the second. Suitable for all models between 8010 – 8351.

**8000-409B** Floor stand (950-1430 mm) for 1032 (K&M 26741-129-55)

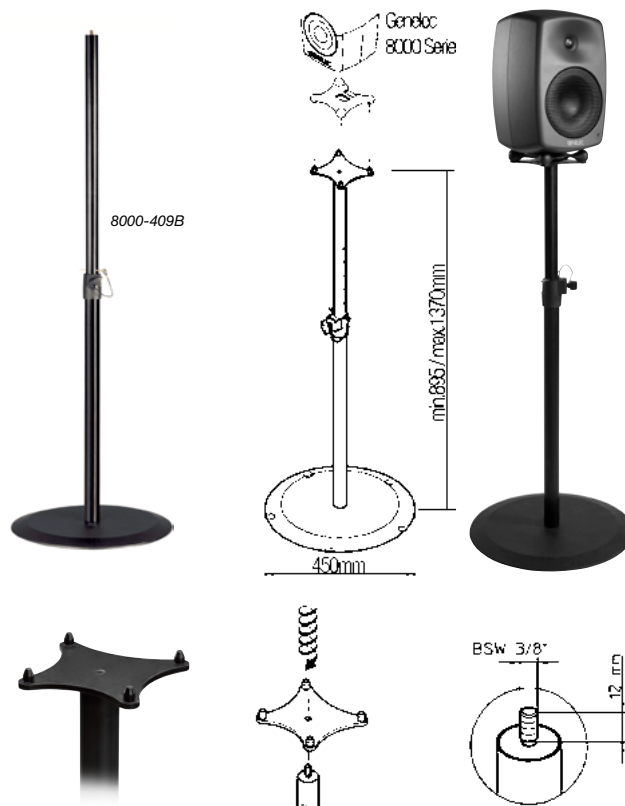

# Stand plates

## Stand plate for 1032

Stand plate for 1032 and S30D monitors. To be mounted on a stable floor stand, example 8000-409B (K&M 26741-029-55). The stand plate has a 3/8" thread insert in its centre for further stand assembly. The plate is tiltable 15° and a rear press fit bar keeps the enclosure securely fixed onto the plate.

**1032-450B** Stand plate for 1032 (K&M 24455-000-55)



1032-450B.  
1032 stand  
plate mounted  
on floor stand.

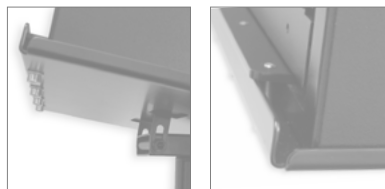
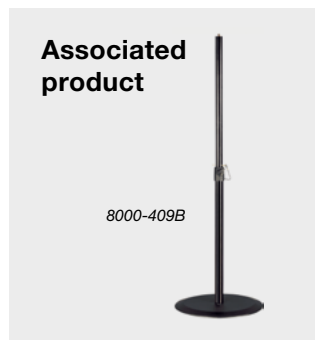
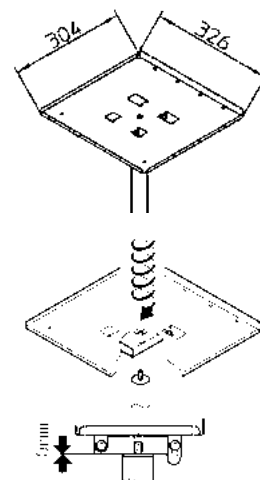

# Wall mounts

## Wall mount 1238DF

Wall mount for 1238CF and DF models.

**1038-437B** Wall mount for 1238CF (K&M 24477-000-55)

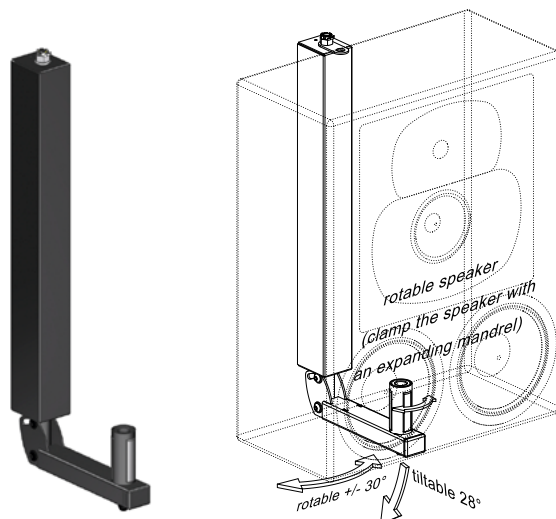

# Slatwall mounts and adapters

## Amplifier rack module for AIW26B

Up to 3 pcs Genelec RAM1-amplifiers (3U) can be rack mounted using the Genelec RM1 rack adapter (4U).

**RAM1-401** Amplifier rack module for AIW26B



## Rack adapter for AIW25 / AIC25 / 5041A

Up to 8 pcs Genelec RAM3-amplifiers (or RAM2) can be rack mounted using the Genelec RM2 rack adapter.

**RAM2-405** Rack adapter for AIW25/AIC25/5041A



# Carrying accessories

## Carrying strap

Nylon carrying strap for all 8XXX models, mounts with included M6 screws.

**8000-430** Carrying strap for one monitor inc screws





# Cables

## Installation cable

Installation friendly signal cable with shielded pair for balanced line level analog audio. Slimline white plastic jacket, sold in 100 m and 50 m reels.

**1510-888** Installation cable, 100 m reels



# Pre-construction brackets

## Pre-construction bracket for AIW26B

Galvanized steel bracket to be used for the enclosure mounting in thin wall materials.

**AIW26-001** Mounting bracket for AIW26B



## Pre-construction bracket for AIW25

Galvanized steel bracket to be used for the enclosure mounting in thin wall materials.

**272-0030** Pre-construction bracket for AIW25



## Pre-construction bracket for AIC25

Galvanized steel bracket to be used for the enclosure mounting in thin ceiling materials.

**272-0039** Pre-construction bracket for AIC25

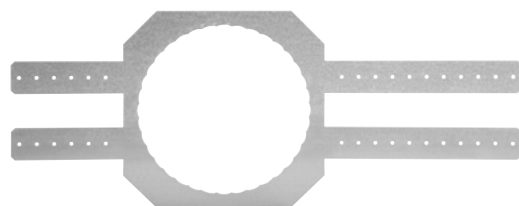

# Other products

## Grille for 1032A

Acoustically transparent fabric grille, mounts with integrated plastic studs.

**1032-409** Grille for 1032A, black

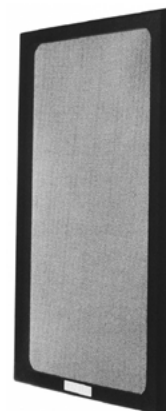

---

## Grille for 1037A

Acoustically transparent fabric grille, mounts with integrated plastic studs.

**1037-409** Grille for 1037A, black

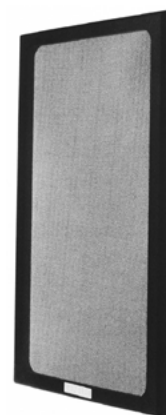

---

## Grille for 1238DF

Acoustically transparent fabric grille, mounts with integrated plastic studs.

**1238-409** Grille for 1238DF, black

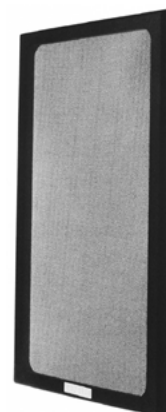

# 8000, G and 4000 series monitor models

**6010  
G One**



**8010**

**4010**

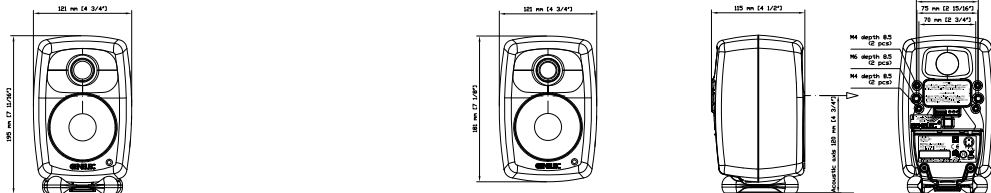

**8020  
G Two**

**4020**

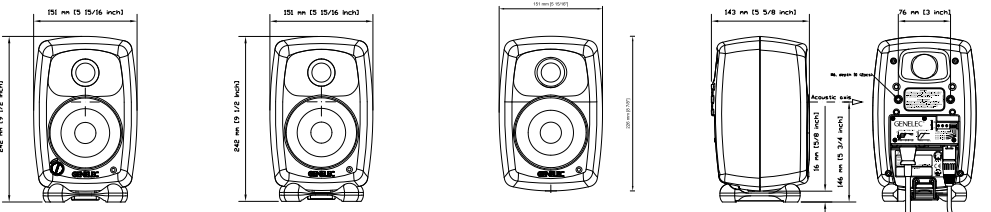

**8030  
G Three**

**4030**

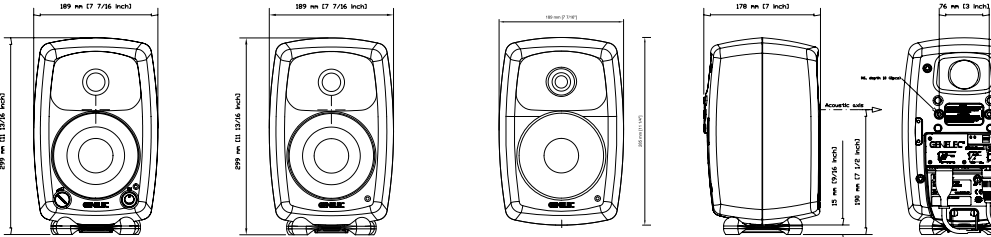

**8040  
G Four**

**4040**

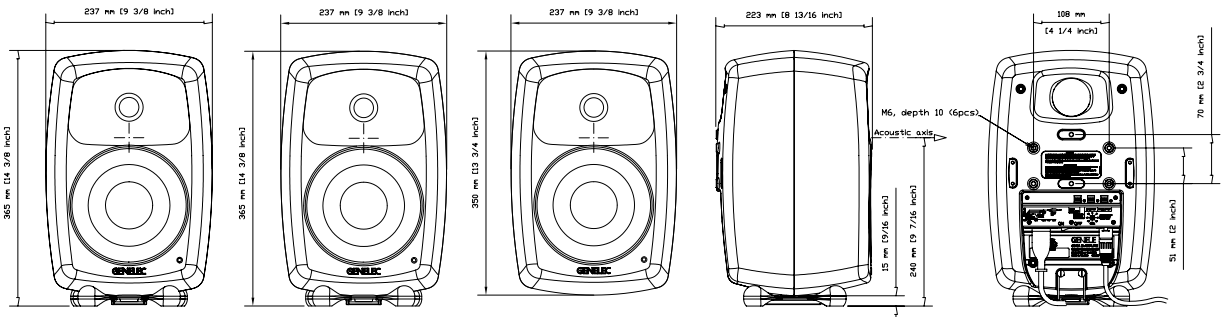

**8050  
G Five**

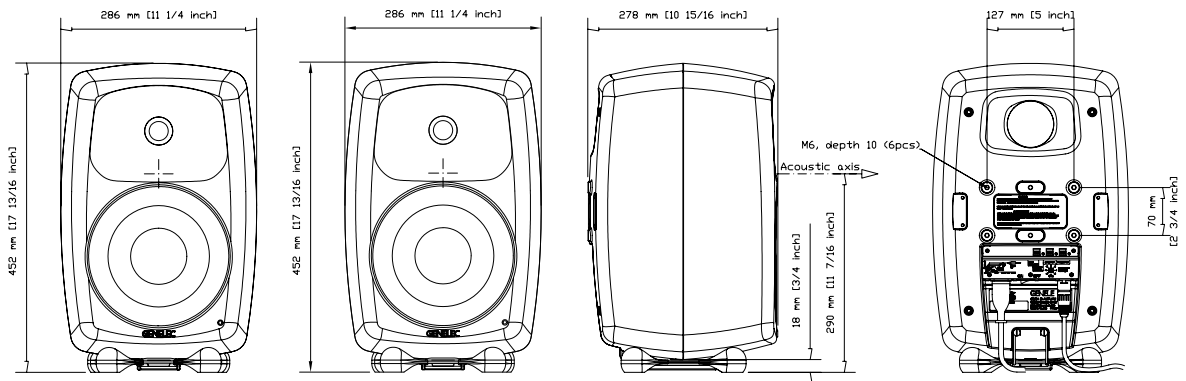

# The Ones monitor models

**8331**

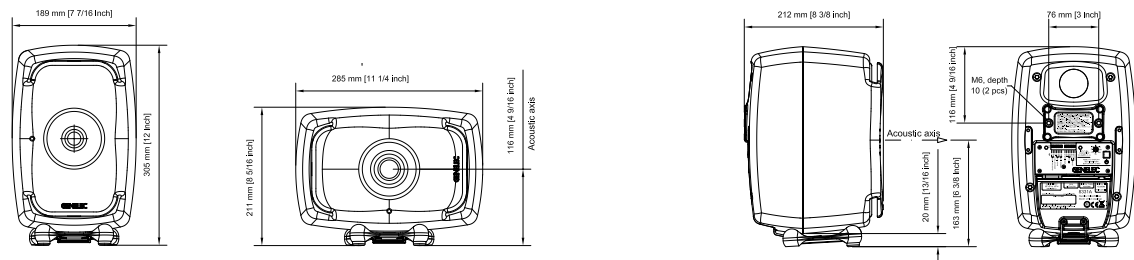

**8341**

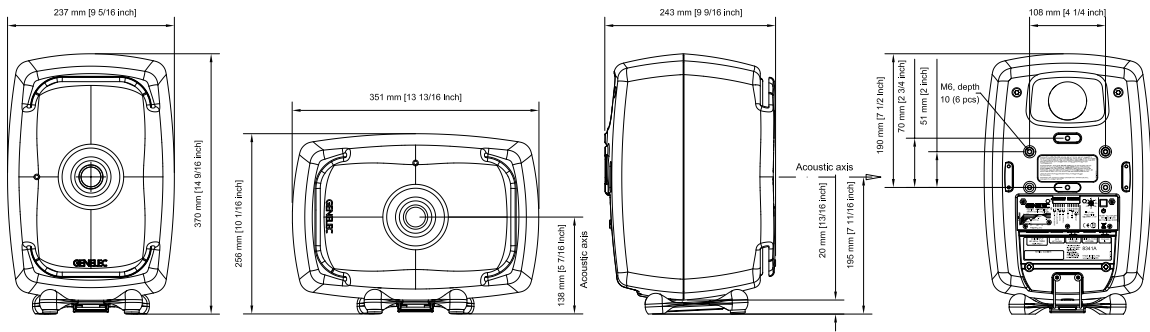

**8351**

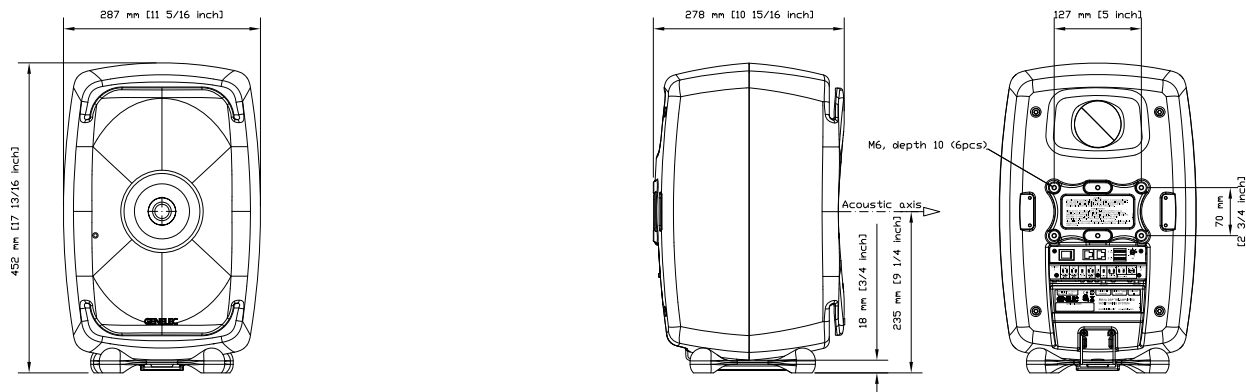

**8361**

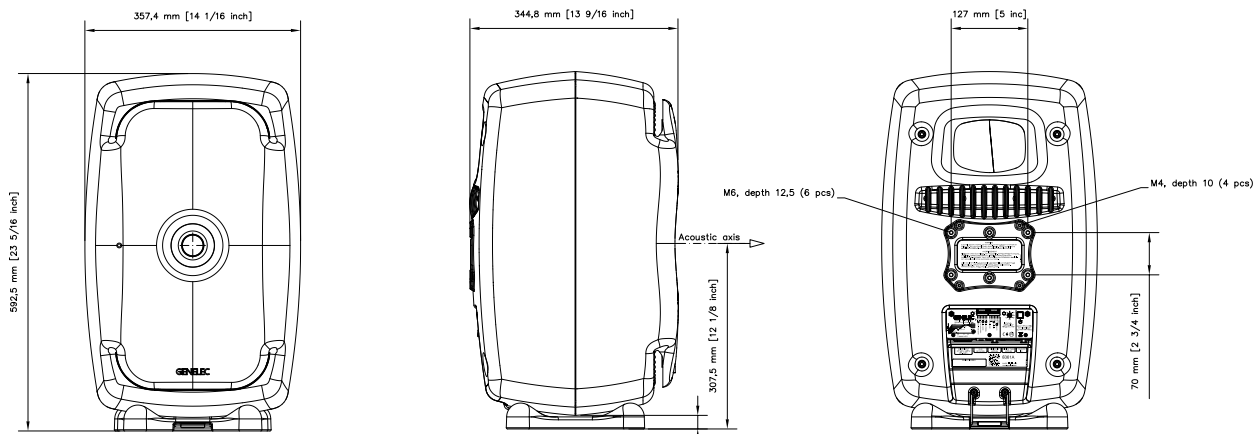



**Factory and Headquarters**

Genelec Oy  
Olivitie 5  
FI-74100 Iisalmi  
Finland  
T +358 17 83 881  
Email [genelec@genelec.com](mailto:genelec@genelec.com)

**USA**

Genelec Inc.  
7 Tech Circle  
Natick MA 01760  
USA  
T +1 508 652 0900  
Email [genelec.usa@genelec.com](mailto:genelec.usa@genelec.com)

**Sweden**

Genelec Sweden  
Ellipsvägen 10A  
SE-141 75 Kungens Kurva  
Sweden  
T +46 8 449 5220  
Email [sweden@genelec.com](mailto:sweden@genelec.com)

**China**

Beijing Genelec Audio  
Room 101, Building B33  
Universal Business Park  
No.10 Jiuxianqiao Road  
Chaoyang District  
Beijing 100015  
China  
T +86 10 5823 2014  
T +86 400 700 1978  
Email [genelec.china@genelec.com](mailto:genelec.china@genelec.com)

**Japan**

Genelec Japan Inc  
2-22-21 Akasaka  
Minato ku  
JP-107-0052 Tokyo  
Japan  
T +81 3 6441 0591  
Email [genelec.japan@genelec.com](mailto:genelec.japan@genelec.com)

**Denmark**

Genelec Denmark  
Danmarksvej 32D  
8660 Skanderborg  
Denmark  
T +45 71 741 641  
Email [denmark@genelec.com](mailto:denmark@genelec.com)

Genelec Document BBAGE045h.  
Copyright Genelec Oy 09.2019.

All data subject to change. Detailed data sheets of all Genelec models, Quick Setup Guides and other useful information can be downloaded at

[www.genelec.com](http://www.genelec.com)