

— HOME OF —
THE PGA OF AMERICA

WELCOME TO THE
HOME OF THE PGA



PGA™

ABOUT THE PGA



The Home of the PGA in Frisco, Texas, is a monument to all that's great about golf. But it's also a monument to all the people who make the sport what it is, from the nearly 28,000 PGA Members and Associates, to weekend warriors to the LPGA and PGA TOUR Professionals we watch every week.

Walk through the facility and look around, and you instantly see the preponderance of windows and natural light and the airy, creative interior design scheme. It's also evident in how the PGA of America's leaders and staff members refer to the facility.

"We call this 'Home,'" says Sandy Cross. "We don't call it 'headquarters.' This is the *Home* of the PGA of America and the *home* of PGA Professionals."

This is the first time the PGA of America's Education Center will be housed under the same roof as the rest of the organization. That includes classrooms for Associates working toward PGA Membership as well as advanced coaching facilities, like an indoor short game practice area, 11 standard and four simulated hitting bays and a practice green wired with motion-capture sensors.

The Home symbolizes the PGA of America's mission of promoting the PGA Member and growing the game. It's the culmination of years of efforts designed to make golf and the PGA as an organization as accessible as possible, and that's certainly a word you could use to describe the new PGA offices — accessible. The complex isn't the least bit stuffy; it's a place where you can pour yourself a coffee, grab a club and spend a few minutes casually hitting golf balls on the first-floor concourse.

MAP OF THE HOME OF THE PGA

LEVEL 1

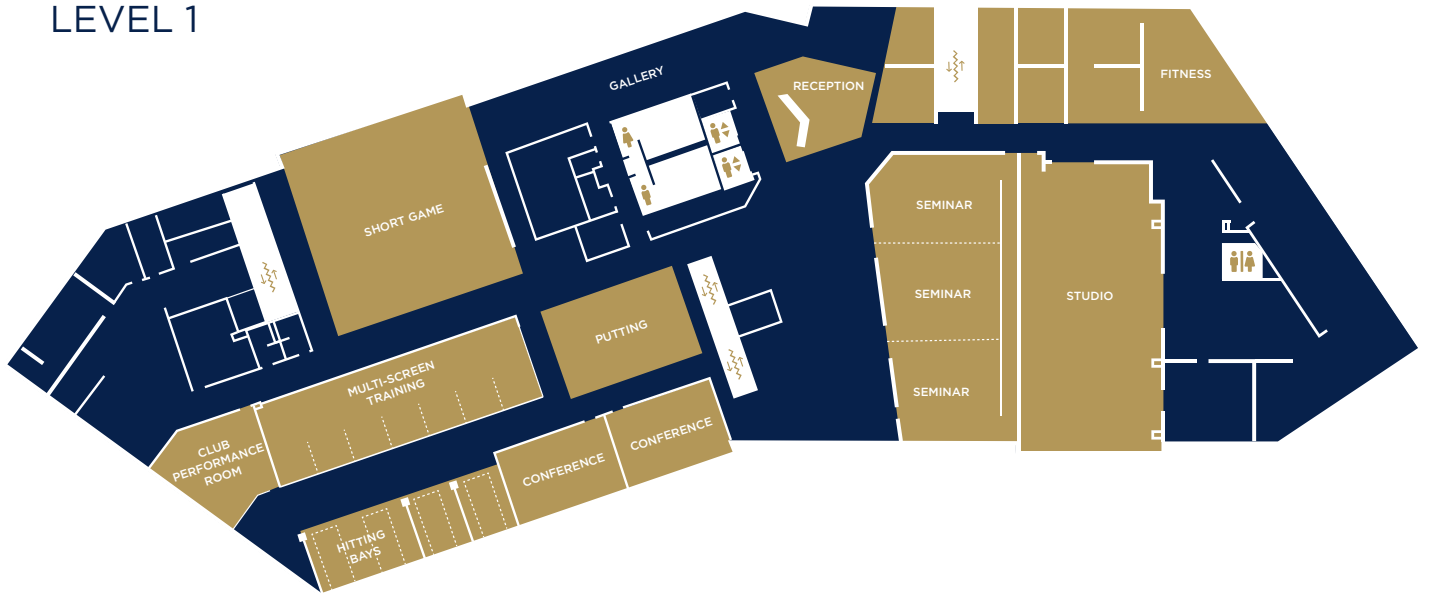

4TH FLOOR

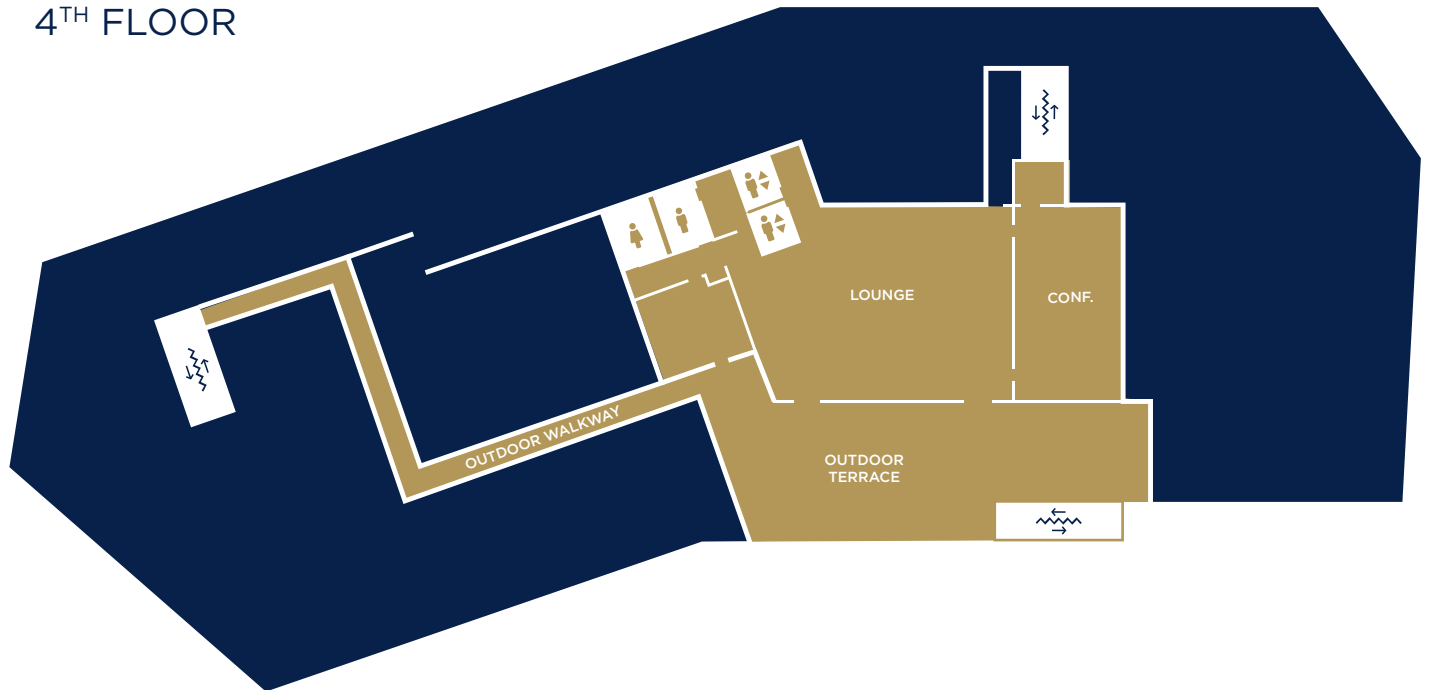

FAIRWAY/GRAND STAND



Home of the PGA grand stairway is a magnificent architectural feature that is both visually stunning and functional. The centerpiece of the stairway is the iconic "I am Golf" stairs, to pay homage to the sport that the PGA is known for.

As visitors ascend the stairs, they are treated to breathtaking views of the surrounding golf course, thanks to the venue's strategic design. Large windows line the walls, providing an unobstructed panoramic view of the landscape. The natural light flooding in from these windows creates a warm and welcoming atmosphere that is enhanced by the sleek and modern decor.

Overall, Home of the PGA grand stairway is a true showstopper that perfectly encapsulates the essence of the PGA. From the iconic i golf stairs to the picturesque views of the golf course, every detail of this architectural wonder has been carefully considered to create an unforgettable experience for guests.

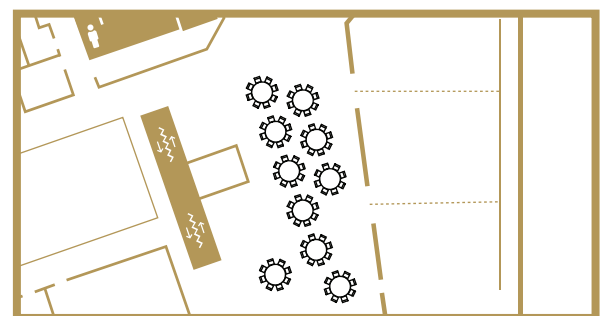
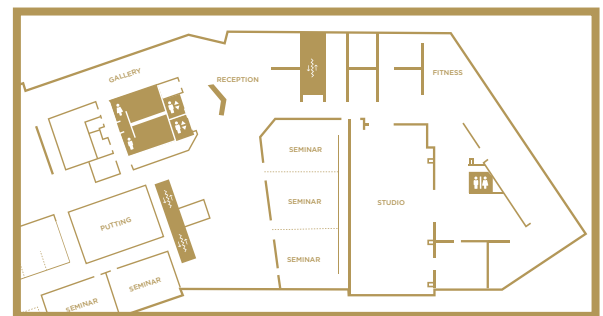

| LEVEL | FT ² | L X W (FT) | CLASSROOM | THEATER | COCKTAIL RECEPTION | BANQUET | U-SHAPE |
|-------|-----------------|------------|-----------|---------|--------------------|---------|---------|
| 1 | 2,376 | 33' x 72' | N/A | N/A | 250 | 100 | N/A |

SEMINAR ROOMS



The state-of-the-art seminar rooms are designed to offer the most advanced technology and modern amenities, providing a comfortable and productive environment for learning, training and seminars.

The seminar rooms are equipped with large high-definition displays, state-of-the-art audio systems, and advanced lighting solutions to ensure that every presentation and lecture is displayed and heard clearly, with minimal distractions.

In addition, the rooms provide access to high-speed internet, video conferencing facilities, and a range of other advanced features to facilitate effective communication and collaboration among attendees.

The ambiance of the rooms is elegant but comfortable, with soothing colors, cozy lighting, and other design elements that promote a relaxed and focused mindset.

Overall, the state-of-the-art seminar rooms at the PGA are an excellent choice for executives, professionals, and students who are looking for a modern, comfortable, and efficient venue for their seminars and meetings.

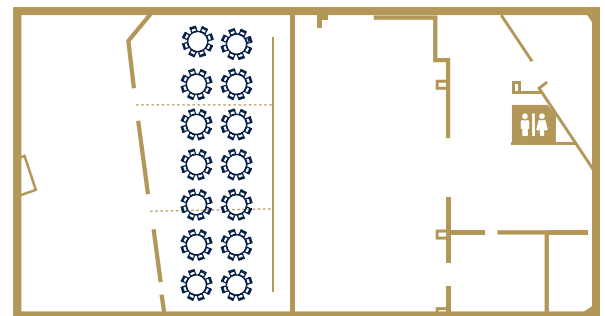
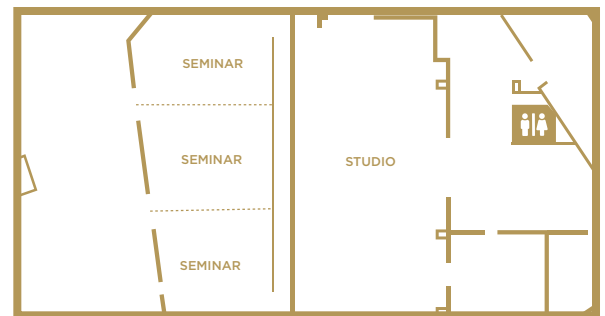

| LEVEL | FT ² | L X W (FT) | CLASSROOM | THEATER | COCKTAIL RECEPTION | BANQUET | CONFERENCE | U-SHAPE |
|-------|-----------------|------------|-----------|---------|--------------------|---------|------------|---------|
| 1 | 2,448 | 34' x 72' | 80 | 150 | N/A | 150 | 100 | 60 |

4TH FLOOR VENUE



The 4th floor event space is a stunning venue that offers a spacious indoor area and a breathtaking outdoor patio. As you walk through the doors, you are immediately struck by the sophistication and elegance of the space. The open concept design offers a lot of flexibility for seating arrangements.

One of the highlights of this event space is the stunning outdoor patio that overlooks the PGA Frisco. The patio is surrounded by lush greenery and it offers the perfect setting for a cocktail hour or an al fresco dinner, with the view of the golf course providing a beautiful backdrop.

The design of the space is modern, with clean lines and beautiful finishes. The large windows allow for abundant natural light, creating a bright and inviting atmosphere. The space is also equipped with state-of-the-art audiovisual equipment, making it an ideal venue for presentations and conferences.

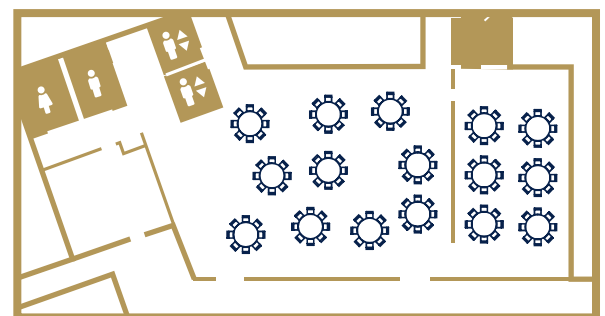
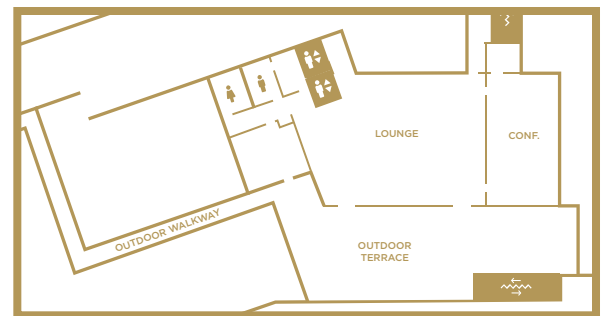

| LEVEL | FT ² | L X W (FT) | CLASSROOM | THEATER | COCKTAIL RECEPTION | BANQUET | U-SHAPE |
|-------|-----------------|------------|-----------|---------|--------------------|---------|---------|
| 1 | 3,652 | 83' x 44' | 75 | 100 | 200 | 160 | 50 |

HALL OF FAME LAWN



The lawn event space is a tranquil, open-air space ideally located for hosting unforgettable events. The lush lawns provide a refreshing and relaxing atmosphere that transports guests away from the hustle and bustle of everyday life. The venue is nestled in a scenic location. The lawn event space can accommodate small to large groups, making it the perfect setting for an intimate gathering or a grand celebration. With its breathtaking setting, exceptional scenery, and ample space, guests will enjoy an unforgettable experience at this lawn event space.

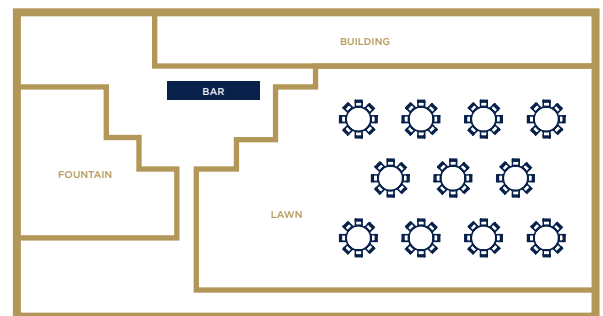
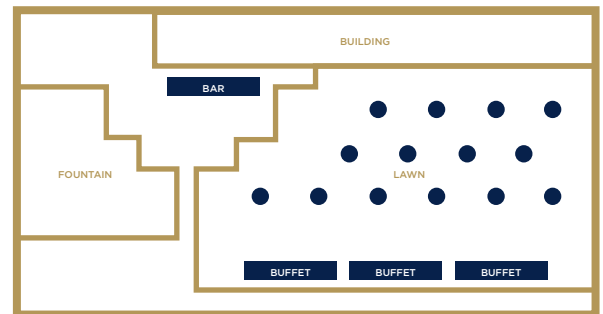

| LEVEL | CLASSROOM | THEATER | COCKTAIL RECEPTION | BANQUET | U-SHAPE |
|-------|-----------|---------|--------------------|---------|---------|
| 1 | N/A | N/A | 150 | 100 | N/A |

COACHING CENTER



Welcome to our coaching center with a breathtaking second story view! Our center is a one-of-a-kind venue that offers the perfect setting for your next dinner or networking event. Perched atop our building, the second story view showcases stunning panoramic views of the golf course and surrounding area, creating a picturesque and unforgettable backdrop for any occasion.

This space provides the perfect balance between comfort and elegance. You'll feel at ease in our cozy indoor dining area, complete with spacious seating arrangements and charming decor.

At the same time, you'll experience the beauty of the outdoors with our large open air doors to the golf course. Here, you can soak up the sunshine or enjoy the crisp evening breeze while mingling with guests and taking in the stunning views.

Our coaching center is the ideal venue for any event, from intimate, private dinners to networking receptions. Experience the beauty and elegance of our coaching center with its second story view - a venue unlike any other that will create lasting memories for you and your guests.

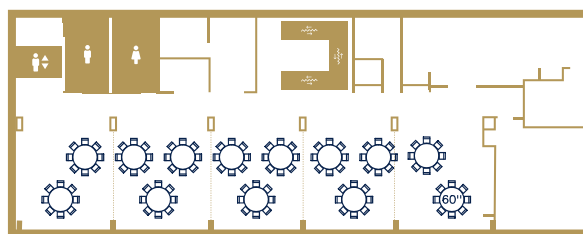
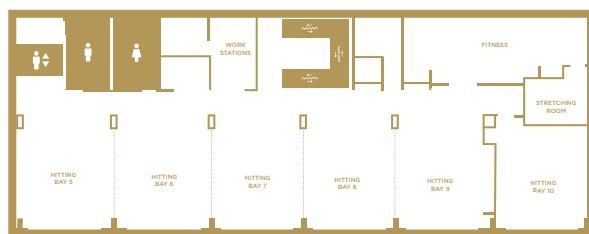

| LEVEL | FT ² | L X W (FT) | CLASSROOM | THEATER | COCKTAIL RECEPTION | BANQUET | U-SHAPE |
|-------|-----------------|------------|-----------|---------|--------------------|---------|---------|
| 1 | 90 | 18' x 5' | N/A | N/A | 175 | 130 | N/A |

PGA HOUSE RULES



ACCESS

- Building usage requests must be submitted at least 60 days in advance. Please allow 7-10 business days for internal review and approval.
- Clients must designate an on-site representative who will be in contact with the PGA as needed. Clients must:
 - Provide greeters and guest check-ins
 - Provide guest lists in advance
 - Manage badging
 - Supervise movement in the building
- All guests must register at the front desk and wear their badges at all times.
- All large equipment, crates, or catering movements must be directed to use the shipping & receiving dock.
- Access to Levels 2 & 3 is strictly prohibited.

GENERAL RULES

- *Purpose:* Client must use Home of the PGA only for the purpose of hosting its meeting or event and for no other purpose.
- *PGA Rules/Standards:* Client must follow all PGA rules and workplace standards communicated to Client by PGA.
- *Signage:* No decorative or other materials shall be nailed, tacked, screwed or otherwise physically attached to any part of the facility/property without prior authorization from the PGA of America events staff. All decorations must be placed and removed without leaving damage.
- *Fire/Fireworks:* No sparklers, open flames, candles, or grills of any kind are permitted without explicit approval by the PGA.
- *No Firearms:* Firearms and weapons are prohibited at Home of the PGA.
- *Animals:* No pets allowed in the building except service animals.
- *Chipping Area:* No food, or drink in the chipping area. No pointy shoes or tripods with pointed feet, especially in the bunker area as it has weight bearing issues.
- *Noise Level:* During the event, no amplified music may be played on the patios after 10pm. Acoustic music ONLY is permitted but must conclude at 11pm with respect to City of Frisco noise ordinances.
- *Minors:* Children younger than 18 must be accompanied by an adult at all times.



SPECIAL PROVISIONS

- *Food & Beverage:* Clients must use a PGA-approved caterer. Selling or purchasing of alcoholic beverages is prohibited. All alcoholic beverages must be served through a licensed bartender/caterer. Alcohol may not be served to minors.
- *Procedure on leaving:* All events must end by 11:00 pm to comply with the City sound ordinances and to allow for clean-up and closure of the site by 11:00pm. Clients are responsible for restoring the property back to its original condition at the conclusion of their meeting or event.
- *Trash Removal:* Clients are responsible for ensuring that all trash, recycling, and other debris are placed in appropriate refuse containers during and after the event.
- *Parking:* The parking lot entrance is accessible from PGA Parkway. 225 surface spots are available on a first-come, first-serve basis. There are four accessible parking spaces near the main entrance.
- *Smoking:* To promote good health, remain in accordance with state or local regulations, and improve indoor air quality, the building shall be entirely smoke-free. That includes the use of all tobacco and smoking products, including chewing tobacco, pipes, cigars, and e-cigarettes. There is no smoking within 50 feet of any buildings, in company parking lots, or in outdoor areas surrounding the company.
- *Photography/Filming:* Any individual or organization wanting to engage in photography or filming for broadcast, public dissemination, or commercial usage of any type needs advance permission from the PGA.



PGA OF AMERICA
HOME OF THE PGA
1916 PGA PARKWAY
FRISCO, TX 75033



PGA™