

CITYLABS

Changing the skyline. Changing your health. Changing lives.

A development by
bruntwood
SciTech

for
 **MSP** MANCHESTER
SCIENCE
PARTNERSHIPS

Manchester University
NHS Foundation Trust

An aerial photograph of a city, likely Manchester, showing a dense urban landscape with various buildings, including residential houses and commercial structures. A large, semi-transparent dark rectangle is overlaid on the left side of the image, containing white text. The text is arranged in three lines: a large headline, a subtitle, and a line of smaller text. The headline is in a large, bold, sans-serif font. The subtitle is in a smaller, regular, sans-serif font. The line of smaller text is in an even smaller, regular, sans-serif font. The background image shows a mix of old and new architecture, with a prominent bridge in the lower right corner.

A world-leading campus for health innovation, precision medicine and data analytical businesses.

Creating stronger relationships between the NHS, academia and industry

OXFORD ROAD CORRIDOR
ENABLING STRATEGIC PARTNERSHIPS

“The Manchester Oxford Road Corridor has the good buildings, the cultural offer, the sector and the cluster legacies that are evolving. You couldn’t dream up what’s happening here. Manchester is taking collaboration to another level.”

BRUCE KATZ
BROOKINGS INSTITUTION, WASHINGTON DC



**LARGEST CLINICAL
ACADEMIC CAMPUS
IN EUROPE** **£3.6BN GVA | £5.6BN BY 2025** **74,000
STUDENTS**
20% Of Manchester's GVA

**£51
MILLION**
UK research funding in medical
and biological sciences 2015-18

£6 BILLION
Devolved health and care system
Home to UK's only IoT city demonstrator project -
CITYVERVE

15,000+
Research participants across
635 research studies 2016-18

**6,500
CLINICIANS**

HOME TO
50%
of life sciences businesses
in Manchester

**13,000
JOBS** In hospitals, medical
and dental practices
**42,000
RESIDENTS**

MMU degree apprenticeship programme
has successfully delivered over
**1,100 APPRENTICESHIPS
WITH 220 EMPLOYER
PARTNERS**

**8,800
BUSINESSES** **79,000
WORKERS**
104,000 FTE jobs by 2025

54%
of all apprenticeship placements in Manchester

**Physically
Connected**



PHYSICALLY CONNECTED

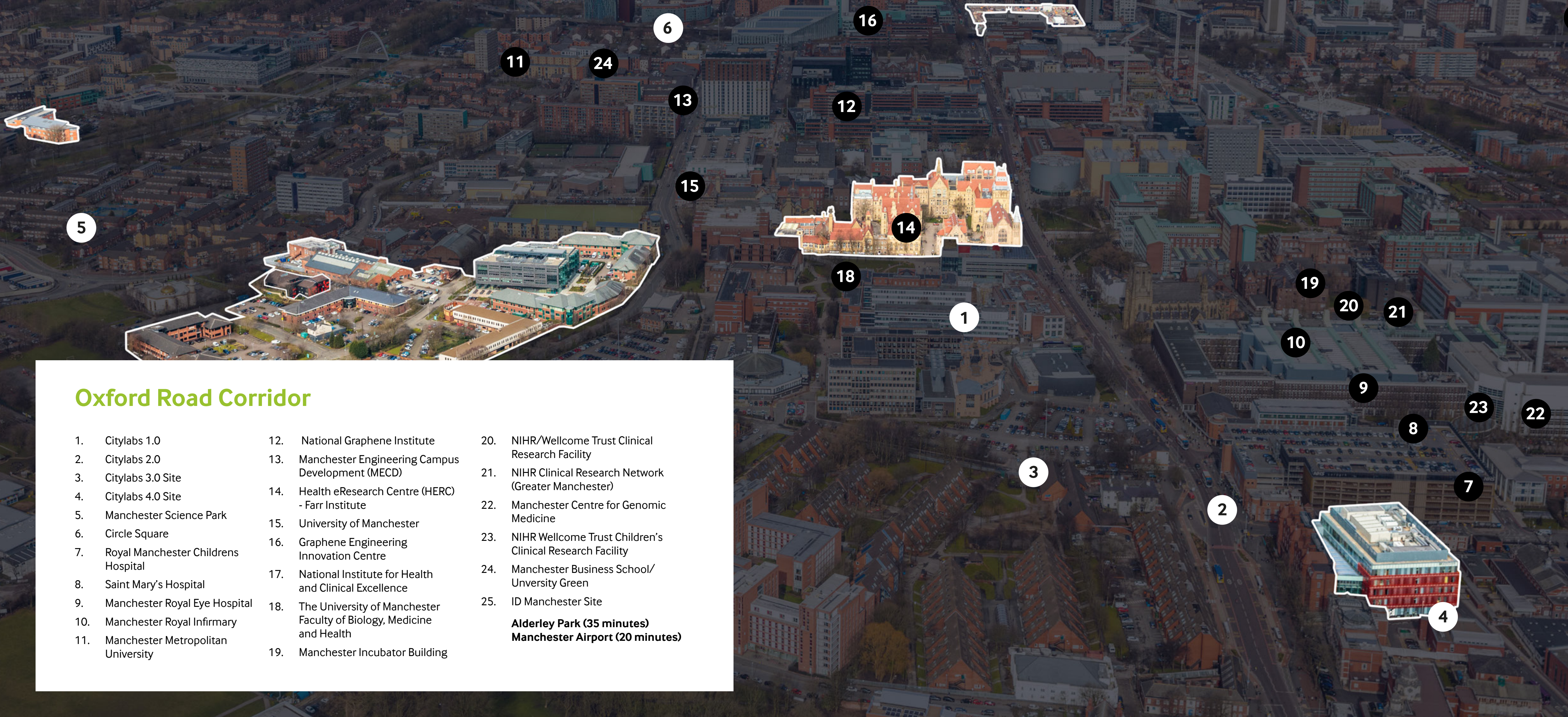

Oxford Road Corridor

- | | | |
|--|--|---|
| 1. Citylabs 1.0 | 12. National Graphene Institute | 20. NIHR/Wellcome Trust Clinical Research Facility |
| 2. Citylabs 2.0 | 13. Manchester Engineering Campus Development (MECD) | 21. NIHR Clinical Research Network (Greater Manchester) |
| 3. Citylabs 3.0 Site | 14. Health eResearch Centre (HERC) - Farr Institute | 22. Manchester Centre for Genomic Medicine |
| 4. Citylabs 4.0 Site | 15. University of Manchester | 23. NIHR Wellcome Trust Children's Clinical Research Facility |
| 5. Manchester Science Park | 16. Graphene Engineering Innovation Centre | 24. Manchester Business School/ University Green |
| 6. Circle Square | 17. National Institute for Health and Clinical Excellence | 25. ID Manchester Site |
| 7. Royal Manchester Childrens Hospital | 18. The University of Manchester Faculty of Biology, Medicine and Health | |
| 8. Saint Mary's Hospital | 19. Manchester Incubator Building | |
| 9. Manchester Royal Eye Hospital | | |
| 10. Manchester Royal Infirmary | | |
| 11. Manchester Metropolitan University | | |

Alderley Park (35 minutes)
Manchester Airport (20 minutes)

CONNECTED HUB

 Direct connections to all major rail and Metrolink connections

 2 hours by train to London

 20 minutes by car to Manchester Airport

Number of passengers per annum

Manchester Piccadilly
24.5 million passengers per year

Manchester Oxford Road
8 million passengers per year

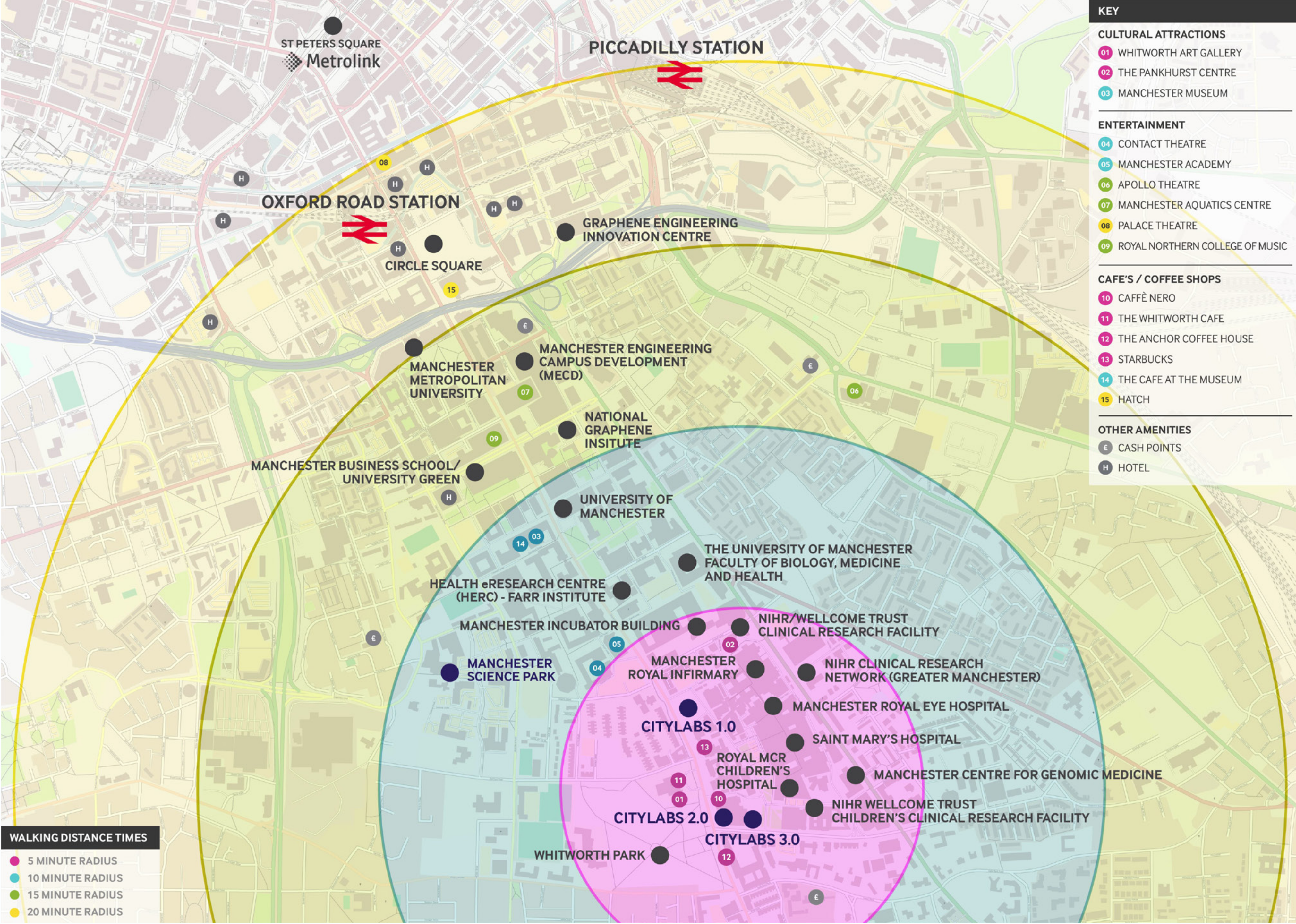



**A unique city;
a unique opportunity**

A UNIQUE CITY; A UNIQUE OPPORTUNITY

“The Greater Manchester Local Industrial Strategy builds on the existing strengths and great opportunities for the city-region. It is based on extensive discussions, consultations and inputs, and presents an exciting strategy for the future success of Greater Manchester, and national and international prosperity.”

Professor Dame Nancy Rothwell,
President and Vice Chancellor,
University of Manchester

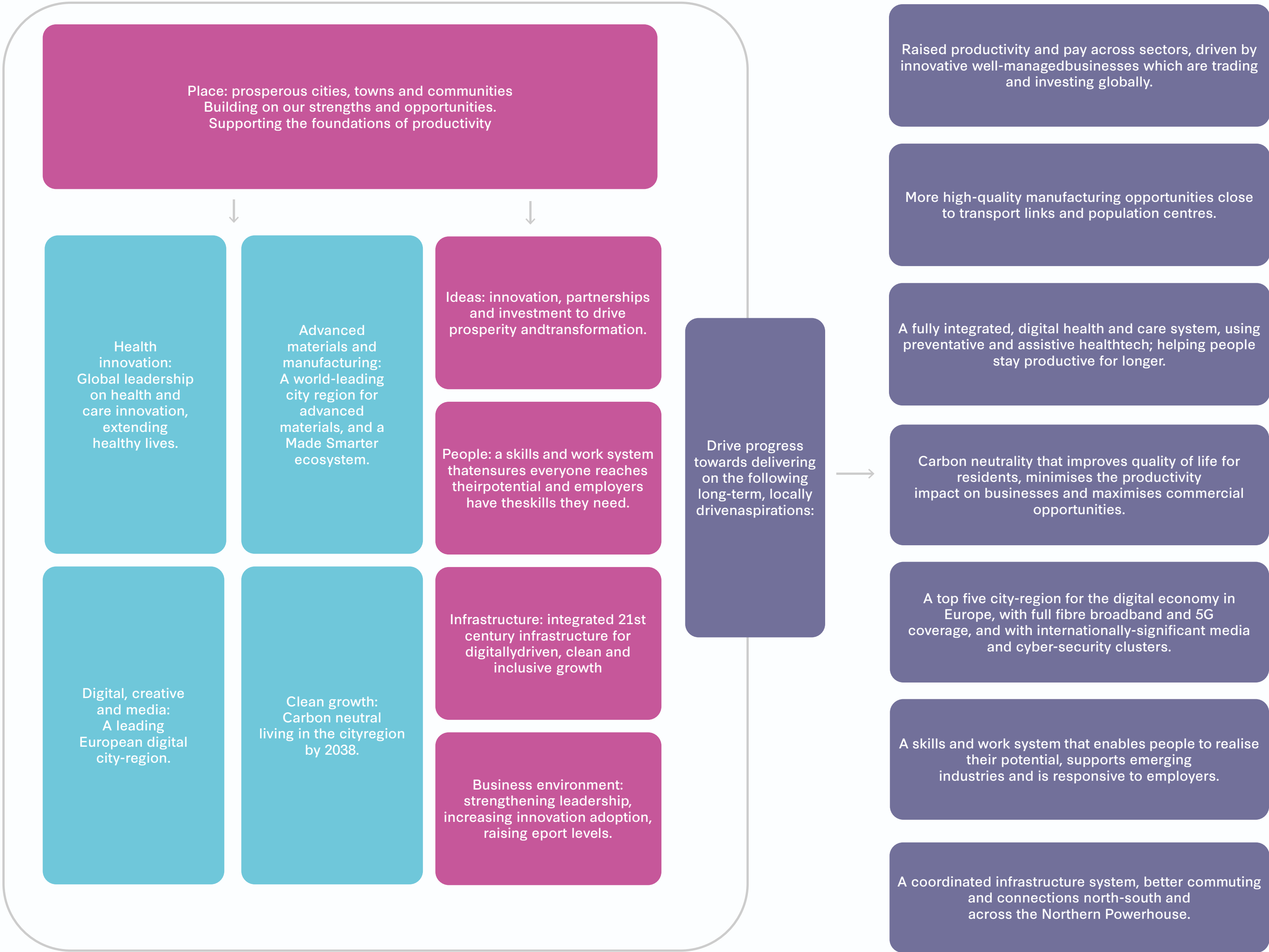
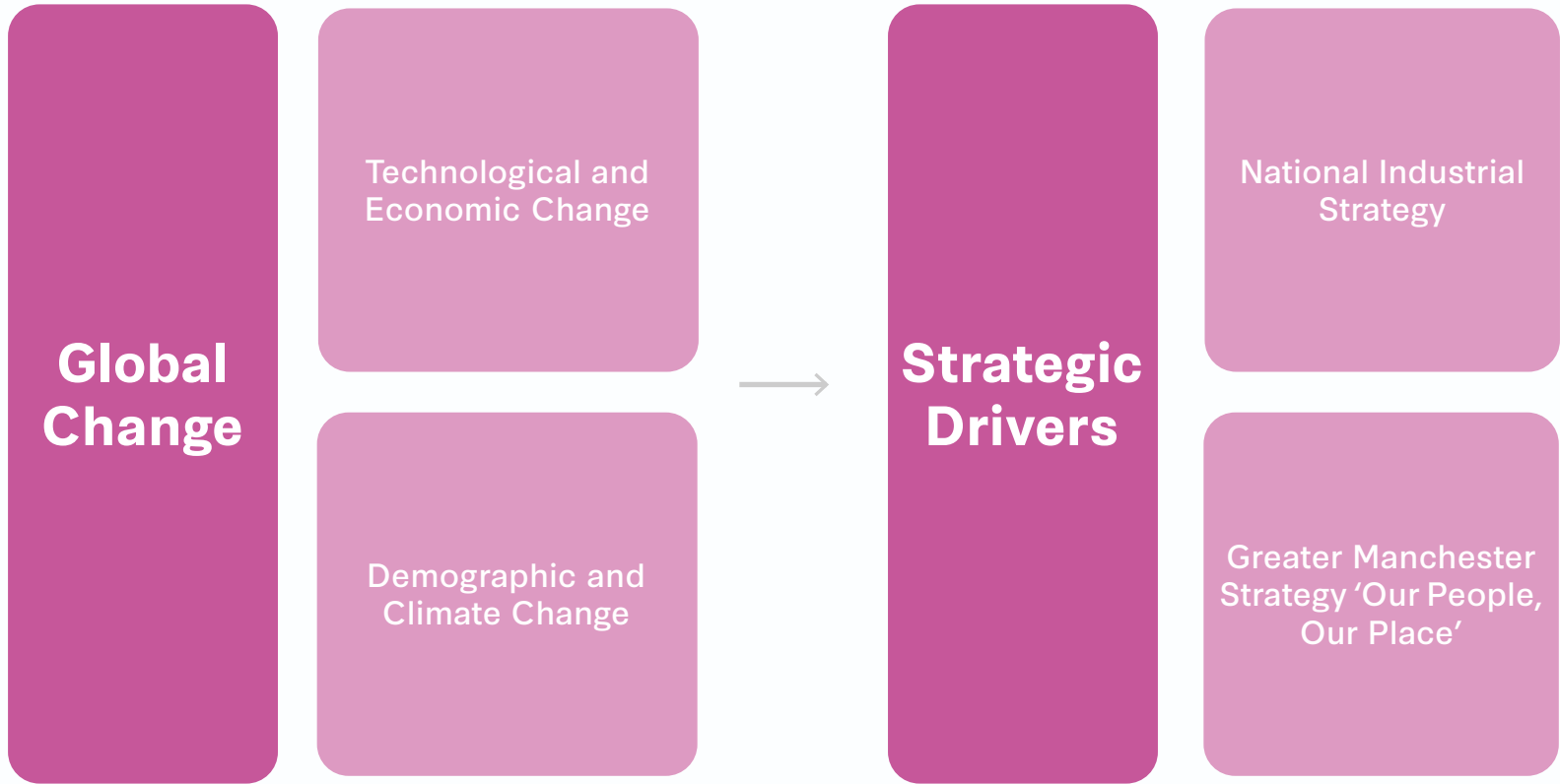

A UNIQUE CITY; A UNIQUE OPPORTUNITY

HEALTH INNOVATION MANCHESTER - DISCOVER. DEVELOP. DEPLOY

1

Deliver the full spectrum of programmes and projects agreed by the national AHSN network and the HInM Innovation and Prioritisation and Monitoring Committee (IPMC).

2

Deliver the local programmes and projects agreed by the HInM Research and Education Board.

3

Work across the system to develop blue prints for reliable implementation of innovation.

4

Introduce an effective method of board assurance giving visibility on current delivery of the agreed innovation programmes and projects.

5

Develop and deliver an enhanced operating model to deliver the functions defined in the business plan.

6

Clearly articulate the value proposition of HInM and promote the assets of Greater Manchester both nationally and internationally.

7

Further cement existing industry partnerships and develop an agreed HInM industry strategy, with clear outcomes.

8

Strengthen academic partnerships through the development of an Academic Partnerships strategy, with clear outcomes.

9

Work closely with the Greater Manchester Health and Social Care Partnership to deliver benefits from existing and future investment in the digital interoperability hub.

10

Deliver a compelling vision for the digital innovation hub, ensuring system-wide buy-in and secure necessary funding.

**The only development
of its kind in the UK**

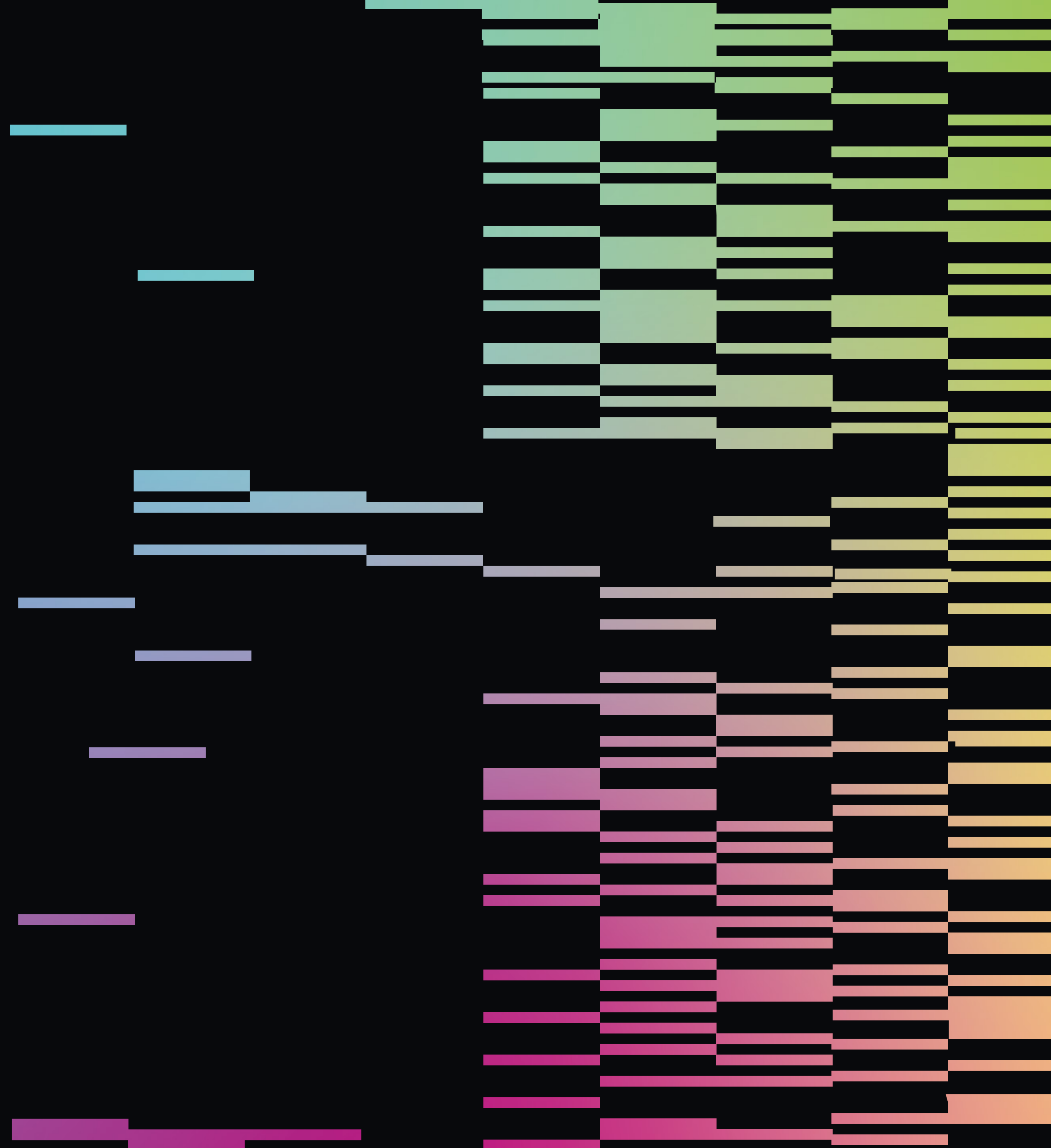

THE ONLY DEVELOPMENT
OF ITS KIND IN THE UK

CITYLABS 1.0

MANCHESTER ROYAL
INFIRMARY

MANCHESTER ROYAL
EYE HOSPITAL

ST MARY'S
HOSPITAL

ROYAL MANCHESTER
CHILDREN'S HOSPITAL

RONALD MCDONALD
HOUSE

MFT HEADQUARTERS

CITYLABS 2.0 & 3.0

OLD ST MARY'S
HOSPITAL

CITYLABS 4.0 SITE

THE ONLY DEVELOPMENT
OF ITS KIND IN THE UK



A **Joint Venture partnership** between Manchester Science Partnerships (MSP) and Manchester University NHS Foundation Trust (MFT) - the UK's largest NHS Trust

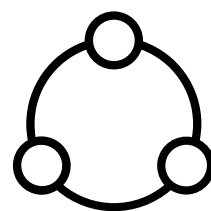

Brings together and accelerates collaboration between the NHS, scientific and academic communities and industry on the largest clinical academic campus in Europe and in the heart of Manchester's Innovation District - the Oxford Road Corridor



Provides opportunities for health and medical technology businesses to grow and co-create new health products in collaboration with the NHS and academia

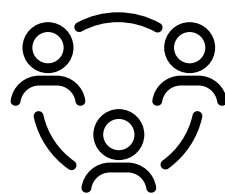

Access to MSP's wider community of 300 life sciences and tech businesses and Bruntwood SciTech's +600 community across Manchester, Cheshire, Leeds and Birmingham



A unique pathway to partnership - direct access to MFT clinicians, resources and patients. Current Citylabs customers are connected into MFT through working on joint clinical trials (Mac Clinical Research) and sample supply (Takagi Europe)

+3m

Opportunity to reach +3m population of Greater Manchester

20+

Current cluster of 20+ diagnostics, medtech, digital health and genomics businesses in Citylabs 1.0



Future home to global diagnostics company QIAGEN and their European Centre of Excellence for Precision Medicine in Citylabs 2.0

£95m

Undergoing £95m expansion to create Citylabs 2.0, 3.0 & 4.0

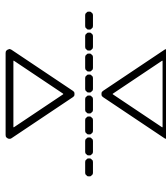

Strategically aligned with the NHS' 'Innovation, Health and Wealth' agenda



Direct access to Health Innovation Manchester; Manchester's single umbrella health science and innovation system

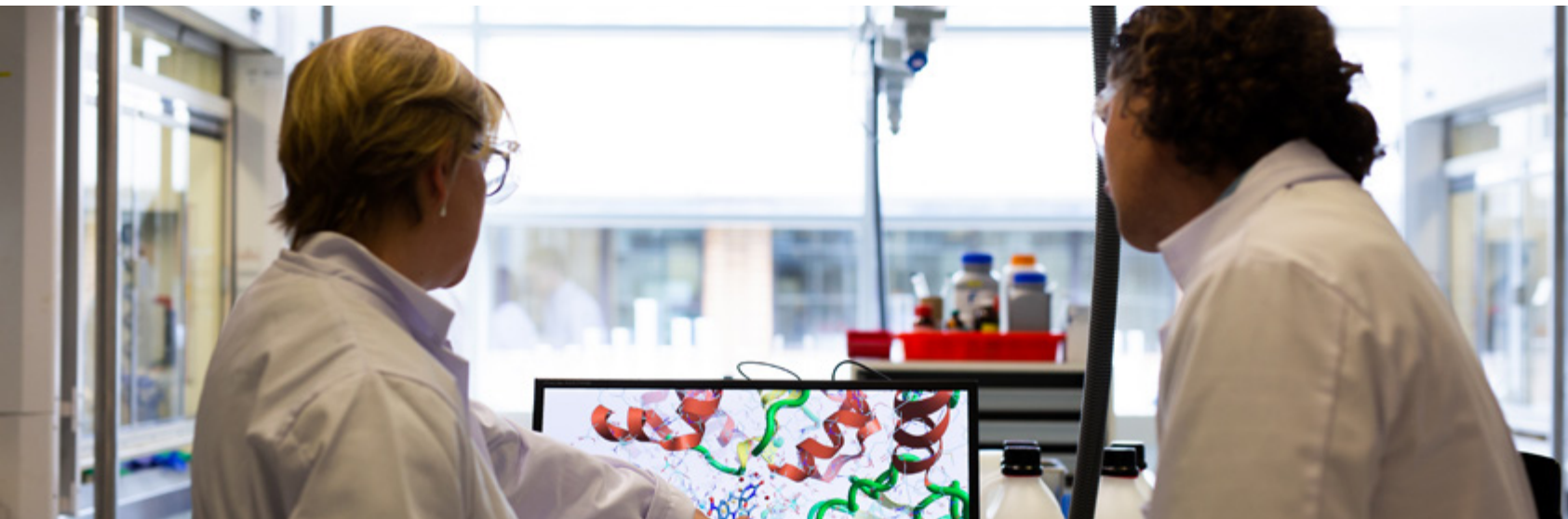

Our Partner Network



OUR PARTNER NETWORK

ACCESS TO FINANCE AND FUNDING

£32m Greater Manchester and Cheshire Life Science
Investment Fund, with £50m Fund 2 in development

£15bn
Investor Ladder

Investor
Showcase

Investor
Network

OUR PARTNER NETWORK

ACCESS TO SKILLS AND TALENT

University of Manchester top
5 UK university for spin-outs;
350+ incorporations per year

20,000 STEM
graduates per annum

Talent sourcing through
specialist partner recruitment

Access DigitalHer and
TechSheCan to support
future STEM talent

OUR PARTNER NETWORK

ACCESS TO UNIVERSITIES, NHS & LOCAL GOVERNMENT

**In Good
Company**

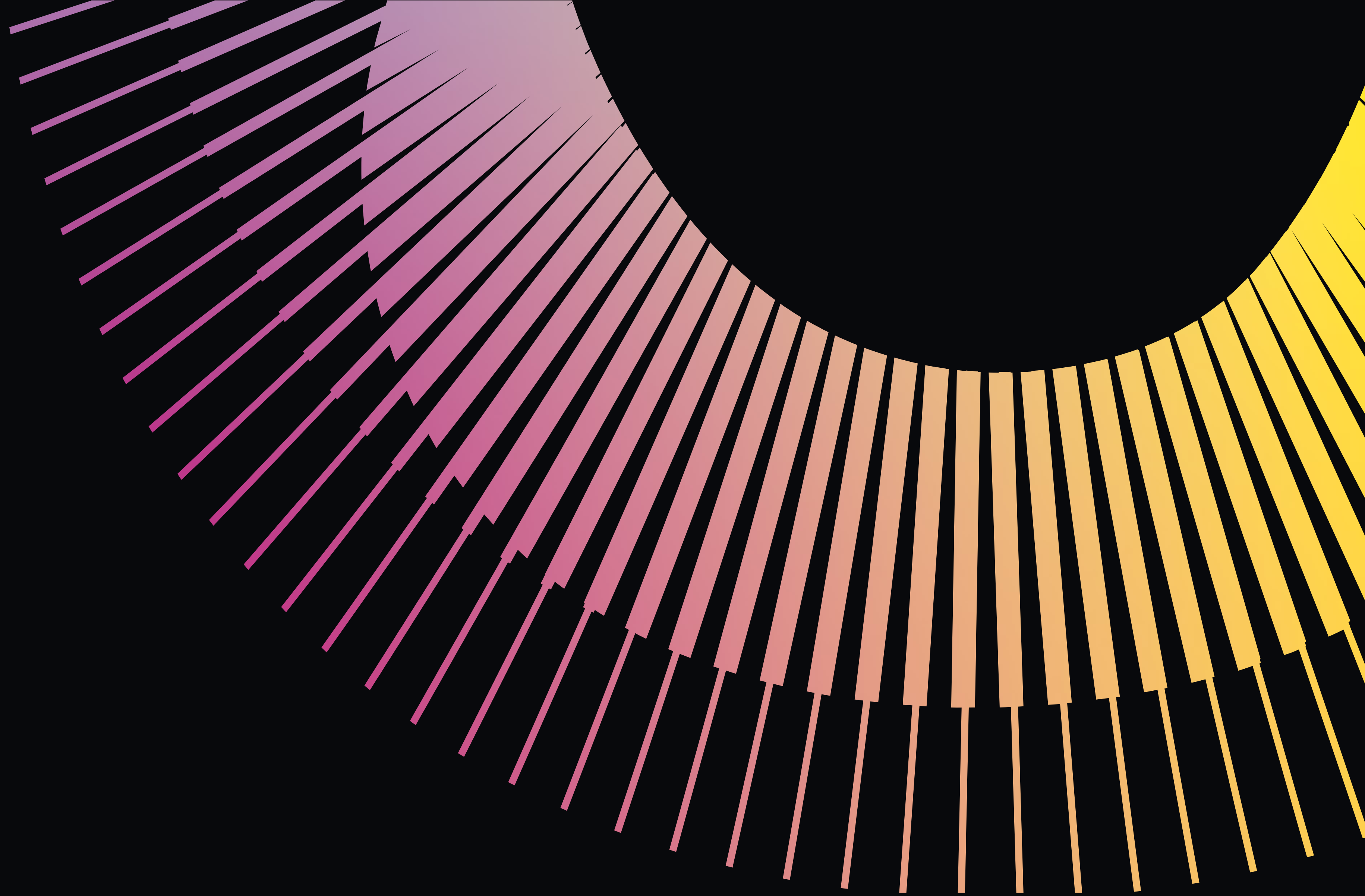

IN GOOD COMPANY



WHAT OUR CUSTOMERS SAY

“Being at Citylabs has been invaluable for our business. There’s almost endless supply, and the logistics like receiving shipments inwards and outwards and access to the airport means we can have a direct flight to anywhere in Europe within a few hours. For us to work so closely with our European network of distributors means it has been the best place for us to be.”

Alan Temple,
European Sales Manager, Takagi

“Our goal in basing ourselves at Citylabs is to build relationships with the right people and the right businesses: our product has significant potential for medical applications such as cancer diagnosis and micro-organism identification. The standard of the facilities here at Citylabs also chimes with how we want to present ourselves to our potential customers, and having opportunities to network and engage with like-minded businesses is key to our growth strategy.”

Emmanuel Raptakis,
Managing Director, ASTA UK

“Citylabs’ partnerships leverage Qiagen’s rich expertise in Manchester to accelerate innovation as a basis for the development of valuable molecular tests. This is a true win-win situation, bringing together Qiagen, the global leader in Sample to Insight solutions, with important intellectual assets in the UK to accelerate molecular biomarker research and subsequent development of new and promising diagnostic assays.”

Peer M Schatz,
Chief Executive, QIAGEN

CUSTOMER STORIES



APIS ASSAY TECHNOLOGIES



STOLLER BIOMARKER DISCOVERY CENTRE



TAKAGI EUROPE



PART OF A THRIVING COMMUNITY



Health and
Wellbeing Events



Business Support
Programme



Community Events
Programme

PART OF THE
BRUNTWOOD SCITECH NETWORK

PLATFORM



MANCHESTER
SCIENCE
PARK

INNOVATION
BIRMINGHAM

ALDERLEY
PARK

CIRCLE
SQUARE



**Amazing
Space**

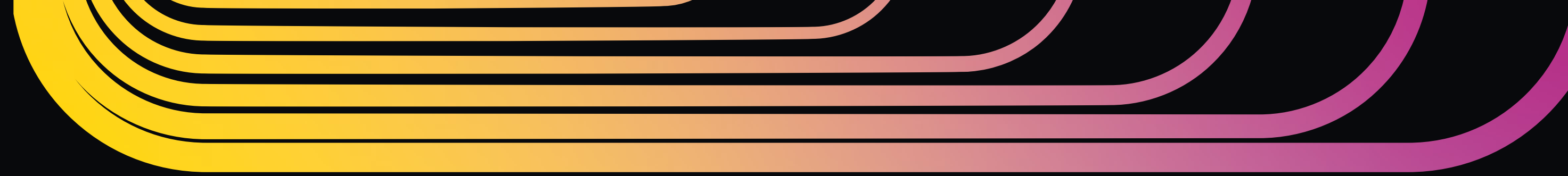



Citylabs 1.0

- Biomedical centre of excellence
- Opened 2014
- Fully let to +20 companies within 15 months
- 100,000 sq ft
- Office and lab space



Citylabs 2.0

- 92,000 sq ft office and lab space
- Under construction - PC December 2020
- Will be home to QIAGEN European Centre of Excellence for Precision Medicine
- £25m development
- Will create 800 jobs
- £150m additional economic value
- ERDF and Evergreen funded



Citylabs 3.0

- 128,000 sq ft world class office and lab space, with events space, meeting rooms and retail
- Planning permission received
- Redevelopment of Old St Mary's Hospital and derelict chapel
- £35m development

CITYLABS 4.0



CITYLABS 4.0
FACTS AND STATS

125,000sq ft
7 FLOORS

Available space from 1,948 sq ft



SHOWERS, CYCLE
STORE AND KIT
DRYING ROOM

£35 million
DEVELOPMENT

INFORMAL BREAKOUT
AND MEETING SPACE

Host Reception



300

ADDITIONAL JOBS
FOR CITY

OFFICE AND
LAB SPACE

19,440 sq ft
FLOORPLATES

Event space and
meeting rooms
accessible at
Citylabs 1.0



Gym access at
Manchester Science Park

BUILDING STACKER AND TECHNICAL SPECIFICATION

Innovative M&E Systems to achieve low carbon emissions
Fully Air Conditioned
4.2m Floor to ceiling Ground Floor (Reception and Ground Floor Suites)
3.5m Floor to ceiling height with an exposed concrete soffit and steel beams
Energy efficient LED lighting
Showers, changing and kit drying facilities
Secure cycle storage
Full height glazing on all elevations
19,440 sq ft typical upper floorplate
Extensive new landscape
BREEAM ‘Very Good’ Rating

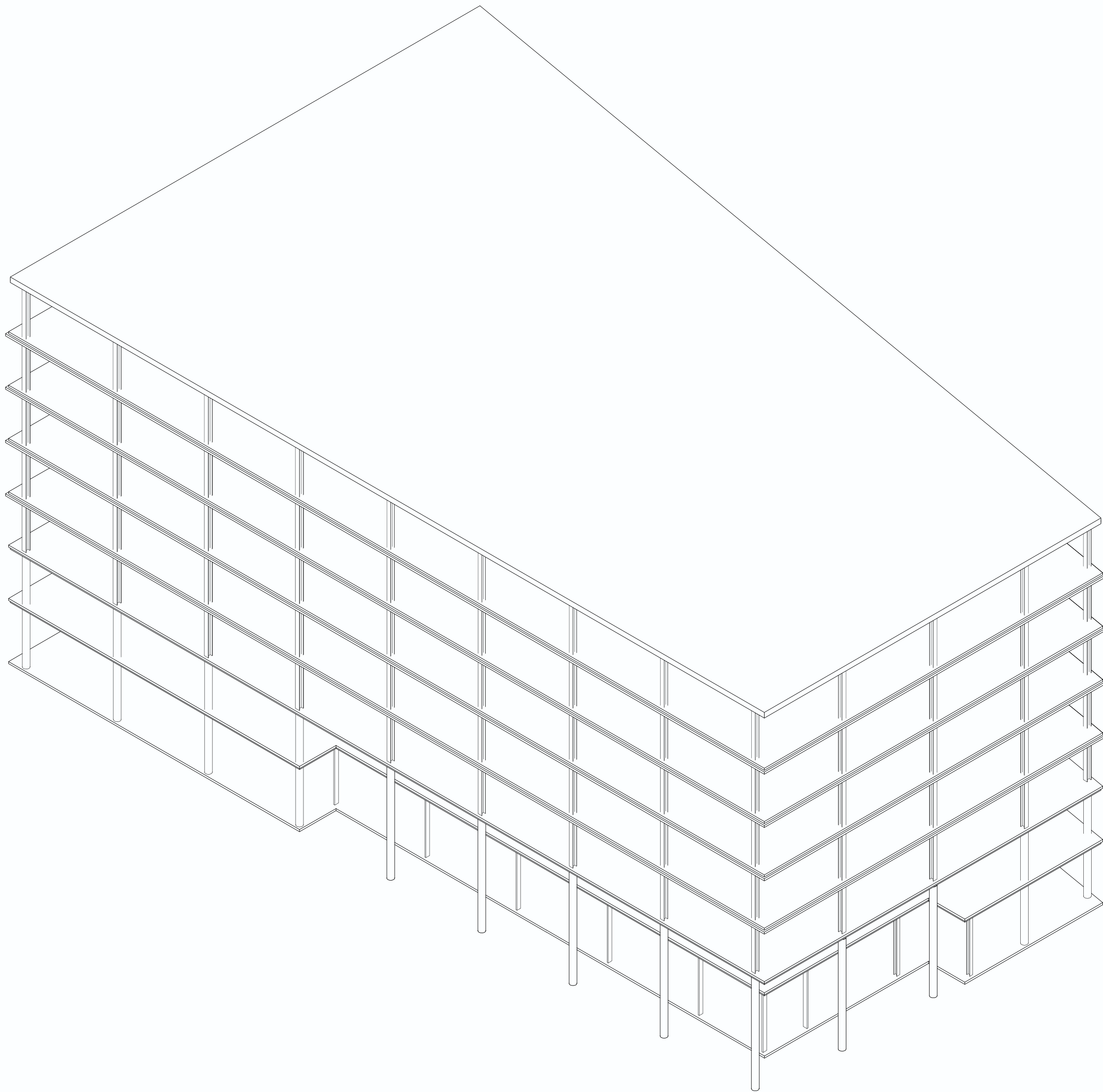

Area Schedule (Nett Internal Area)		
SQ M	SQ FT	FLOOR
		Plant
1806	19,440	6
1806	19,440	5
1806	19,440	4
1806	19,440	3
1806	19,440	2
1650	17,761	1
868	9,343	G

GROUND FLOOR
PLAN

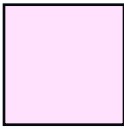
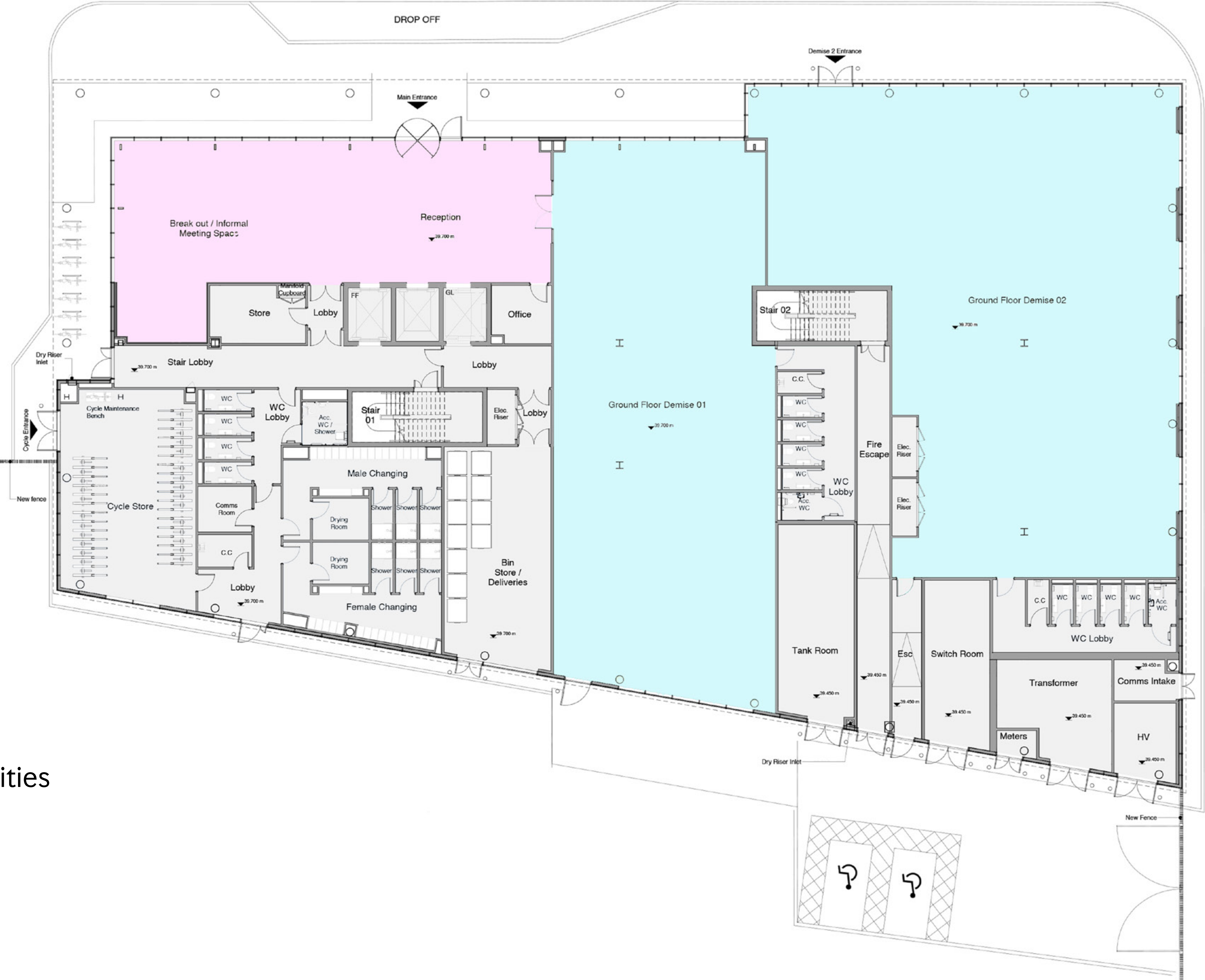

Communal facilities





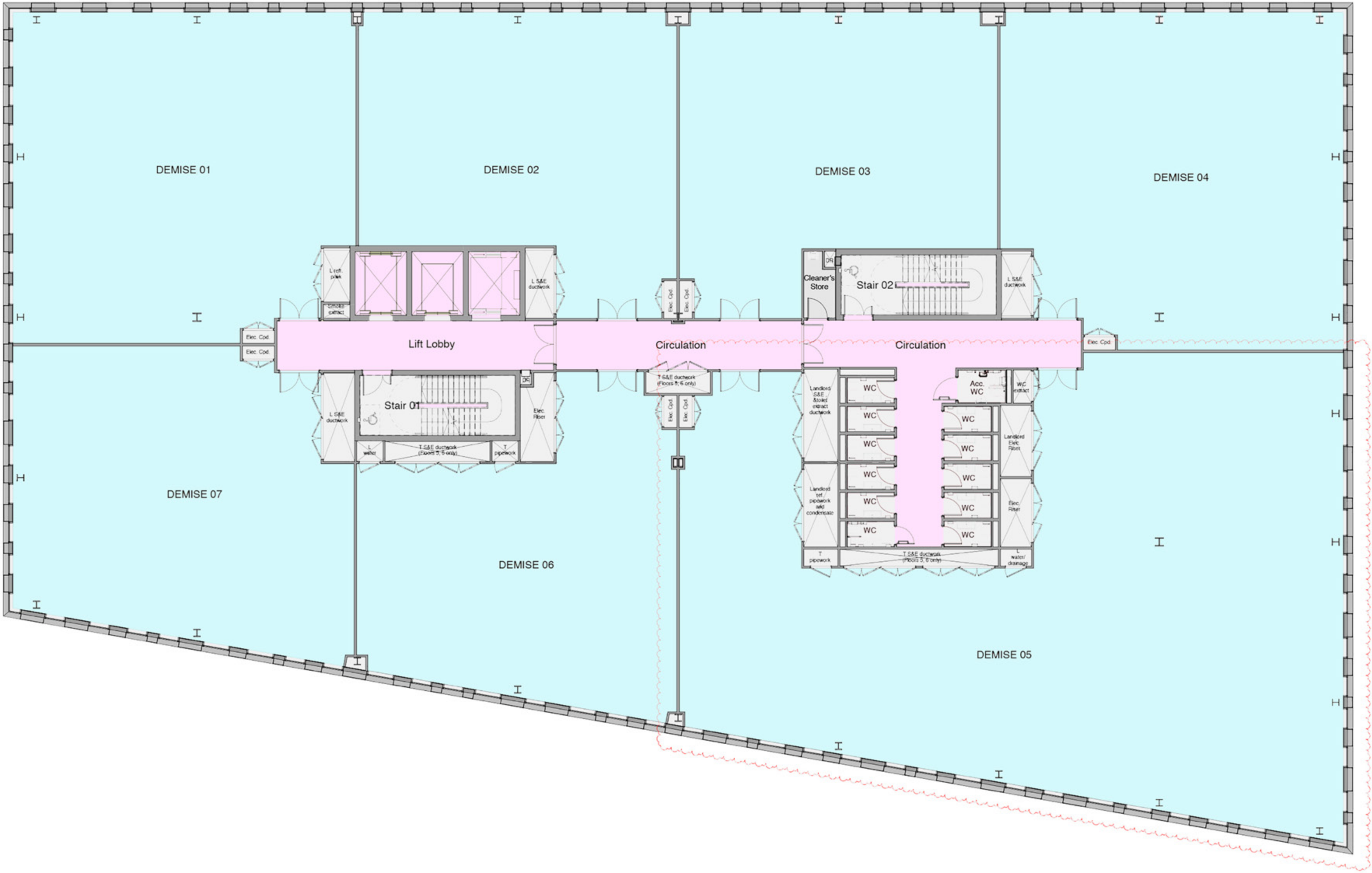

Office space

TYPICAL UPPER FLOOR
PLAN

- Communal facilities
- Office space



KEY MILESTONES

		2019	2020	2021	2022
	PLANNING PERMISSION SUBMITTED	NOVEMBER 2019			
	PLANNING DETERMINATION	MARCH 2020			
	ON SITE CONSTRUCTION	JULY 2020 DECEMBER 2021			
	PRACTICAL COMPLETION	JAN 2022			

**Any
Questions?**

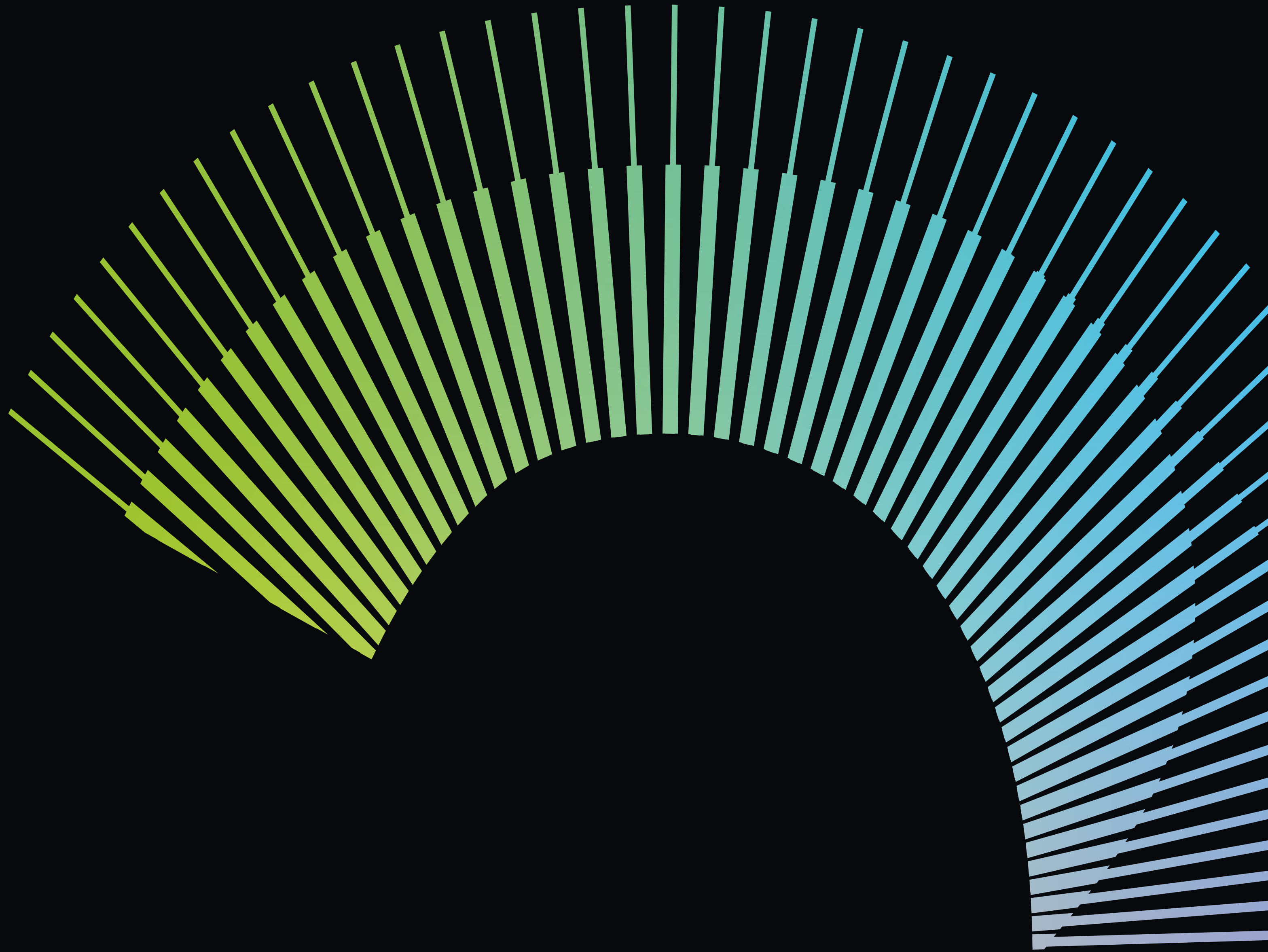

Shilpa Lakhanpal
Asset Manager
Bruntwood SciTech - Manchester

shilpa.lakhanpal@bruntwood.co.uk
07825 845754

bruntwood.co.uk/scitech

 https://twitter.com/BW_SciTech

 <https://www.linkedin.com/company/bruntwood-scitech/>

 <https://www.instagram.com/bruntwoodscitech/>

Will Hughes
Commercial Manager
Bruntwood SciTech - Manchester

will.hughes@bruntwood.co.uk
07384 216600

A development by
bruntwood
SciTech

for
 **MSP** MANCHESTER
SCIENCE
PARTNERSHIPS

 **Manchester University**
NHS Foundation Trust