

todo se reduce a mirar

con maldad, obsesión, paranoia...

Y comprender claro...

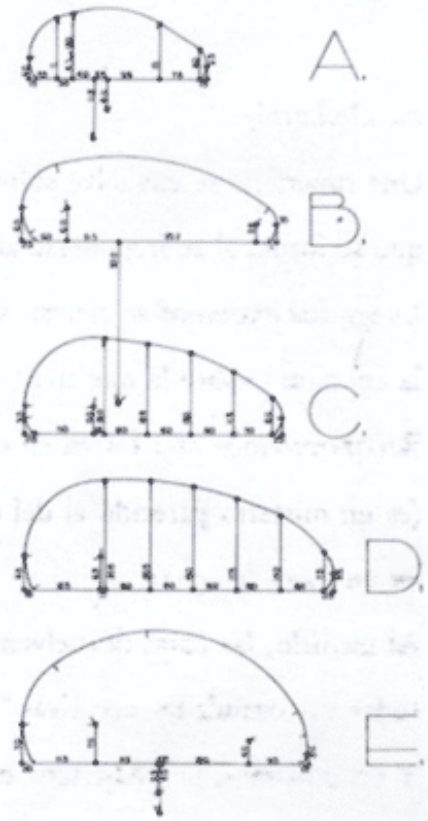
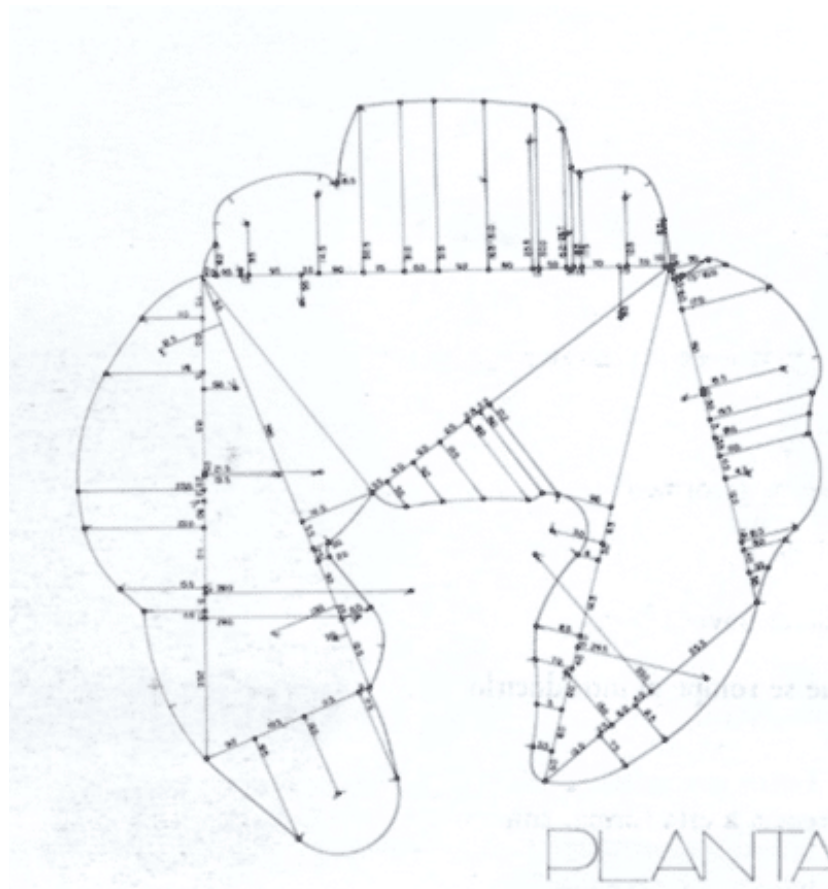
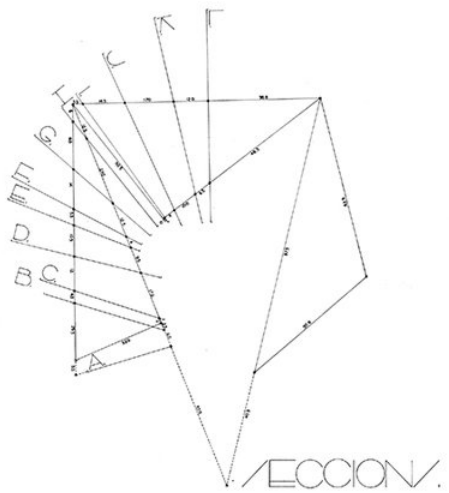
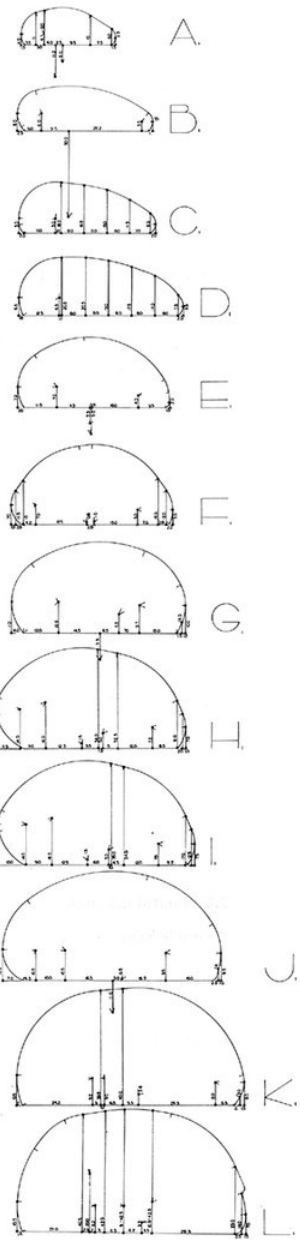
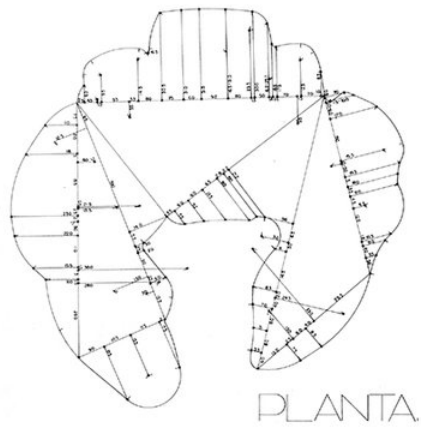

K L

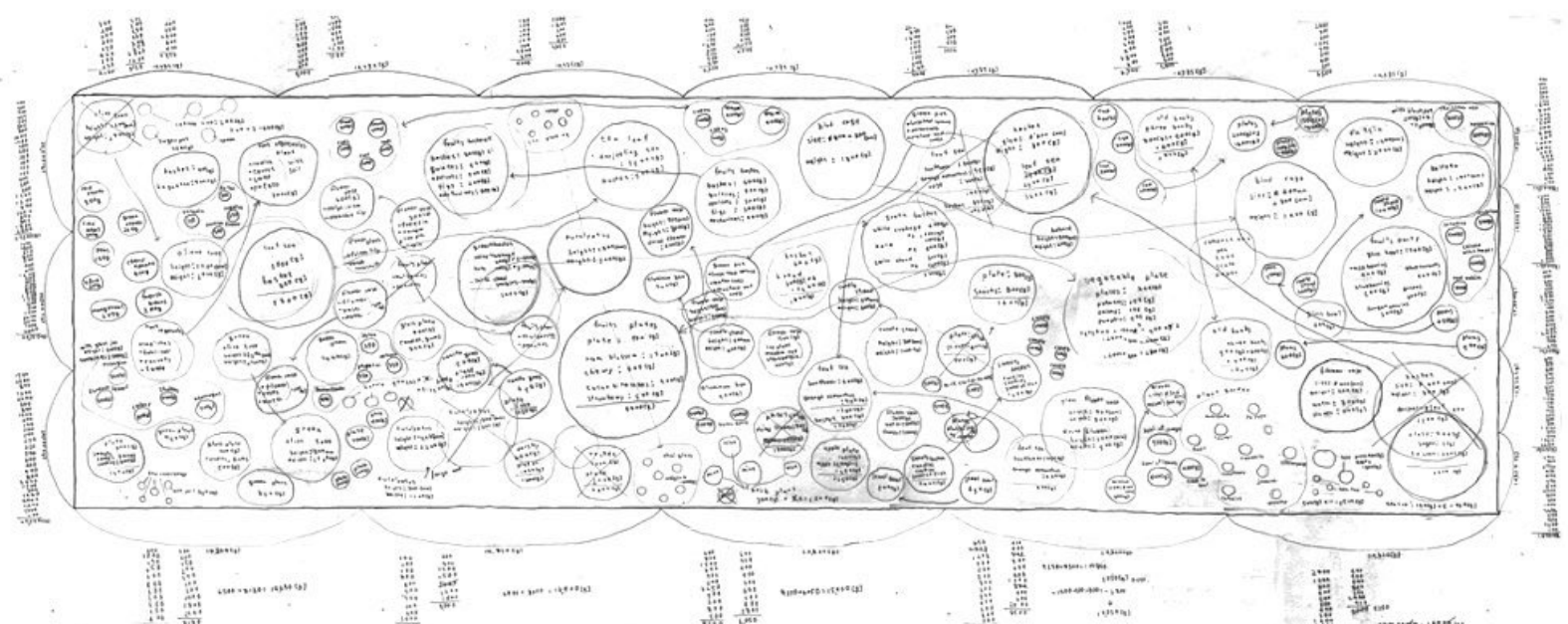
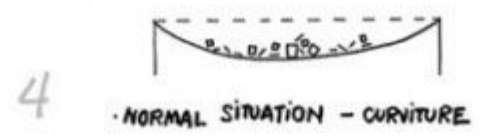
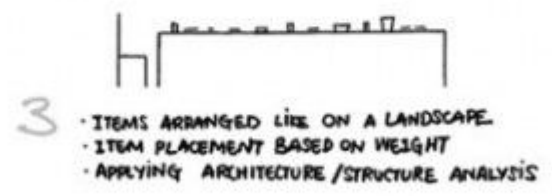
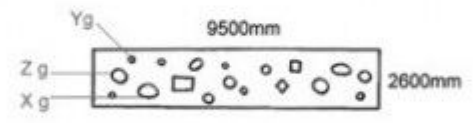
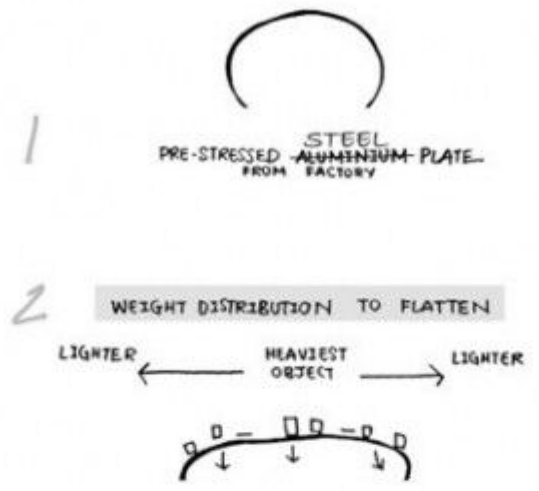



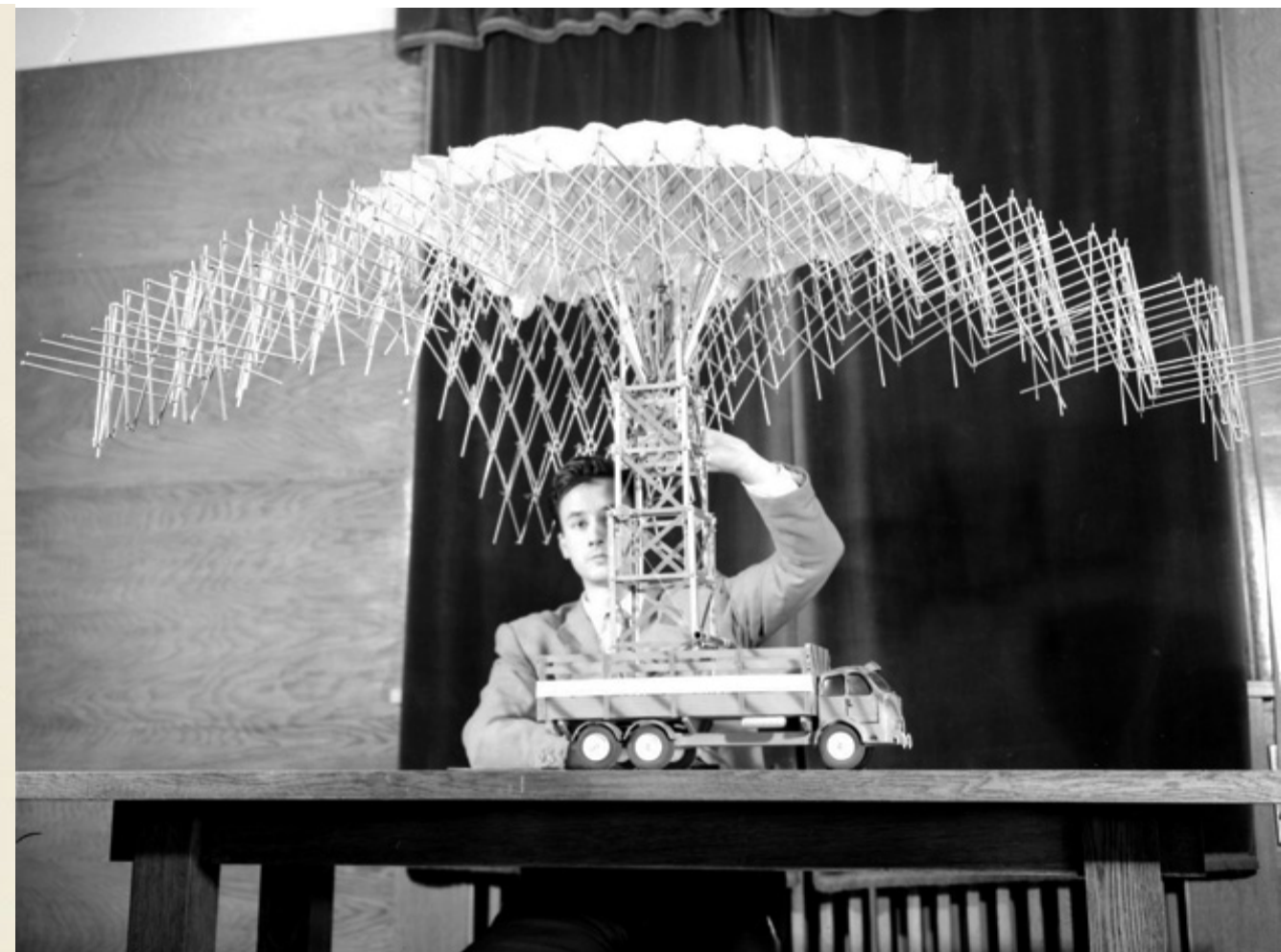
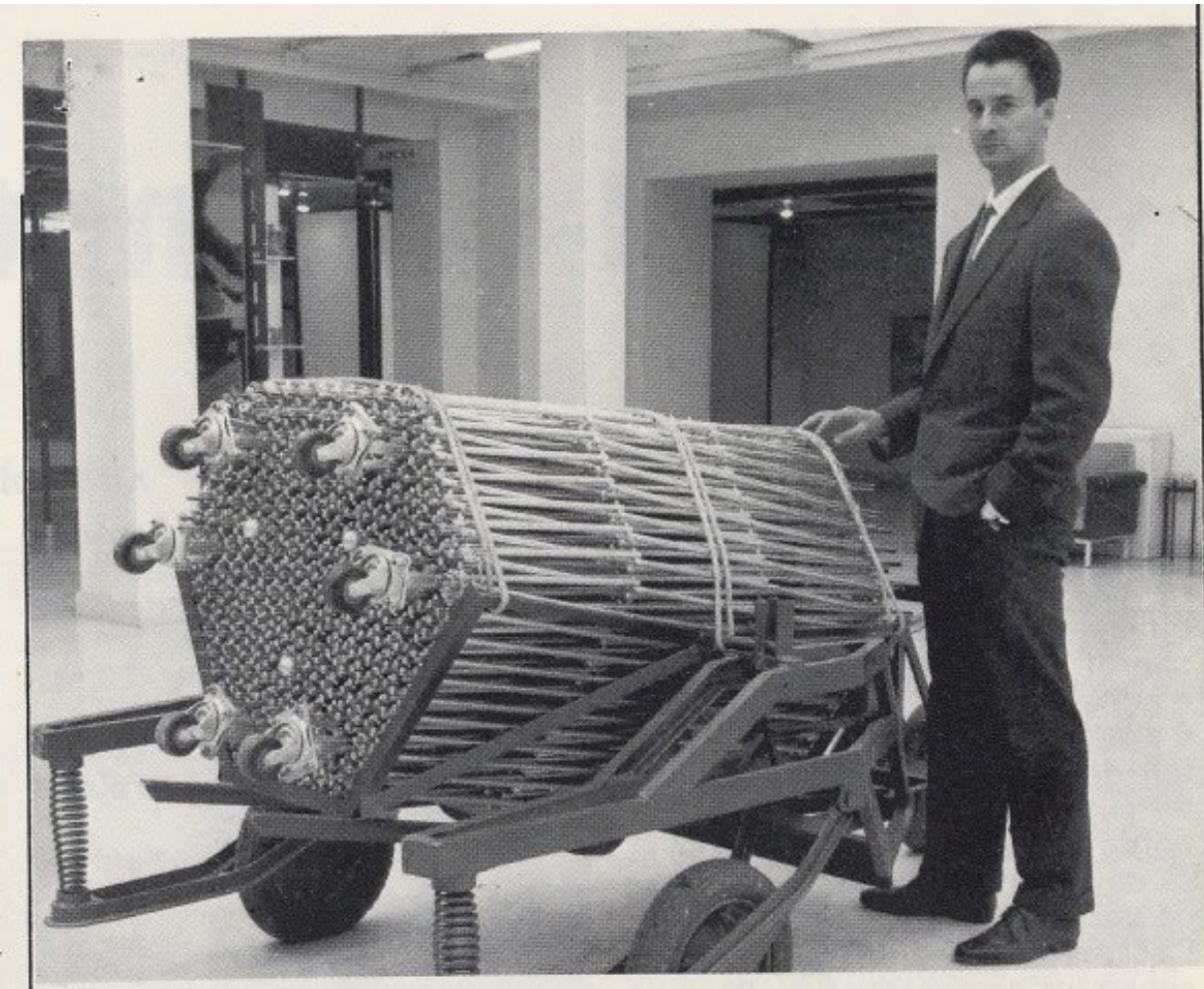

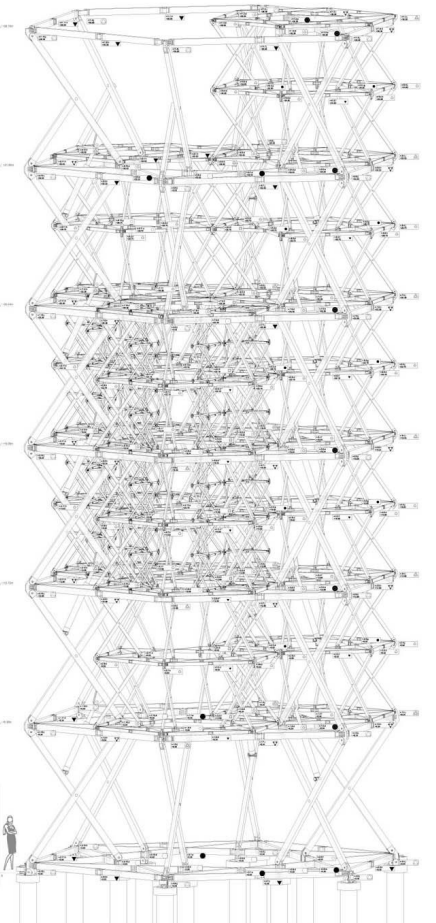
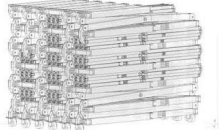
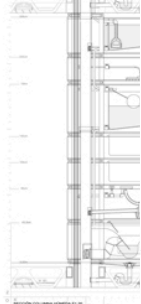
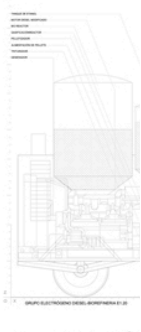
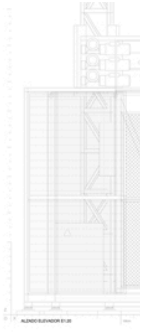
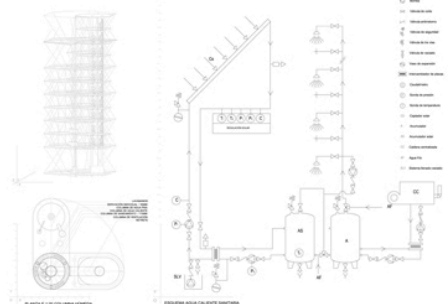
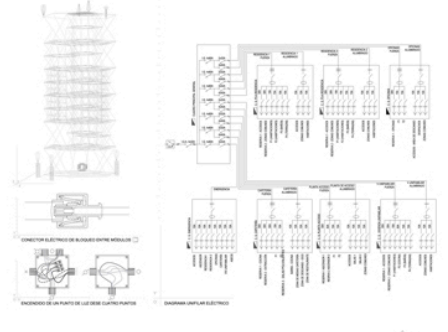
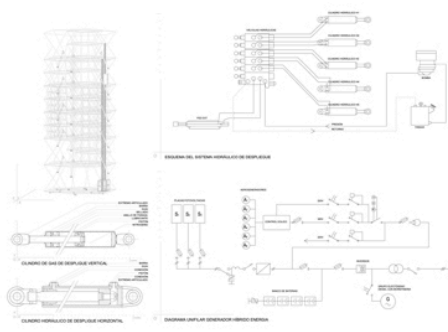
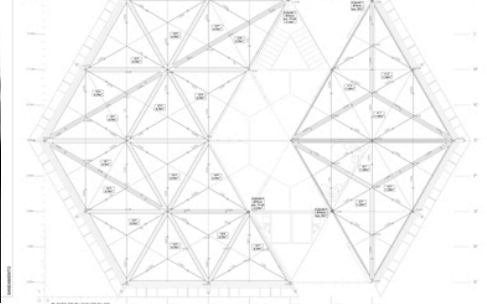
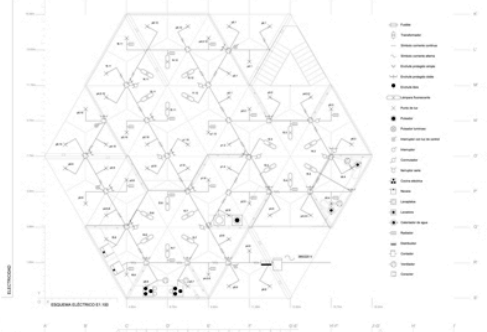
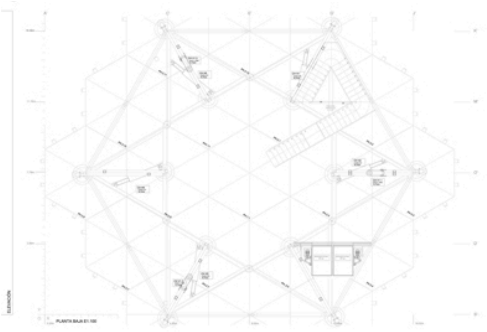

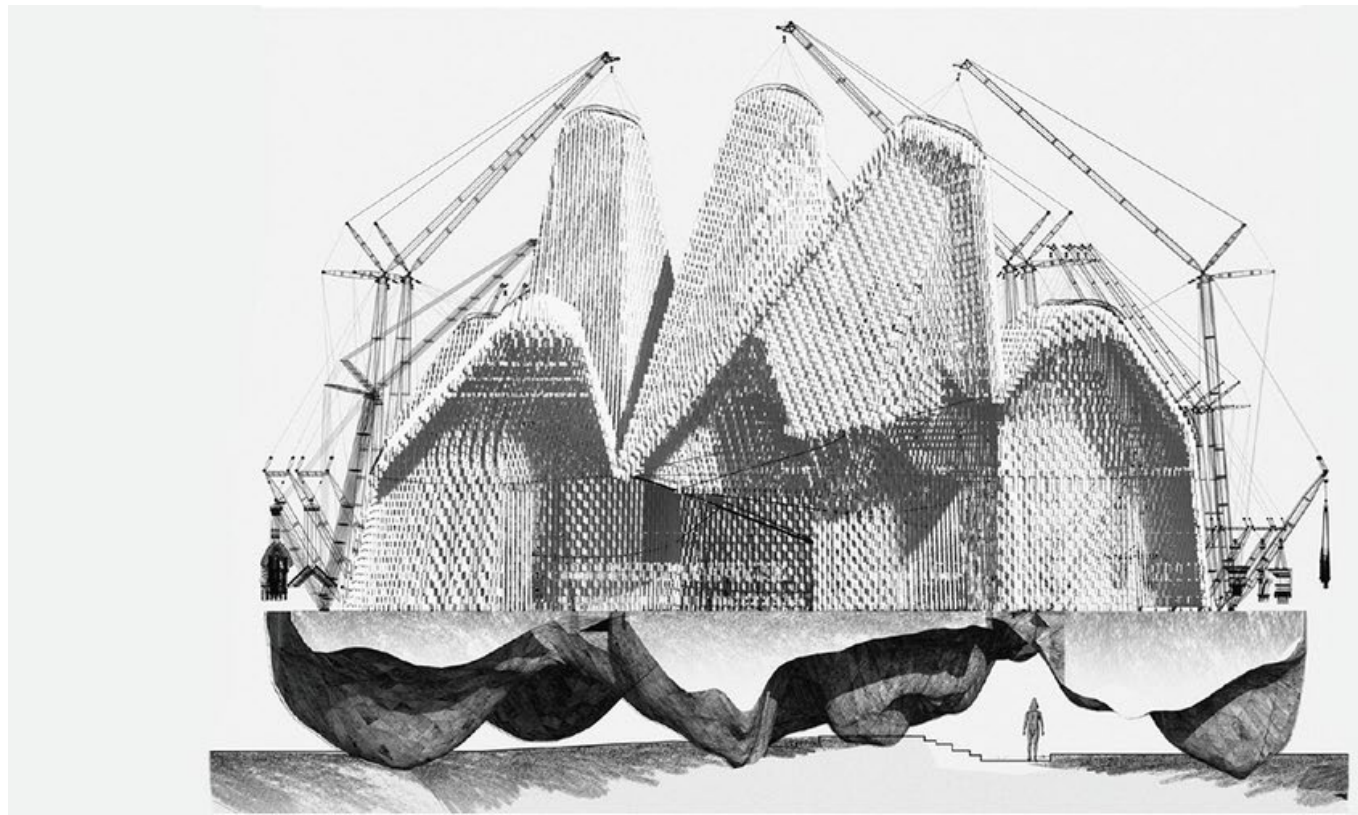
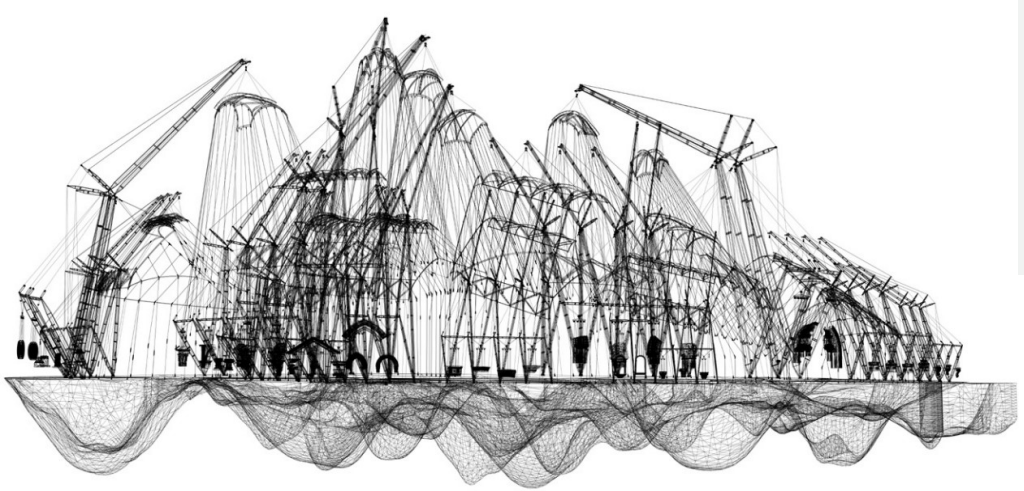
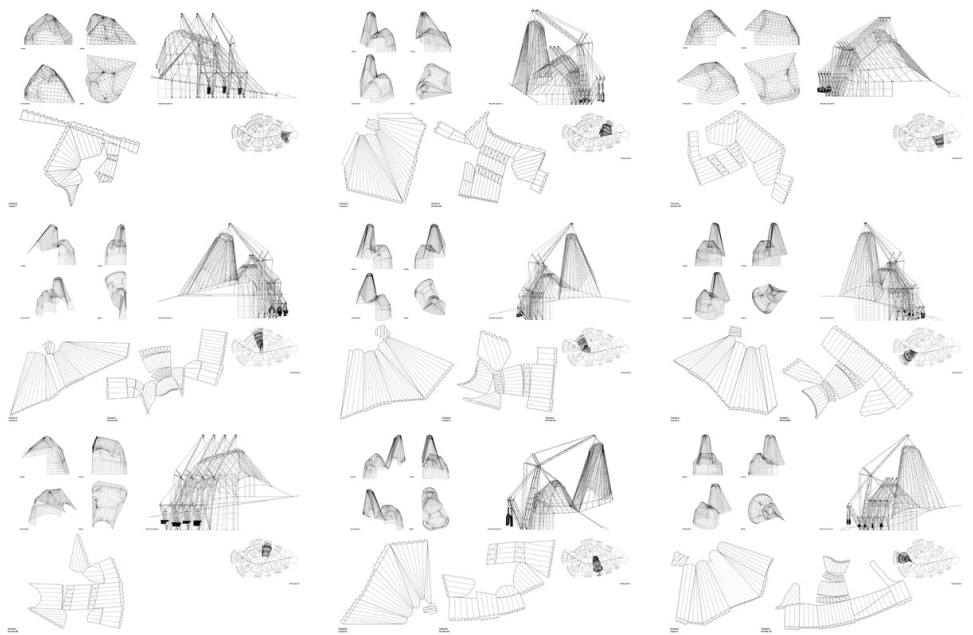

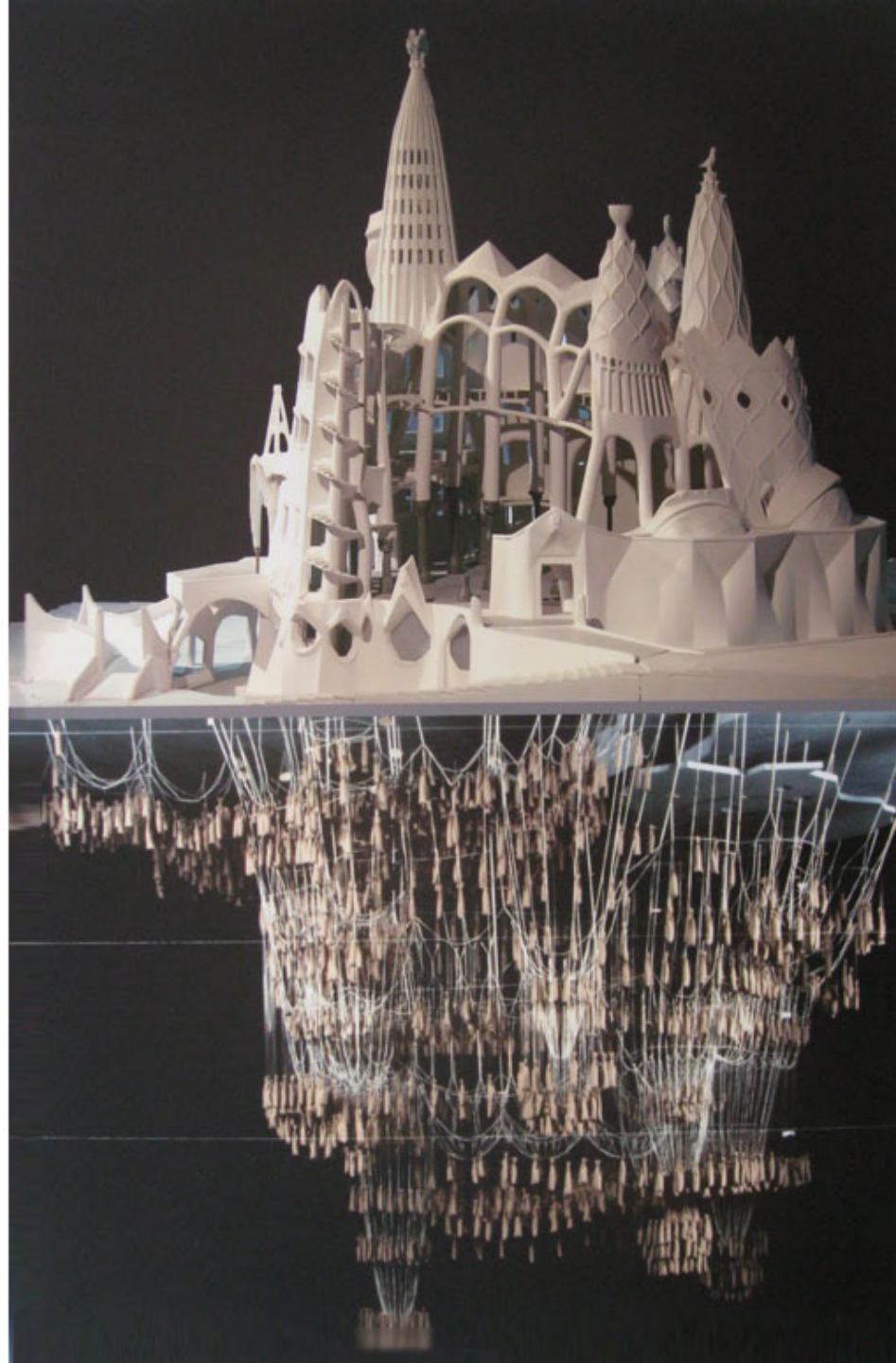



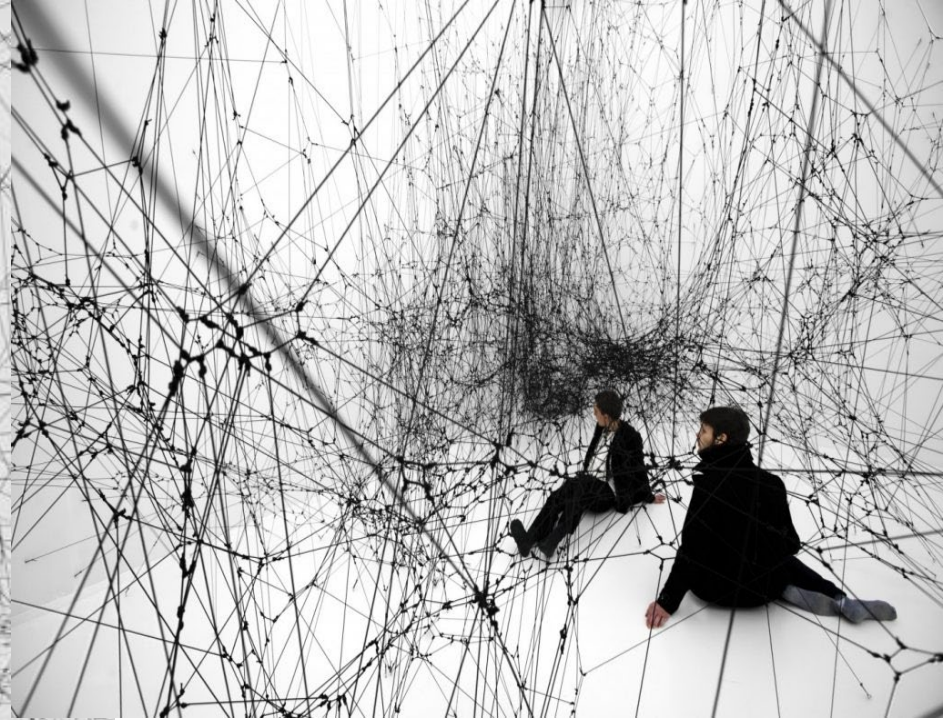

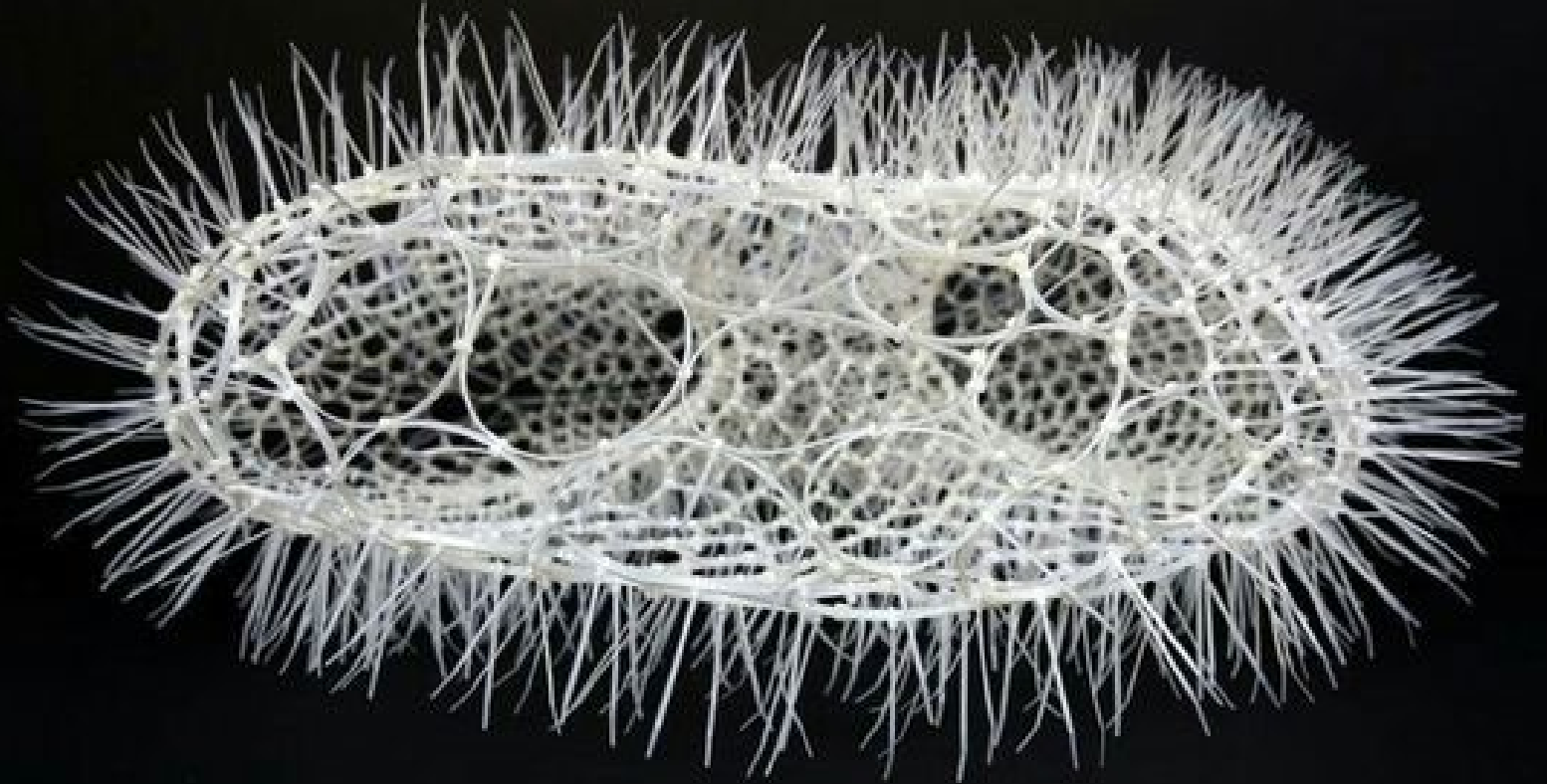
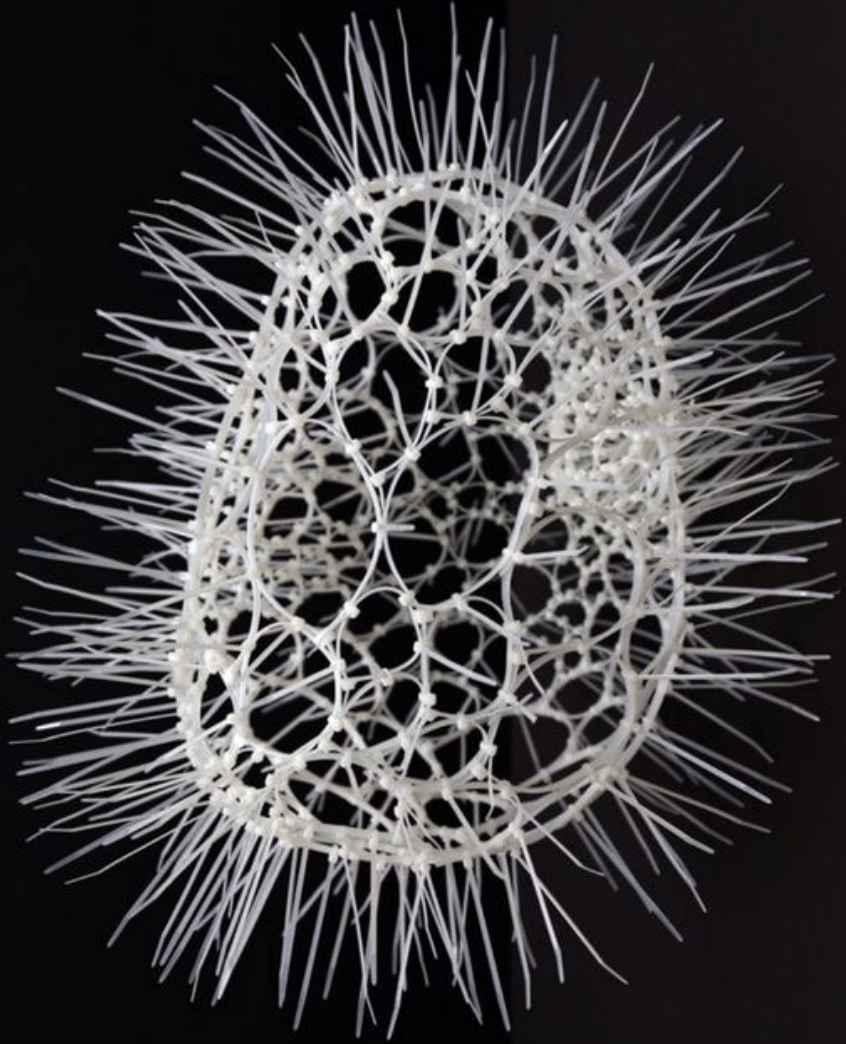



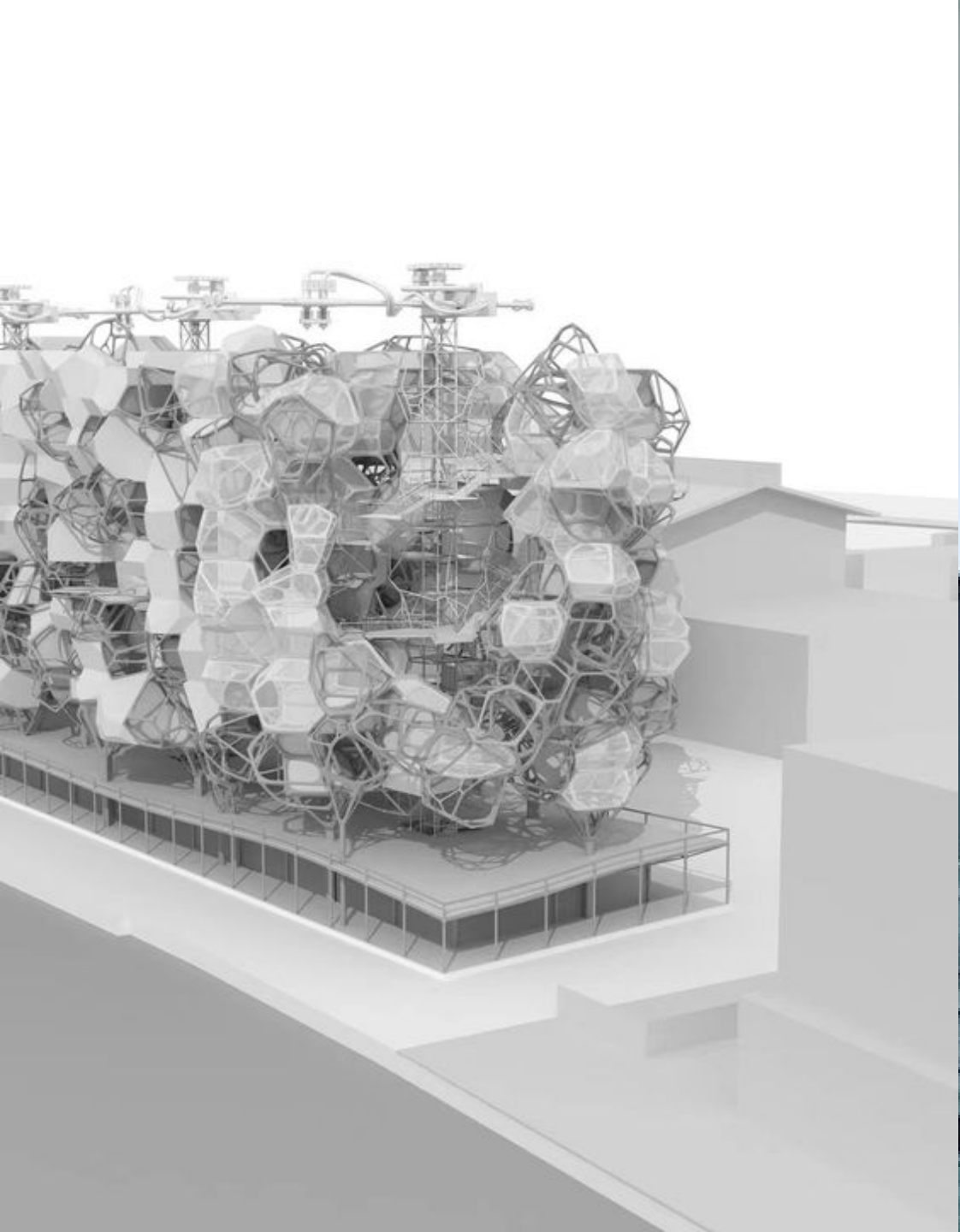

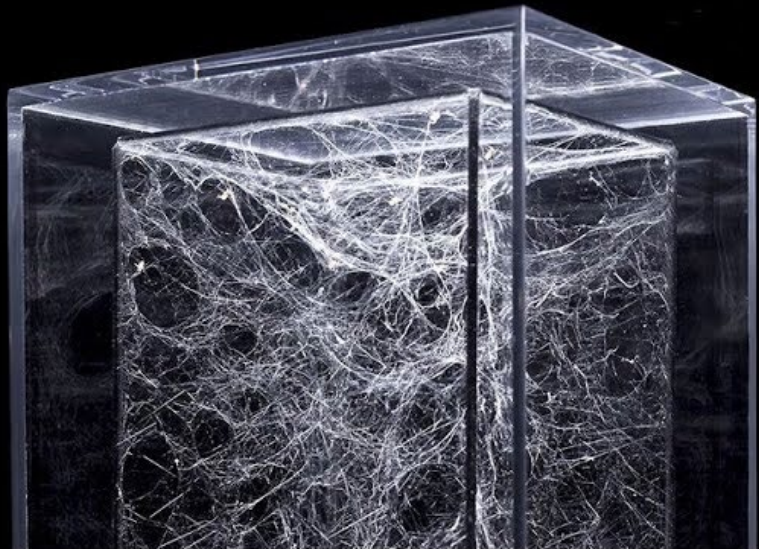

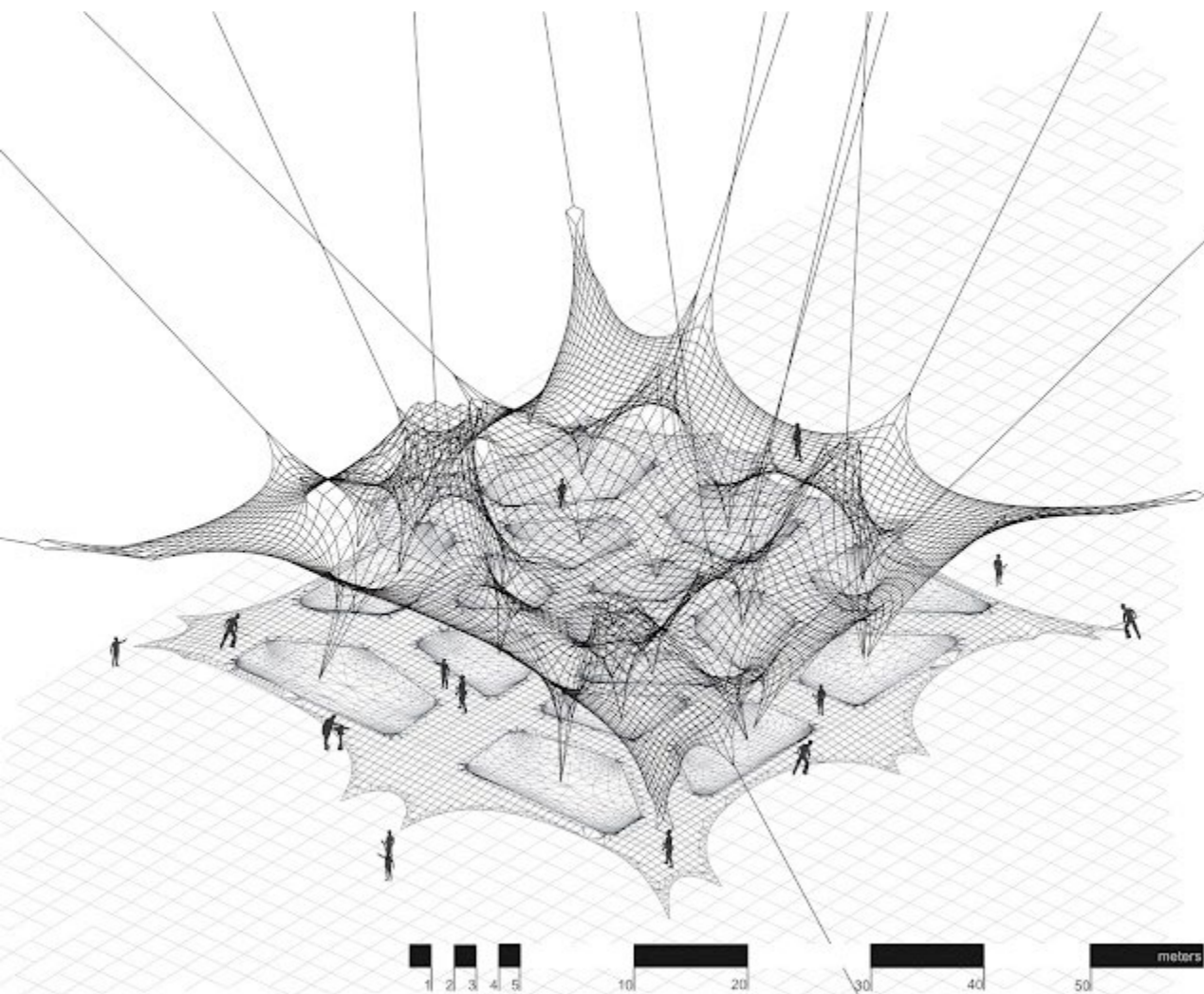

ANALOGUE FORMFINDING EXPERIMENT 2.1 METHOD CHOREOGRAPHY

MAIN AMBITIONS

Using the previous experiment findings and failures to expand on the use of the forms for structure. A more inhabitable interior was the main objective. Forces were applied to tension the fabric to shape the interior spaces. Methods of bringing the light into the space were attempted.

PROCESS

The fabric was tensioned at nodes randomly, working on shaping the interior geometry of two layers at two separate planes. The exterior tectonics emerged from the shaping procedures of the interior. A gradient of transparency was pursued in the casting process. A gradient of transparency was achieved by painting and spraying compressed air on a freshly painted thin layer of plaster mix. Openings were formed by pulling the material using solid discs, that were cut after the plaster had set.

RESULT

A pixilation of light rays appeared in the interior by leaving the mesh exposed at the peaks of the mountains that were pulled by the forces. The interior morphology emerged from the shaping procedures of the exterior. **The number of nodes was excessive and has to be reduced. Adding more nodes at the edges did not solve the edge-buckling problem. Ground is wobbly and uneven.**

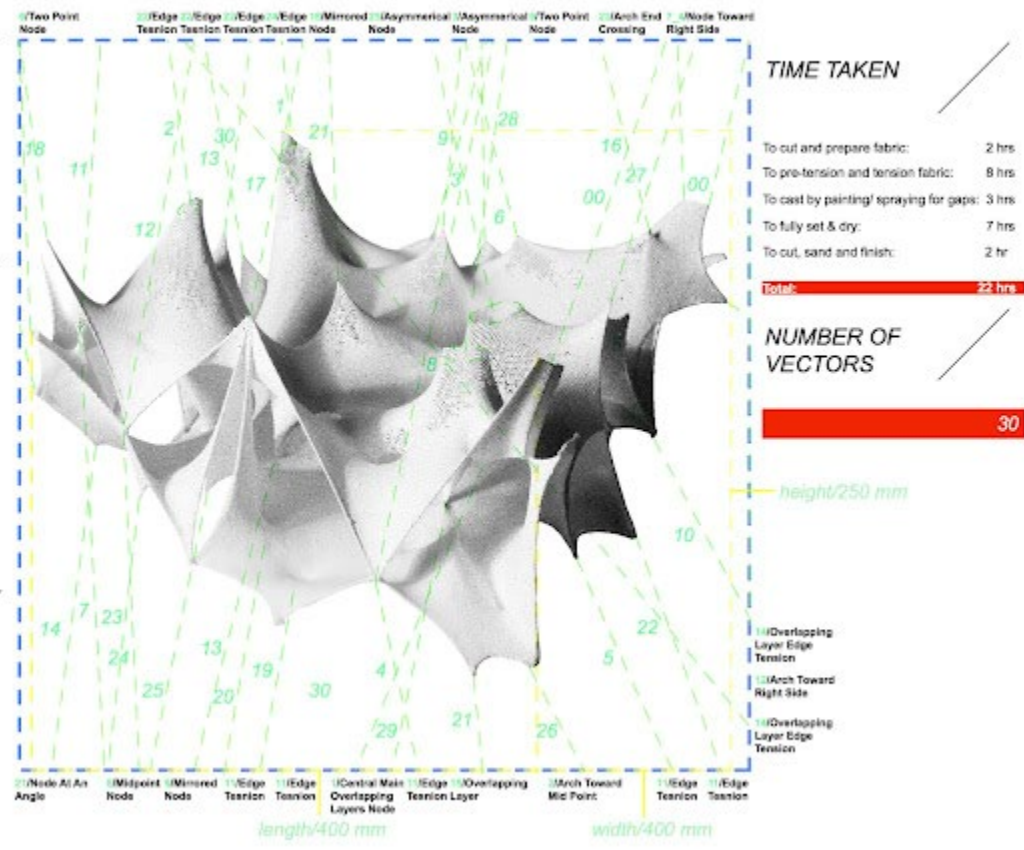

TIME TAKEN

To cut and prepare fabric:	2 hrs
To pre-tension and tension fabric:	8 hrs
To cast by painting/ spraying for gaps:	3 hrs
To fully set & dry:	7 hrs
To cut, sand and finish:	2 hr
Total:	22 hrs

NUMBER OF VECTORS

30

height/250 mm

- 1) Overlapping Layer Edge Tension
- 2) Arch Toward Right Side
- 3) Overlapping Layer Edge Tension

Two Point Node
 Edge Tension
 Edge Tension
 Edge Tension
 Edge Tension
 Node
 Mirrored Node
 Asymmetrical Node
 Asymmetrical Node
 Two Point Node
 Arch End Crossing
 Node Toward Right Side

1) Node At An Angle
 2) Midpoint Node
 3) Mirrored Node
 4) Edge Tension
 5) Edge Tension
 6) Central Mass Overlapping Layers Node
 7) Edge Tension
 8) Overlapping Tension Layer
 9) Arch Toward Mid Point
 10) Edge Tension
 11) Edge Tension

length/400 mm
 width/400 mm



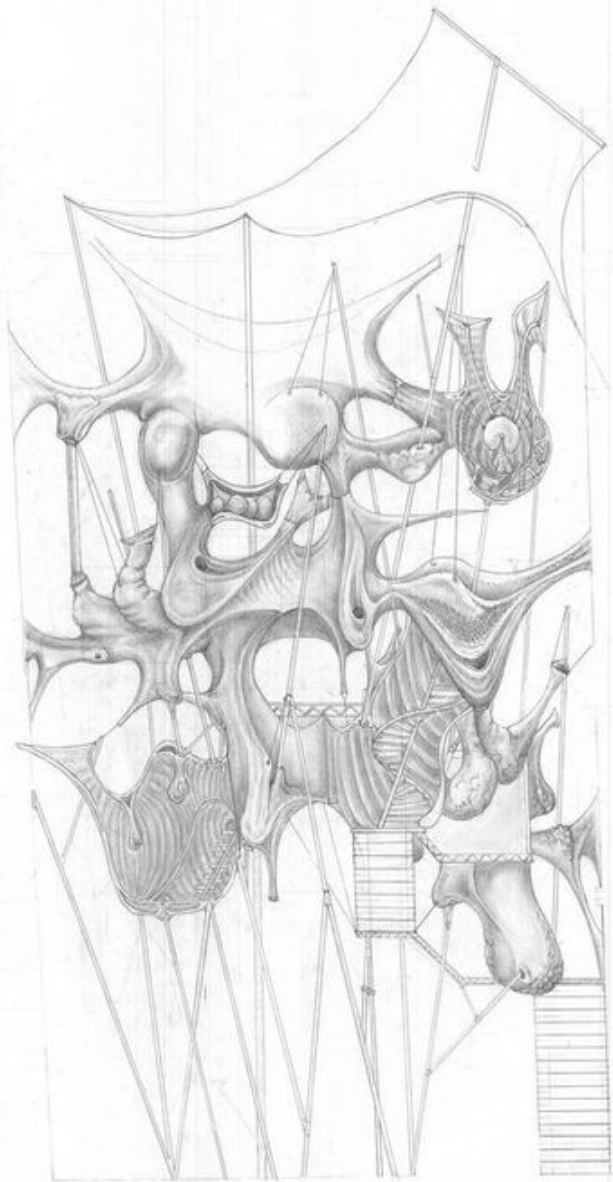



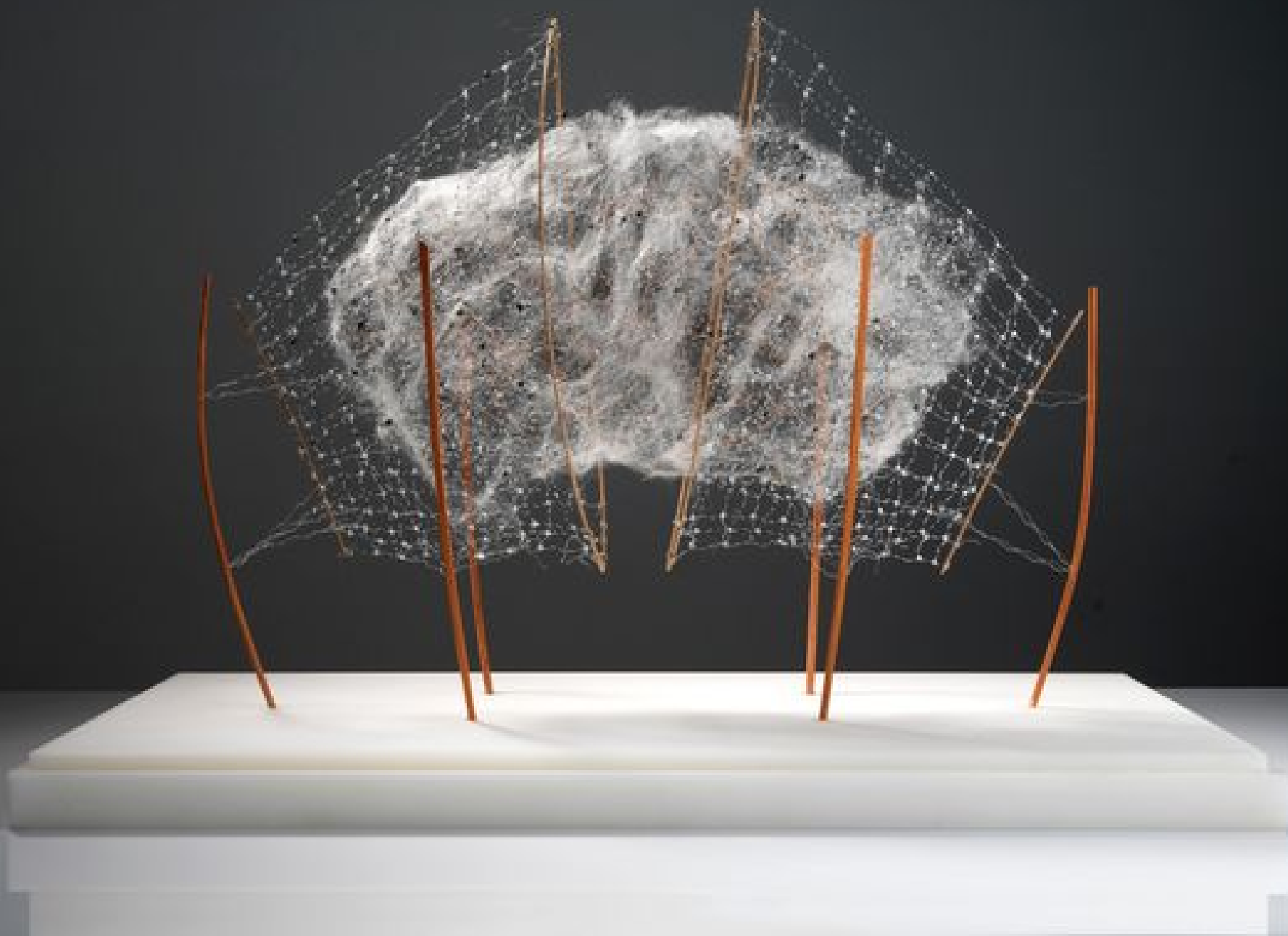

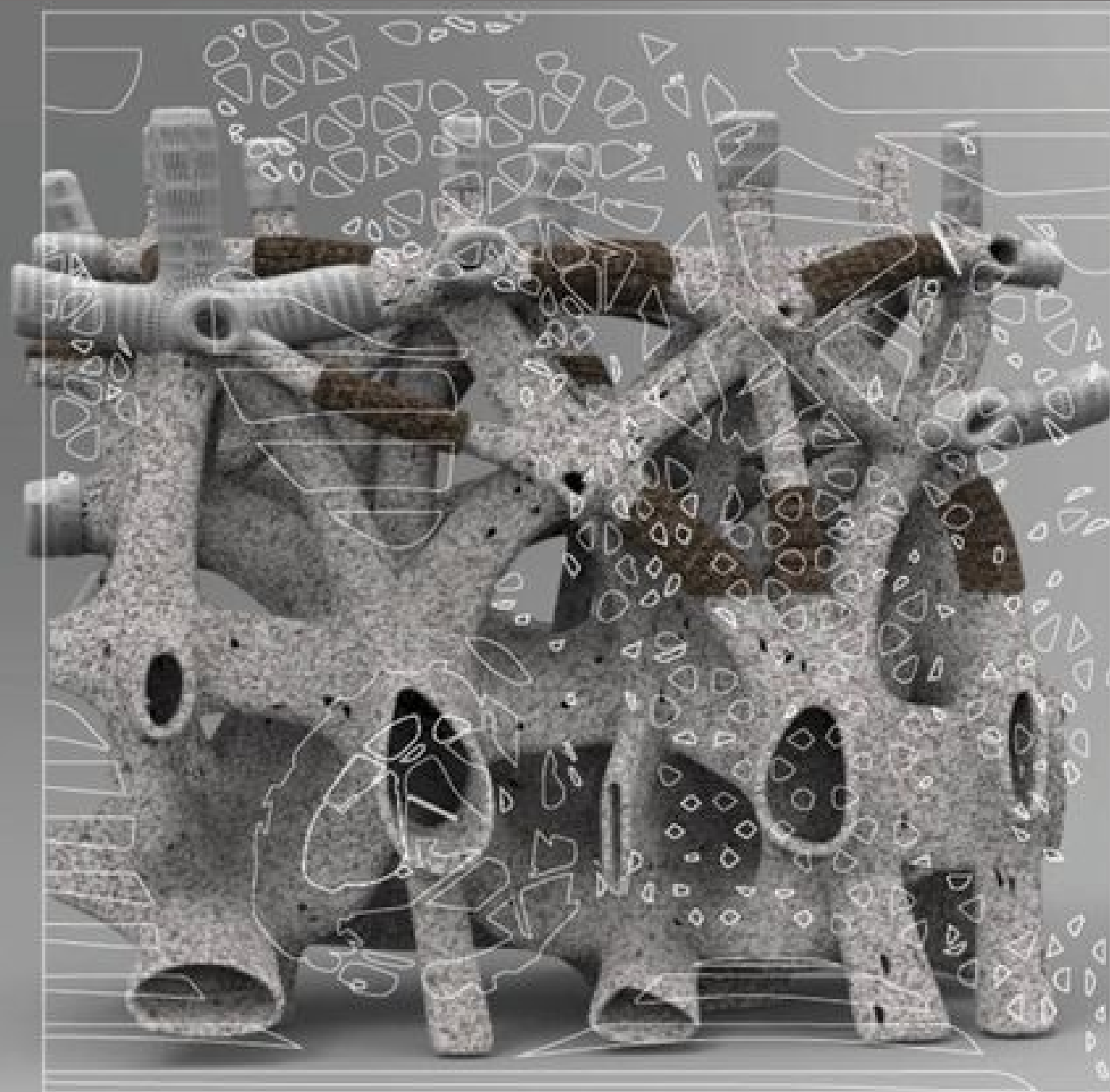

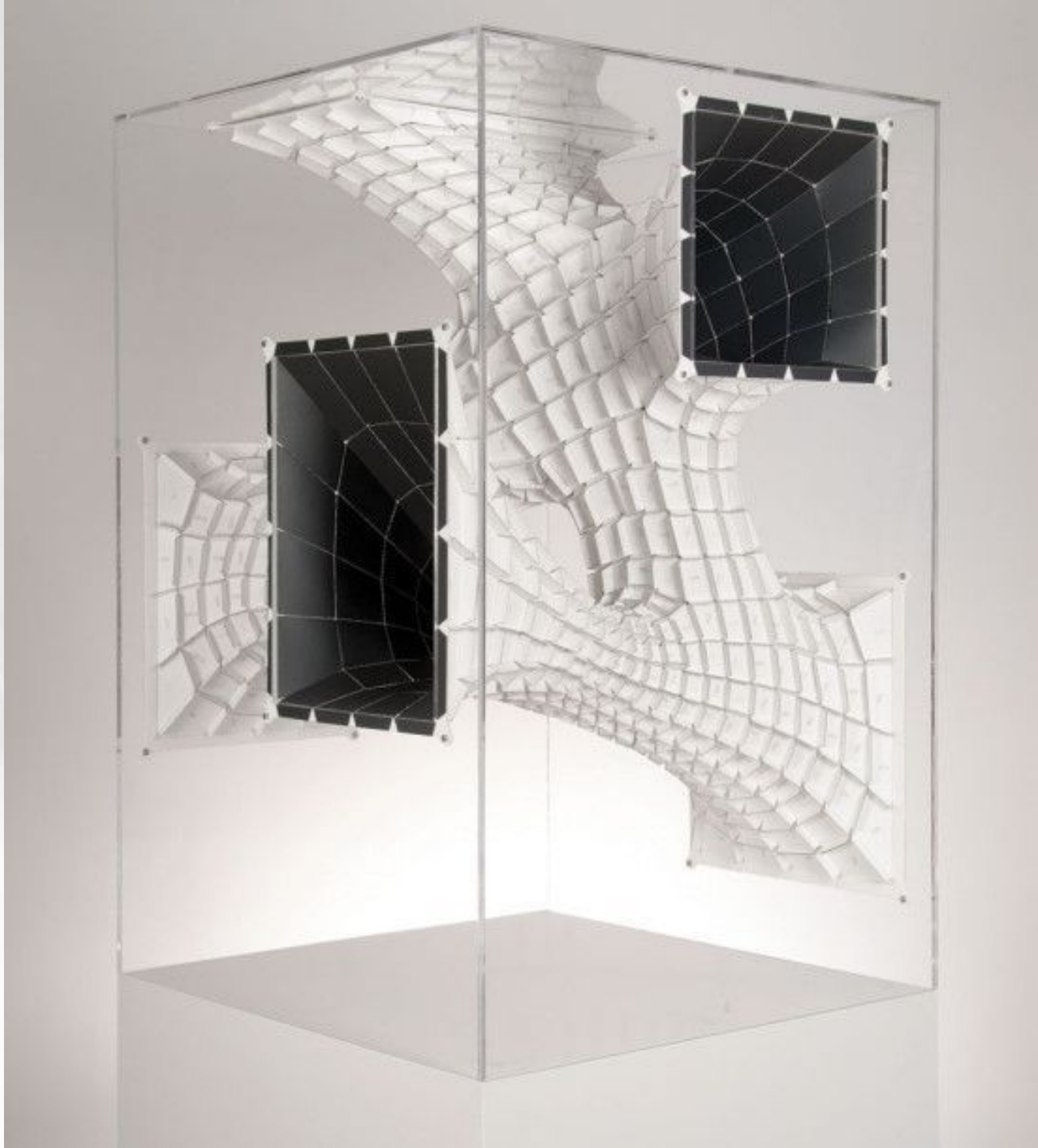
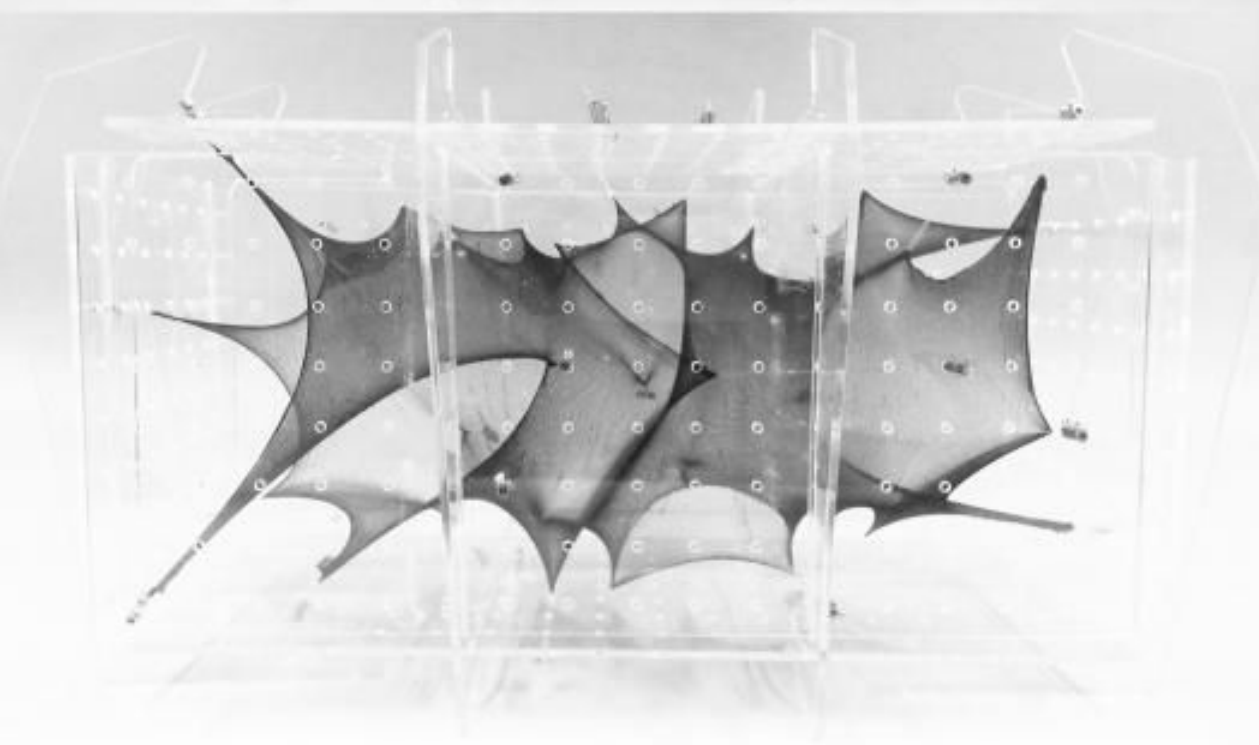
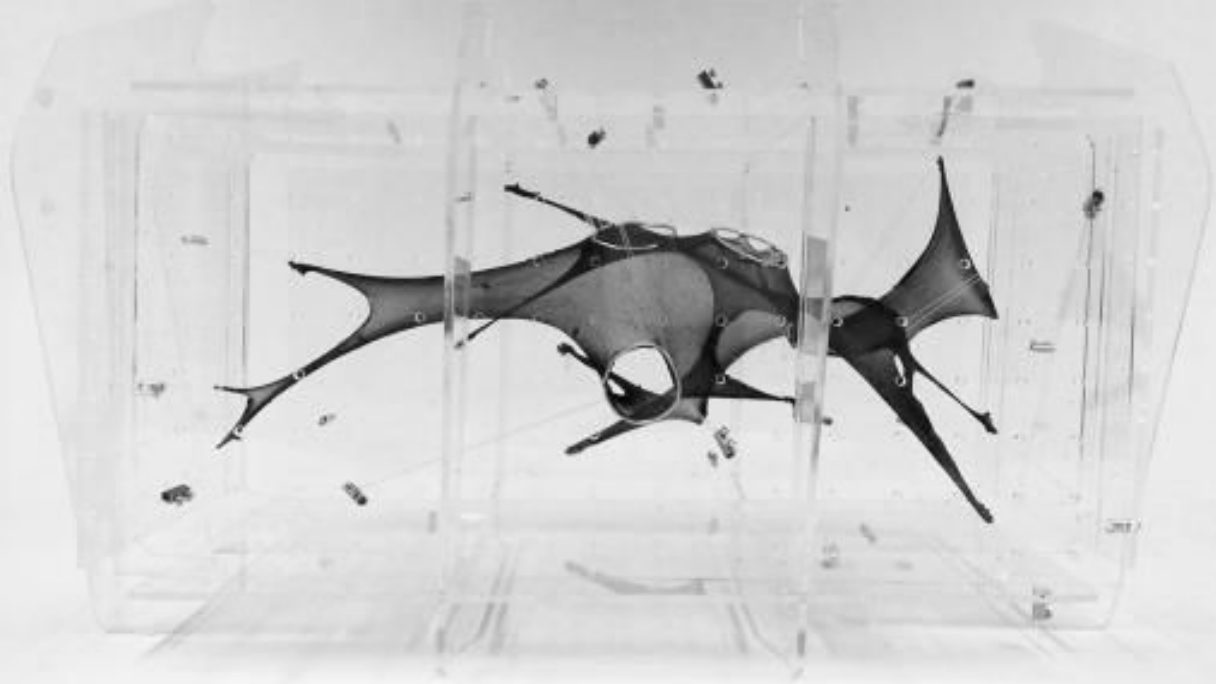

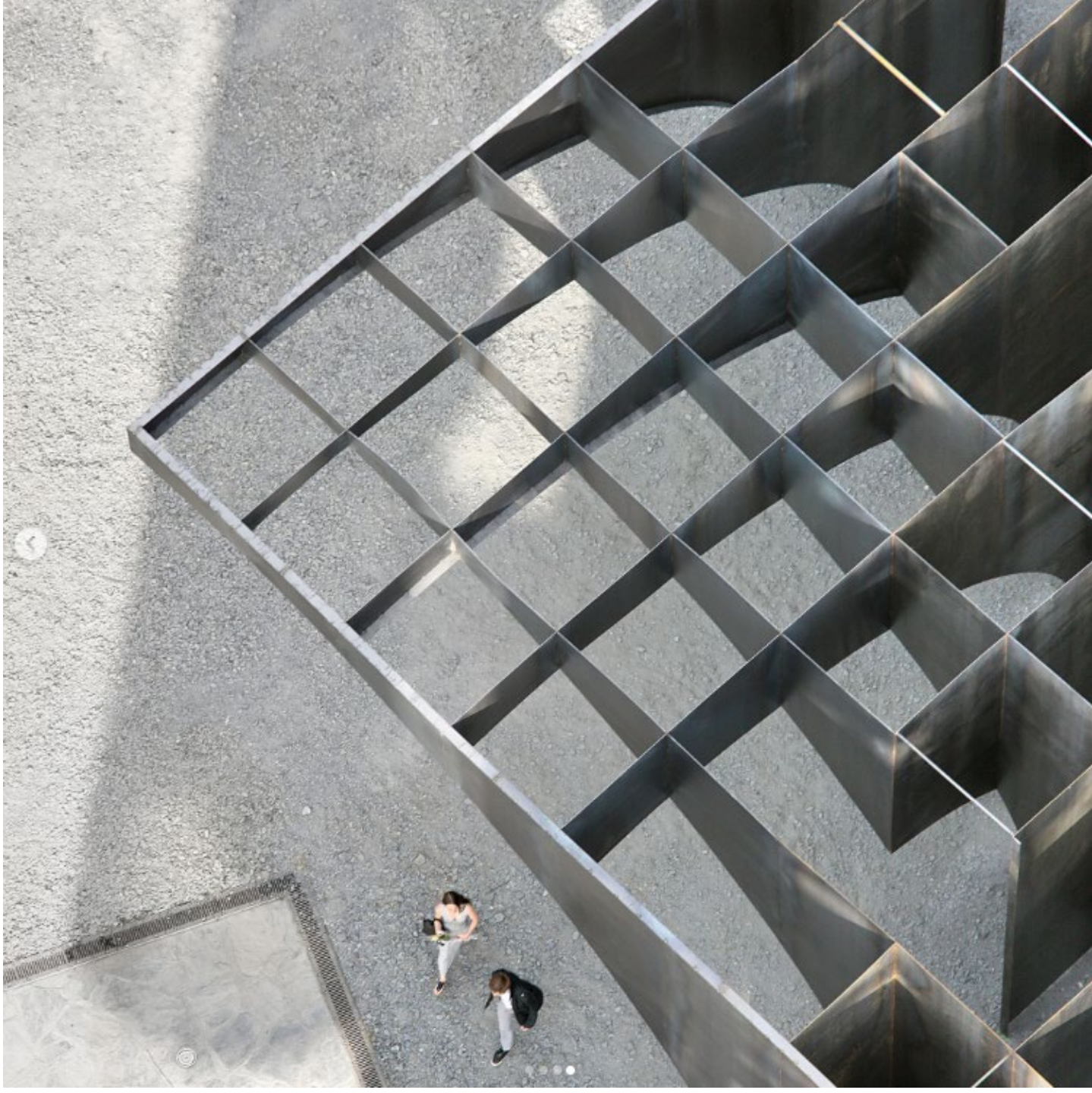
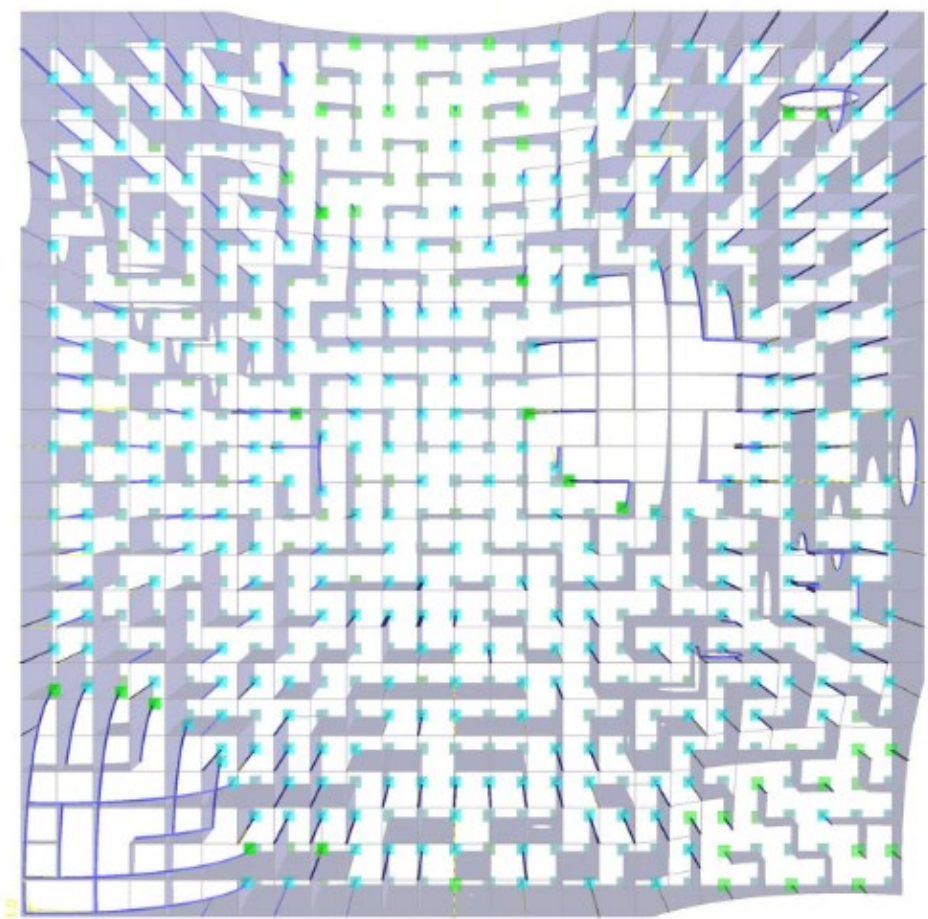

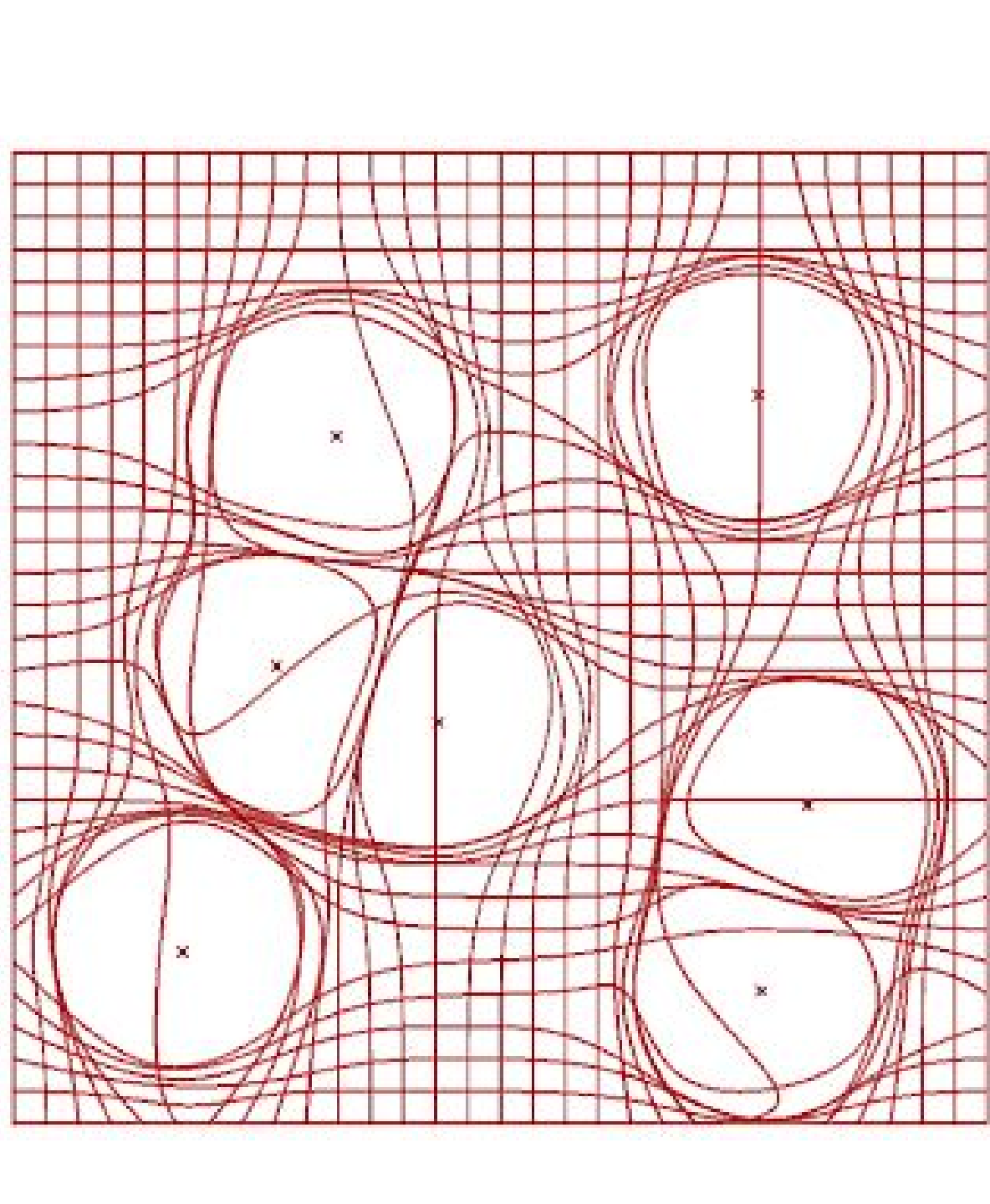
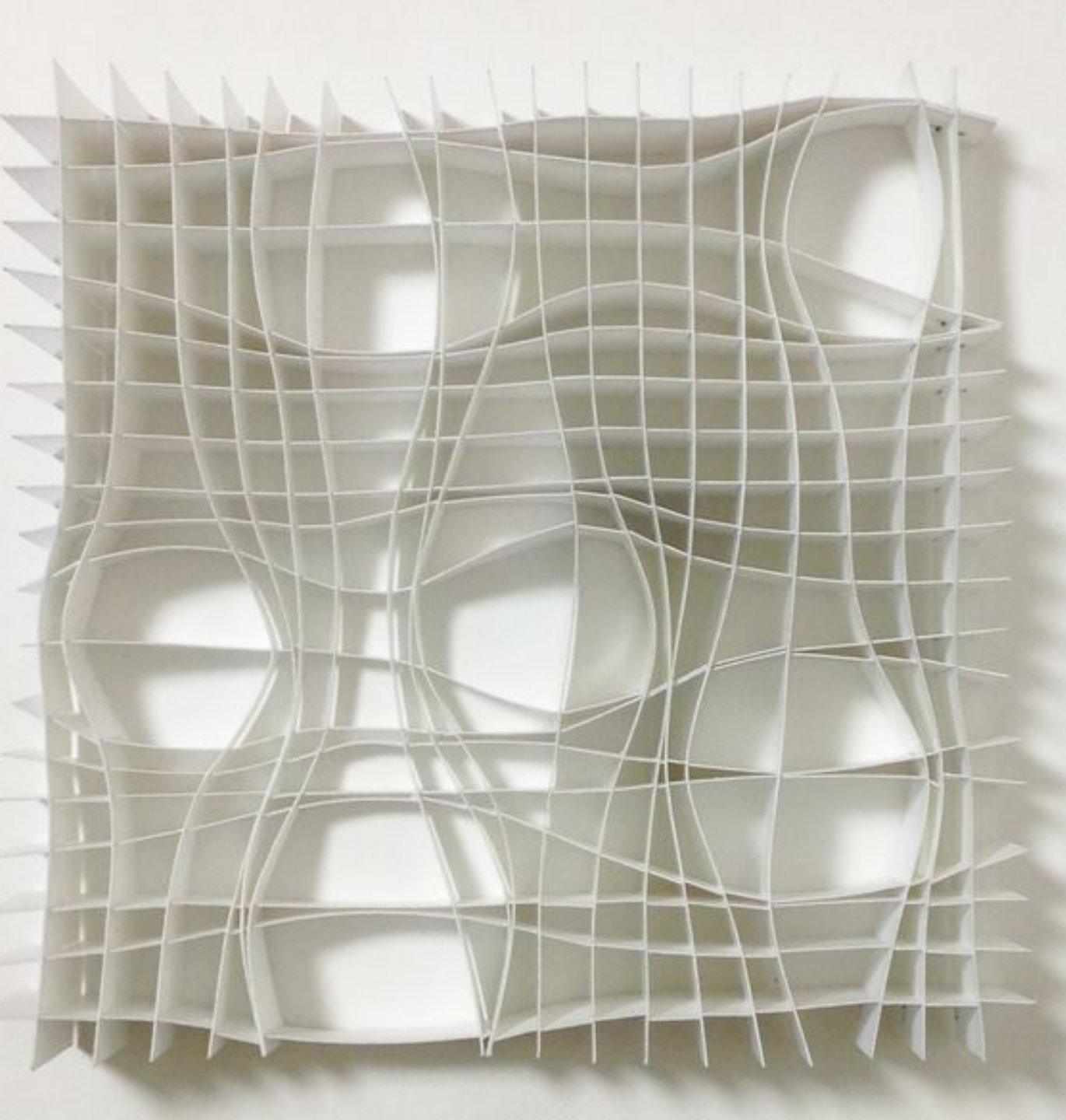

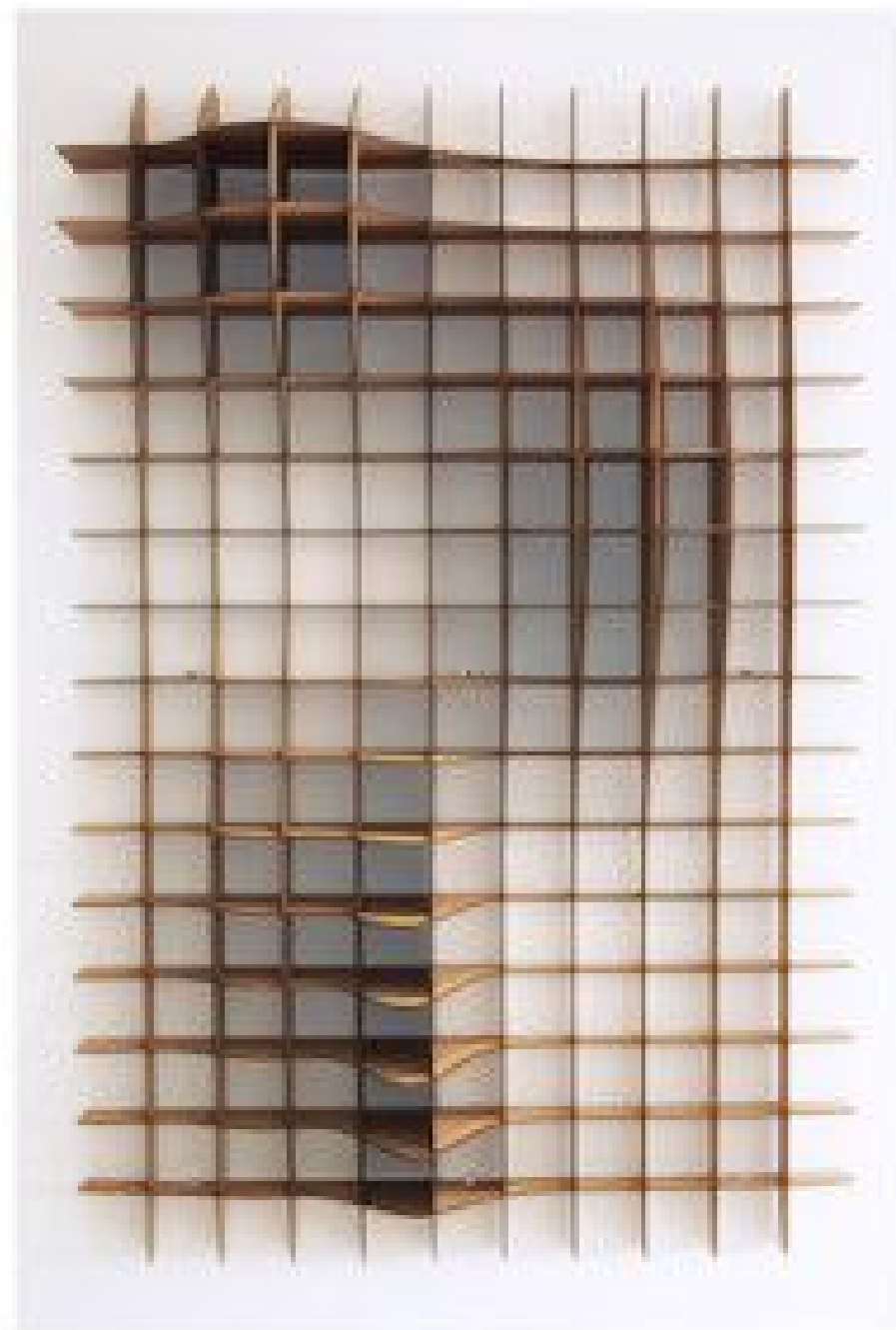

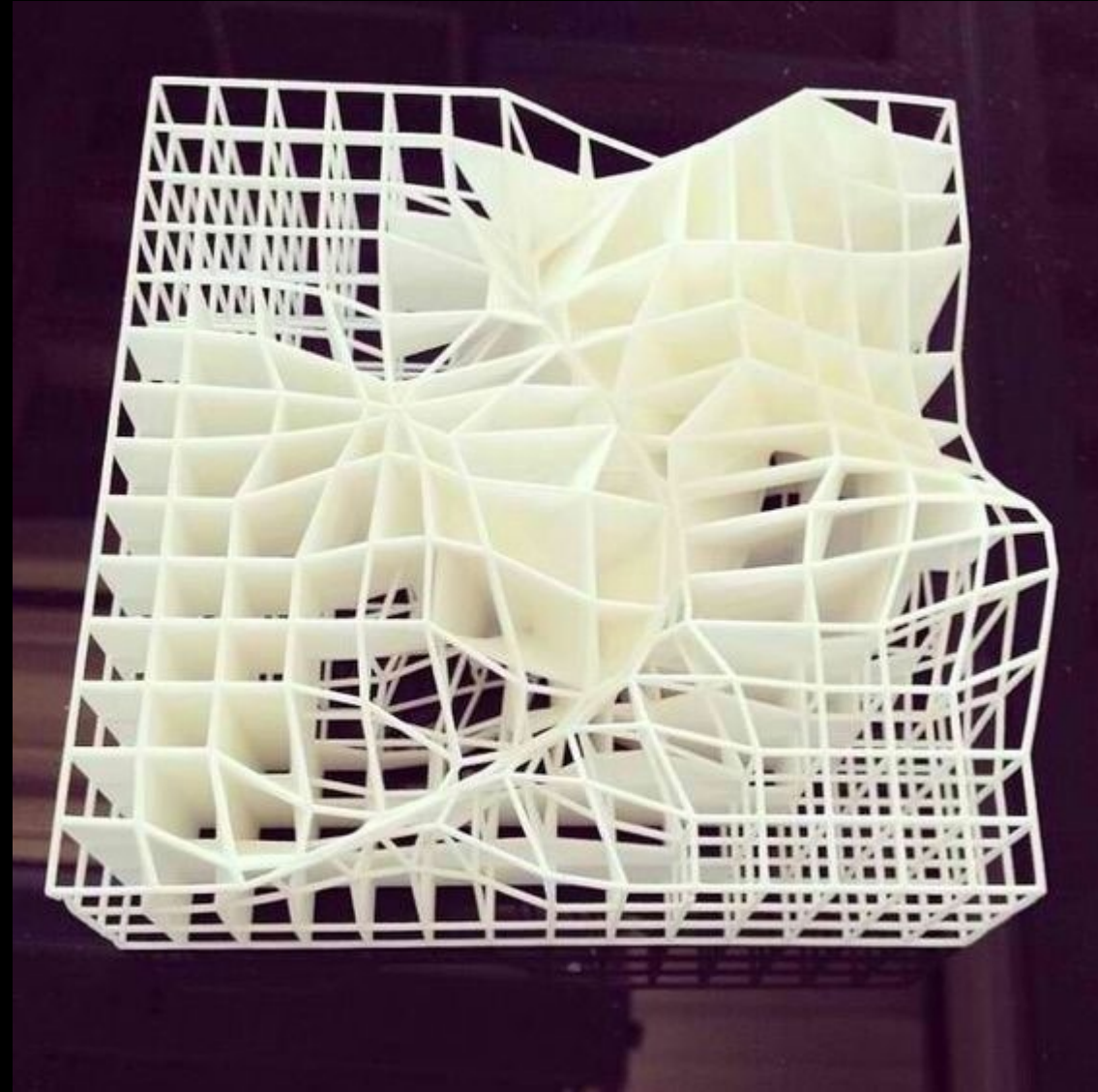

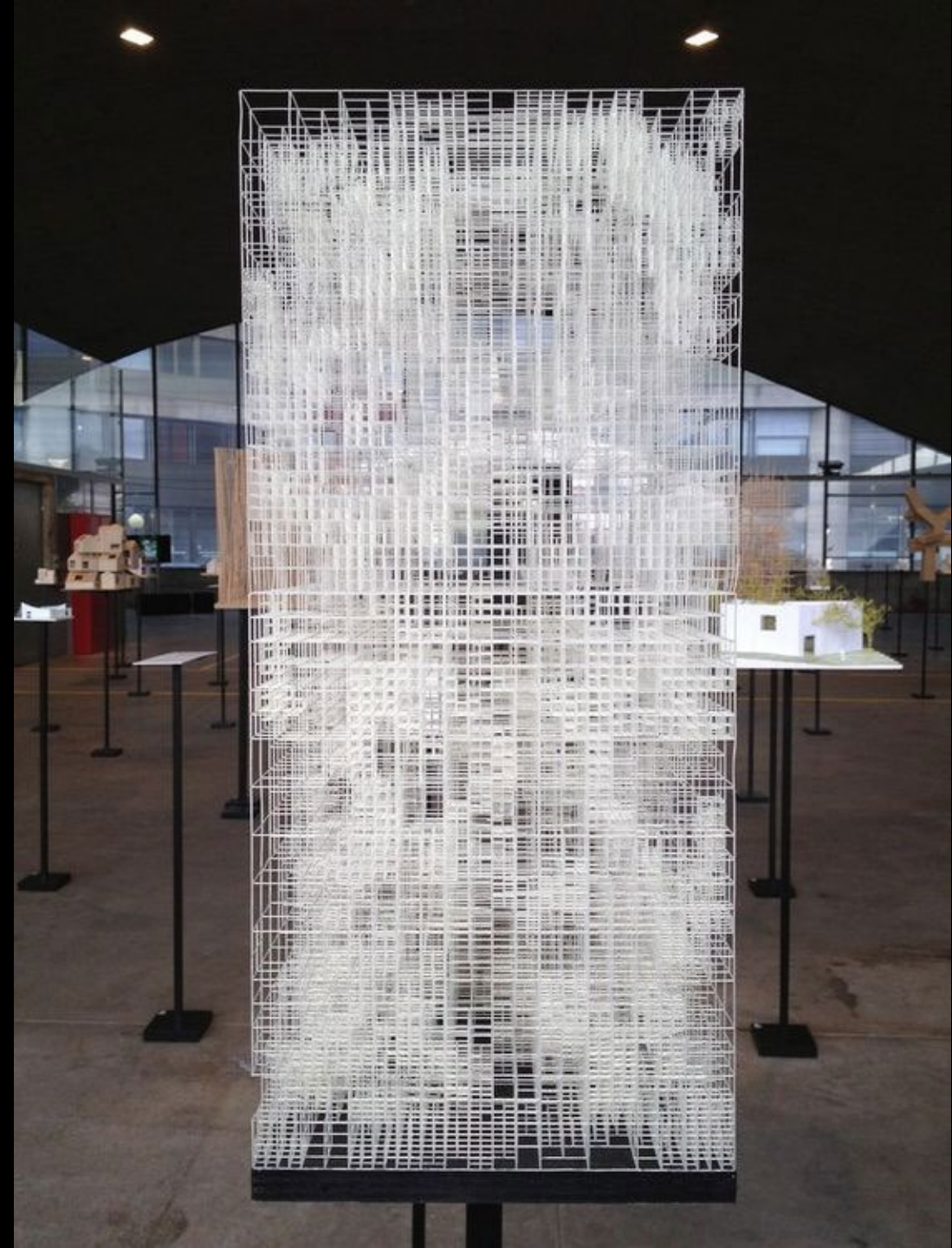
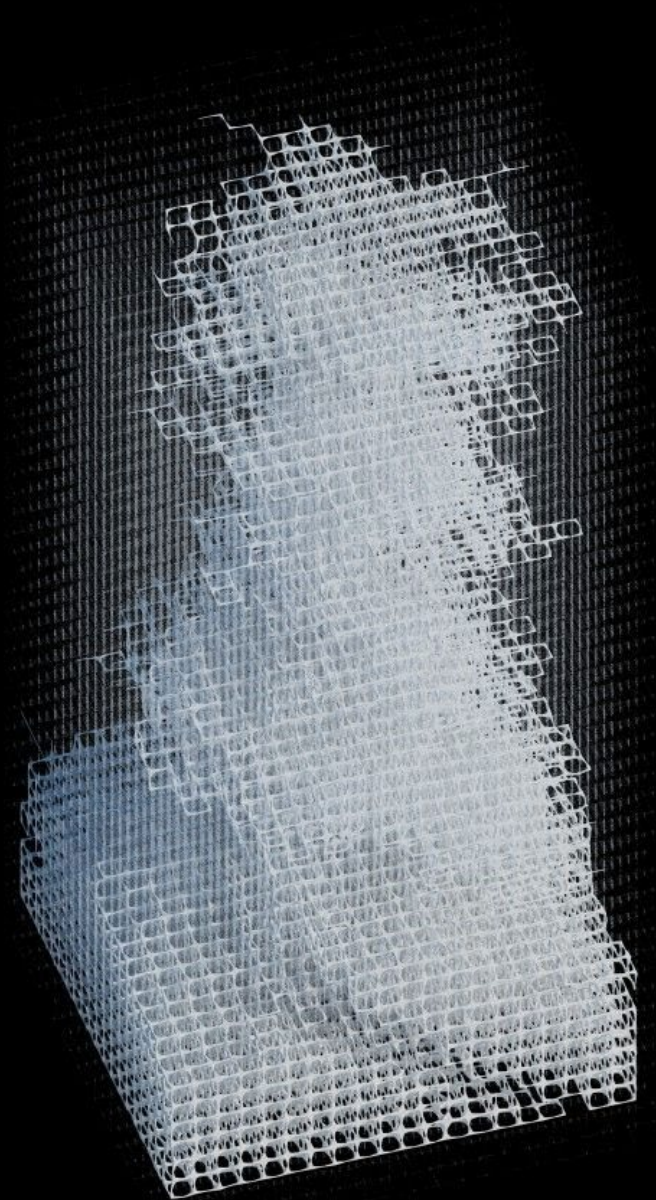

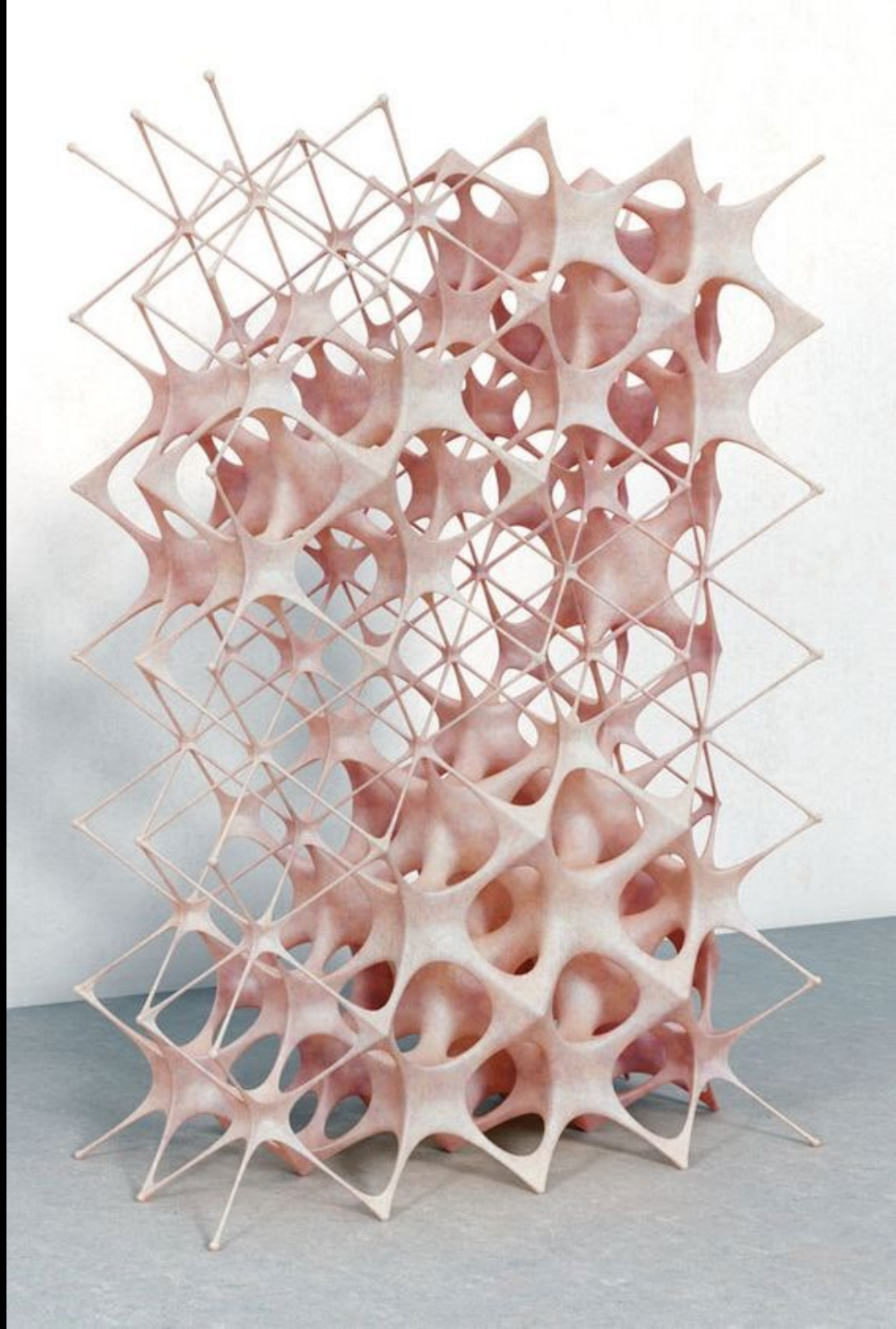
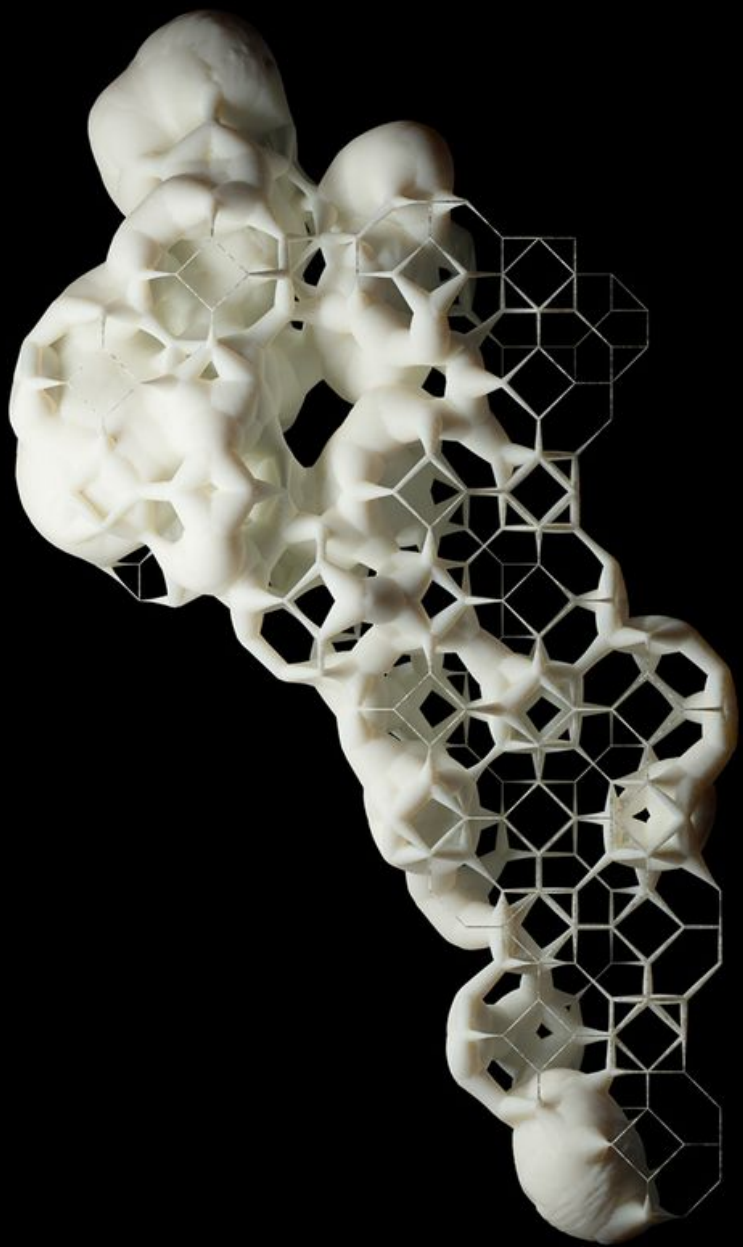



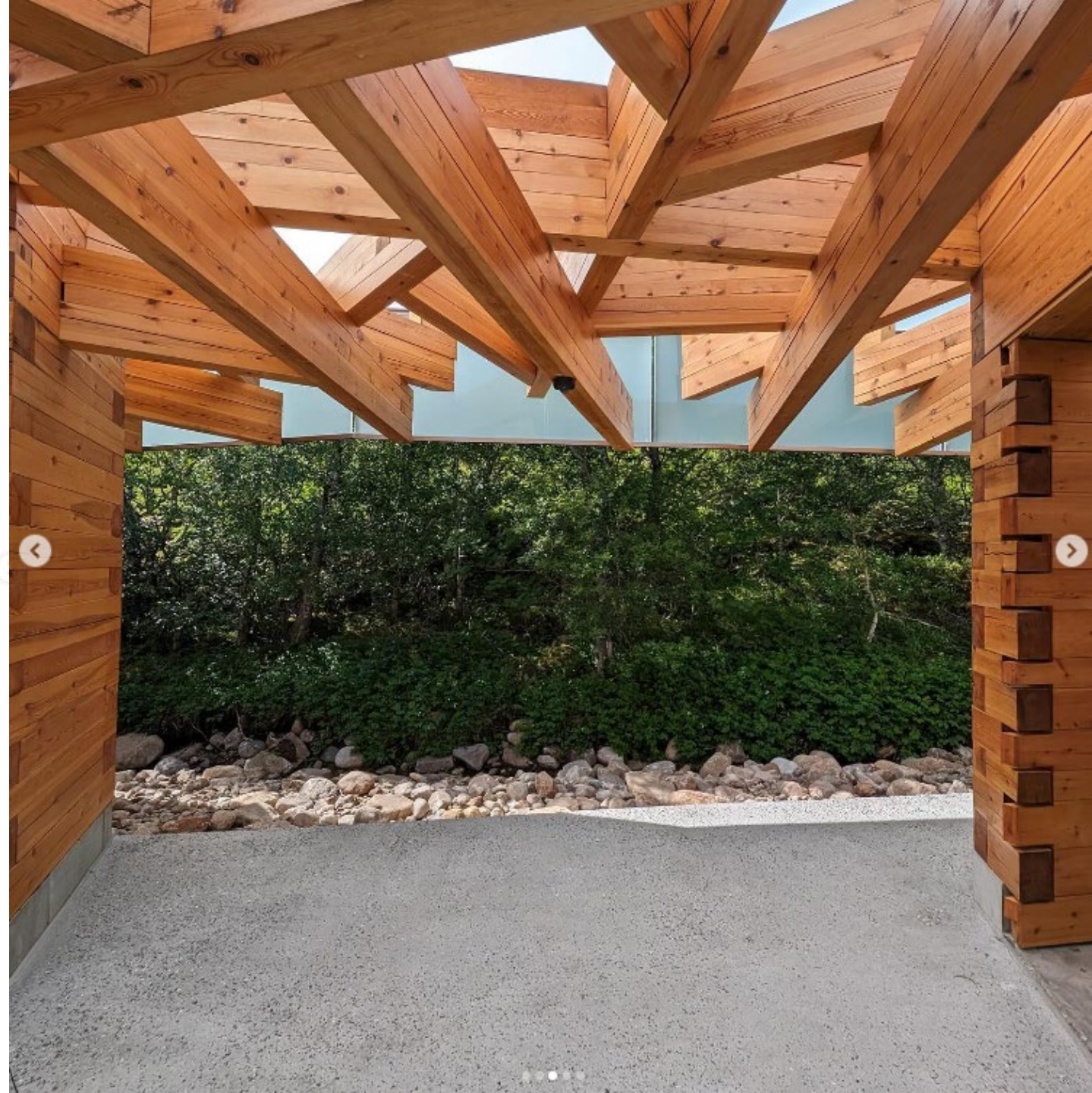
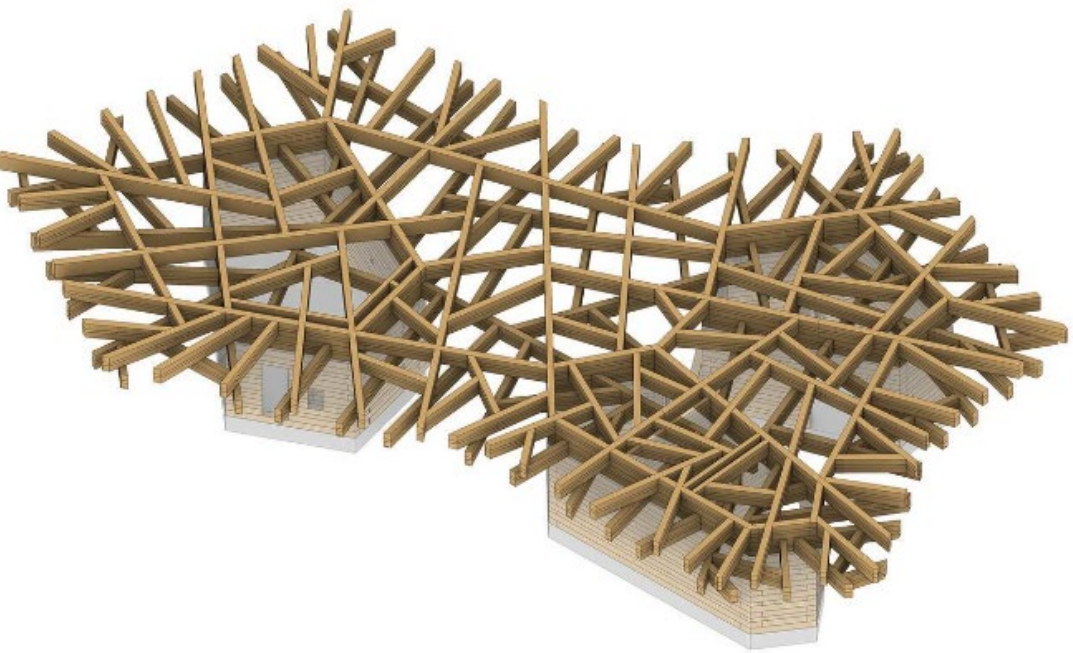

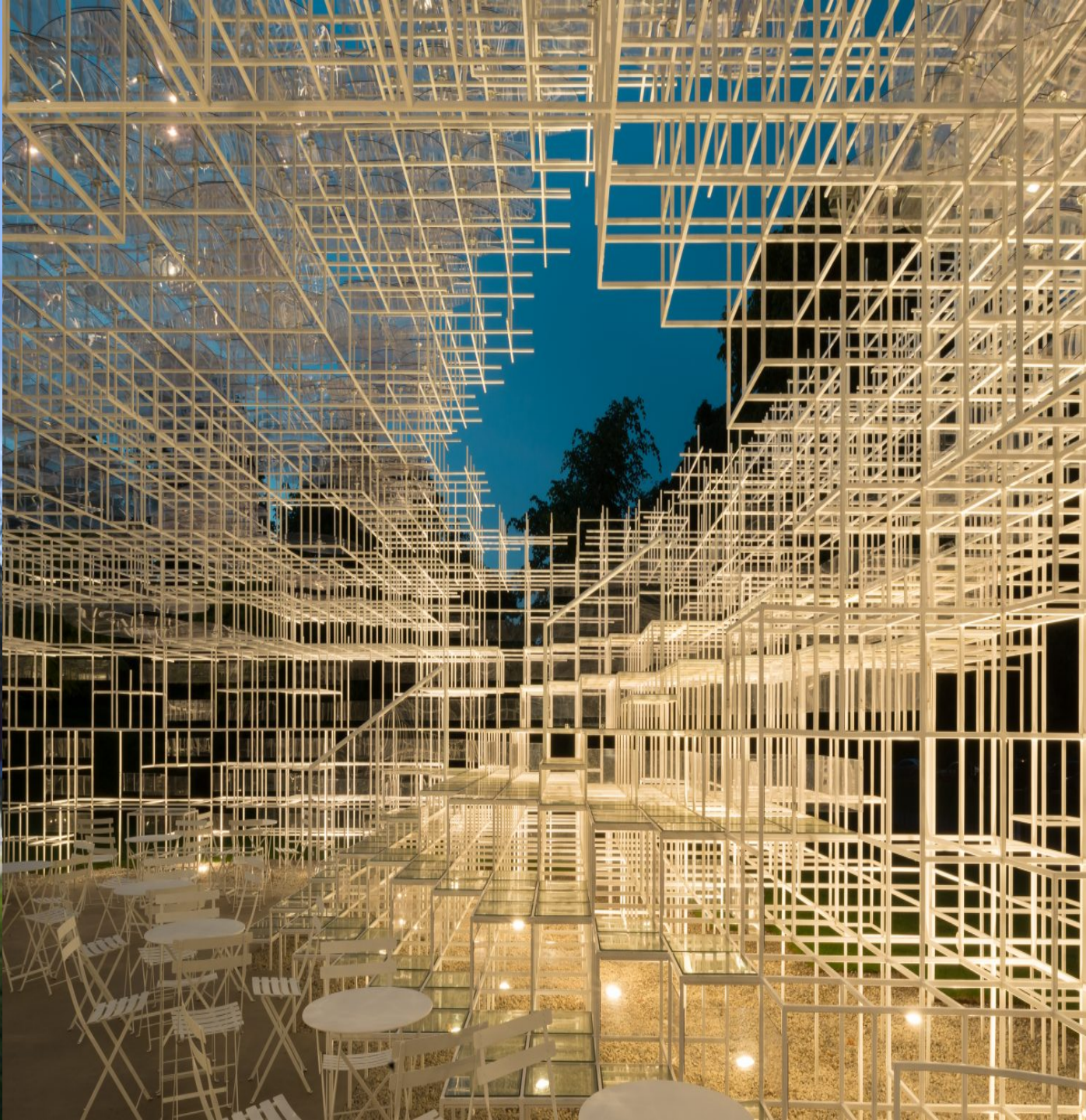
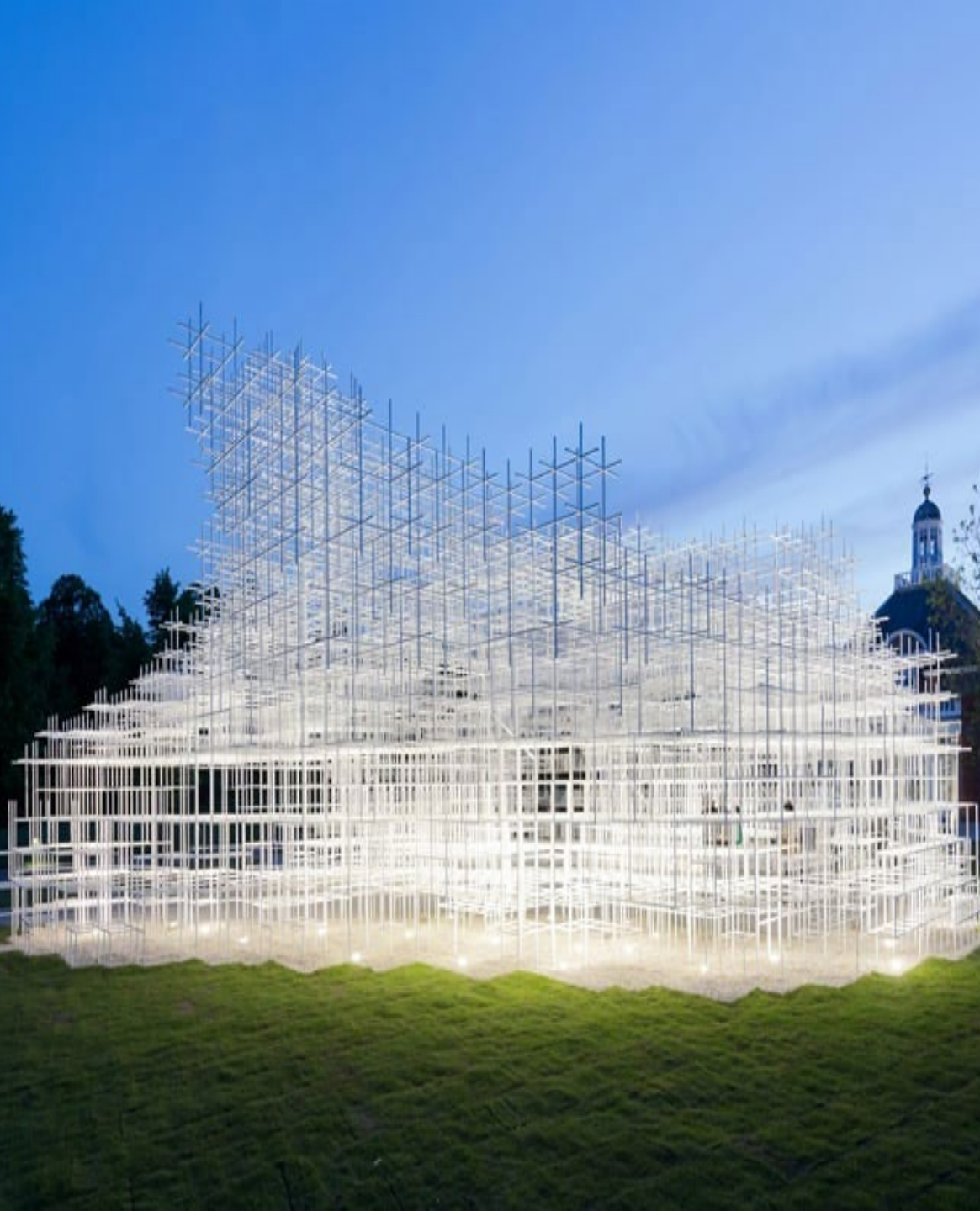





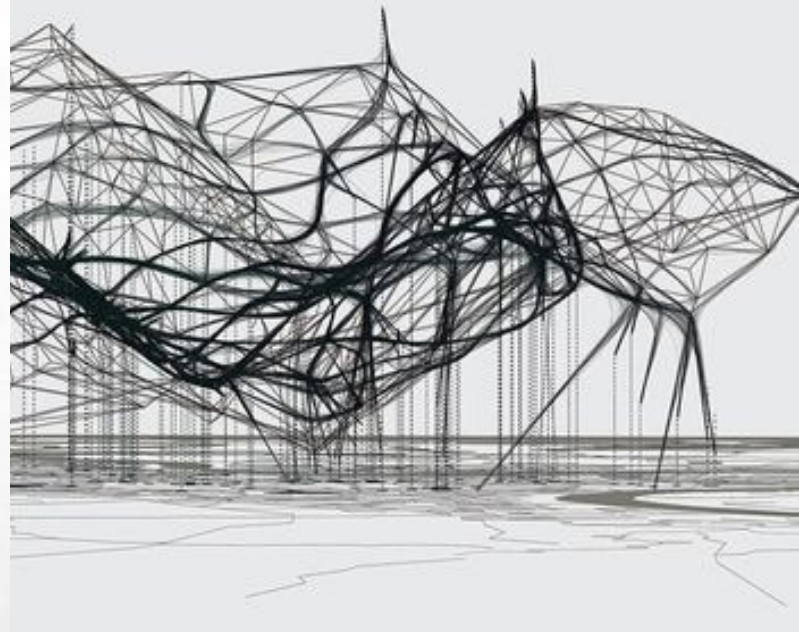
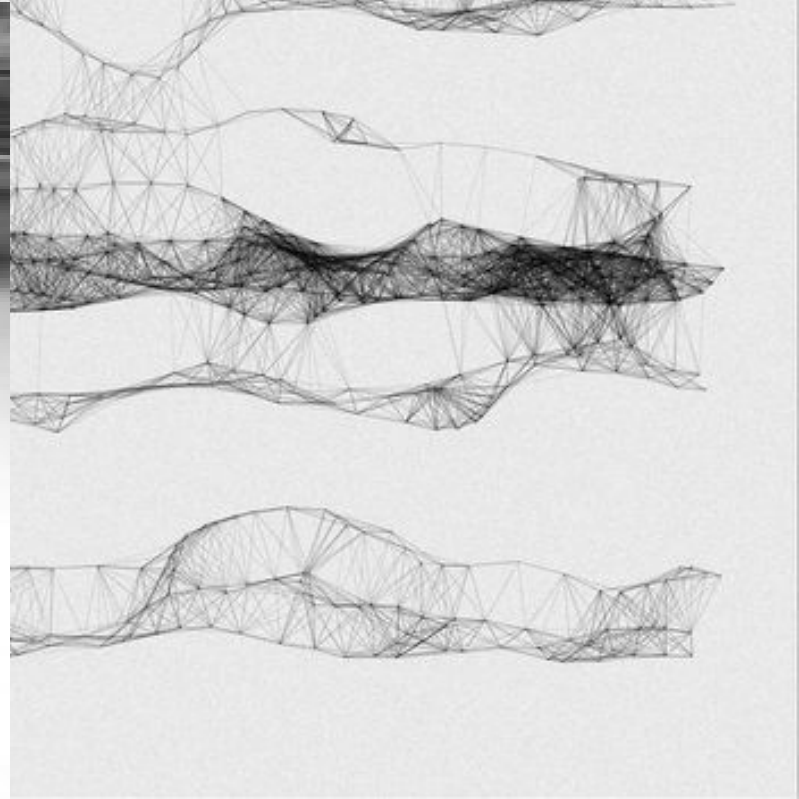
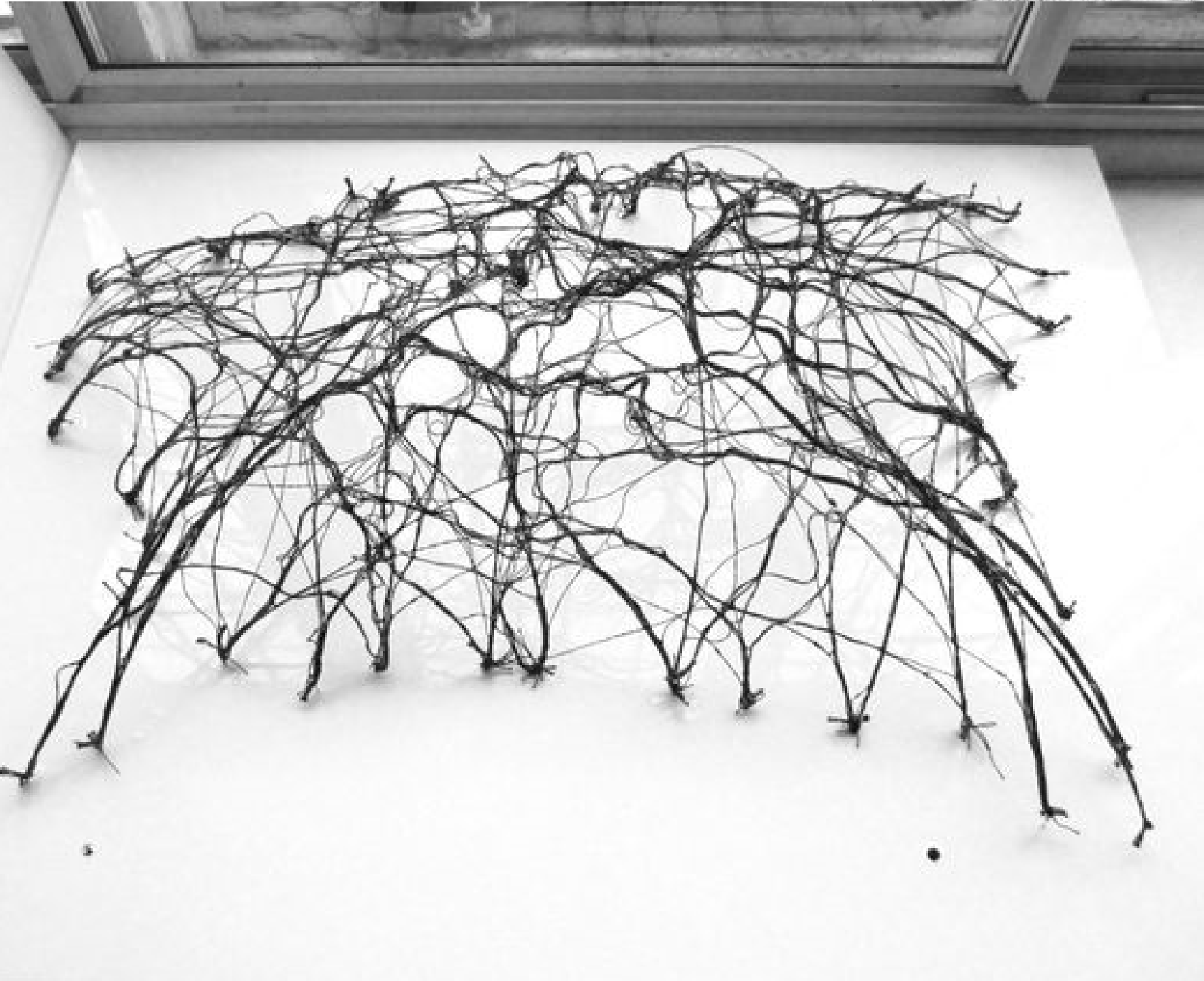

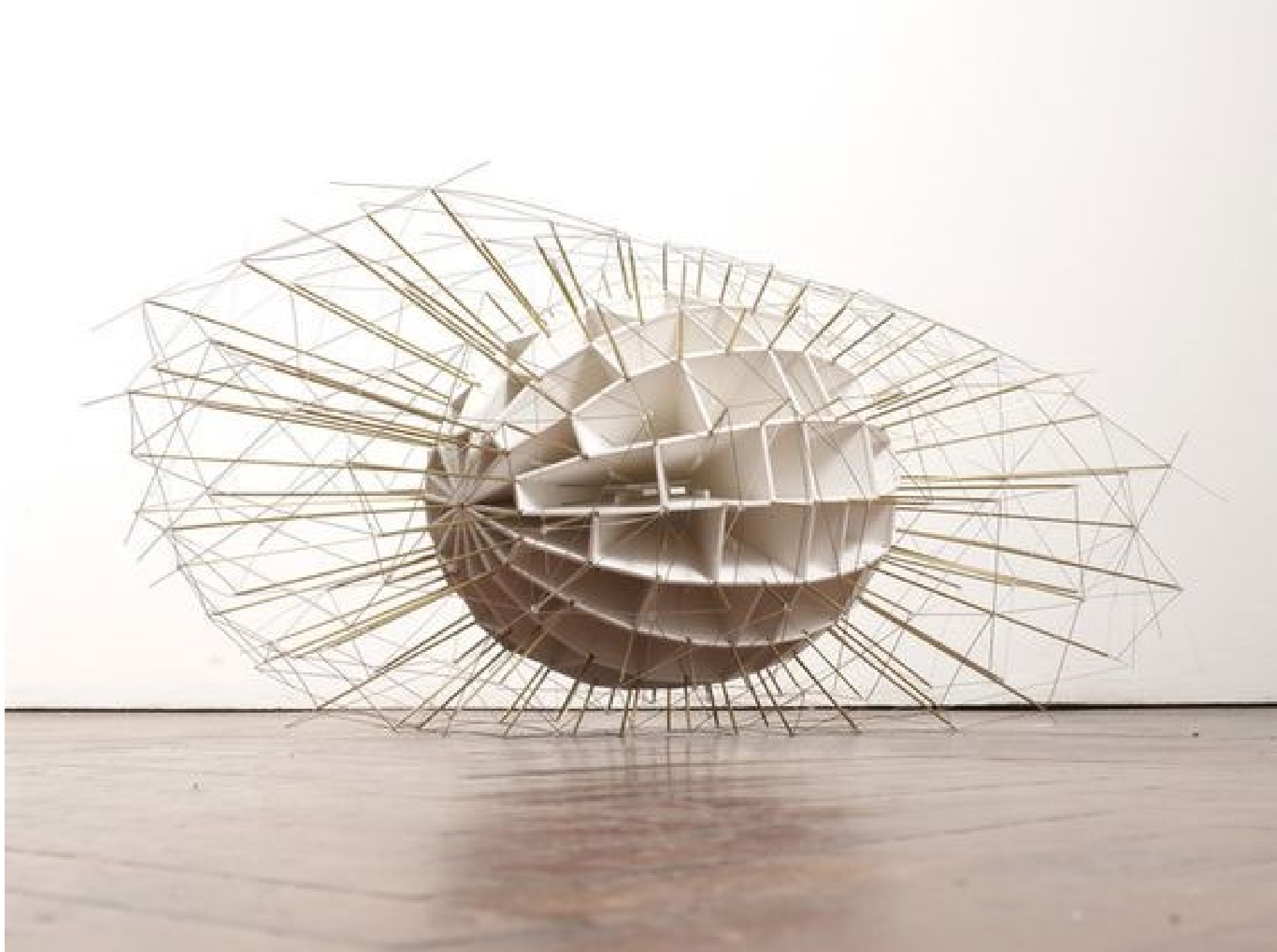

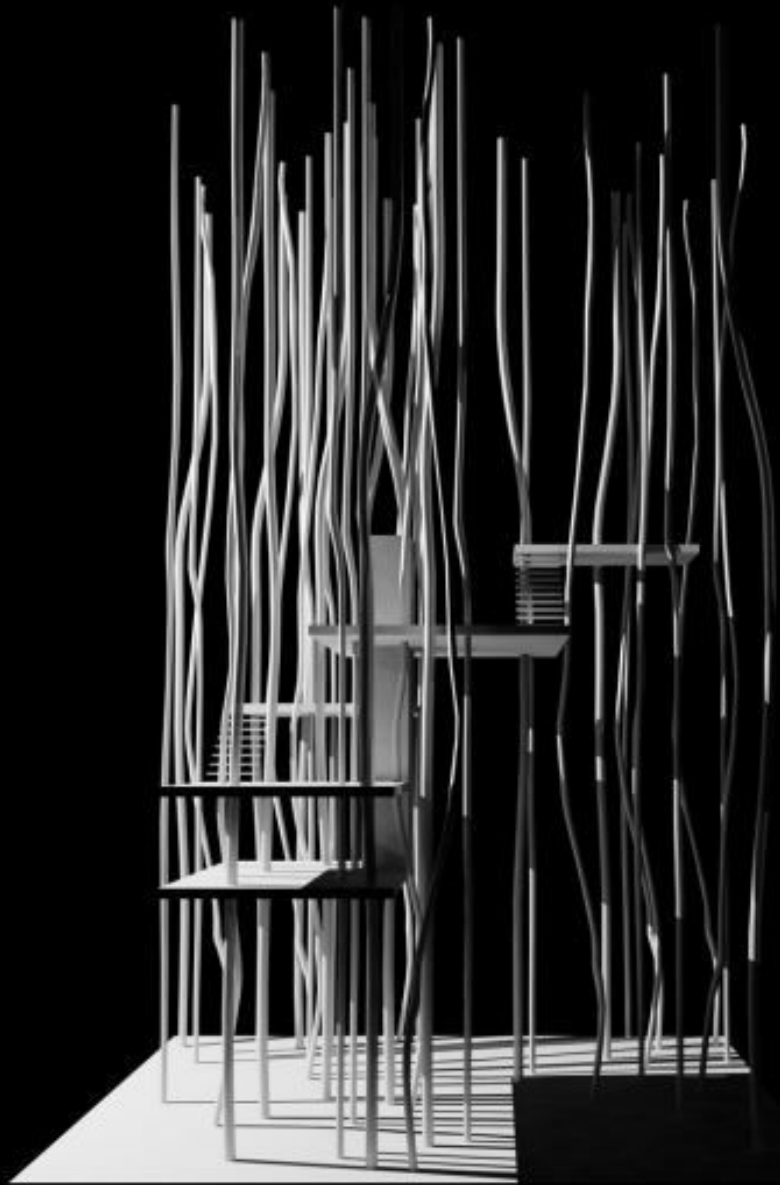



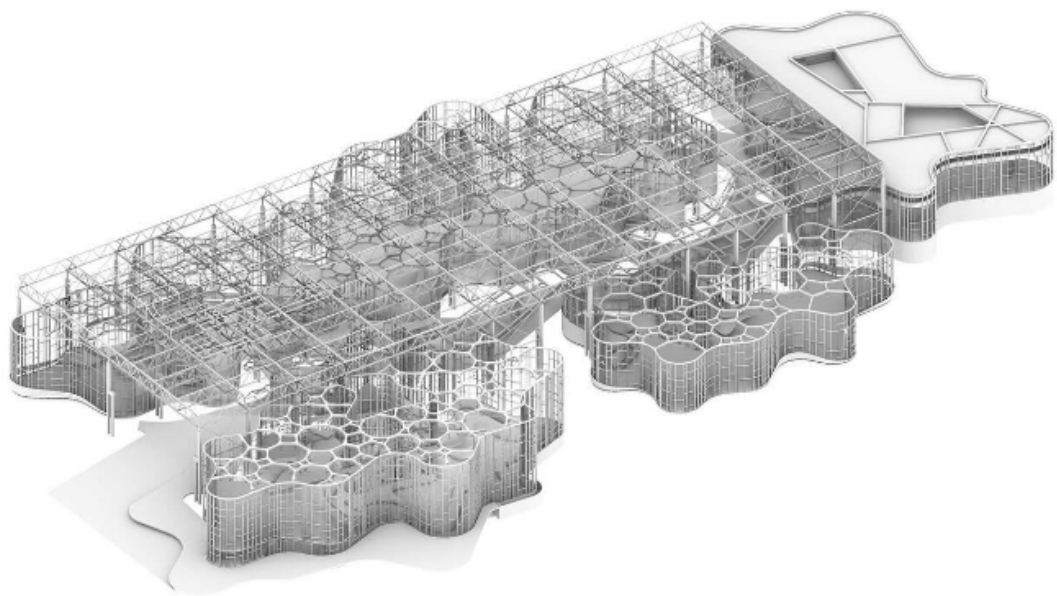



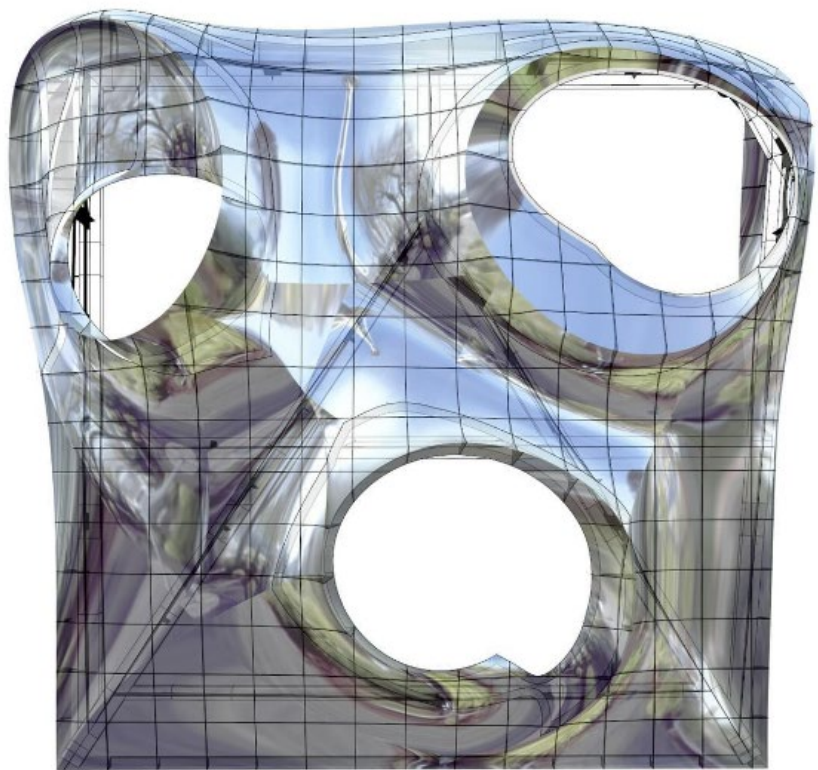



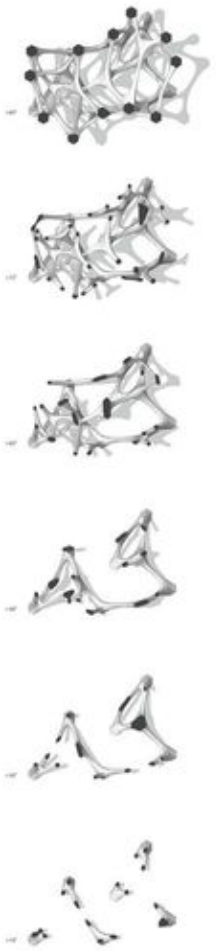
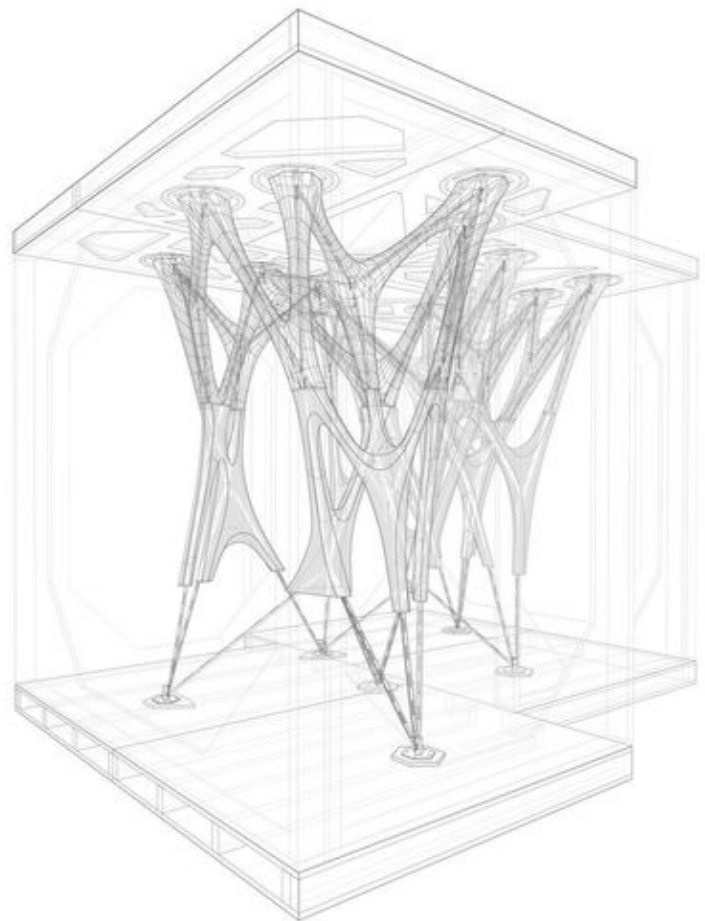

Form-Finding and Optimization

Network Tension Optimization

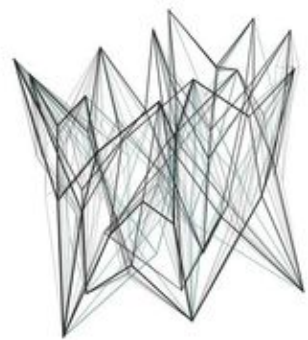

Mesh Subdivision Form-Finding

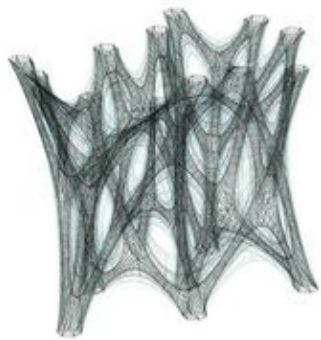

Mesh Relaxation

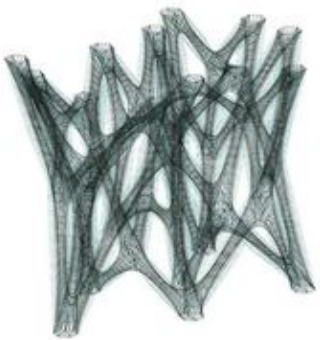

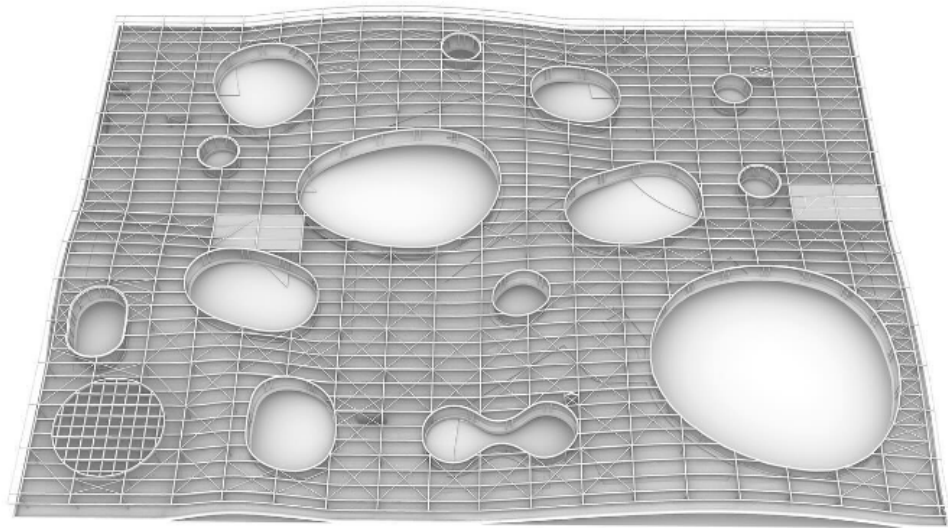

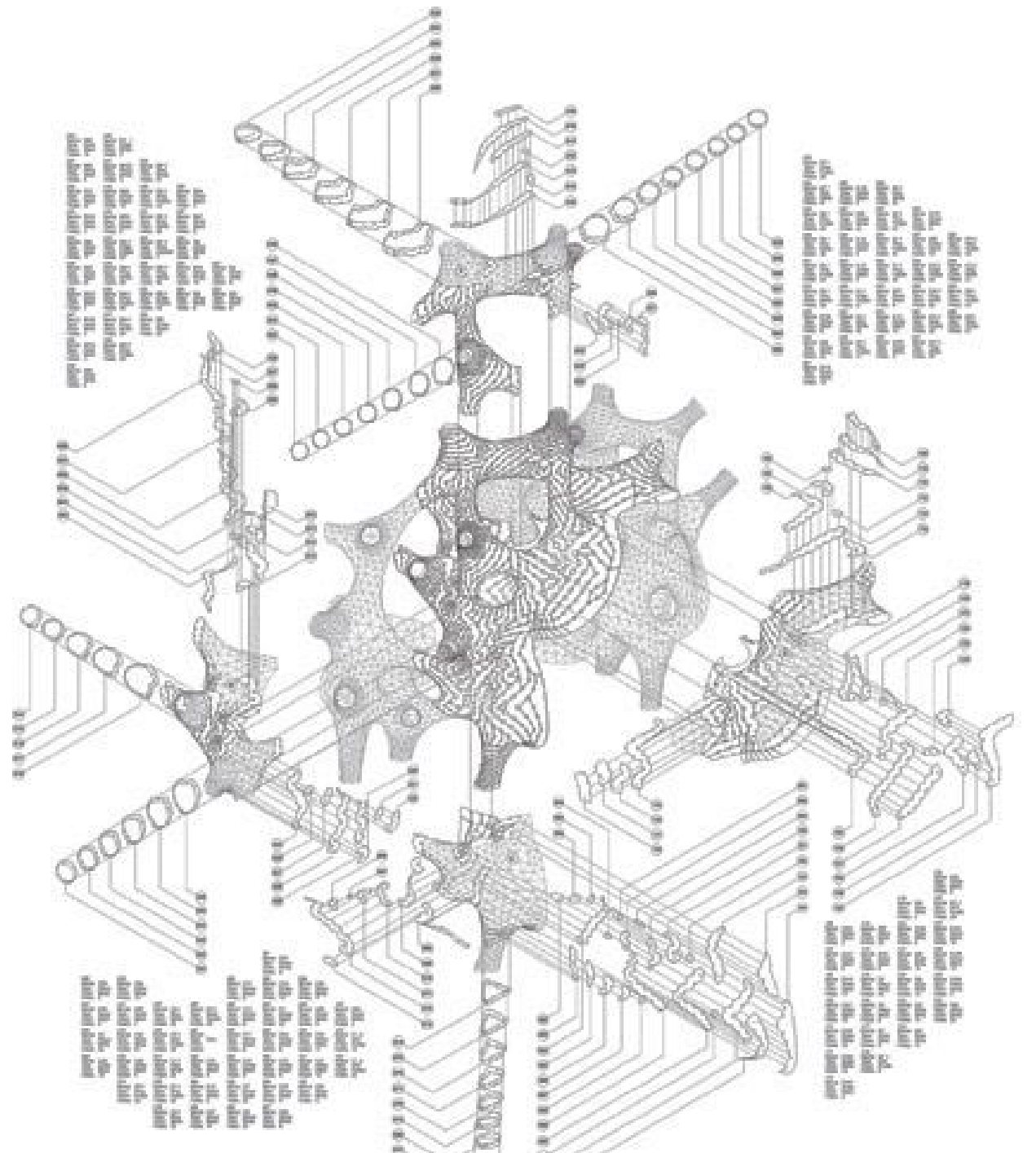
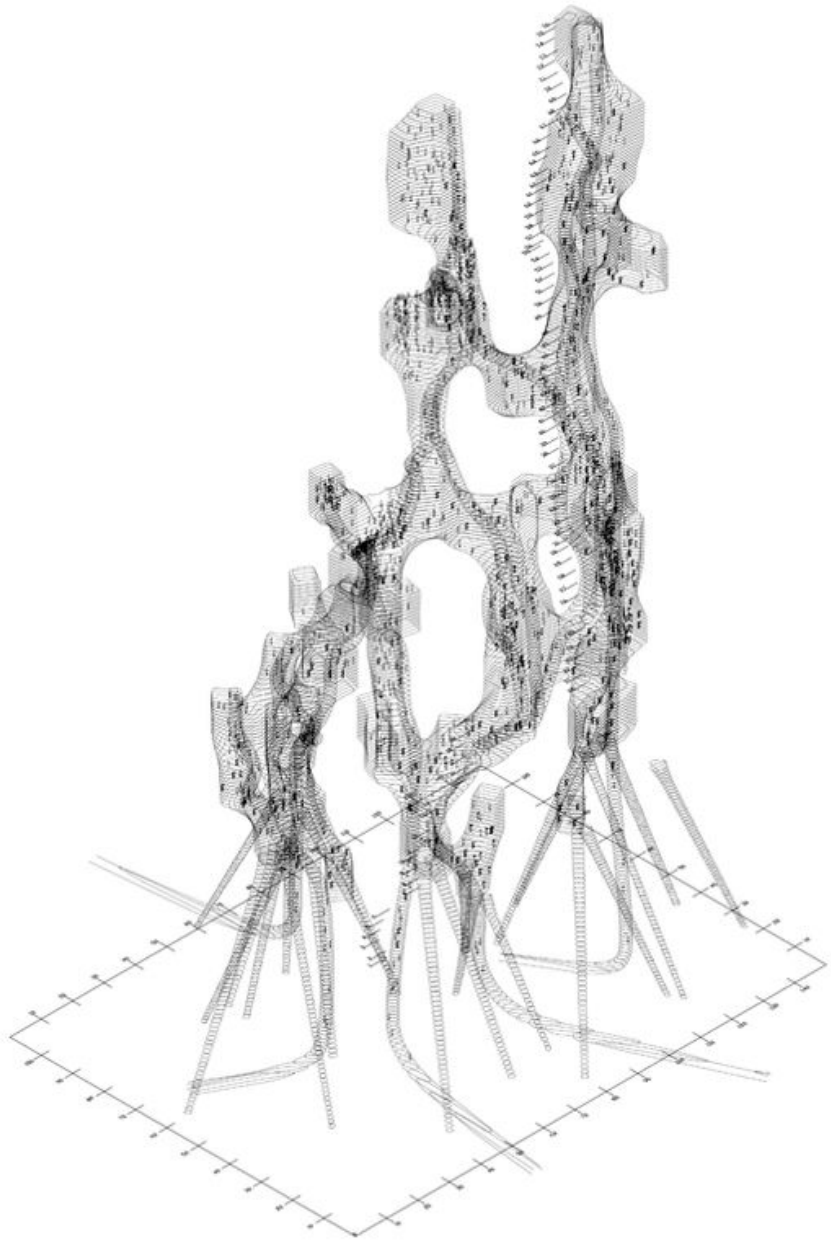







tensión/excitación intelectual

alimentadla, dadle de comer...

el proyecto como investigación

no se puede proyectar sin investigar

nosotros solo os podemos dar puntos de entrada