

Spellbound Castle

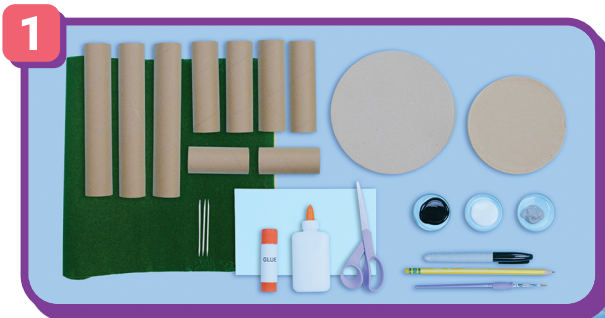

Gather Supplies

- Cardboard tubes
- Green and light blue paper
- Gray, black, and white paint
- Recycled circular boxes
- Pen, pencil, paintbrush
- White glue
- Glue stick
- Scissors

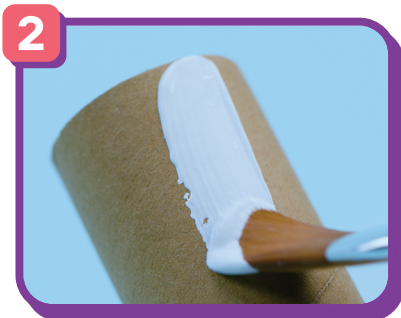

Prep Your Recyclables

Start by painting all your cardboard tubes, boxes, and toothpicks white. Let them dry.



Add Castle Details

Use gray and black paint to add fun details like windows and doors to the castle.



Create Green Spires

Cut out circles from the green paper, using larger circles for the tall spires, and smaller circles for short spires. Cut the circles in half, and then roll each half into a cone shape. Glue the edges to hold them closed.



Attach the Spires

Put glue around the top rim of each cardboard tube and attach a green spire. Repeat for all the tubes.

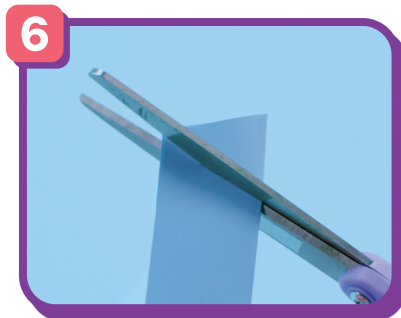

Make the Flags

Take a small rectangle of light blue paper, fold it in half, and cut out triangle shapes to make flags. Use a glue stick to put glue on one side of the flag, then stick a toothpick in the middle. Fold over to secure it.



Assemble Your Castle

Arrange the painted cardboard tubes and circular boxes in the shape of a castle and glue them down. Add the toothpick flags to the spires for a final touch.



Ask an adult to help with this project.