

fabuwood®

CUSTOMIZATIONS BROCHURE

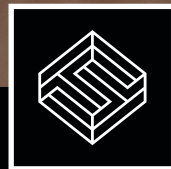

At Fabuwood, we create kitchens that make you feel at home.

Fabuwood's hand crafted and detailed customizations create industry leading products that are unique to you. To further understand our customization process, please review the following pages which include illustrations using stock doors. For those who want further customization, we offer custom sized doors for a limited number of door styles.

Please know this is only a basic overview of the modifications we provide. To find out more about our full customization options or to get a price quote, please reach out to your Fabuwood sales rep with a detailed drawing.

CONTENTS

page **05** Cabinet Size Modifications

page **13** Cabinet Chase Cut-Outs

page **17** Custom-size Columns & Returns

page **21** Product Customizations

page **37** Customizations Examples

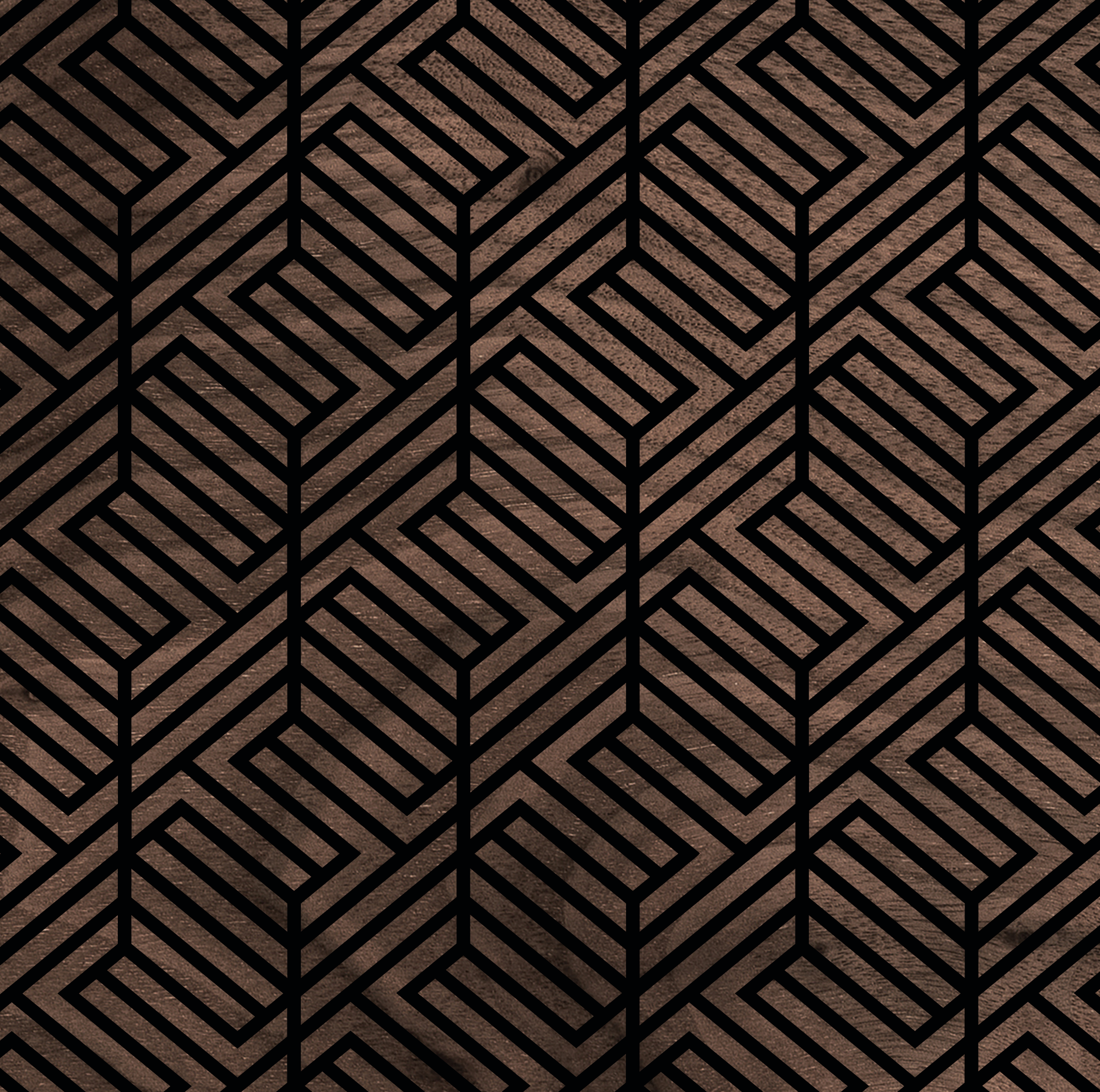

CABINET SIZE MODIFICATIONS

Reduce Depth of a Wall Cabinet (min. depth 3")

MOD# CUT-WALL

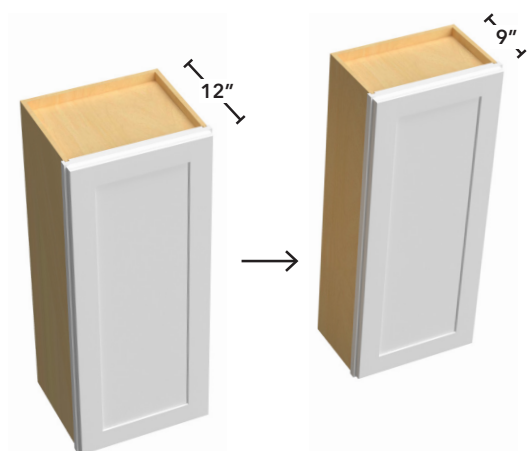

Wall cabinets have a standard depth of 12". Generally, modifications will be made in 3" increments, but can also be cut to custom sizes such as 5", 5-1/4", or 5-1/2" deep. Wall cabinets can be cut to any size, with a minimum depth of 3".

Please note: For a No Door wall cabinet, wood shelves will be provided instead of glass shelves.

Increase Depth of Wall Cabinet (max. depth 30")

MOD# INCREASE-WALL

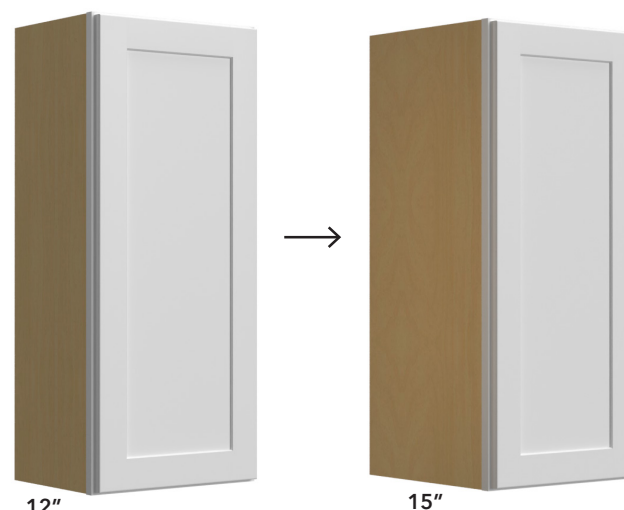

Fabuwood's standard wall cabinet are 12" deep. Cabinet depth can be increased up to 30".

Please note: For a No Door wall cabinet, wood shelves will be provided instead of glass shelves.

Cut Height of RHA Hood (suggested min. height 24")



Please note: Requires custom doors. Custom quote required.

Reduce Depth of Base Cabinet (min. depth 12")

MOD# CUT-BASE

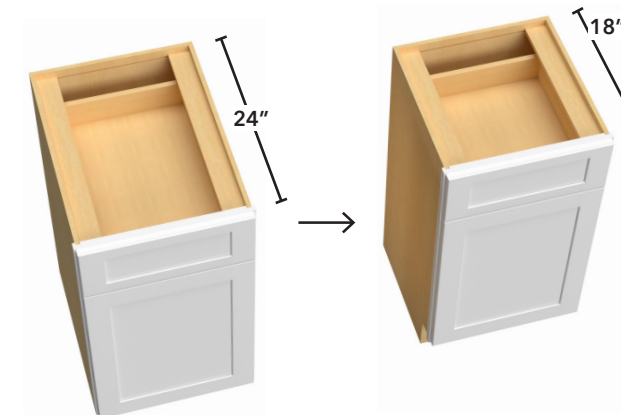

The standard depth of a base cabinet is 24" deep. Generally, customizations are done in 3" increments, but can also be done to any custom size, such as 16", 17", or even 17½" deep. Base cabinet must have a minimum depth of 12". The drawer box will be cut to 3" less than the cabinet depth. To accommodate the drawer slides, the drawer box can only be cut in 3" increments.

Reduce Width of a Wall Cabinet

SKU# CUT-WIDTH WALL

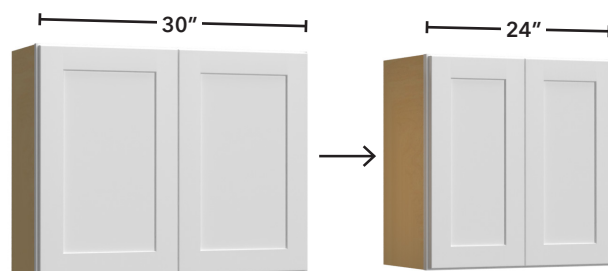

Please note: May require custom doors. Custom quote required.

Reduce Height of a Wall Cabinet

SKU# CUT-HEIGHT WALL

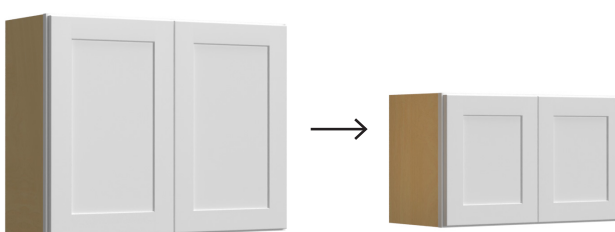

Please note: May require custom doors. Custom quote required.

Increase Depth of Base Cabinet

MOD# INCREASE-BASE

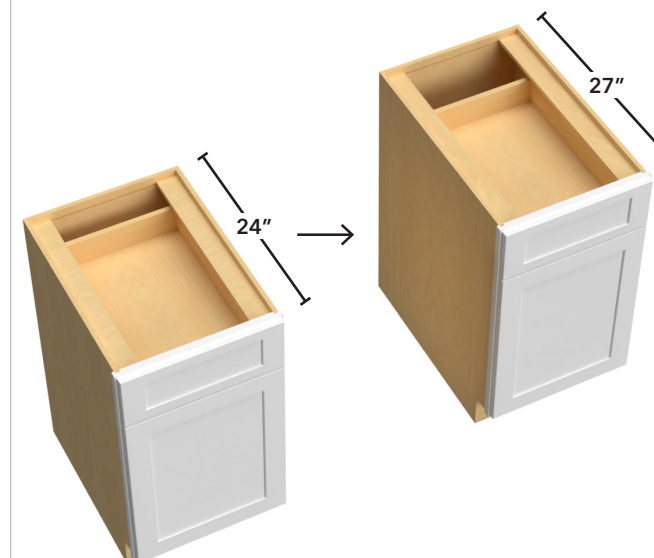

Cabinet depth can be increased to any size. The drawer depth will remain 21".

Reduce Width of a Base Cabinet

SKU# CUT-WIDTH BASE

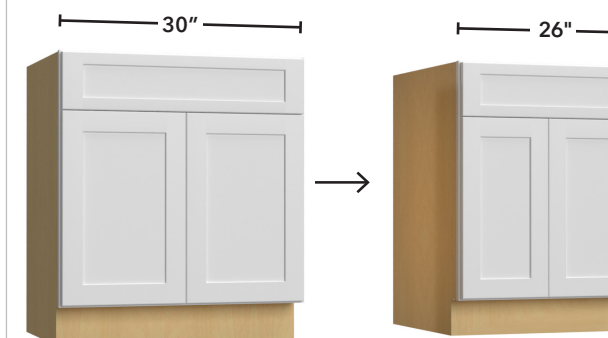

Available for both Allure and Illume. A custom quote is required as custom doors may be required.

Reduce Height of Base Cabinet

MOD# CUT-BASE HEIGHT

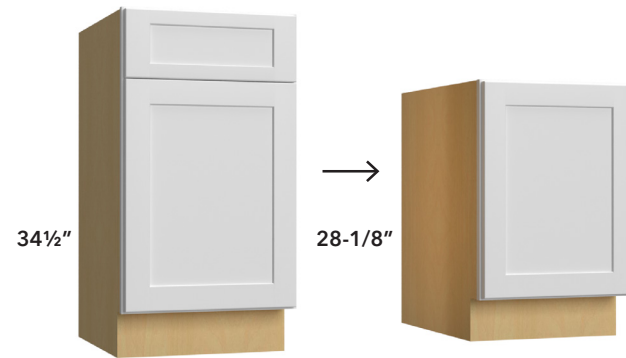

The height of a base cabinet can be cut right above the door, eliminating the drawer. Available on base cabinets with standard drawer front height.

The total height will be:

Allure 28-1/8"

Value - Quest 28-1/2"

Reduce Toe Kick Height

MOD# CUT-TK



Fabuwood can reduce the height of the toe kick in 1/4" increments or remove the toe kick completely.

Please note: Cabinet is not designed to use as a wall hung cabinet.

Reduce Depth of a Tall Cabinet (min. depth of 4")

MOD# CUT-TALL

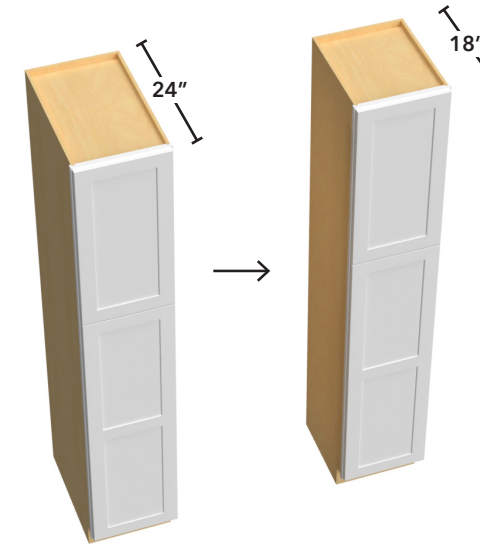

Tall cabinets are available in 12" and 24" deep. Fabuwood can cut the depth of a tall cabinet to customer specifications with a minimum depth of 4".

Increase Depth of Tall Cabinet (max. depth 30")

MOD# INCREASE-TALL

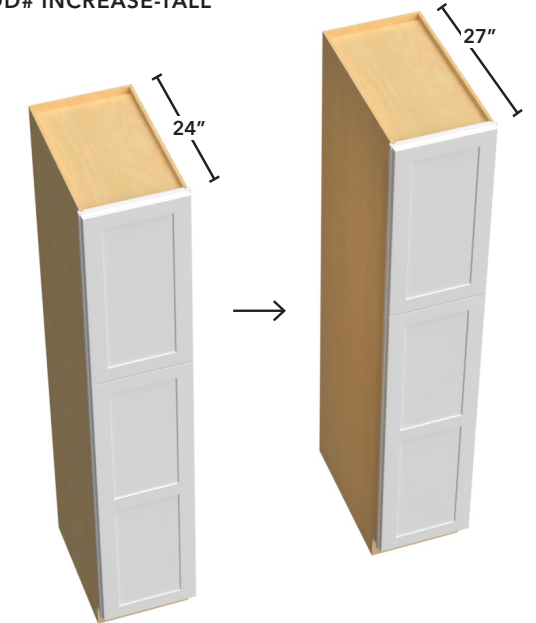

Fabuwood offers 12"D and 24"D tall cabinets. Fabuwood can increase the depth of any tall cabinet up to 30"D.

Reduce Depth of Drawer Base Cabinet (min. depth 12")

MOD# CUT-DBASE

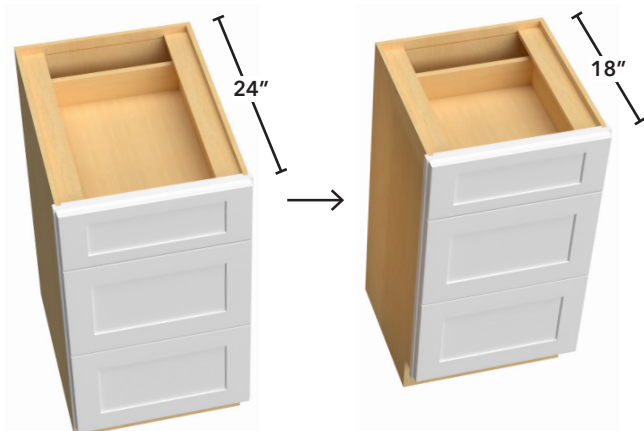

Fabuwood can cut the depth of a drawer base cabinet to customer specifications. Please note the depth of all three drawer boxes will be 3" less than the cabinet box. For example, when a cabinet is cut to 18" deep, the drawer boxes and slides will be 15" deep.

Reduce Depth of Sink Base Cabinet (min. depth of 4")

MOD# CUT-SBASE

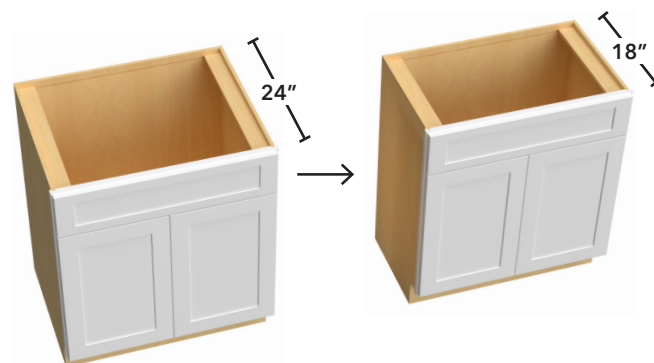

Sink base cabinets can be cut to a minimum depth of 4". Generally, customizations are done in 3" increments, but can also be modified to any custom size, such as 16", 16-1/4" or 16-1/2" deep.

Reduce Width of a Tall Pantry

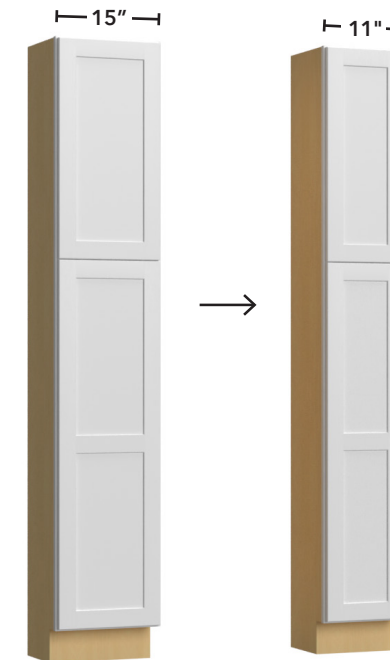

Please note: May require custom doors. Custom quote required.

Reduce Width of Oven Cabinet



Please note: May require custom doors, drawer fronts & drawer boxes. Custom quote required.

Reduce Height of Tall Pantry or Oven Cabinet

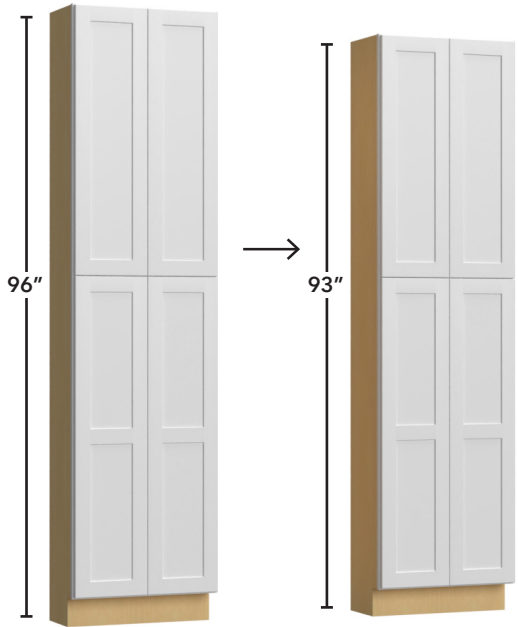

Please note: May require custom doors. Custom quote required.

Reduce Depth of KD30 Cabinet (min. depth 12")

MOD# CUT-KD30

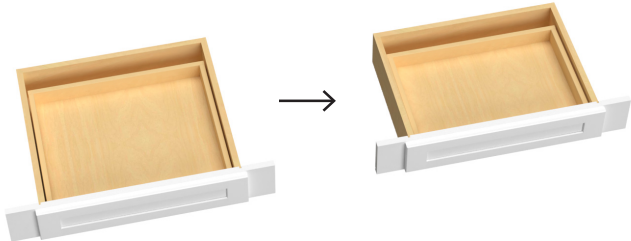

Fabuwood can modify the depth of any knee drawer in 3" increments. The drawer box will be 3" less than the cabinet depth. For example: if a base cabinet is cut to 18" deep, the drawer box and slides will be 15" deep.

Cut Width of Filler on Return Panel, and Finished Cut Side

MOD# CUT-RETURN WIDTH

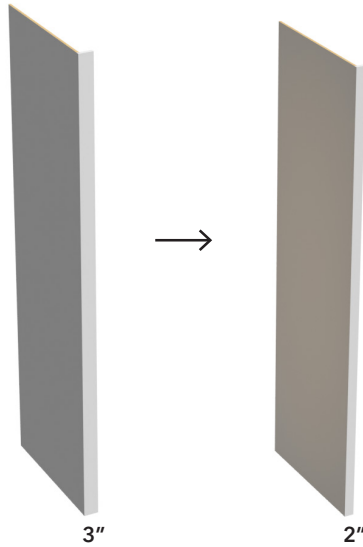

Cut Panel

MOD# CUT-PANEL

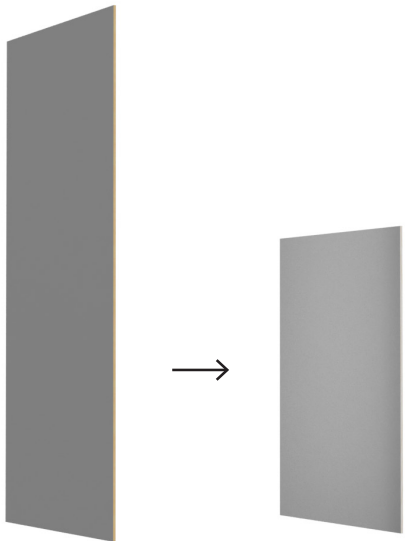

Customer can also add matching color edge-band for Fabuwood to apply, or to ship loose.

Reduce Depth of a Roll-Out Drawer

SKU# CUT-ROD

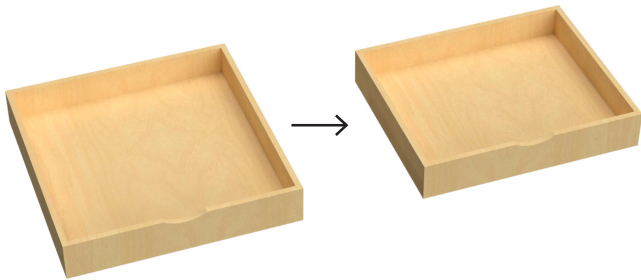

Reduce the depth of a roll out drawer when a cabinet is less than 24" deep.

The rollout drawer boxes will be cut to 3" less than the cabinet depth. To accommodate the drawer slides, the drawer box can only be cut in 3" increments. The minimum depth of a base cabinet must be 12" for rollout application.

Please note: The back of the rollout will no longer be dovetail.

Reduce Depth of a Column

MOD# CUT-COLUMN

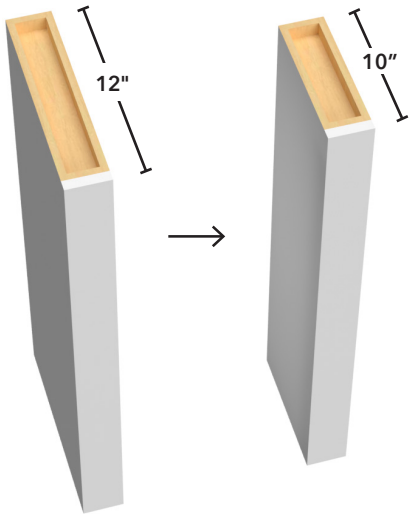

Columns can be reduced to any depth from 12" deep in 1/4" increments.

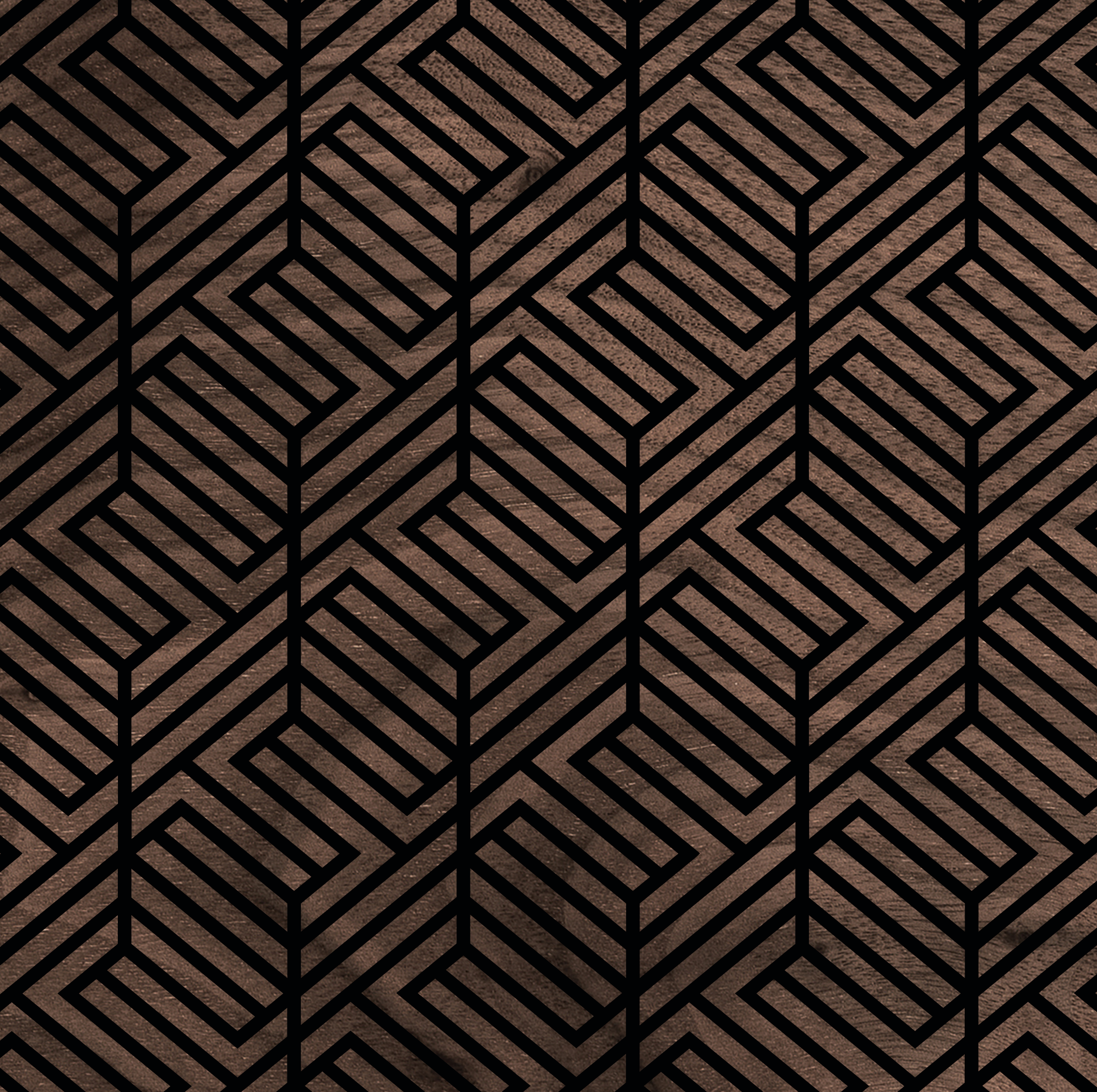

CABINET CHASE CUT-OUTS

Create Chase in Base Cabinet

MOD# CHASE-BASE

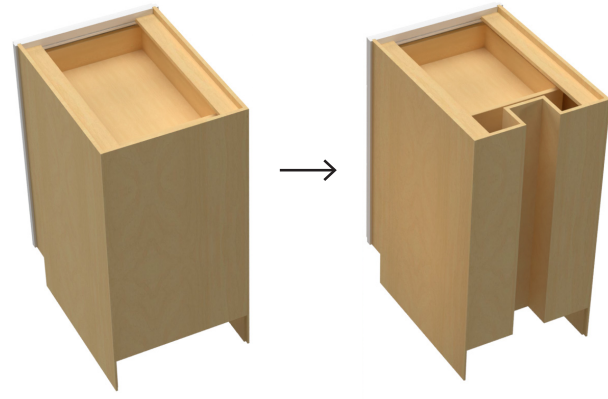

Fabuwood can modify any base cabinet with a vertical chase and cover the opening. The shelf will be modified to accommodate the chase while the drawer depth is reduced 3" from the chase.

Please note: Customer must provide drawing.

Create Chase in Drawer Cabinet

MOD# CHASE-DBASE

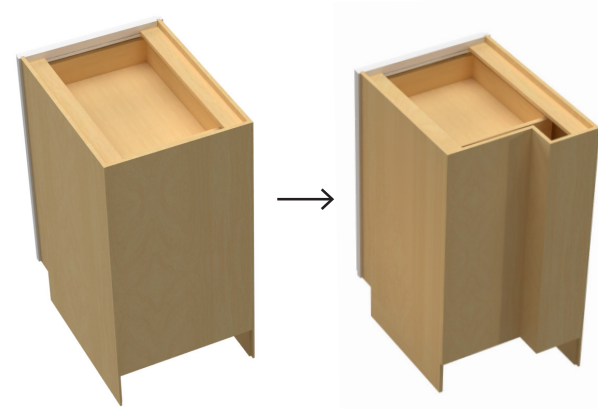

Fabuwood can modify any drawer base cabinet with a vertical chase and cover the opening. The shelf will be modified to accommodate the chase while the drawer depth is reduced 3" from the chase.

Please note: Customer must provide drawing.

Create Chase in a Tall Cabinet

MOD# CHASE-TALL

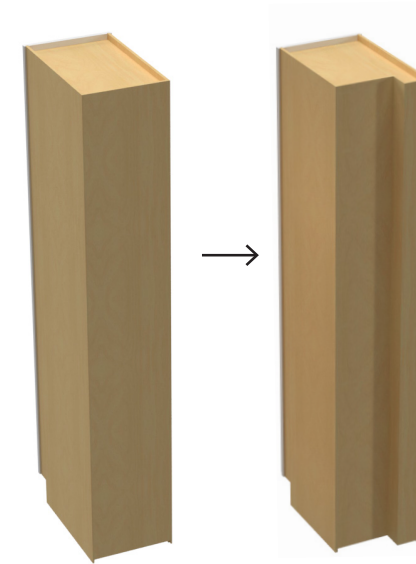

Fabuwood can modify any tall cabinet with a vertical and or horizontal chase and cover the opening. The shelf will be modified to accommodate the chase.

Please note: Customer must provide drawing.

Create Chase in a Tall Cabinet

MOD# CHASE-3 TALL

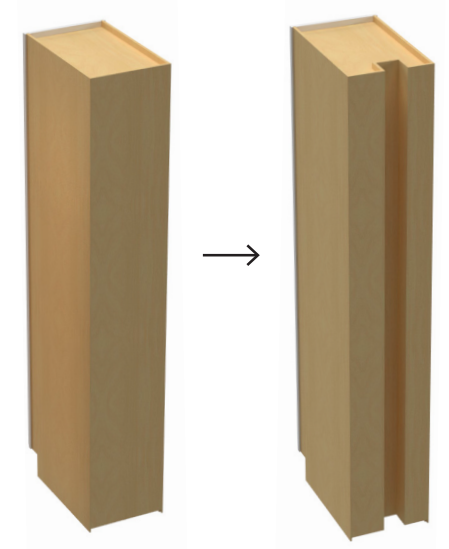

Fabuwood can modify any tall cabinet with a vertical and or horizontal chase and cover the opening. The shelf will be modified to accommodate the chase.

Please note: Customer must provide drawing.

Create Chase in Corner Cabinet

MOD# CHASE-CORNER

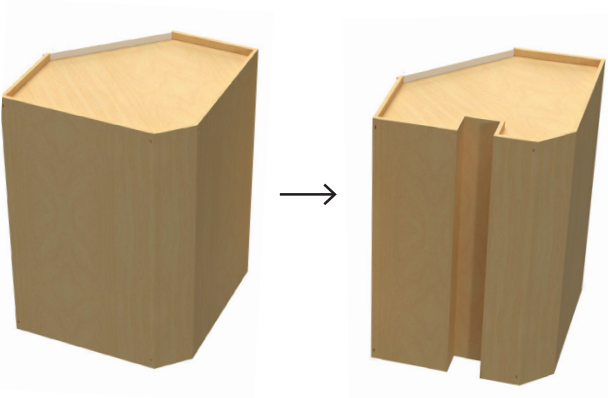

Fabuwood can modify any corner cabinet with a vertical and or horizontal chase and cover the opening. The shelf will be modified to accommodate the chase.

Please note: Customer must provide drawing.

Create Chase in Wall Cabinet

MOD# CHASE-WALL

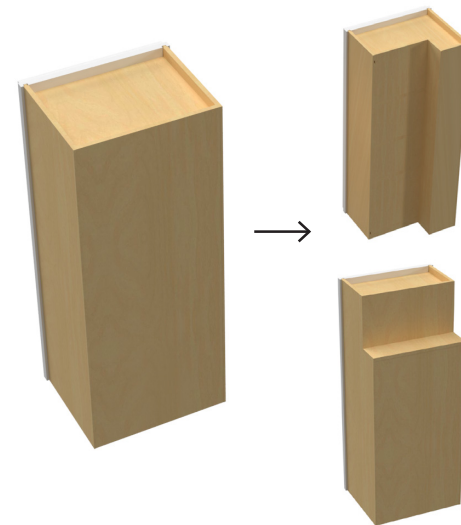

Fabuwood can modify any wall cabinet with a vertical and or horizontal chase and cover the opening. The shelf will be modified to accommodate the chase.

Please note: Customer must provide drawing.

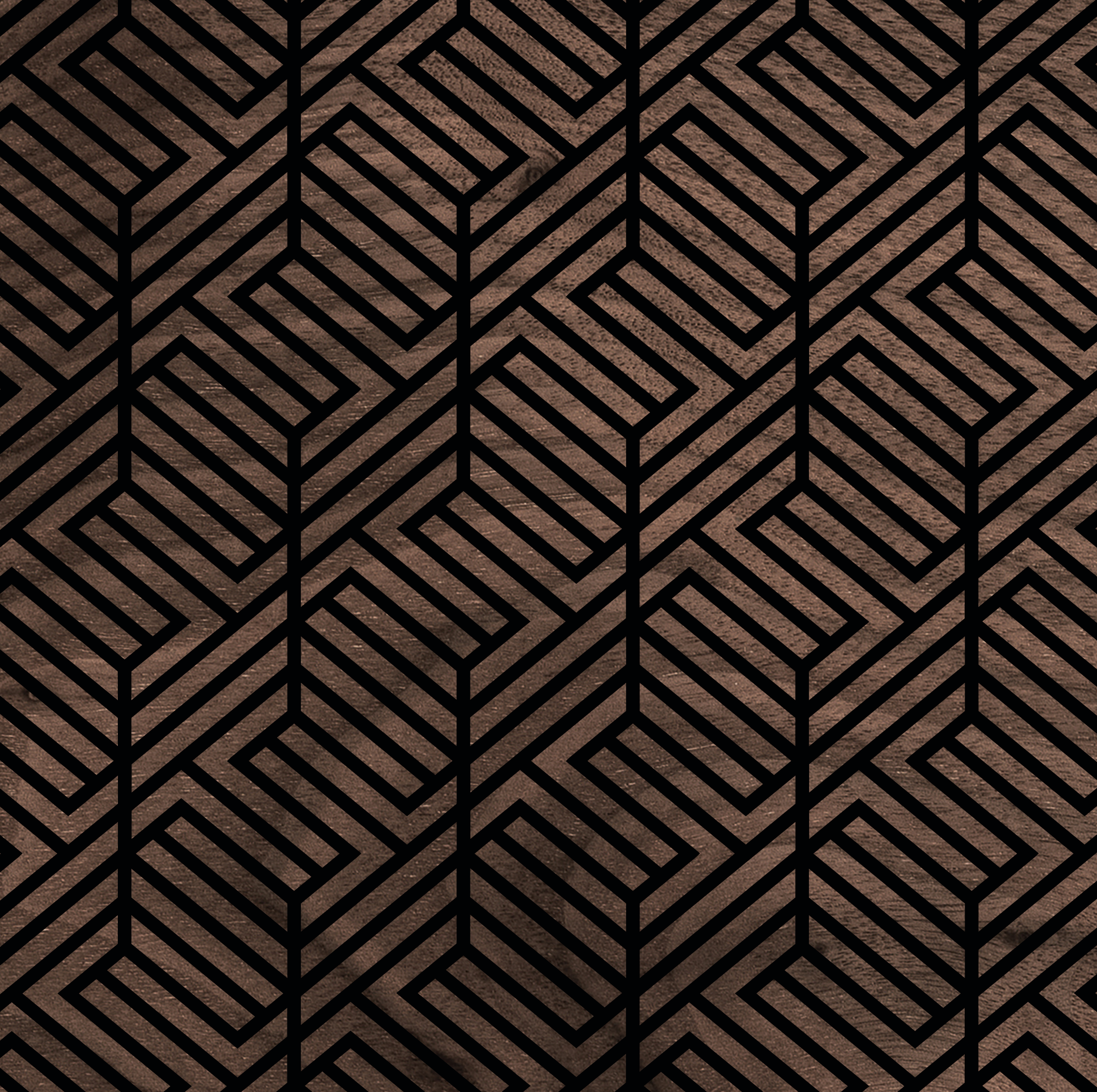

**CUSTOM-SIZE
COLUMNS &
RETURNS**

Create Base Column

SKU# CREATE-COLUMN BASE

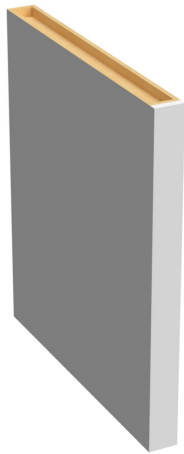

Create a 3" column up to 30"D by 34½"H
Please note: Custom quote required.

Create Wall Column

SKU# CREATE-COLUMN WALL



Create a 3" column up to 15"D x 42"H
Please note: Custom quote required.

Create Tall Return

SKU# CREATE-RETURN TALL

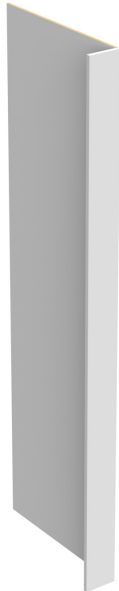

Create a return tall filler up to 6"W x 30"D x 120"H.
Please note: Custom quote required.

Create Custom Column

MOD# CUSTOM-CLM

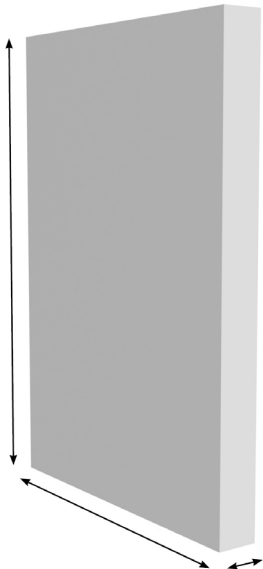

Customer will be able to enter custom sizes to create column up to 96".
Please note: Custom quote required.

Create Tall Column

SKU# CREATE-COLUMN TALL



Create an oversized column up to 6"W x 48"D x 120"H
Please note: Custom quote required.

Create Wall Return

SKU# CREATE-RETURN WALL

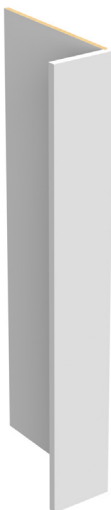

Create a return wall filler up to 6"W x 15"D x 42"H
Please note: Custom quote required.

Create Over-Sized Custom Column

MOD# CUSTOM CLM-OS

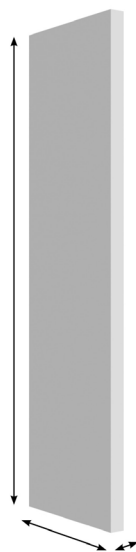

Customer will be able to enter custom sizes to create column between 96 - 120".
Please note: Custom quote required.

Add Filler to back of Column

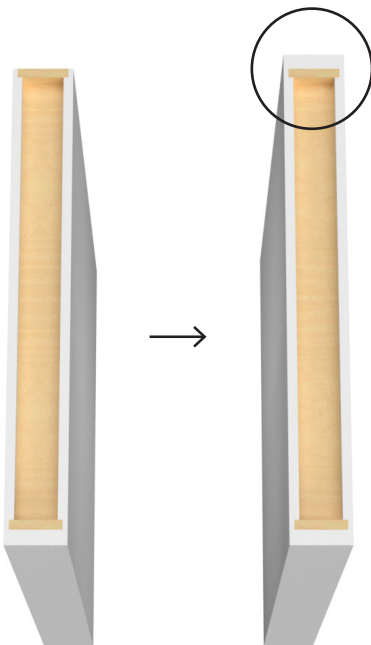

Fabuwood can apply a filler to the back of a column, finishing it on both ends.
Please note: Custom quote required.

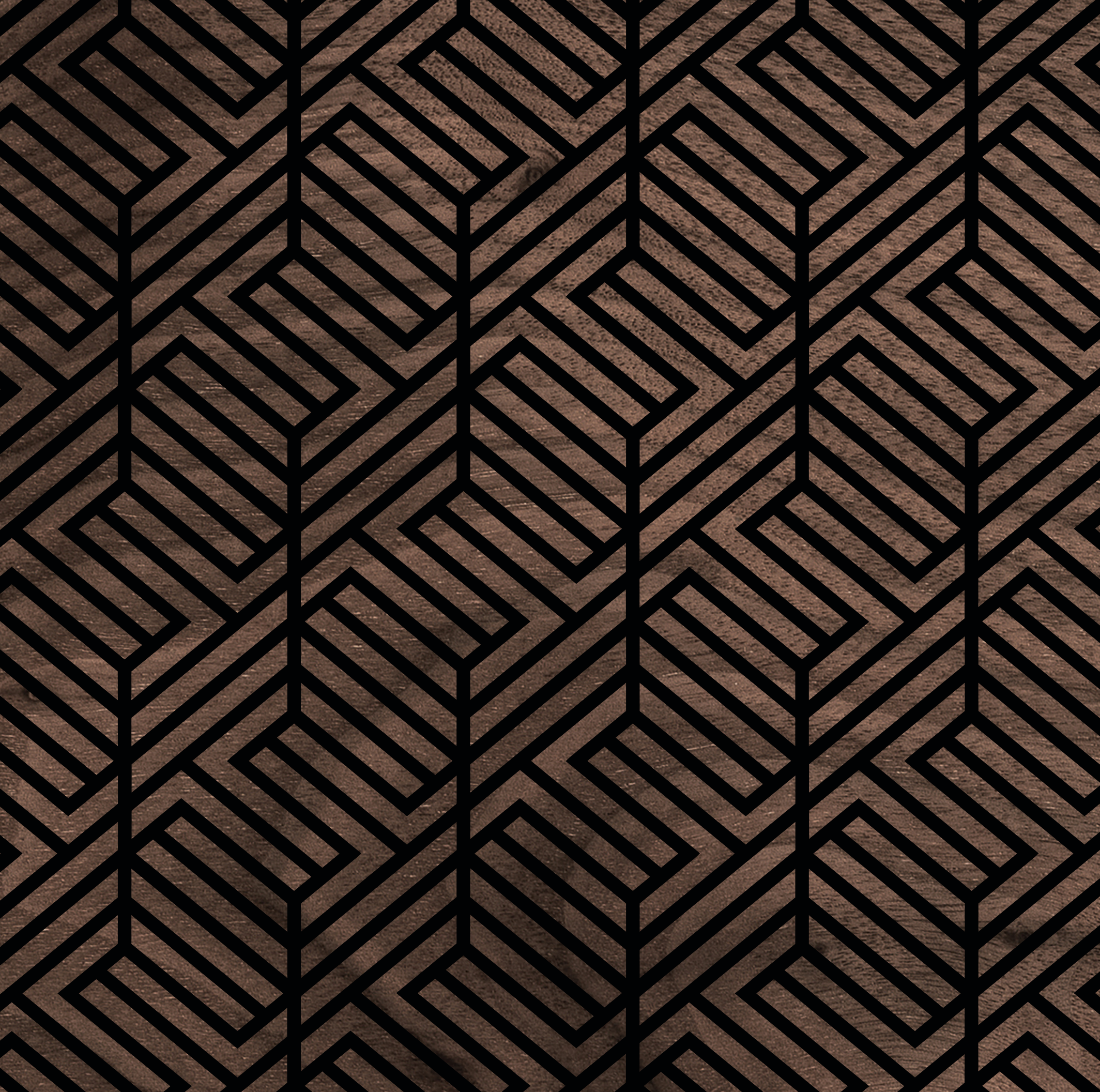

PRODUCT CUSTOMIZATIONS

Attach Toe-Kick on a Wall Cabinet

MOD# ATTACH-TK

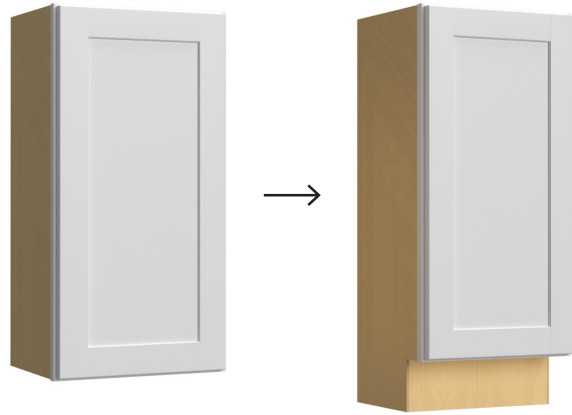

Fabuwood can modify a wall cabinet into a base cabinet by applying a toe-kick.
Please note: Customer needs to specify exposed sides.

Close Open Section of a Blind Cabinet

MOD# CLOSE-BLIND



Fabuwood can close the open section of a blind wall or base cabinet by adding a 1/4" panel on the inside of the frame.

Please note: Fabuwood can order and install any accessory for a blind cabinet. Customer must provide the model number.

Create Base Microwave Cabinet from Drawer Base

MOD# CREATE-BMC



Fabuwood can modify a drawer base to create a microwave base. To fulfill this modification, Fabuwood will remove the top two drawers, install a support shelf on top of the bottom drawer, and apply a full flat panel to the front.

Please note: Full flat panel to be cut on the job site to accommodate the microwave.

Create Base Oven Cabinet from a Base Cabinet

MOD# CREATE-BOC



Fabuwood can modify a base to create an oven base. To fulfill this modification, the top drawer and doors are removed, a full flat panel is applied to the front.

Please note: Full flat panel to be cut on the job site to accommodate the oven.

Close the Panel Opening of an Oven Cabinet

MOD# CLOSE FRONT-OC



Fabuwood can close the open panel of a base microwave, base oven, tall oven, or a wall microwave cabinet by adding 3/4" plywood to the inside of the frame.

Create Square Bottom Shelf for Open End Cabinet

MOD# CREATE-SQ BOTTOM

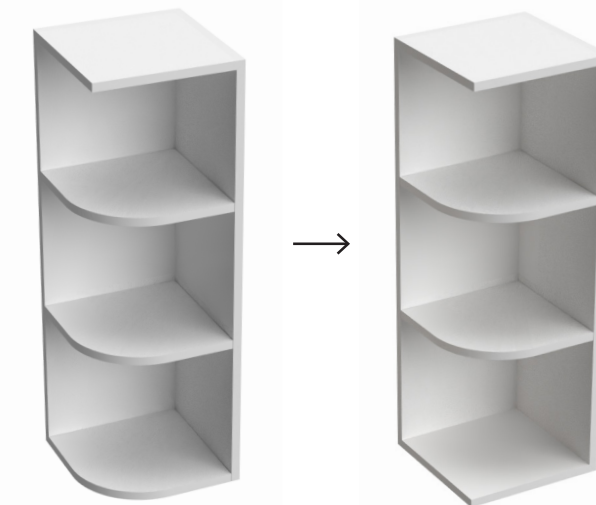

Add a square bottom to an open end, to apply light rail molding.

Create Arched Valance from a Filler

SKU# CREATE-VALANCE

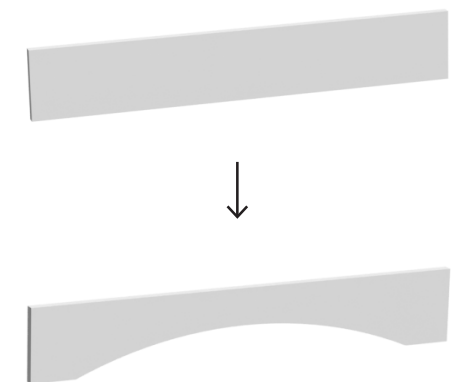

The valance will be 5-1/2" high and can be up to 96" long. This is also used for a base toe kick to create a furniture look. Please note: Custom quote required.

Fill Hinge Holes with Touch-Up (seam will still be visible)

SKU# FILL HINGE SEAM



Flush Toe Kick of Cabinet

MOD# FLUSH-TOE KICK



Fabuwood can modify the toe kick by bringing it forward to be flushed with the face frame.

Install Door-Mounted Pull-Out Wood Hamper in Cabinet

MOD# HAMPER



To create a hamper cabinet from a base cabinet, a door-mounted wood hamper is attached using undermount slides. Hamper is 18" high. This includes hamper box only, and does not include cloth liner or plastic bin accessories.

Full Cut-Out on Microwave Cabinet



Fabuwood can create a full cut out by cutting the full frame, leaving a 1-1/2" rather than 3" wide stiles and rails.

Please note: Customer needs to specify match-interior when ordering. Custom quote required.

Flush Bottom Panel of Wall Cabinet

MOD# FLUSH-WALL BOTTOM

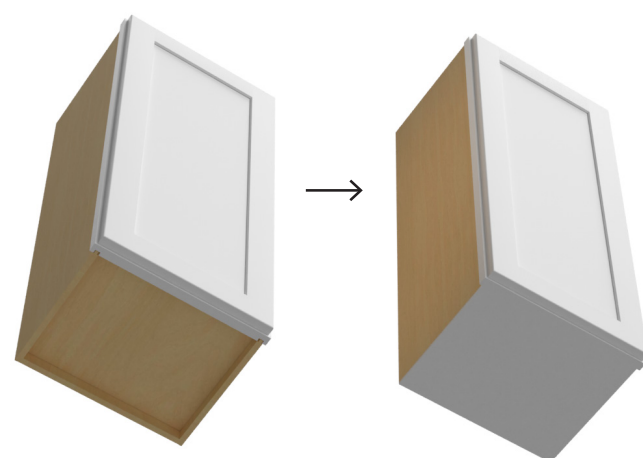

Create Full-Door Base Cabinet from Standard Base Cabinet

SKU# FULL-DOORS



Please note: Check EZPO for available full height base cabinets.

Recess Toe Kick on Base Cabinet

MOD# RECESS-TK



Fabuwood can recess the toe kick of any base cabinet by 3" increments from the following options: Left, Right, Back or a combination of all three.

Full Depth Shelf



Fabuwood can create a full depth shelf for any base or tall cabinet.

Please note: Custom quote required.

Insert Broom Divider

MOD# INSERT BROOM DIVIDER



Divide the lower section of a pantry to use as a broom closet. A cutout will be made in the center fixed shelf to allow space for the broomstick.

Insert Tray Dividers in a Wall Cabinet

MOD# INSERT DIVIDER

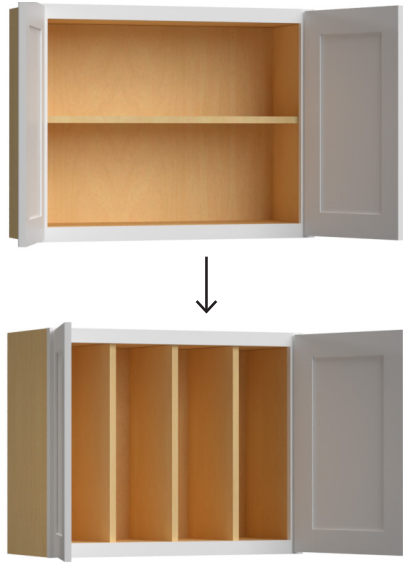

Insert 1/2" vertical tray dividers in a standard wall from 9"W - 36"W.
Other configurations available through Custom Quotes.

Modify Tall Pantry by Swapping Top and Bottom Door

MOD# INVERT FRAME-TALL



Using a standard tall pantry, Fabuwood can invert the frame and doors to have the tall door on the top and the short door on the bottom, using an added groove to adjust the fixed shelf height.

Create Sink Base Cabinet

MOD# REMOVE-DRAWER

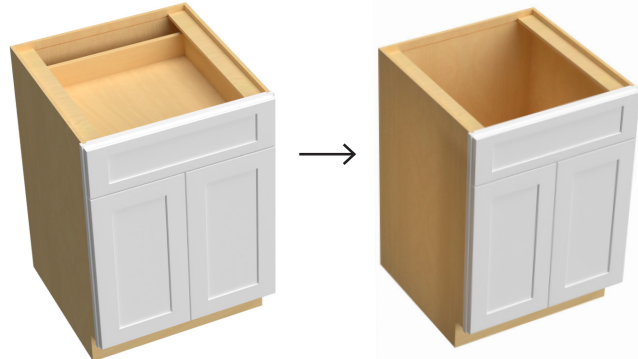

Available for both Allure and Illume. To modify a base cabinet into a sink base, the drawer box and slides will be removed. The drawer front is then attached to the frame as a false drawer front.

Insert Tray Dividers in a Base Cabinet

MOD# INSERT DIVIDER



Insert 1/2" vertical tray dividers in a standard base cabinet from 9"W - 36"W.
Other configurations available through Custom Quotes.

Modify Base Cabinet to Create Sink Base with Drawer on Bottom

MOD# INVERT FRAME-BASE



Using a standard base cabinet, Fabuwood can invert the frame featuring a door at the top and a drawer on the bottom. A fixed shelf with a front rail is also inserted above the drawer.

When your selected SKU in vanity depth is not available, an additional cut-base charge will apply.

Create Peninsula Cabinet (cabinets not included)

MOD# PEN-CABINET



A peninsula cabinet can be created from two wall and/or base cabinets.

Fabuwood will create a peninsula using any cabinets as long the peninsula side frame is the same size. If it is a full height door on the peninsula side, there will be a 7" apron to cover the drawer box.

Please note: For a No Door Wall Cabinet Peninsula, wood shelves will be provided instead of glass shelves.

Remove Floor of Cabinet



MOD# REMOVE-FLOOR



To remove the floor, the bottom panel, bottom rail, and toe kick (if applicable) are removed from frame. Bottom panel grooves are filled in and support is added for shipping.

Note: Cabinets with full center stile are not eligible for this modification.

Install Roll-Out Drawers Side-by-Side in Cabinet



MOD# ROD-SPECIAL



Please note: Custom quote required.

Stacked Cabinets



Please note:
Customer can specify any exposed sides to ensure skin application.
Custom quote required.

Create Blind Cabinet



Fabuwood can create a blind cabinet by using any double door base or wall cabinet by removing one door and adding a wide center stile.

Please note: Custom quote required.

Install a Drawer in the Toe-Kick of a Base Cabinet



MOD# TK DRAWER

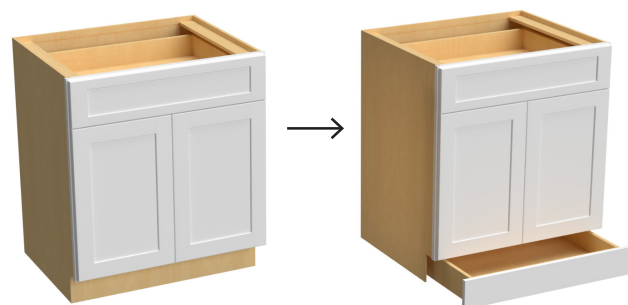

Fabuwood can modify any base cabinet with a toe kick drawer allowing for additional storage.

Create Curio Wall Cabinet



Fabuwood can create a curio cabinet by replacing a 12" wide face frame and mitering the front frame.

Please note:

- Glass doors can be added to the front and side of the cabinet and can be ordered separately.
- Custom quote required.

Create Wall Open Shelf from No-Door Wall Cabinet

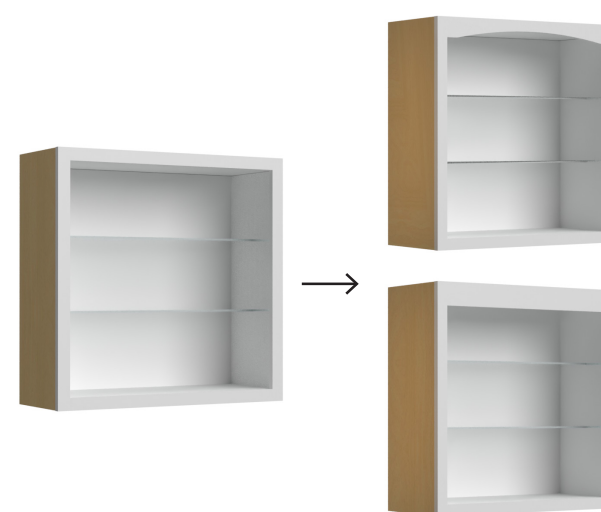

Fabuwood can add an arched or straight valance to any wall cabinet. Hinge holes can be filled upon request.

Please note: Custom quote required.

Arched Toe Kick Valance



An arched flushed toe kick can be created upon request.

Please note: Custom quote required.

Finish Interior of Cabinet with Laminate



Fabuwood can line the interior of any cabinet with the color laminate of your choosing.
Please note: Custom quote required.

Finish Interior of Cabinet

MOD# CHOOSE-INTERIOR



Finish full interior of cabinet to selected color or stain. Customer can choose from Signature, Designer or Custom Color Collections.
Not available for NDW, WOS, WR/WC/WO cabinets, Vanities, and Tall Pantries.

Matching Color Edge-Band

MOD# EBAND-MATCH BOX



Upgrade your Illume cabinets with a Matching Color Edge-Band that matches your selected door finish for a seamless custom look.

Matching Color Edge-Band

MOD# EBAND-MATCH SHELF



Upgrade your Illume adjustable shelves with a matching edge-band for a cohesive finish.

Illume Finished Ends

MOD# FINISHED-END



We've added a laminate skin to the left, right, or both sides of applicable cabinets. Finished ends will add less than 1/16" to the total width for a simple, clean, seamless look.

Please note: The front edge band will cover the skin on the sides only. The top and bottom edge band will remain white linen.

Paint/Stain Interior of Cabinet to Match Exterior

MOD# MATCH-INTERIOR

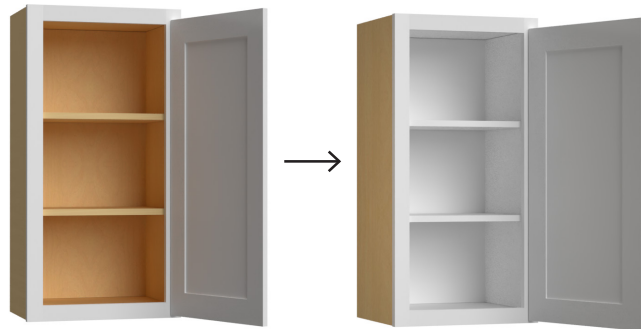

Fabuwood can finish the interior of any cabinet to match the exterior color.

Two Tone Hoods



Available for Allure's chimney-style hoods, including Euro, Farmhouse, Signature, and Curved Artisan.

The 2-Tone Finish modification lets dealers add an accent finish to the hood's base, chimney, moldings, & valance.

Create Two-Drawer Base from Three-Drawer Base



Relocate the horizontal rails. Add a full set of custom or stock sized doors.

For example: Use a DS W3024 to create a DB24-2.

Please note: Custom quote required.

Split Top Drawer of Drawer Base Cabinet



Fabuwood can customize a drawer base with two drawers on top, side by side by adding a center stile to the face frame.

Please note: Custom quote required.

Create Four-Drawer Base from Three-Drawer Base



Add and relocate the horizontal rails. Add a full set of 2 drawer boxes and drawer fronts, and 1 set of slides.

Please note: Custom quote required.

Create 42" Diagonal Sink Base



Fabuwood can create any custom size diagonal cabinet. To create a DSB42", the door set used is a B24 leaving the front angle to be 25-1/2".

Please note: Custom quote required.

Oversized Tall Filler

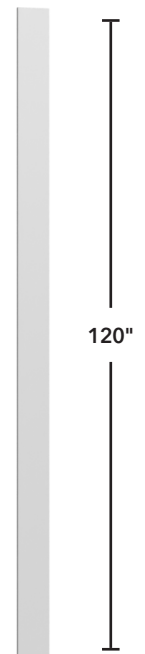

Fabuwood can create a 3" or 6" filler up to 120"H.

Please note: Custom quote required.

Create Farm Sink Base



To create a farm sink base, a closed front panel will be added above the doors and a door set from an 18"H wall cabinet will be used.

Please note: Custom quote required.

Create Custom Knee Drawer



Fabuwood can create a single or double knee drawer upon request.

Please note: Custom quote required.

Oversized 1/4" Panel Skin



Create an oversized 1/4" panel in any size up to 48" x 120".

Oversized Refrigerator Panel

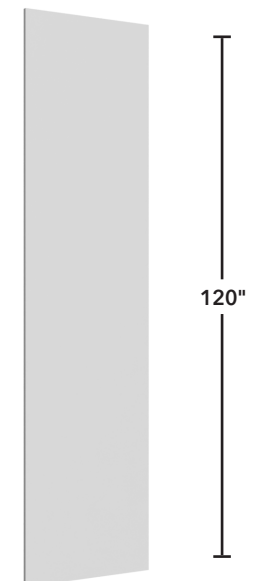

Fabuwood can create an oversized REP 3/4" thick up to 48" x 120", edge banding the two long sides.

Attach Base or Pantry Doors with Dowels



Connect 2 doors, or a door and drawer front, with dowels so doors open as one.

Please note: Custom quote required.

Attach Base or Pantry Doors with Backer



Attach 2 doors, or a door with drawer front, with a 1/4" panel inset, so doors open as one tall door.

Please note: Custom quote required.

Cut Out Center Panel of Door for Glass Insert

MOD# CUT-DOOR

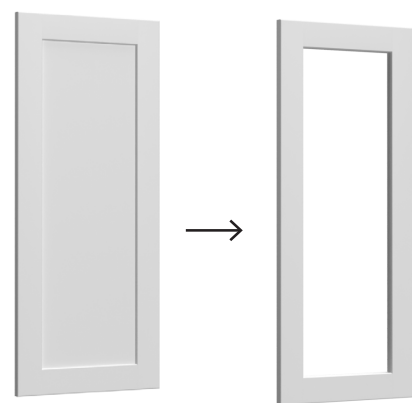

Center panels of doors can be cut out to prepare for glass inserts. Customization includes refinishing the cut edges and a rubber gasket for installation of a 1/8" thick glass is included.

Please note: Glass is not supplied.

Not available for Illume. Only available in Luna for custom doors.

Doors(s) will be shipped loose; hinges will come installed on the cabinet.

Create Chase in a Roll Out Drawer

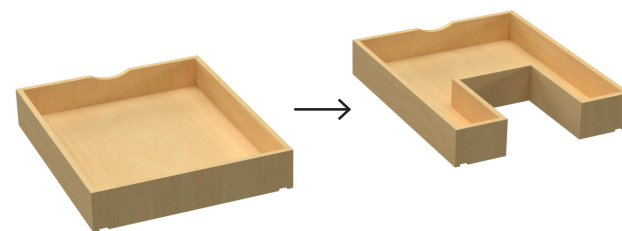

Fabuwood cuts a chase in the drawer and covers the opening.

Please note: Customer must provide drawing. Custom quote required.



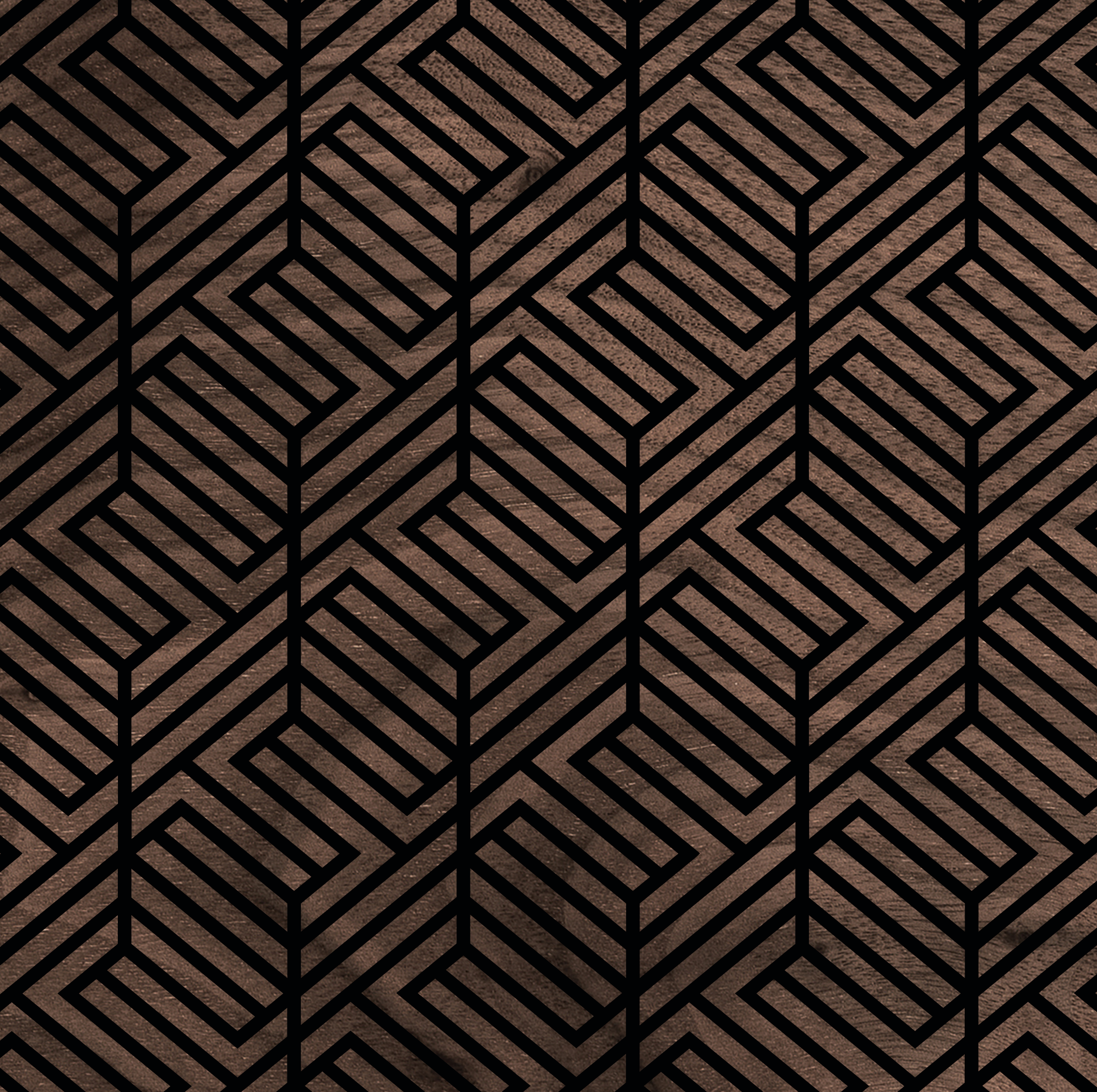

CUSTOMIZATION EXAMPLES

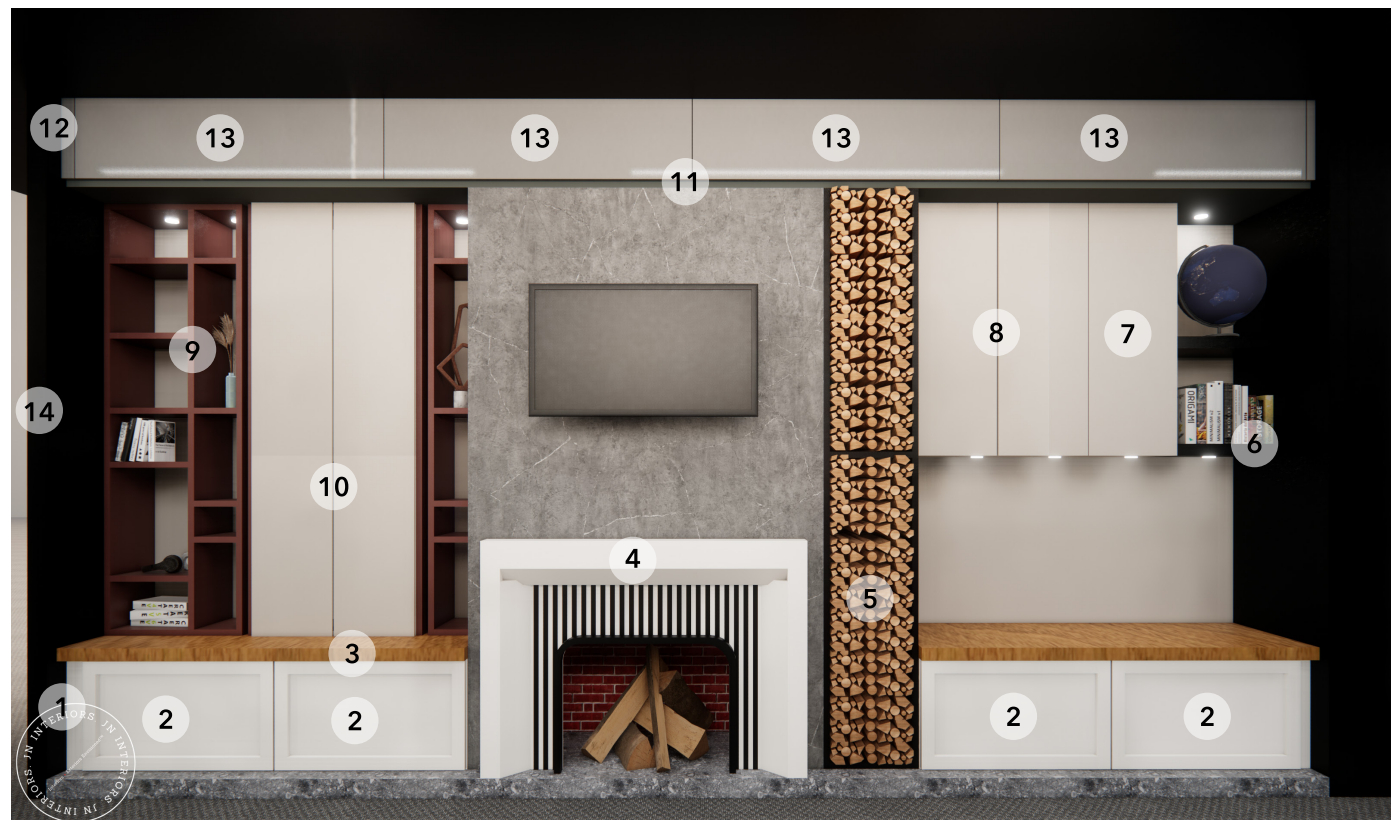

Galaxy Frost and Catalina Bianco Fireplace

- | | |
|--|--|
| 1 WF330 (OLF CUSTOM) | 8 W3030 |
| 2 Bench Seat (DB30-2 with modification) | 9 Open Shelving - Custom Designer Collection |
| 3 Custom Bench Top - Timber | 10 W2730 |
| 4 Custom Fireplace (REP, CM-9, BM3/4) | 11 REP-1 1/2" - Pitch Black |
| 5 TP152084 (CUT-DEPTH, NO DOORS, MATCH-INTERIOR, CUT-TK) | 12 WF3 |
| 6 Floating Shelves - Pitch Black | 13 W481224-LU |
| 7 W1530 | 14 REP3096 |



Luna Timber & Pitch Black Kitchen

- | | |
|------------------------------|---|
| 1 Timber Pan 3/4 - Edge Band | 11 Custom Cabinet with Pocket Doors |
| 2 DB24 Doors on Dishwasher | 12 TP301284 (CUT-HEIGHT, CHOOSE INTERIOR, CUT-DOOR FOR GLASS) |
| 3 DB30-2 With Accessories | 13 TP241284 (CUT-HEIGHT, CUT-TK) |
| 4 BF3, OLF) | 14 W3630 |
| 5 BLB48/51 With Accessory | 15 W3015-LU (CHOOSE-INTERIOR, CUSTOM GLASS FOOR) |
| 6 B15 (ROD-B15) | 16 PLY 1/2 |
| 7 B24 (CWKD-B24 BLUM) | 17 CM-9 |
| 8 FLS24 | 18 REP2496 |
| 9 RHCA42 | 19 TK8 |
| 10 WC0630 (4) | |



Onyx Frost Kitchen

- 1 CLM
- 2 Pitch Black (TP152496) Cut Door. Choose-
interior Frost, Walnut Shelves
- 3 W361224-LU
- 4 LSB36
- 5 DB18-4 (Cutting Board)
- 6 TBPO, WF330, OLF330
- 7 SB27 (Sink Liner)
- 8 TP362496 (Broom Cabinet Divider,
ROD-30's)
- 9 W361224
- 10 W33214
- 11 FLS33
- 12 W1824 (Cut-Door, Walnut Shelves)
- 13 VARP36
- 14 W1242 (CUT-DOOR, WALNUT SHELVES)
- 15 WPC2442 (CUT-DOOR, WALNUT SHELVES)
- 16 W151224 (Custom Door with Glass)
- 17 W361224 (Cut Door)
- 18 Custom Cabinet from REP's
- 19 Create REP
- 20 Pitch Black LRM
- 21 Custom Fridge Panels
- 22 TK8





Nexus Indigo Vanity

- | | |
|-----------------------------------|----------------|
| 1 VSD42 With Modification | 5 CUSTOM WALL |
| 2 Vera Platform & Cove Bun Feet | 6 CUSTOM PANEL |
| 3 TP152484
(CUT-DEPTH, CUT-TK) | 7 REP + CM4 |
| 4 STKM-8 | |



Galaxy Pistachio Green Laundry

- | | |
|--|----------------------------|
| 1 BF3 | 9 Create Column 1-1/2" |
| 2 FS30 | 10 REP2496 |
| 3 B30 (Hamper, Ironing Board) | 11 W271524 |
| 4 Create Column 1-1/2" | 12 W273024 |
| 5 DB30-2 With Modification | 13 Floating Shelf - Timber |
| 6 Custom Pullout Drawer
(TF396, Custom OLF) | 14 TK8 |
| 7 CLM96 | 15 SHL-8 Dove |
| 8 REP24X96 | |





Fusion Stone Pantry

- 1 TP182496 with accessories
- 2 B18 (GDW1830,ROD's)
- 3 SB21
- 4 DD BF6 Custom Base 6"
- 5 LSB36
- 6 36" Bench Seat
- 7 Basket Pullouts Custom
- 8 W3618 OPEN, SHL-8 Back Panel
- 9 W3642 OPEN, SHL-8 Back Panel
- 10 W1242 OPEN, SHL-8 Back Panel
- 11 WPC2442 OPEN, SHL-8 Back Panel
- 12 VARP36
- 13 W1842 (Cut-height)
- 14 W1839 with Tray Divider
- 15 STEMWARE 36"
- 16 WR1818
- 17 WD1860 (CUT-DEPTH)
- 18 W3012 (CUT-DOOR, Metal Mesh)
- 19 W3612 (CUT-DOOR, Metal Mesh)
- 20 W1812 (CUT-DOOR, Metal Mesh)
- 21 W181224 (CUT-DOOR, Metal Mesh)
- 22 CM-6
- 23 TK8
- 24 Custom Column





Galaxy Timber Vanity

- 1 SB18 (CUT-DEPTH, CUT-TK)
- 2 VDB12 (CUT DOOR CENTER, CUT-TK)
- 3 Shaker Platform & Taper Bun Feet

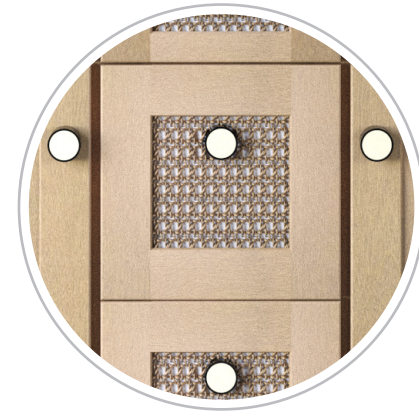

Illume Vanity

- 1 DB24 (Cut Base-Height)
- 2 VDB15 (Cut Base-Height)
- 3 Create-Column 1-1/2"
- 4 VB36 Top Drawer Only
- 5 VBEP
- 6 W1536 (CUT-WALL, MIRROR DOOR)
- 7 W3036 (CUT-WALL, MIRROR DOOR)
- 8 CLM84 Cut out 4 inches
- 9 TK8



Two-Tone Hood Finish Modification



Signature Traditional Hood
Oyster Base with Kona
moldings and valance

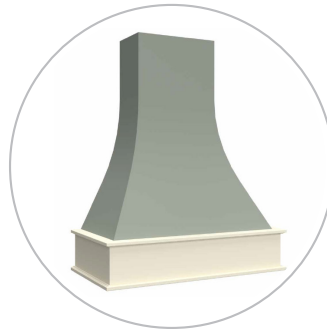

Artisan Curved Hood
Pistachio Green Base with Linen
moldings and valance



Signature Traditional Hood
Kona Base with Graphite Black
moldings and valance



Artisan Curved Hood
Timber Base and valance with
Pitch Black moldings

Notes

This image shows a single sheet of white paper with horizontal ruling lines. The lines are evenly spaced and run across the width of the page. There are no margins, text, or other markings on the paper.

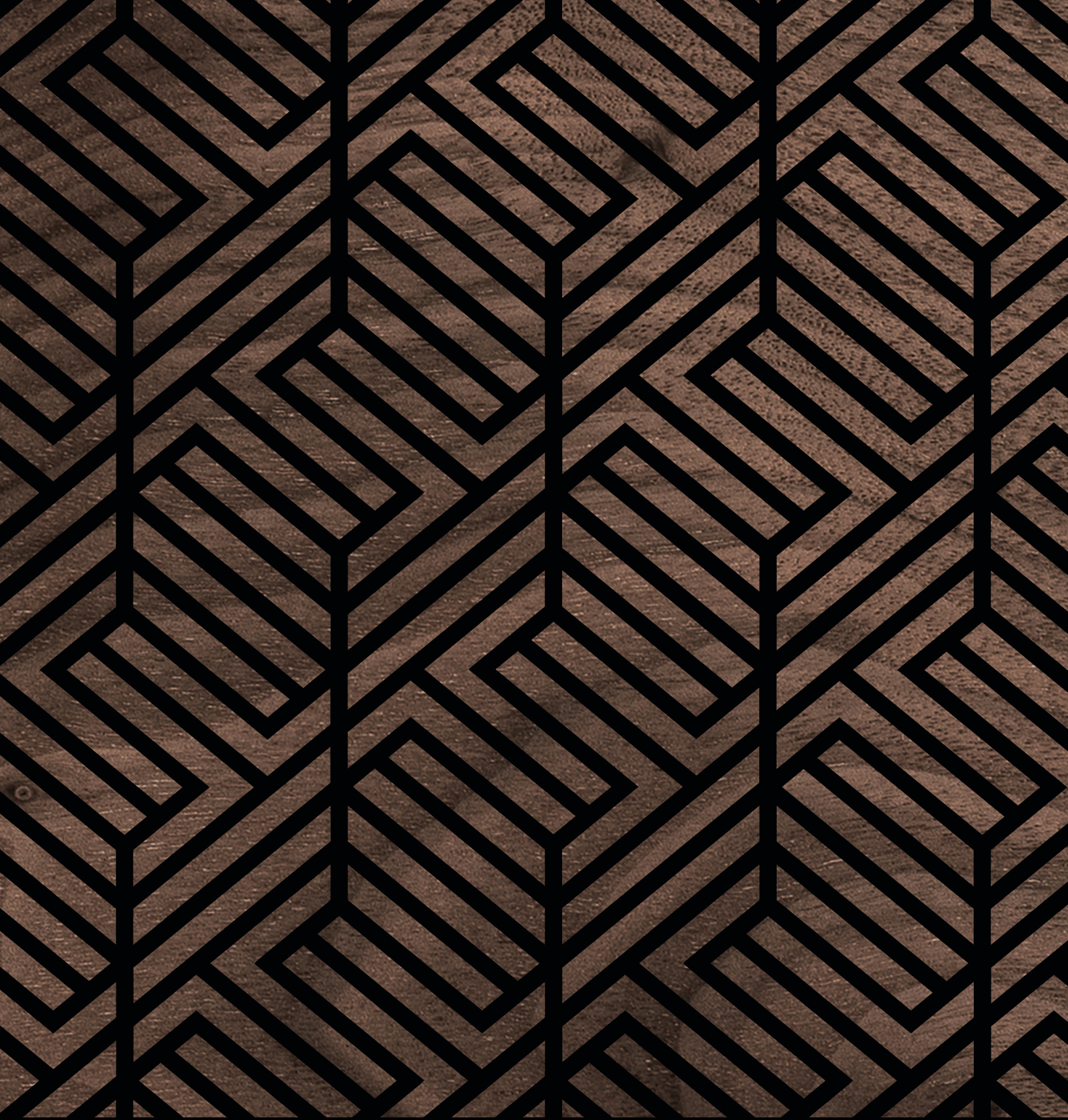

69 Blanchard St. | Newark, NJ 07105 | T: (201) 432-6555 | F: (201) 432-6055
www.fabuwood.com | Fabuwood Cabinetry Corp. All Rights Reserved 2024.



*Limited Lifetime Warranty is applicable to the Allure, Illume, Value Premium, & Quest series cabinets only.
At Fabuwood, we prioritize sustainability through energy efficiency, waste reduction, and eco-friendly practices, creating a healthier environment for our employees, customers, and community.