

Dimensions

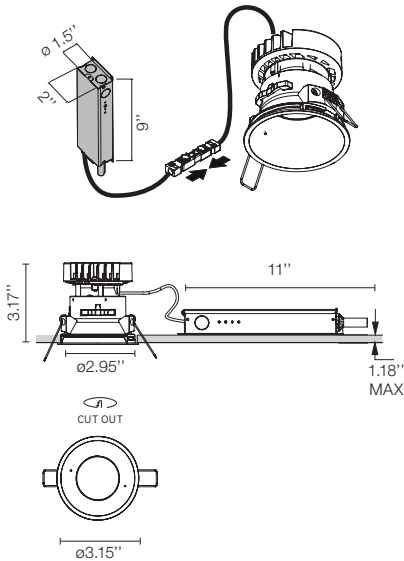

Certifications



Photometrics

For current IES files please visit architectural.flosusa.com

Warranty

2 years from date of sale.

FLOS. USA
36 East 31st Street
Suite 402
New York N.Y. 10016
(800) 841.4011

EasyKap 80 (ø3.2") Round Fixed NON-IC

NON-IC Ceiling Recessed Trim Downlight

Description

LED luminaire for recessed mounting into plasterboard ceilings. The Easy Kap version has an aluminium injected body with a liquid paint, dust and/or metallic copper finish with a plastic diffuser included. It does not need a pre-installation frame. Thanks to remote-phosphor technology, the LED modules of the Phosphor LED version offer maximum quality light, the perception of objects and spaces, reaching chromatic reproduction indices of 90. The LED modules installed on the LED Array versions have cutting-edge technology that permits a lower average temperature in the electronics. Thanks to this feature, the luminaire can operate at a higher power inside the safety parameters yet still offer 20% added luminous flux.

Lamp

Table with 2 columns: Lamp Type, Wattage, Output Nominal, Color Temperature, Color rendering. Values include LED ARRAY, 9.2W, 935 lm / 974 lm, 2700K - 3000K, CRI 90.

Optical

Table with 2 columns: Beam Angle, Lighting Type, Light Distribution. Values include 19°/ 26°/ 50° (white finish), Direct, Symmetric.

Physical

Table with 2 columns: Material, Aiming, Weight, Ingress Protection Rating, Finishes. Values include Aluminum, Adjustable to 20°, 7.77 Lbs, IP54, Painted lacquer.

B1 White, 74 Black, GL Matt Gold



Table with 2 columns: Installation type, Environment. Values include Ceiling Recessed Non IC, 11" recommended ceiling space to install, Indoor dry location.





## EasyKap 80 (ø3.2") Round Fixed NON-IC

NON-IC Ceiling Recessed Trim Downlight

### Electrical & Control

Input Voltage	120-277V
Control	Standard 0-10V dimming 1% linear
Driver	Driver in splice box
Current	500mA

### Performance

Delivered lumens	from 472 lm up to 732 lm
Efficacy	80 lm/W

### Dimensions

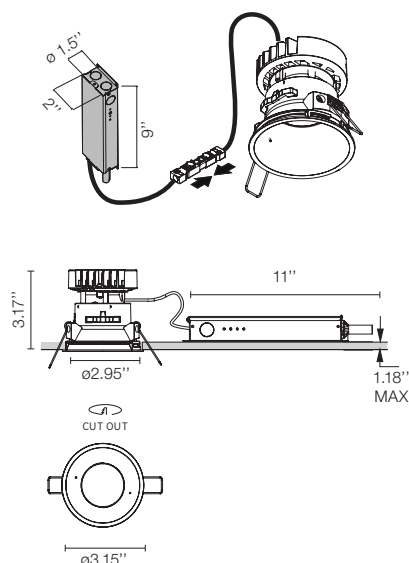

### Notes

Pre-installation frame has to be ordered separately

Non IC rated luminaire

Ceiling Recessed Non IC, 11" recommended ceiling space to install.

Driver must be ordered separately. 3 Options:

- 0-10V Dimming 120V
- 0-10v Dimming 277 V
- ELV Dimming 120 V

Available in 4 different finishes: Black, White, Gold and Copper.

Maximum tilt angle for the Kap 80 (3.2") adjustable version is 20°

LED included not replaceable

Listings: UL listed, IP44

### Certifications



### Photometrics

For current IES files please visit  
[architectural.flosusa.com](http://architectural.flosusa.com)

### Warranty

2 years from date of sale.

EasyKap 80 (ø3.2") Round Fixed NON-IC

NON-IC Ceiling Recessed Trim Downlight

How to specify

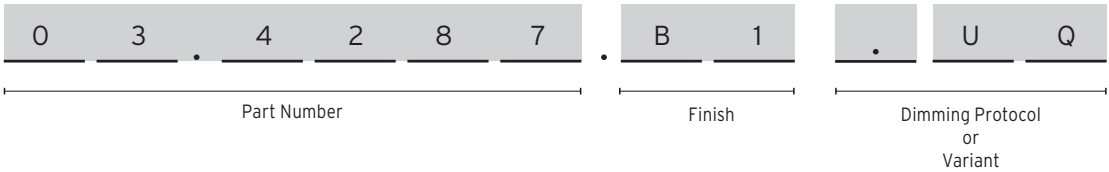

How to Specify ex. 03.4287.B1.98

Part Number	CCT	CRI	Initial Lumens	Watts	Beam Angle	Finish	Variant
03.4287	3000	90	974	9,2W	19°	B1 = White 74 = Black GL = Gold	UQ = US product. Splice Box* not included  *Has to be Always supply by FLOS
03.4288	2700		935				
03.4192	3000		974		26°		
03.4193	2700		935				
03.4297	3000		974		50°		
03.4298	2700		935				

EasyKap 80 (ø3.2") Round Fixed NON-IC

NON-IC Ceiling Recessed Trim Downlight

Photometries Optic Spot

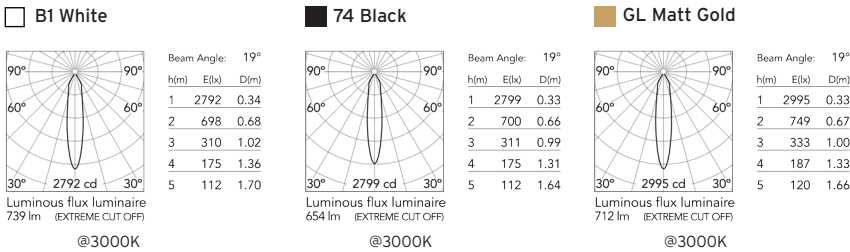

EasyKap 80 (ø3.2'') Round Fixed NON-IC

NON-IC Ceiling Recessed Trim Downlight

Required Splice Box

Splice Box 14W, 20% dim, ELV, 120V. Size: 9'' x 2'' x 1.5''

SP14W500MA-ELV-E01

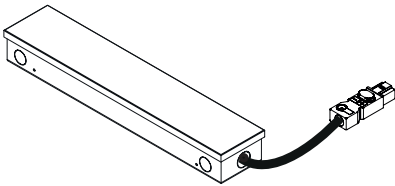

Splice Box 20W, 1% dim, 0-10V, 120V. Size: 9'' x 2'' x 1.5''

SP20W500MA-120-V01

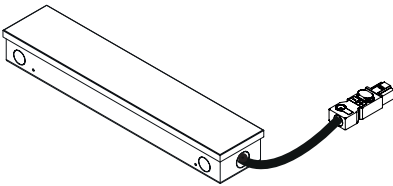

Splice Box 14W, 1% dim, 0-10V, 277V . Size: 9'' x 2'' x 1.5''

SP14W500MA-277-V01

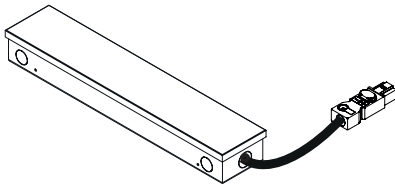

Optional Accessories

Registration Tray -non electrical, place holder for non IC new construction, ø 2.95

TRAY-0001

