



The Tracking Magnet EVO Surface

High-tech LED lighting system for interior architecture

Description

The new Tracking Magnet 48V system is creative, flexible, reliable and precise. Accent luminaires are installed by a magnetic fastening system and a secondary mechanical fastener. The range of luminaires is composed of accent illumination modules with different optics and linear luminaires with the Flos signature design. The extruded aluminum housing creates a clean 0.6" slot that can be run up, around and across walls and ceilings. The Tracking Magnet is available in recessed, surface, or pendant mounted applications, making it an option in even the most varied of job conditions. Vertical and horizontal corners complete the system. The Tracking Magnet is perfect for retail displays where frequent changes are typical and absolute performance is required.

Lamp

System Lamp Type	LED
Color Temperature	2700K, 3000K, *3500K, *4000K (See Notes)
Color Rendering	CRI90
Application	General Lighting / Accent lighting

Physical

Material	Aluminum
Ingress Protection Rating	IP20
Finishes	<input type="checkbox"/> 40 White <input checked="" type="checkbox"/> 14 Black <input type="checkbox"/> 05 Chrome
Installation type	Ceiling Surface
Environment	Indoor
Field cuttable	Yes

Electrical & Control

Driver location	Remote
Driver Input Voltage	120V-277V
Driver Output Voltage	48V
Maximum Driver Wattage	Class 2 - 96W
Control	On fixture: Standard 0-10V dimming / DALI / On board
Nº Circuit	1 circuit

Surface Installation

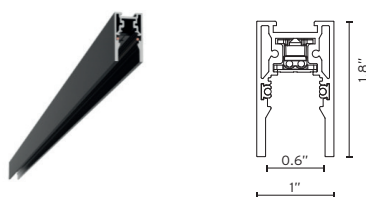

Light Modules



Certifications



Photometrics

For current IES files please visit
arch.flosusa.com

Warranty

2 years from date of sale.



Surface Installation

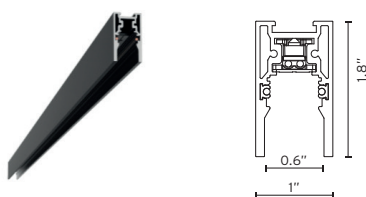

Light Modules



Certifications



Photometrics

For current IES files please visit
arch.flosusa.com

Warranty

2 years from date of sale.

The Tracking Magnet EVO Surface

High-tech LED lighting system for interior architecture

Notes

EC to supply site cabling from driver to track location and site UL listed enclosure.

Wattage per linear foot is dependent upon quantity and type of light modules used.

Spots and linear luminaires available with individually addressable DALI-Wireless circuitry, 0-10V (from 10% up to 100%) Dimming

0-10V Fixtures come from the factory set up at the lowest level 10% they always required a 0-10V signal to achieve the maximum output.

Surface version can be used for recessed look into ceilings with thickness different than 5/8" and where mud in the track is not an option, contact Flos to request details.

All linear profiles are field cuttable.

3500K, 4000K and other CCT available but not cataloged. Consult factory for additional color temperatures.

How To Specify

A. Select and position corners

1. Horizontal - Connect sections on flat surfaces (90° corner)
2. Inside - Transition from wall to ceiling (inside corner)
3. External - Turn outside corners for walls and soffits (270° corner)

B. Fill lengths between corners with Linear Housings

Select dimmable (0-10V fixtures) or non dimmable track (Built-in dimmer fixtures). Available section lengths are 3.3', 4.9', 6.7' or 8.2'. Profile can be easily cut to site to exact length and joined together.

C. Drivers

Quantity of drivers determined by total wattage or light elements in section (total maximum possible per linear foot is 29W). Maximum driver distance is 15'. Locate drivers nearby.

D. Select Spot heads

Light Strips are available in three nominal lengths: 11.8", 23.6", 35.4", 47.2" and 59". Individual Spots are Spot 50, Spot 90, Spot 120, Spot 150 and Anthony.

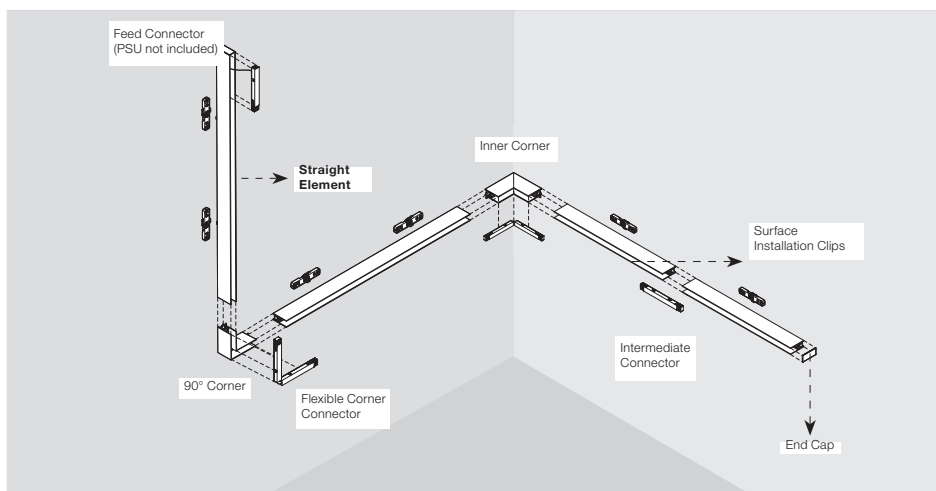

The Tracking Magnet EVO Surface

High-tech LED lighting system for interior architecture

Track

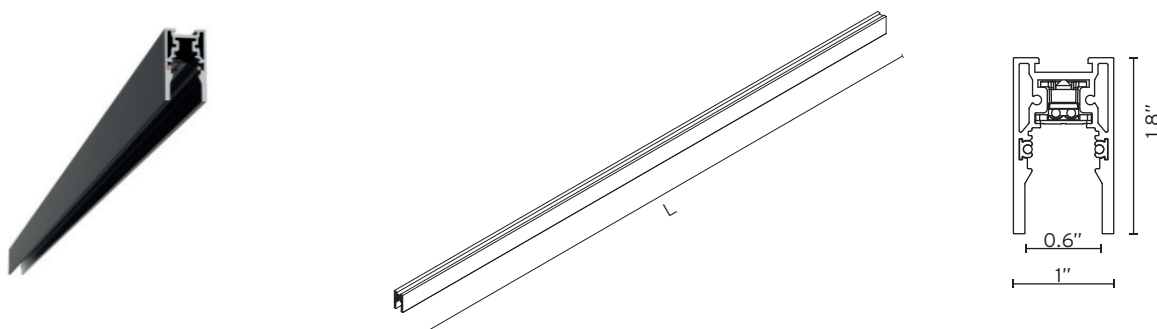

How to specify: 06.5060.14

Length	Part Number	Finish	Dimming Protocol
39.4" (1m)	06.5060	<input type="checkbox"/> 40 = White <input checked="" type="checkbox"/> 14 = Black <input type="checkbox"/> 05 = Chrome	Dimmable on Board
59" (1.5m)	06.5061		
78.7" (2m)	06.5062		
98.4" (2.5m)	06.5063		

Note: Track can be cut to different lengths in field

How to specify: 06.5010.14

Length	Part Number	Finish	Dimming Protocol
39.4" (1m)	06.5010	<input type="checkbox"/> 40 = White <input checked="" type="checkbox"/> 14 = Black <input type="checkbox"/> 05 = Chrome	1-10V, 10% Dimming DALI, 10% Dimming
59" (1.5m)	06.5011		
78.7" (2m)	06.5012		
98.4" (2.5m)	06.5013		

Note: Track can be cut to different lengths in field

The Tracking Magnet EVO Surface

High-tech LED lighting system for interior architecture

Corners

Mechanical Horizontal 90° Corner.
[2" x 2"]

Part Number:

- 06.5015.14
- 06.5015.40
- 06.5015.05

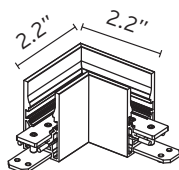
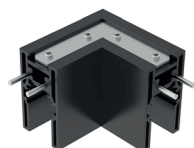

Mechanical Inside Corner. [2" x 2"]

Part Number:

- 06.5016.14
- 06.5016.40
- 06.5016.05

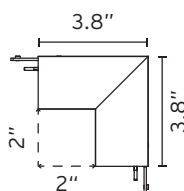

Mechanical T Corner.

Part Number:

- 06.5018.14
- 06.5018.40

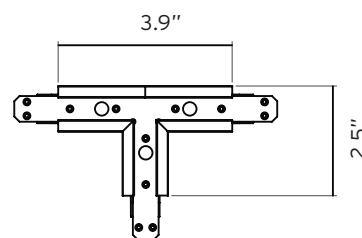
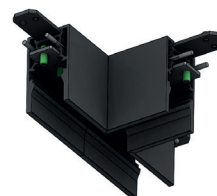

Mechanical X Corner.

Part Number:

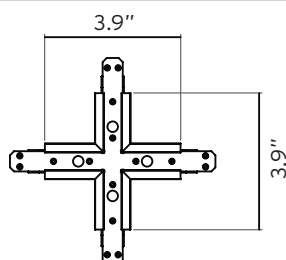

- 06.5019.14
- 06.5019.40



The Tracking Magnet EVO Surface

High-tech LED lighting system for interior architecture

Connectors

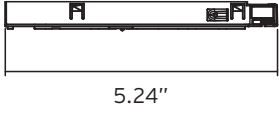
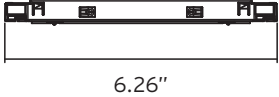
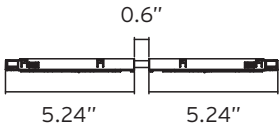
Feed connector	Intermediate Straight connector	Flexible/Electrical Intermediate Corner
Part Number: ■ 08.0611.14	Part Number: ■ 08.0612.14	Part Number: ■ 08.0614.14
		
		

Dimming controllers

Dimming Control Unit Box 48V
0-10V Required for a 0-10V Dimming
installation. 1 Dimmingo control can
control up to 20 fixtures

Part Number:

■ 08.0613.14A

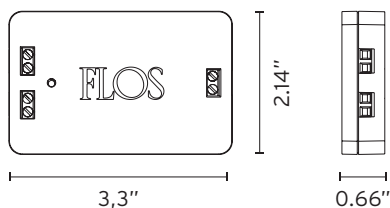

The Tracking Magnet EVO Surface

High-tech LED lighting system for interior architecture

Required Accesories

Fixed Ceiling Kit (2 units) *

*For installation on ACT or wood ceiling.
Consult factory for other ceiling types.

Part Number:

08.0615.00

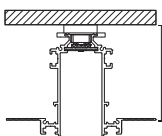

End Cap kit (2 units)

Part Number:

■ **06.5017.14**

□ **06.5017.40**

■ **06.5017.05**











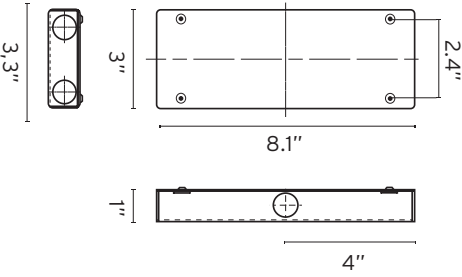

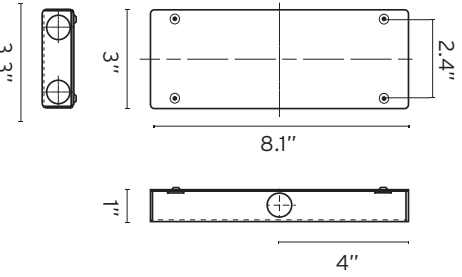
Profile	Quantities Ceiling kit
39.37" / 59.06" [1000 mm/ 1500 mm]	2
78.74" / 98.42" [2000 mm/ 2500 mm]	3

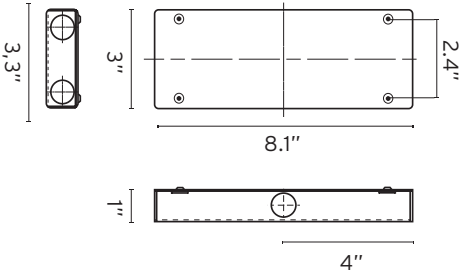
The Tracking Magnet EVO Surface

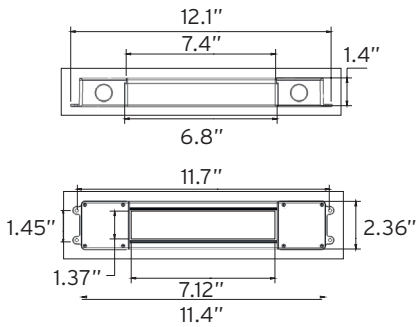
High-tech LED lighting system for interior architecture

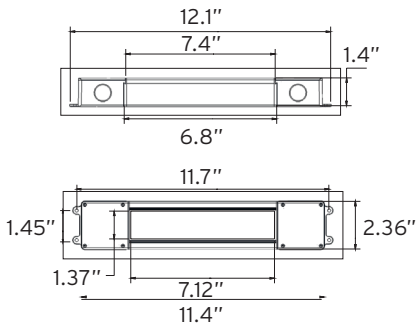
Required Drivers

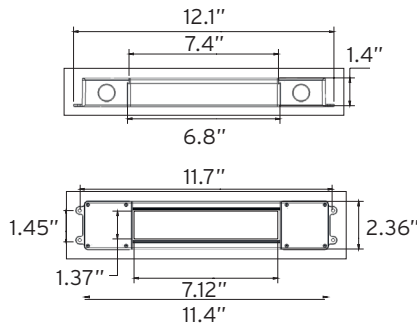
<p>LED power supply source for remote installation, 48V/96W, 120-277V, UL Listed</p> <p>Part Number:</p> <p>LEDSB96W48V-NDM-UO</p>  	<p>LED power supply source for remote installation, 48V/60W, 120-277V, UL Listed</p> <p>Part Number:</p> <p>LEDSB60W48V-NDM-U01</p>  	<p>LED power supply source for remote installation, 48V/30W, 120-277V, UL Listed</p> <p>Part Number:</p> <p>LEDSB40W48V-NDM-U01</p>  
<p>LED power supply source for remote installation, 48V/96W, 120-277V, UL Listed</p> <p>Part Number:</p> <p>LEDSB96W48V-NDM-DO1</p>  	<p>LED power supply source for remote installation, 48V/60W, 120-277V, UL Listed</p> <p>Part Number:</p> <p>LEDSB60W48V-NDM-DO1</p>  	<p>LED power supply source for remote installation, 48V/30W, 120-277V, UL Listed</p> <p>Part Number:</p> <p>LEDSB30W48V-NDM-DO1</p>  

The Tracking Magnet EVO Surface

High-tech LED lighting system for interior architecture

How to specify

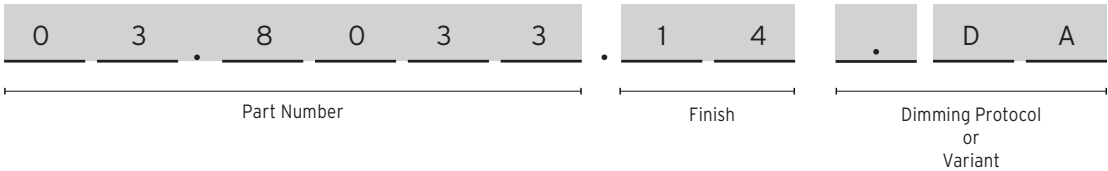

Spot 50

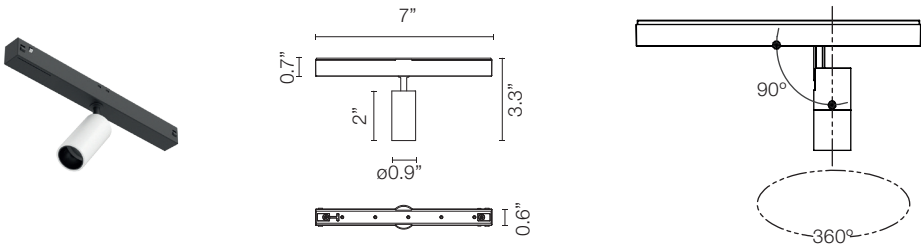

CCT	CRI	Initial Lumens	Delivered Lumens	Watts	Beam Spread	Part Number	Finish	Dimming Protocol	Photometric												
3000	90	307	212	3.5	26°	03.8033	<div><div></div> 40 = White</div> <div><div></div> 14 = Black</div> <div><div></div> 05 = Chrome</div>	A Dimmable on Board A1V = 0-10V, 10% Dimming ADA = DALI, 10% Dimming	<div><p>Luminous flux luminaire 212 lm</p></div> <table><thead><tr><th>E(h)</th><th>D(m)</th></tr></thead><tbody><tr><td>1 1012</td><td>0.47</td></tr><tr><td>2 253</td><td>0.94</td></tr><tr><td>3 112</td><td>1.41</td></tr><tr><td>4 63</td><td>1.88</td></tr><tr><td>5 40</td><td>2.35</td></tr></tbody></table>	E(h)	D(m)	1 1012	0.47	2 253	0.94	3 112	1.41	4 63	1.88	5 40	2.35
E(h)	D(m)																				
1 1012	0.47																				
2 253	0.94																				
3 112	1.41																				
4 63	1.88																				
5 40	2.35																				
2700	90	286	205	3.5	26°	03.8032			<div><p>Luminous flux luminaire 205 lm</p></div> <table><thead><tr><th>E(h)</th><th>D(m)</th></tr></thead><tbody><tr><td>1 977</td><td>0.47</td></tr><tr><td>2 244</td><td>0.94</td></tr><tr><td>3 109</td><td>1.41</td></tr><tr><td>4 61</td><td>1.88</td></tr><tr><td>5 39</td><td>2.35</td></tr></tbody></table>	E(h)	D(m)	1 977	0.47	2 244	0.94	3 109	1.41	4 61	1.88	5 39	2.35
E(h)	D(m)																				
1 977	0.47																				
2 244	0.94																				
3 109	1.41																				
4 61	1.88																				
5 39	2.35																				

Included Accessories Spot 50

Cross Baffle	Honeycomb

The Tracking Magnet EVO Surface

High-tech LED lighting system for interior architecture

Spot 90

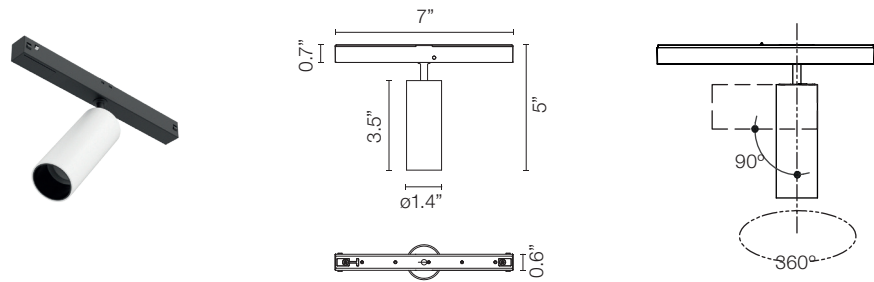

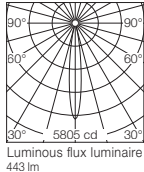
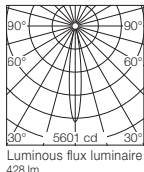
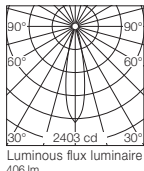
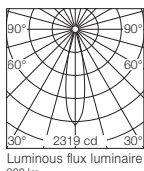
CCT	CRI	Initial Lumens	Delivered Lumens	Watts	Beam Spread	Part Number	Finish	Dimming Protocol	Photometric														
3000	90	656	443	8.5	14°	03.8043	<div><div></div> 40 = White</div> <div><div></div> 14 = Black</div> <div><div></div> 05 = Chrome</div>	<div>A Dimmable on Board</div> <div>A1V = 0-10V, 10% Dimming</div> <div>ADA = DALI, 10% Dimming</div>	<div><table><thead><tr><th>E(x)</th><th>D(m)</th></tr><tr><th>h(m)</th><th></th></tr></thead><tbody><tr><td>1 5805</td><td>0.25</td></tr><tr><td>2 1451</td><td>0.49</td></tr><tr><td>3 645</td><td>0.74</td></tr><tr><td>4 363</td><td>0.98</td></tr><tr><td>5 232</td><td>1.23</td></tr></tbody></table></div>	E(x)	D(m)	h(m)		1 5805	0.25	2 1451	0.49	3 645	0.74	4 363	0.98	5 232	1.23
E(x)	D(m)																						
h(m)																							
1 5805	0.25																						
2 1451	0.49																						
3 645	0.74																						
4 363	0.98																						
5 232	1.23																						
2700	90	610	428	8.5	14°	03.8042	<div><table><thead><tr><th>E(x)</th><th>D(m)</th></tr><tr><th>h(m)</th><th></th></tr></thead><tbody><tr><td>1 5601</td><td>0.25</td></tr><tr><td>2 1400</td><td>0.49</td></tr><tr><td>3 622</td><td>0.74</td></tr><tr><td>4 350</td><td>0.98</td></tr><tr><td>5 224</td><td>1.23</td></tr></tbody></table></div>	E(x)	D(m)	h(m)		1 5601	0.25	2 1400	0.49	3 622	0.74	4 350	0.98	5 224	1.23		
E(x)	D(m)																						
h(m)																							
1 5601	0.25																						
2 1400	0.49																						
3 622	0.74																						
4 350	0.98																						
5 224	1.23																						
3000	90	656	406	8.5	22°	03.8045	<div><table><thead><tr><th>E(x)</th><th>D(m)</th></tr><tr><th>h(m)</th><th></th></tr></thead><tbody><tr><td>1 2403</td><td>0.38</td></tr><tr><td>2 601</td><td>0.77</td></tr><tr><td>3 267</td><td>1.15</td></tr><tr><td>4 150</td><td>1.54</td></tr><tr><td>5 96</td><td>1.92</td></tr></tbody></table></div>	E(x)	D(m)	h(m)		1 2403	0.38	2 601	0.77	3 267	1.15	4 150	1.54	5 96	1.92		
E(x)	D(m)																						
h(m)																							
1 2403	0.38																						
2 601	0.77																						
3 267	1.15																						
4 150	1.54																						
5 96	1.92																						
2700	90	610	392	8.5	22°	03.8044	<div><table><thead><tr><th>E(x)</th><th>D(m)</th></tr><tr><th>h(m)</th><th></th></tr></thead><tbody><tr><td>1 2319</td><td>0.38</td></tr><tr><td>2 580</td><td>0.77</td></tr><tr><td>3 258</td><td>1.15</td></tr><tr><td>4 145</td><td>1.54</td></tr><tr><td>5 93</td><td>1.92</td></tr></tbody></table></div>	E(x)	D(m)	h(m)		1 2319	0.38	2 580	0.77	3 258	1.15	4 145	1.54	5 93	1.92		
E(x)	D(m)																						
h(m)																							
1 2319	0.38																						
2 580	0.77																						
3 258	1.15																						
4 145	1.54																						
5 93	1.92																						

Included Accessories Spot 90

Cross Baffle



Honeycomb



The Tracking Magnet EVO Surface

High-tech LED lighting system for interior architecture

Spot 120 Power LED

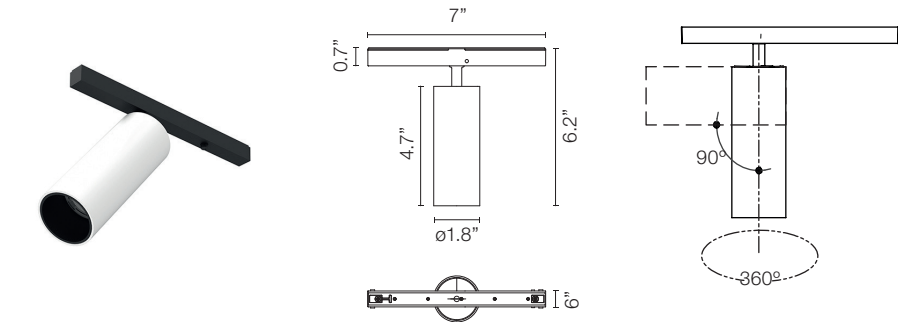

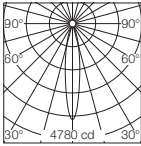
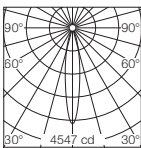
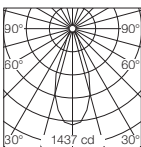
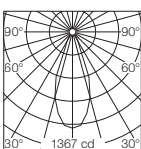
CCT	CRI	Initial Lumens	Delivered Lumens	Watts	Beam Spread	Part Number	Finish	Dimming Protocol	Photometric														
3000	90	779	558	12	11°	03.8053	<div><div></div> 40 = White</div> <div><div></div> 14 = Black</div> <div><div></div> 05 = Chrome</div>	<div>A Dimmable on Board</div> <div>A1V = 0-10V, 10% Dimming</div> <div>ADA = DALI, 10% Dimming</div>	<div><table><thead><tr><th>E(lx)</th><th>D(m)</th></tr></thead><tbody><tr><td>h(m)</td><td>17°</td></tr><tr><td>1</td><td>4780 0.31</td></tr><tr><td>2</td><td>1195 0.61</td></tr><tr><td>3</td><td>531 0.92</td></tr><tr><td>4</td><td>299 1.23</td></tr><tr><td>5</td><td>191 1.53</td></tr></tbody></table><div>Luminous flux luminaire 887 lm</div></div>	E(lx)	D(m)	h(m)	17°	1	4780 0.31	2	1195 0.61	3	531 0.92	4	299 1.23	5	191 1.53
E(lx)	D(m)																						
h(m)	17°																						
1	4780 0.31																						
2	1195 0.61																						
3	531 0.92																						
4	299 1.23																						
5	191 1.53																						
2700	90	724	539	12	11°	03.8052	<div><table><thead><tr><th>E(lx)</th><th>D(m)</th></tr></thead><tbody><tr><td>h(m)</td><td>17°</td></tr><tr><td>1</td><td>4547 0.31</td></tr><tr><td>2</td><td>1137 0.61</td></tr><tr><td>3</td><td>505 0.92</td></tr><tr><td>4</td><td>284 1.23</td></tr><tr><td>5</td><td>182 1.53</td></tr></tbody></table><div>Luminous flux luminaire 854 lm</div></div>	E(lx)	D(m)	h(m)	17°	1	4547 0.31	2	1137 0.61	3	505 0.92	4	284 1.23	5	182 1.53		
E(lx)	D(m)																						
h(m)	17°																						
1	4547 0.31																						
2	1137 0.61																						
3	505 0.92																						
4	284 1.23																						
5	182 1.53																						
3000	90	779	505	12	17°	03.8055	<div><table><thead><tr><th>E(lx)</th><th>D(m)</th></tr></thead><tbody><tr><td>h(m)</td><td>40°</td></tr><tr><td>1</td><td>1437 0.73</td></tr><tr><td>2</td><td>359 1.45</td></tr><tr><td>3</td><td>160 2.18</td></tr><tr><td>4</td><td>90 2.91</td></tr><tr><td>5</td><td>57 3.64</td></tr></tbody></table><div>Luminous flux luminaire 829 lm</div></div>	E(lx)	D(m)	h(m)	40°	1	1437 0.73	2	359 1.45	3	160 2.18	4	90 2.91	5	57 3.64		
E(lx)	D(m)																						
h(m)	40°																						
1	1437 0.73																						
2	359 1.45																						
3	160 2.18																						
4	90 2.91																						
5	57 3.64																						
2700	90	724	487	12	17°	03.8054	<div><table><thead><tr><th>E(lx)</th><th>D(m)</th></tr></thead><tbody><tr><td>h(m)</td><td>40°</td></tr><tr><td>1</td><td>1367 0.73</td></tr><tr><td>2</td><td>342 1.45</td></tr><tr><td>3</td><td>152 2.18</td></tr><tr><td>4</td><td>85 2.91</td></tr><tr><td>5</td><td>55 3.64</td></tr></tbody></table><div>Luminous flux luminaire 599 lm</div></div>	E(lx)	D(m)	h(m)	40°	1	1367 0.73	2	342 1.45	3	152 2.18	4	85 2.91	5	55 3.64		
E(lx)	D(m)																						
h(m)	40°																						
1	1367 0.73																						
2	342 1.45																						
3	152 2.18																						
4	85 2.91																						
5	55 3.64																						

Included Accessories Spot 90

Cross Baffle



Honeycomb



The Tracking Magnet EVO Surface

High-tech LED lighting system for interior architecture

Spot 120 LED ARRAY

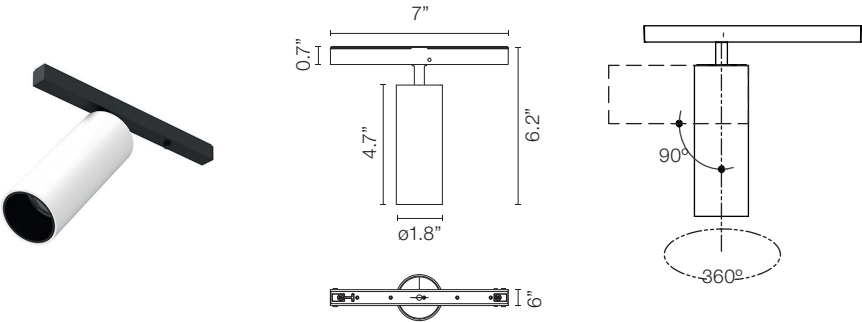

CCT	CRI	Initial Lumens	Delivered Lumens	Watts	Beam Spread	Part Number	Finish	Dimming Protocol	Photometric														
3000	90	1138	687	12.5	17°	03.8155	<div><div></div> 40 = White</div> <div><div></div> 14 = Black</div> <div><div></div> 05 = Chrome</div>	<div>Dimmable on Board</div> <div>1V = 0-10V, 10% Dimming</div> <div>DA = DALI, 10% Dimming</div>	<div><p>Luminous flux luminaire 687 lm</p><table><tr><td>E(x)</td><td>D(m)</td></tr><tr><td>h(m)</td><td>17°</td></tr><tr><td>1</td><td>4780 0.31</td></tr><tr><td>2</td><td>1195 0.61</td></tr><tr><td>3</td><td>531 0.92</td></tr><tr><td>4</td><td>299 1.23</td></tr><tr><td>5</td><td>191 1.53</td></tr></table></div>	E(x)	D(m)	h(m)	17°	1	4780 0.31	2	1195 0.61	3	531 0.92	4	299 1.23	5	191 1.53
E(x)	D(m)																						
h(m)	17°																						
1	4780 0.31																						
2	1195 0.61																						
3	531 0.92																						
4	299 1.23																						
5	191 1.53																						
2700	90	1075	654	12.5	17°	03.8154	<div><p>Luminous flux luminaire 654 lm</p><table><tr><td>E(x)</td><td>D(m)</td></tr><tr><td>h(m)</td><td>17°</td></tr><tr><td>1</td><td>4547 0.31</td></tr><tr><td>2</td><td>1137 0.61</td></tr><tr><td>3</td><td>505 0.92</td></tr><tr><td>4</td><td>284 1.23</td></tr><tr><td>5</td><td>182 1.53</td></tr></table></div>	E(x)	D(m)	h(m)	17°	1	4547 0.31	2	1137 0.61	3	505 0.92	4	284 1.23	5	182 1.53		
E(x)	D(m)																						
h(m)	17°																						
1	4547 0.31																						
2	1137 0.61																						
3	505 0.92																						
4	284 1.23																						
5	182 1.53																						
3000	90	1138	629	12.5	40°	03.8157	<div><p>Luminous flux luminaire 629 lm</p><table><tr><td>E(x)</td><td>D(m)</td></tr><tr><td>h(m)</td><td>40°</td></tr><tr><td>1</td><td>1437 0.73</td></tr><tr><td>2</td><td>359 1.45</td></tr><tr><td>3</td><td>160 2.18</td></tr><tr><td>4</td><td>90 2.91</td></tr><tr><td>5</td><td>57 3.64</td></tr></table></div>	E(x)	D(m)	h(m)	40°	1	1437 0.73	2	359 1.45	3	160 2.18	4	90 2.91	5	57 3.64		
E(x)	D(m)																						
h(m)	40°																						
1	1437 0.73																						
2	359 1.45																						
3	160 2.18																						
4	90 2.91																						
5	57 3.64																						
2700	90	1075	599	12.5	40°	03.8156	<div><p>Luminous flux luminaire 599 lm</p><table><tr><td>E(x)</td><td>D(m)</td></tr><tr><td>h(m)</td><td>40°</td></tr><tr><td>1</td><td>1367 0.73</td></tr><tr><td>2</td><td>342 1.45</td></tr><tr><td>3</td><td>152 2.18</td></tr><tr><td>4</td><td>85 2.91</td></tr><tr><td>5</td><td>55 3.64</td></tr></table></div>	E(x)	D(m)	h(m)	40°	1	1367 0.73	2	342 1.45	3	152 2.18	4	85 2.91	5	55 3.64		
E(x)	D(m)																						
h(m)	40°																						
1	1367 0.73																						
2	342 1.45																						
3	152 2.18																						
4	85 2.91																						
5	55 3.64																						

Included Accessories Spot 90

Cross Baffle	Honeycomb

The Tracking Magnet EVO Surface

High-tech LED lighting system for interior architecture

Spot 150

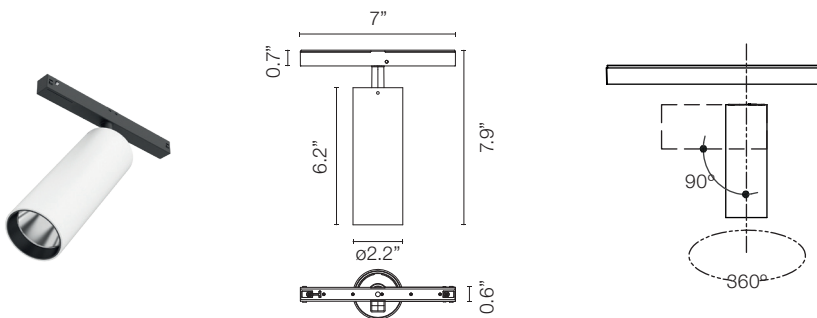

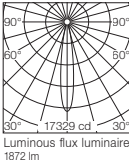
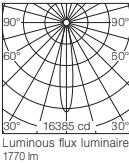
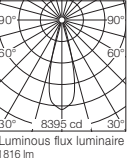
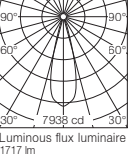
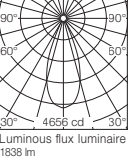
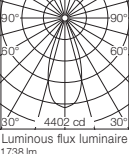



CCT	CRI	Initial Lumens	Delivered Lumens	Watts	Beam Spread	Part Number	Finish	Dimming Protocol	Photometric												
3000	90	2115	1872	22.5	16°	03.8073	<div><div></div> 40 = White</div> <div><div></div> 14 = Black</div> <div><div></div> 05 = Chrome</div>	Dimmable on Board	<div><table><thead><tr><th>E(x)</th><th>D(m)</th></tr></thead><tbody><tr><td>1</td><td>17329 0.28</td></tr><tr><td>2</td><td>4332 0.56</td></tr><tr><td>3</td><td>1925 0.84</td></tr><tr><td>4</td><td>1083 1.12</td></tr><tr><td>5</td><td>693 1.40</td></tr></tbody></table></div>	E(x)	D(m)	1	17329 0.28	2	4332 0.56	3	1925 0.84	4	1083 1.12	5	693 1.40
E(x)	D(m)																				
1	17329 0.28																				
2	4332 0.56																				
3	1925 0.84																				
4	1083 1.12																				
5	693 1.40																				
2700	90	2000	1770	22.5	16°	03.8072	1V = 0-10V, 10% Dimming	<div><table><thead><tr><th>E(x)</th><th>D(m)</th></tr></thead><tbody><tr><td>1</td><td>16385 0.28</td></tr><tr><td>2</td><td>4096 0.56</td></tr><tr><td>3</td><td>1821 0.84</td></tr><tr><td>4</td><td>1024 1.12</td></tr><tr><td>5</td><td>655 1.40</td></tr></tbody></table></div>	E(x)	D(m)	1	16385 0.28	2	4096 0.56	3	1821 0.84	4	1024 1.12	5	655 1.40	
E(x)	D(m)																				
1	16385 0.28																				
2	4096 0.56																				
3	1821 0.84																				
4	1024 1.12																				
5	655 1.40																				
3000	90	2115	1816	22.5	28°	03.8075	<div><div></div> 40 = White</div> <div><div></div> 14 = Black</div> <div><div></div> 05 = Chrome</div>	Dimmable on Board	<div><table><thead><tr><th>E(x)</th><th>D(m)</th></tr></thead><tbody><tr><td>1</td><td>8395 0.50</td></tr><tr><td>2</td><td>2099 1.00</td></tr><tr><td>3</td><td>933 1.50</td></tr><tr><td>4</td><td>525 2.00</td></tr><tr><td>5</td><td>336 2.50</td></tr></tbody></table></div>	E(x)	D(m)	1	8395 0.50	2	2099 1.00	3	933 1.50	4	525 2.00	5	336 2.50
E(x)	D(m)																				
1	8395 0.50																				
2	2099 1.00																				
3	933 1.50																				
4	525 2.00																				
5	336 2.50																				
2700	90	2000	1717	22.5	28°	03.8074	A1V = 0-10V, 10% Dimming	<div><table><thead><tr><th>E(x)</th><th>D(m)</th></tr></thead><tbody><tr><td>1</td><td>7938 0.50</td></tr><tr><td>2</td><td>1984 1.00</td></tr><tr><td>3</td><td>882 1.50</td></tr><tr><td>4</td><td>496 2.00</td></tr><tr><td>5</td><td>318 2.50</td></tr></tbody></table></div>	E(x)	D(m)	1	7938 0.50	2	1984 1.00	3	882 1.50	4	496 2.00	5	318 2.50	
E(x)	D(m)																				
1	7938 0.50																				
2	1984 1.00																				
3	882 1.50																				
4	496 2.00																				
5	318 2.50																				
3000	90	2115	1838	22.5	40°	03.8077	<div><div></div> 40 = White</div> <div><div></div> 14 = Black</div> <div><div></div> 05 = Chrome</div>	Dimmable on Board	<div><table><thead><tr><th>E(x)</th><th>D(m)</th></tr></thead><tbody><tr><td>1</td><td>4656 0.73</td></tr><tr><td>2</td><td>1164 1.46</td></tr><tr><td>3</td><td>517 2.18</td></tr><tr><td>4</td><td>291 2.91</td></tr><tr><td>5</td><td>186 3.64</td></tr></tbody></table></div>	E(x)	D(m)	1	4656 0.73	2	1164 1.46	3	517 2.18	4	291 2.91	5	186 3.64
E(x)	D(m)																				
1	4656 0.73																				
2	1164 1.46																				
3	517 2.18																				
4	291 2.91																				
5	186 3.64																				
2700	90	2000	1738	22.5	40°	03.8076	1V = 0-10V, 10% Dimming	<div><table><thead><tr><th>E(x)</th><th>D(m)</th></tr></thead><tbody><tr><td>1</td><td>4402 0.73</td></tr><tr><td>2</td><td>1101 1.46</td></tr><tr><td>3</td><td>489 2.18</td></tr><tr><td>4</td><td>275 2.91</td></tr><tr><td>5</td><td>176 3.64</td></tr></tbody></table></div>	E(x)	D(m)	1	4402 0.73	2	1101 1.46	3	489 2.18	4	275 2.91	5	176 3.64	
E(x)	D(m)																				
1	4402 0.73																				
2	1101 1.46																				
3	489 2.18																				
4	275 2.91																				
5	176 3.64																				

The Tracking Magnet EVO Surface

High-tech LED lighting system for interior architecture

Optional Accessories Spot 150

Cross Baffle <hr/> Part Number: 08.8429.00 	Elliptical Lens <hr/> Part Number: 08.8431.00 	Flood Lens <hr/> Part Number: 08.8432.00 
Honeycomb <hr/> Part Number: 08.8428.00 	Snoot shielding cone <hr/> Part Number: 08.0526.00 	

The Tracking Magnet EVO Recessed

High-tech LED lighting system for interior architecture

Wallee

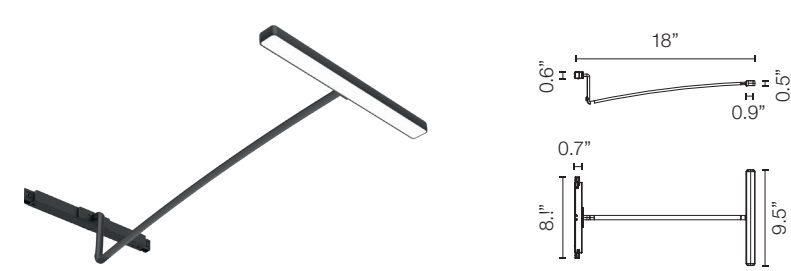

CCT	CRI	Initial Lumen	Delivered Lumens	Watts	Beam Spread	Part Number	Finish	Dimming Protocol	Photometric
3000	90	818	454	10	96°	03.8091	<div> <div></div>40 = White <div></div>14 = Black </div>	Dimmable on Board 1V = 0-10V, 10% Dimming DA = DALI, 10% Dimming	<div> E(lx) D(m) h(m) 96° 1 183 2.21 2 46 4.43 3 20 6.64 4 11 8.85 5 7 11.07 </div>
2700	90	773	454	10	96°	03.8090	<div> <div></div>40 = White <div></div>14 = Black </div>	Dimmable on Board 1V = 0-10V, 10% Dimming DA = DALI, 10% Dimming	<div> E(lx) D(m) h(m) 96° 1 183 2.21 2 46 4.43 3 20 6.64 4 11 8.85 5 7 11.07 </div>

The Tracking Magnet EVO Recessed

High-tech LED lighting system for interior architecture

Light Strip

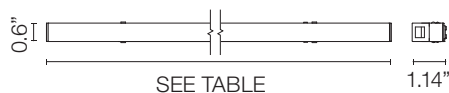

Length	CRI	CCT	Initial Lumens	Delivered Lumens	Watts	Part Number	Finish	Dimming Protocol
11.8" (300 mm)	90	2700	558	244	6	03.8000	■ 14 = Black	Dimmable on Board 1V = 0-10V, 10% Dimming DA = DALI, 10% Dimming
23.6" (600 mm)	90	2700	1115	488	12	03.8001		
35.4" (900 mm)	90	2700	1673	732	18	03.8002		
47.2" (1200 mm)	90	2700	2230	976	24	03.8003		
59" (1500 mm)	90	2700	2788	1220	30	03.8004		

Length	CRI	CCT	Initial Lumens	Delivered Lumens	Watts	Part Number	Finish	Dimming Protocol
11.8" (300 mm)	90	3000	590	258	6	03.8005	■ 14 = Black	Dimmable on Board 1V = 0-10V, 10% Dimming DA = DALI, 10% Dimming
23.6" (600 mm)	90	3000	1180	516	12	03.8006		
35.4" (900 mm)	90	3000	1670	773	18	03.8007		
47.2" (1200 mm)	90	3000	2360	1031	24	03.8008		
59" (1500 mm)	90	3000	2950	1289	30	03.8009		

The Tracking Magnet EVO Recessed

High-tech LED lighting system for interior architecture

Anthony Spot Track

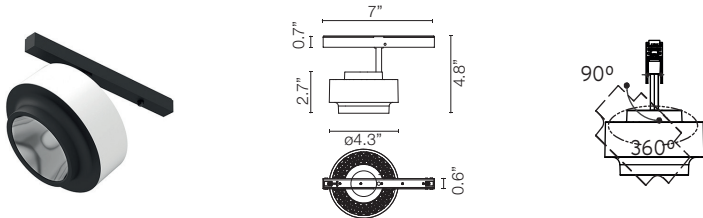

CCT	CRI	Initial Lumens	Delivered Lumens	Watts	Beam Spread	Part Number	Finish	Dimming Protocol	Photometric
3000	90	1730	1425	17.6	15°	03.8027	<div> <div>40 = White</div> <div>14 = Black</div> <div>05 = Chrome</div> </div>	<div>Dimmable on Board</div> <div>1V = 0-10V, 10% Dimming</div> <div>DA = DALI, 10% Dimming</div>	<div> <div>Beam Angle: 15°</div> <div>h(m) E(lx) D(m)</div> <div>1 14285 0.27</div> <div>2 3571 0.54</div> <div>3 1587 0.81</div> <div>4 893 1.07</div> <div>5 571 1.34</div> <div>Luminous flux luminaire 1425 lm</div> </div>
2700	90	1620	1241	17.6	15°	03.8025			<div> <div>Beam Angle: 15°</div> <div>h(m) E(lx) D(m)</div> <div>1 12442 0.27</div> <div>2 3110 0.54</div> <div>3 1382 0.81</div> <div>4 778 1.07</div> <div>5 498 1.34</div> <div>Luminous flux luminaire 1241 lm</div> </div>
3000	90	1730	1426	17.6	32°	03.8028			<div> <div>Beam Angle: 28°</div> <div>h(m) E(lx) D(m)</div> <div>1 5799 0.49</div> <div>2 1450 0.98</div> <div>3 644 1.47</div> <div>4 362 1.97</div> <div>5 232 2.46</div> <div>Luminous flux luminaire 1399 lm</div> </div>
2700	90	1620	1242	17.6	32°	03.8026			<div> <div>Beam Angle: 28°</div> <div>h(m) E(lx) D(m)</div> <div>1 5145 0.49</div> <div>2 1286 0.98</div> <div>3 572 1.47</div> <div>4 322 1.97</div> <div>5 206 2.46</div> <div>Luminous flux luminaire 1242 lm</div> </div>

The Tracking Magnet EVO Recessed

High-tech LED lighting system for interior architecture

Optional Accessories Anthony Spot

Honeycomb	Elliptical Lens	Flood Lens (28° Anthony Fixture + Flood Lens = 35°)
Part Number: 08.8419.14A	Part Number: 08.8418.68A	Part Number: 08.0050.00
		