

The Tracking Magnet EVO

High-tech LED lighting system for interior architecture

Spot 90

How to specify

03.8043.40.DA

Accent LED Spot modules can be rapidly exchanged and repositioned without tools. Light elements are quick to position and connect automatically with magnets. Honeycomb and cross baffle comes standard with the fixture. IP20

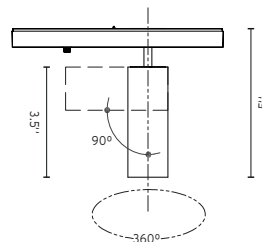
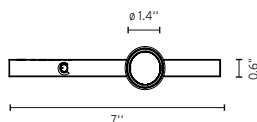
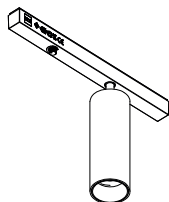

CCT	CRI	Initial Lumens	Delivered Lumens	Watts	Beam Spread	Part Number	Finish	Dimming Protocol	Photometric												
3000	90	656	443	8.5	14°	03.8043	<div><div></div> 40 = White</div> <div><div></div> 14 = Black</div> <div><div></div> 05 = Chrome</div>	<div>Dimmable on Board</div> <div>1V = 0-10V, 10% Dimming</div> <div>DA = DALI, 10% Dimming</div>	14° <div><table><thead><tr><th>E(x)</th><th>D(m)</th></tr></thead><tbody><tr><td>1 5805</td><td>0.25</td></tr><tr><td>2 1451</td><td>0.49</td></tr><tr><td>3 645</td><td>0.74</td></tr><tr><td>4 363</td><td>0.98</td></tr><tr><td>5 232</td><td>1.23</td></tr></tbody></table>Luminous flux luminaire 443 lm</div>	E(x)	D(m)	1 5805	0.25	2 1451	0.49	3 645	0.74	4 363	0.98	5 232	1.23
E(x)	D(m)																				
1 5805	0.25																				
2 1451	0.49																				
3 645	0.74																				
4 363	0.98																				
5 232	1.23																				
2700	90	610	428	8.5	14°	03.8042	14° <div><table><thead><tr><th>E(x)</th><th>D(m)</th></tr></thead><tbody><tr><td>1 5601</td><td>0.25</td></tr><tr><td>2 1400</td><td>0.49</td></tr><tr><td>3 622</td><td>0.74</td></tr><tr><td>4 350</td><td>0.98</td></tr><tr><td>5 224</td><td>1.23</td></tr></tbody></table>Luminous flux luminaire 428 lm</div>	E(x)	D(m)	1 5601	0.25	2 1400	0.49	3 622	0.74	4 350	0.98	5 224	1.23		
E(x)	D(m)																				
1 5601	0.25																				
2 1400	0.49																				
3 622	0.74																				
4 350	0.98																				
5 224	1.23																				
3000	90	656	406	8.5	22°	03.8045	22° <div><table><thead><tr><th>E(x)</th><th>D(m)</th></tr></thead><tbody><tr><td>1 2403</td><td>0.38</td></tr><tr><td>2 601</td><td>0.77</td></tr><tr><td>3 267</td><td>1.15</td></tr><tr><td>4 150</td><td>1.54</td></tr><tr><td>5 96</td><td>1.92</td></tr></tbody></table>Luminous flux luminaire 406 lm</div>	E(x)	D(m)	1 2403	0.38	2 601	0.77	3 267	1.15	4 150	1.54	5 96	1.92		
E(x)	D(m)																				
1 2403	0.38																				
2 601	0.77																				
3 267	1.15																				
4 150	1.54																				
5 96	1.92																				
2700	90	610	392	8.5	22°	03.8044	22° <div><table><thead><tr><th>E(x)</th><th>D(m)</th></tr></thead><tbody><tr><td>1 2319</td><td>0.38</td></tr><tr><td>2 580</td><td>0.77</td></tr><tr><td>3 258</td><td>1.15</td></tr><tr><td>4 145</td><td>1.54</td></tr><tr><td>5 93</td><td>1.92</td></tr></tbody></table>Luminous flux luminaire 392 lm</div>	E(x)	D(m)	1 2319	0.38	2 580	0.77	3 258	1.15	4 145	1.54	5 93	1.92		
E(x)	D(m)																				
1 2319	0.38																				
2 580	0.77																				
3 258	1.15																				
4 145	1.54																				
5 93	1.92																				