

Light Shadow Fixed, Trimless 8L

NON-IC Ceiling Recessed Fixed Downlight.

Description

Flos introduces Light Shadow, a revolution in low-glare lighting. A patented and unique optical solution in this new family reaches extreme cut off angles without sacrificing efficiency. The optics have been designed exclusively by FLOS and guarantee maximum control and uniformity of the beam. Light Shadow is a downlight that can be perfectly incorporated into any architecture because of its extraordinary compact size that allows the integration even when there is a minimum space. The collection is available in 2/4/8/or 12 spots, trimmed or trimless, and fixed or adjustable. It can be mounted in continuous row. The Light Shadow 4 spot is also available as a light element for Running Magnet 2.0.

Lamp

Table with 2 columns: Specification (Lamp Type, Wattage, Initial Lumens, Color Temperature, Color rendering) and Value (LED, 21.6W / 18,5W, 2160lm / 1800lm, 2280lm / 1900lm, 2700K, 3000K, 3500K*, CRI 90).

Optical

Table with 2 columns: Specification (Beam Angle, Lighting Type, Light Distribution) and Value (10°/ 22°/ 33°/ 45°, Direct, Symmetric).

Physical

Table with 2 columns: Specification (Material, Aiming, Weight, Ingress Protection Rating) and Value (Aluminum, Fixed, 1.1 Pounds, IP55).

Finishes:

Interior: White, Black, Copper, Steel, Bronze
Exterior: 40 White, 14 Black

Table with 2 columns: Specification (Installation type, Environment, Minimum Plenum height, Maximum Ceiling thickness) and Value (Ceiling Recessed, Indoor, 4", 5/8" (1/2" also available)).



Dimensions

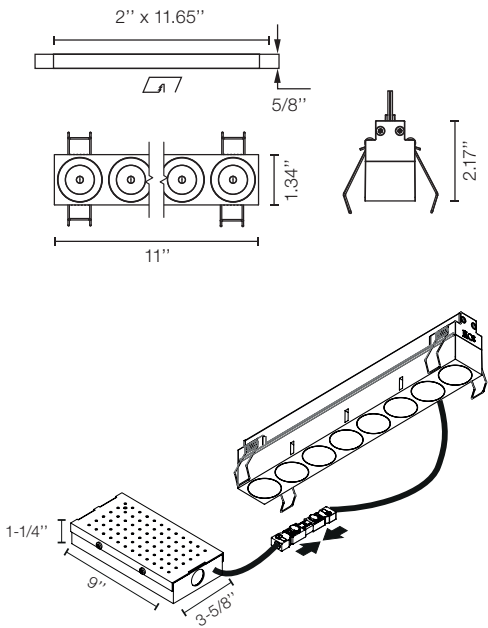

Certifications



Photometrics

For current IES files please visit arch.flosusa.com

Warranty

2 years from date of sale.

FLOS, USA
36 East 31st Street
Suite 402
New York N.Y. 10016
(800) 841.4011



Light Shadow Fixed, Trimless 8L

NON-IC Ceiling Recessed Fixed Downlight.



Electrical & Control

Driver Input Voltage	120V or 277V (depending on Selected Splice Box)
Control	0-10V and ELV
Driver	Integral - Splice Box
Current	900mA / 750mA

Performance	From 1531m To 1741lm
Delivered Lumens	80.6 lm/W
Efficacy	

Dimensions

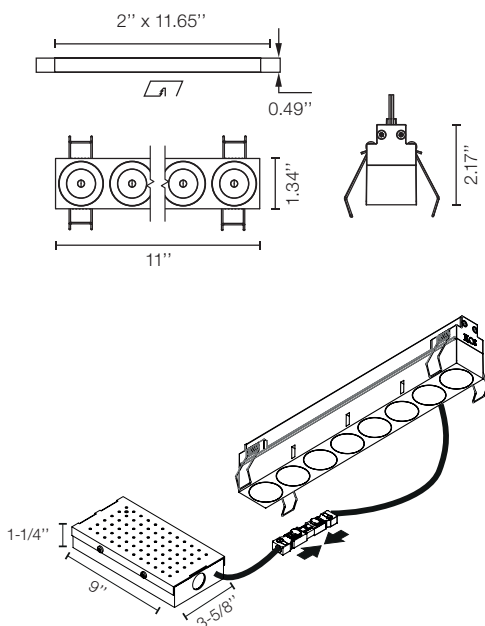

Notes

Black reflector provides the greatest comfort level

Integral LED board is not field replaceable.

Pre-Installation frame required.

Splice Box is installed from below.

Non IC rated luminaire

Splice Box required has to be ordered separately always from FLOS. 3 Standard Options:

- 0-10V Dimming 120V
- 0-10V Dimming 277V
- ELV Dimming 120V

3500K and other CCT available but not cataloged. Consult factory for additional color temperatures.

Certifications



Photometrics

For current IES files please visit
arch.flosusa.com

Warranty

2 years from date of sale.

Light Shadow Fixed, Trimless 8L

NON-IC Ceiling Recessed Fixed Downlight.

How to specify

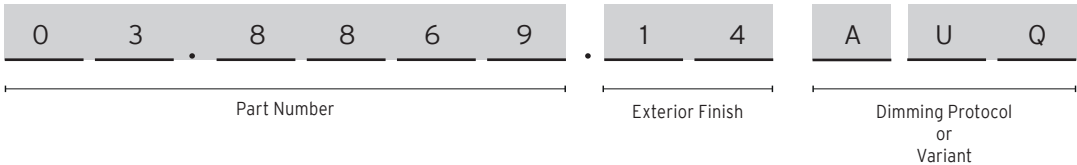

How to Specify ex. 03.8869.14AUQ

CCT	CRI	Initial Lumens (900mA/750mA)	Watts (900mA/750mA)	Beam Angle	Part Number	Exterior Finish	Interior Finish	Variant
2700	90	2160 / 1800	21,6 / 18,5	10°	03.8869	<div> <div>40 = White</div> <div>14 = Black</div> </div>	Black	AUQ = US product. Splice Box* not included. *Has to be Always supply by FLOS
					03.8868		White	
					05.1240		Copper	
					05.1241		Steel	
					05.1242		Bronze	
3000	90	2280 / 1900	21,6 / 18,5	10°	03.8873	<div> <div>40 = White</div> <div>14 = Black</div> </div>	Black	
					03.8872		White	
					05.1245		Copper	
					05.1246		Steel	
					05.1247		Bronze	
2700	90	2160 / 1800	21,6 / 18,5	22°	03.9241	<div> <div>40 = White</div> <div>14 = Black</div> </div>	Black	
					03.9240		White	
					05.1250		Copper	
					05.1251		Steel	
					05.1252		Bronze	
3000	90	2280 / 1900	21,6 / 18,5	22°	03.9251	<div> <div>40 = White</div> <div>14 = Black</div> </div>	Black	
					03.9250		White	
					05.1255		Copper	
					05.1256		Steel	
					05.1257		Bronze	

Light Shadow Fixed, Trimless 8L

NON-IC Ceiling Recessed Fixed Downlight.

How to Specify ex. 03.9246.14AUQ

CCT	CRI	Initial Lumens (900mA/750mA)	Watts (900mA/750mA)	Beam Angle	Part Number	Exterior Finish	Interior Finish	Variant
2700	90	2160 / 1800	21,6 / 18,5	33°	03.9246	<div><div></div> 40 = White</div> <div><div></div> 14 = Black</div>	<div><div></div> Black</div>	AUQ = US product. Splice Box* not included. *Has to be Always supply by FLOS
					03.9245		<div><div></div> White</div>	
					05.1260		<div><div></div> Copper</div>	
					05.1261		<div><div></div> Steel</div>	
					05.1262		<div><div></div> Bronze</div>	
3000	90	2280 / 1900	21,6 / 18,5	33°	03.9256	<div><div></div> 40 = White</div> <div><div></div> 14 = Black</div>	<div><div></div> Black</div>	
					03.9255		<div><div></div> White</div>	
					05.1265		<div><div></div> Copper</div>	
					05.1266		<div><div></div> Steel</div>	
					05.1267		<div><div></div> Bronze</div>	
2700	90	2160 / 1800	21,6 / 18,5	45°	03.8367	<div><div></div> 40 = White</div> <div><div></div> 14 = Black</div>	<div><div></div> Black</div>	
					03.8366		<div><div></div> White</div>	
					05.1270		<div><div></div> Copper</div>	
					05.1271		<div><div></div> Steel</div>	
					05.1272		<div><div></div> Bronze</div>	
3000	90	2280 / 1900	21,6 / 18,5	45°	03.8371	<div><div></div> 40 = White</div> <div><div></div> 14 = Black</div>	<div><div></div> Black</div>	
					03.8370		<div><div></div> White</div>	
					05.1275		<div><div></div> Copper</div>	
					05.1276		<div><div></div> Steel</div>	
					05.1277		<div><div></div> Bronze</div>	

Photometrics

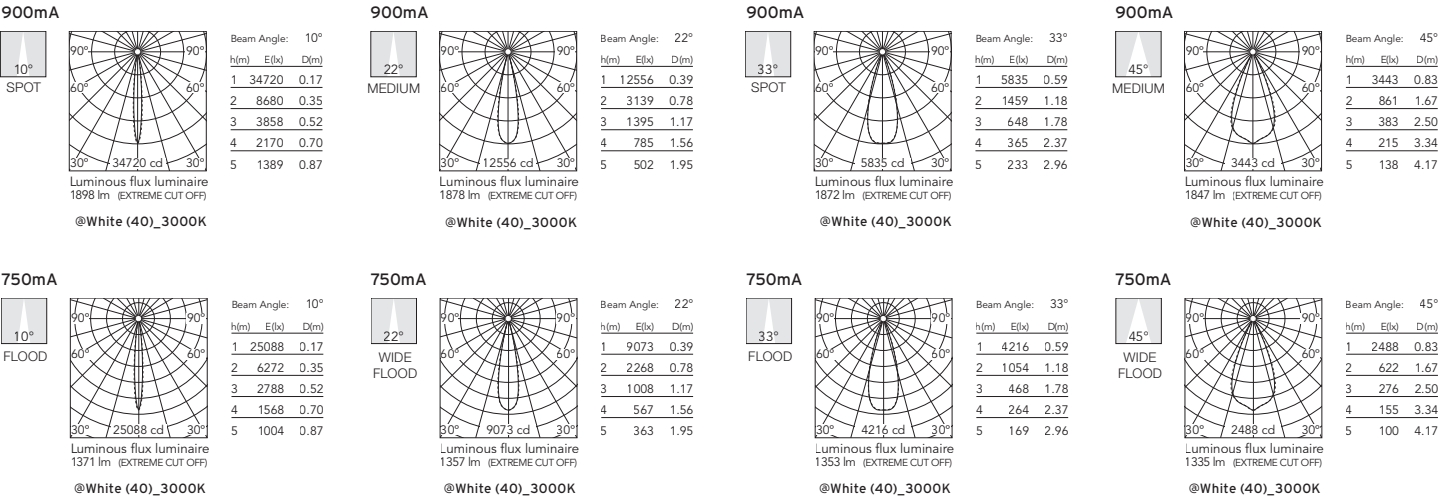

Light Shadow Fixed, Trimless 8L

NON-IC Ceiling Recessed Fixed Downlight.

Required Splice Box

Splice Box 25W, 1 dim, 0-10V, 120V. Size: 9" x 3.59" x 1.25"	Splice Box 25W, 1 dim, 0-10V, 277V. Size: 9" x 3.59" x 1.25"	Splice Box 30W, 20 dim, ELV, 120V. Size: 9" x 3.59" x 1.25"
SP25W900MA-120-A01	SP25W900MA-277-A01	SP30W900MA-ELV-U01

Light Shadow Fixed, Trimless 8L

NON-IC Ceiling Recessed Fixed Downlight.

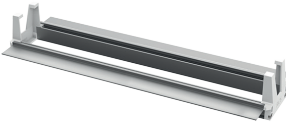
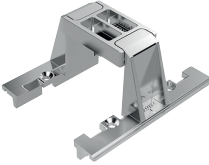
Required Accessories	Optional Accessories
Pre-installation trimless frame 8L 5/8" ceiling thickness	Accessory for mounting trimless continuous line. Each accessory allows connection between two trimless pre-installation frames.
08.0512.00.90	08.0052.90
	

Continuous Lines | How to Specify

- A. Select modules sizes and pre-installation frames
- 1. 2 Lights module
 - 2. 4 Lights module
 - 3. 8 Lights Module
 - 4. 12 Module

- C. Use the accessory to joint the frames
- Each accessory allows connection between two trimless pre-installation frames.

- D. Install the continuous frame in the drywall ceiling and place the light modules

