

Johnny 80 (3.2") 1L Square

Ceiling Recessed Trimmed Spot

Description

LED luminaire for recessed mounting into plasterboard ceilings. Illumination system consisting of one or two adjustable lights in a recessed version (trim or trimless) or in a semi recessed version. Available in two sizes: 80 mm (3.2") and 120 mm (4.7") in round and square versions.

The Johnny 120 is supplied with two frame rings (black and white), which should be fitted to the product if a trimmed version is required, or without, if a Trimless version is required. An exclusive, easy and adjustable system that enables an accurate adjustment of the light beam. The Trimless Ø80 mm (3.2") version has an exclusive Fast&Perfect installation tool.

Lamps

POWER LED : CREE
6.2W, 600lm, 3000K, CRI90
6.2W, 560lm, 2700K, CRI90

Delivered lumen from 284 lm up to 378 lm

Construction

Luminaire body made of die cast aluminum

Should ready Honeycomb louver and cross baffle.

Factory suggest minimum 9.5" plenum height

Electrical

Fixture is constant current, low voltage LED with integral power supply.

Fixture is 6.2 watts.

Finish

☐ 40 White

☒ 14 Black



Notes

Recessed luminaire for LED light source.

Beam spreads available in 14°, 23° and 33°.

The Johnny 80 (3.2") version has an orientation system integrated into the telescopic body.

Maximum rotation 360°

Maximum tilt angle 40°

Listings: UL listed, IP20

Warranty

2 years from date of sale.

Photometrics

For current IES files please visit architectural.flosusa.com

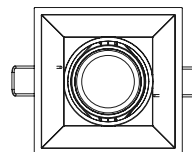
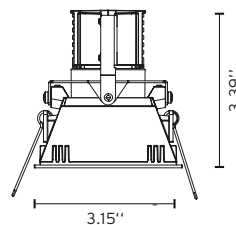
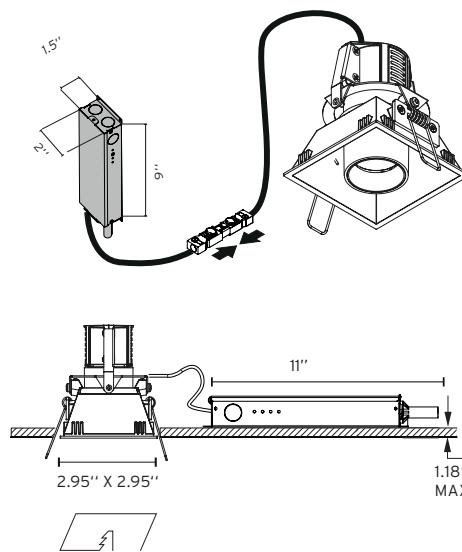

Johnny 80 (3.2") 1L Square

Ceiling Recessed Trimmed Spot

How to Specify ex. 03.0703.14.UL

QTY	Item Number	Beam Angle	Description	Finish	Power Supply
	03.0703	14°	Johnny 80 Square Trimmed 1L, 6.2W, 560lm, 2700K, CRI 90	<div> <div>■ 14 = Black</div> <div>□ 40 = White</div> </div>	GT = Splice box, 10% Dim, ELV, 120V UL = Splice box, 1% Dim, 1-10V, 120V 7U = Splice box, 1% Dim, 1-10V, 277V
	03.0702	14°	Johnny 80 Square Trimmed 1L, 6.2W, 600lm, 3000K, CRI 90	<div> <div>■ 14 = Black</div> <div>□ 40 = White</div> </div>	GT = Splice box, 10% Dim, ELV, 120V UL = Splice box, 1% Dim, 1-10V, 120V 7U = Splice box, 1% Dim, 1-10V, 277V
	03.0707	23°	Johnny 80 Square Trimmed 1L, 6.2W, 560lm, 2700K, CRI 90	<div> <div>■ 14 = Black</div> <div>□ 40 = White</div> </div>	GT = Splice box, 10% Dim, ELV, 120V UL = Splice box, 1% Dim, 1-10V, 120V 7U = Splice box, 1% Dim, 1-10V, 277V
	03.0706	23°	Johnny 80 Square Trimmed 1L, 6.2W, 600lm, 3000K, CRI 90	<div> <div>■ 14 = Black</div> <div>□ 40 = White</div> </div>	GT = Splice box, 10% Dim, ELV, 120V UL = Splice box, 1% Dim, 1-10V, 120V 7U = Splice box, 1% Dim, 1-10V, 277V
	03.0711	33°	Johnny 80 Square Trimmed 1L, 6.2W, 560lm, 2700K, CRI 90	<div> <div>■ 14 = Black</div> <div>□ 40 = White</div> </div>	GT = Splice box, 10% Dim, ELV, 120V UL = Splice box, 1% Dim, 1-10V, 120V 7U = Splice box, 1% Dim, 1-10V, 277V
	03.0710	33°	Johnny 80 Square Trimmed 1L, 6.2W, 600lm, 3000K, CRI 90	<div> <div>■ 14 = Black</div> <div>□ 40 = White</div> </div>	GT = Splice box, 10% Dim, ELV, 120V UL = Splice box, 1% Dim, 1-10V, 120V 7U = Splice box, 1% Dim, 1-10V, 277V

Johnny 80 (3.2") 1L Square

Ceiling Recessed Trimmed Spot

Optional Accesories

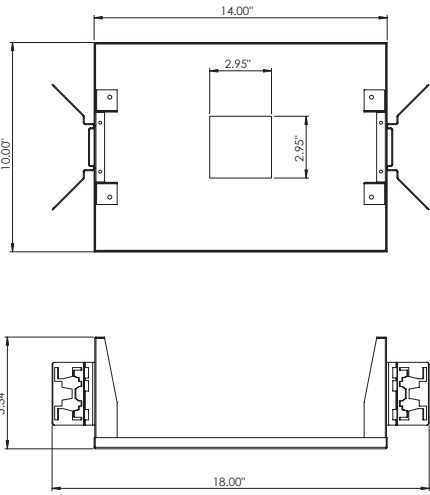
Image	QTY	Item Number	Description
		TRAY-0002	Registration Tray -non electrical, place holder for non IC new construction, 2.95 x 2.95"