



BF Series LED Beacons

Protecting you and your investment





BF Series LED Beacons

High intensity LED beacons designed in Australia to suit Australian conditions

Roads, highways, construction sites, and mines are all dangerous places to be. And the people exposed to these environments all have friends and family who care about them dearly. It's our mission to make sure they return home from work and travel safe and sound, day after day, year after year.

So it's little surprise that we utilise the latest state-of-the-art technology, the highest quality components and materials, and invest extra time and care researching, designing and testing all of our products. Products that are the brightest in their class, products that will last without fail through the tough conditions that Australia is renowned for. Products that give you confidence that they are keeping you and your loved ones safe, time and time again.

The BF Series represents a new generation of LED beacons, twin beacons, lightbars and microbars.



Constructed from premium materials including die-cast alloy, polycarbonate, ABS, and stainless steel, BF Series beacons are designed for durability, class-leading heat management, and intense light output for maximum conspicuity.

The latest in powerful high-output LEDs, intelligent heat sinking and thermal management, plus advanced computer designed lens optics, all work together to keep everyone safe while letting you focus on getting your work done.

Ranging from 700 lumen to 6800 lumen, there's a shape, size, and output to suit virtually any application. Many products in the BF Series range come with the highest possible EMC ratings and are SAE Class 1 certified by accredited labs. All BF Series beacons are IP67 rated against dust and moisture, plus come standard with a three-year warranty.



Created by a market leader in emergency lighting

ESG (ECCO Safety Group) Asia Pacific is an Australian market leader in emergency services safety equipment.

ESG Asia Pacific supplies over 85% of Australia's Police, Fire, and Ambulance fleets with emergency systems including lightbars, beacons, sirens, emergency lighting, and more. ESG Asia Pacific is also part of the ECCO Safety Group which globally serves more than 3,000 OEM and aftermarket customers.

ESG has been operating in Australia for over twenty years. Our local team knows what it takes to make a beacon range that can cope with the harsh conditions of this country, while still providing a tonne of features, outstanding light output, and great value for money.

Along with the Britax brand, ESG also distributes other well-known automotive brands including Code 3, ECCO, Cole Hersee, and Xray Vision.



Designed, built and tested to the highest standards

Protect yourself and your investment with the Britax BF Series' uncompromising levels of certified safety: including powerful light signal output and demonstrated reliability.

The Britax BF Series LED Beacon range has undergone a series of tests and certifications by accredited laboratories. This ensures that the BF beacon you install on your vehicle or machinery will not only be bright enough to protect you and your investment, but will also

stand the test of time against vibration, moisture, dust, corrosion, and even electrostatic discharge! Below are the different standards and ratings that the various beacons in the BF Series range have been tested to and certified; in many cases far exceeding the minimum requirement.



Britax Beacons featuring this icon fully comply with all SAE Class 1 standards:

- Mechanical: SAE J575**
 - Vibration
 - Moisture
 - Dust
 - Corrosion
 - Warpage
- Colour: SAE J578**
 - Amber beacon
- Photometry: SAE J845**
 - Photometric classifications (amber and clear lens)
 - Flash rate
- Environment: SAE J845**
 - High temperature +50°C
 - Low temperature -30°C
 - Durability

SAE Class 1 is the highest possible standard for omnidirectional emergency warning lighting, but it's more than just light output. The beacons are subjected to intensive colour and photometric testing as part

of the standard, however crucially, a beacon does not pass unless it ALSO passes a series of mechanical and environmental tests as well. Only when it passes ALL the various testing is it then certified as SAE Class 1.



Britax Beacons featuring this icon fully comply with ECE Reg 65

ECE Reg 65 is a European standard that covers labelling, light output (intensity and dispersion), flash rate, and colour for beacons, lightbars and directional warning lights. Reg 65 also takes into account durability during normal conditions of use, water resistance, and operation in temperatures between -20°C and +50°C.



Britax Beacons featuring this ISO13766 icon comply fully with the EMC standards:

- EMC: ISO13766**
 - Broad band electromagnetic emissions 30Mhz-1Ghz
 - Narrow band electromagnetic emissions 30Mhz-1Ghz
- Electrostatic discharge (ESD) ISO10605
 - Emission of conducted disturbances ISO 7637-2
 - Immunity of ESA to electromagnetic radiation ISO11452-4 and ISO11452-2

EMC ISO13766 is the highest possible standard for electromagnetic emissions, electromagnetic radiation, and protection against electrostatic discharges.

This standard is now the minimum requirement used by many heavy machinery manufacturers (including Komatsu) when producing and testing new machines.



Britax Beacons featuring this icon comply fully with ECE R10

ECE R10 is a European standard for automotive electronics that covers a variety of testing including RF immunity and emissions, plus transient immunity and emissions. The standard also covers a requirement for burst, surge, harmonics, and flicker. In addition to this it has requirements for electrical vehicles.



Beacons in the Britax BF Series featuring this icon are IP67 rated

This means they are totally protected against dust ingress and protected against liquid immersion between 15 centimetres and 1 metre.



All beacons in the Britax BF Series are covered by a three-year warranty

We are so confident in the durability of the Britax BF Series of LED beacons we have put a three-year warranty on the entire range!

BF900 LED Beacon

3400 Lumen Solid-state LED Beacon with Die-cast Alloy Base SAE J845 Class 1



BF600 LED Beacon

2500 Lumen Solid-state LED Beacon with Die-cast Alloy Base SAE J845 Class 1



BF300 LED Beacon

1100 Lumen Solid-state LED Beacon with Die-cast Alloy Base SAE J845 Class 1



BF180 LED Beacon

700 Lumen Solid-state LED Beacon with Durable Black ABS Base



BF620 LED Twin Beacon

5000 Lumen Die-cast Alloy Base with Twin SAE J845 Class 1 Beacons



BF700 LED Microbar

Amber Solid-state LED Microbar with 360° High Intensity Output



BF400 LED Microbar

Amber Solid-state LED Microbar with 360° High Intensity Output





BF900 LED Beacon

3400 Lumen Solid-state LED Beacon with Heavy Duty Die-cast Alloy Base SAE J845 Class 1



Design Features

- Seven selectable flash patterns including simulated rotate: internal selection of single flash (two speeds), double flash, quadruple flash, and simulated rotation at 150rpm and 210rpm to suit most applications; an auto/random function is also built-in
- BF900 Series bolt base version also features three user configurable preset flash patterns that can be selected via a remote wired switch (not included), 30% dimmable mode for night use (user selectable) and synchronisation with multiple additional BF900 Series beacons
- High-optic lens with sixteen LEDs: advanced lens with internal optics (smooth exterior) improves the visibility of the sixteen LEDs while a lens top shield significantly increases daytime effective intensity, available in clear or amber coloured lens with amber LEDs
- Gasket sealed polycarbonate lens and gel-filled die-cast alloy base: no moving parts makes this beacon very robust with high dust, moisture and vibration resistance; the die-cast alloy base makes it suited to the toughest of applications, IP67
- Three hole mount with rubber gasket: bottom or side cable entry allows for different mounting options whilst providing vibration resistance, features three-hole ISO footprint
- SAE J845 Class 1 beacon, EMC: ISO 13766 with ESD protection
- Bolt base version feature three hole mount with stainless steel fittings and nyloc nuts
- Suction magnetic base version features combination cigarette lighter and accessory (merit) plug

Specifications

- Multivoltage 10–30VDC, selectable rotation speed 150 or 210 RPM
- Maximum current draw of 2.28A @ 12VDC; average current draw of 1.35A @ 12VDC
- Bolt base height 139.3mm x Ø 148.5mm; suction magnetic base height 149.3mm x Ø 165mm

Part Numbers

BF900-00	Amber LEDs, amber lens, bolt base, three hole mount, die-cast alloy
BF900-04	Amber LEDs, clear lens, bolt base, three hole mount, die-cast alloy
BF904-00	Amber LEDs, amber lens, suction magnetic base, 1–3 metre curly cord, cig and merit
BF904-04	Amber LEDs, clear lens, suction magnetic base, 1–3 metre curly cord, cig and merit

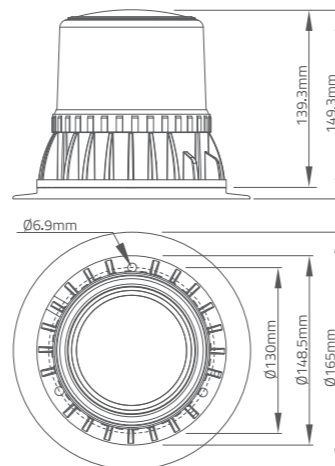

Tough polycarbonate lens

with smooth finish for increased dust resistance and low wind drag.

Internal high-optics design

directs LED intensity improving visibility over greater distances.

Lens top sunlight shield

significantly increases daytime effective intensity under the harsh Australian sunlight.

Solid aluminium core and top heatsink

provide maximum thermal management for high powered LEDs.

Chrome plated high gloss reflectors

focus LED intensity improving visibility over greater distances.

Sixteen high output LEDs

suitable for heavy duty applications.

Seven selectable flash patterns

with easy internal selection of single flash (two speeds), double flash, quadruple flash, simulated rotation (two speeds) and auto/random.

Gel-filled base gasket sealed IP67

very robust with high dust, moisture and vibration resistance.

Heavy duty die-cast alloy base

provides maximum durability and heatsinking.

Versatile mounting gasket supplied

allows for different mounting options whilst providing vibration resistance. Stainless steel corrosion resistant fitting with vibration resistant nyloc nuts.

Three user configurable preset flash patterns

that can be selected via a remote wired switch.

- Per-set flash pattern via internal set button, change via remote wired switch (BF900 Series Bolt base version only)
- Synchronise with multiple BF900 beacons (BF900 Bolt base only)
- Dip switch for simple set and forget flash pattern selection

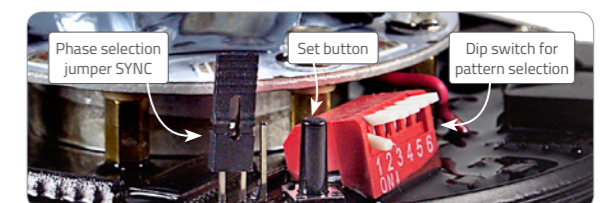

Vehicle integration capability

The user configurable flash patterns feature can be wired in to a mine site vehicle to indicate different vehicle functions.

For example, one wire could be connected to the hand break line to trigger the quad flash with another connected to the reverse light line to trigger a simulated rotate pattern.

Preset flash pattern 1: reverse light line flash pattern trigger

Preset flash pattern 2: hand break line flash pattern trigger

Preset flash pattern 3: drive gear line flash pattern trigger

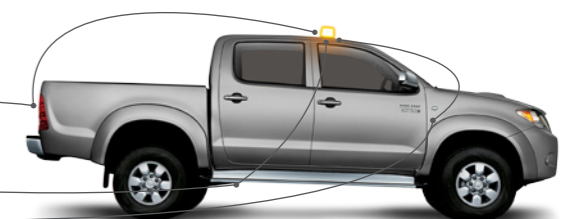



BF600 LED Beacon

2500 Lumen Solid-state LED Beacon with Die-cast Alloy Base SAE J845 Class 1



Design Features

- Four selectable flash patterns including simulated rotate: internal selection of single flash, double flash, quadruple flash and simulated rotation to suit most applications
- Duplex high-optic lens with six high output LEDs: advanced high optic lens improves the visibility of the six high output LEDs while a lens top shield significantly increases daytime effective intensity, available in clear or amber lens with amber LEDs
- O-ring sealed polycarbonate lens and gel-filled die-cast alloy base: no moving parts makes this beacon very robust with high dust, moisture and vibration resistance, IP67
- Heavy duty die-cast alloy base and heatsink for maximum durability and performance
- Bottom or side entry cable with mounting gasket: allows for different mounting options whilst keeping the underside area of the beacon sealed
- Bolt base version feature three hole mount with stainless steel fittings and nyloc nuts
- Suction magnetic base version features combination cigarette lighter and accessory (merit) plug
- Pole mount version features UV stabilised silicone, DIN pole mountable, 90° flexi base



Specifications

- Multivoltage 10–30VDC; rotation speed 130 RPM
- Maximum current draw of 2.34A @ 12VDC; average current draw of 1.4A @ 12VDC
- Bolt base height 123mm x Ø 132mm; suction magnetic base height 133mm x Ø 165mm
- Flexi pole mount base height 242mm x Ø 132mm

Part Numbers

BF600-00	Amber LEDs, amber lens, bolt base, three hole mount, die-cast alloy
BF600-04	Amber LEDs, clear lens, bolt base, three hole mount, die-cast alloy
BF604-00	Amber LEDs, amber lens, suction magnetic base, 1–3 metre curly cord, cig and merit
BF604-04	Amber LEDs, clear lens, suction magnetic base, 1–3 metre curly cord, cig and merit
BF605-00	Amber LEDs, amber lens, flexi pole mount silicone base, DIN pole suitable
BF605-04	Amber LEDs, clear lens, flexi pole mount silicone base, DIN pole suitable

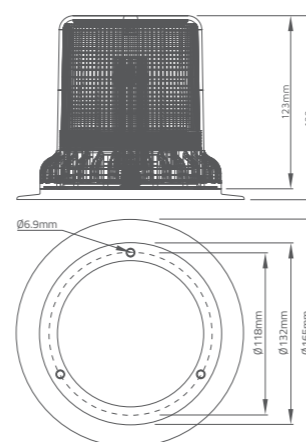

Lens top sunlight shield

significantly increases daytime effective intensity under the harsh Australian sunlight.

Tough polycarbonate external lens

with smooth finish for increased dust resistance and low wind drag.

Internal high-optics design

directs LED intensity improving vertical visibility over greater distances.

Polycarbonate internal Fresnel lens

directs LED intensity improving horizontal visibility over greater distances.

Aluminium core heatsink

provide optimum thermal management for LEDs.

Six high output LEDs

suitable for heavy duty applications.

Four selectable flash patterns

with easy internal selection of single flash, double flash, quadruple flash and simulated rotation, 130 RPM.

IP67 gel-filled base O-ring sealed

very robust with high dust, moisture and vibration resistance.

Heavy duty die-cast alloy base

provides maximum durability and heatsinking.

Rubber mounting gasket supplied

allows for different mounting options whilst keeping the underside area of the beacon sealed at all times, IP67.

Stainless steel fitting

resistant to corrosion with nyloc nuts for vibration resistance.





BF620 LED Twin Beacon

5000 Lumen Die-cast Alloy Base with
Twin SAE J845 Class 1 Beacons



The Britax BF620 Series LED twin beacons feature an aerodynamic polycarbonate lens and die-cast alloy base for superior strength and durability.

Design Features

- Strong, UV resistant, electrostatically coated black die-cast alloy base
- Die-cast alloy base works to heat sink the internal high powered twin 2500 Lumen LED beacons
- Die-cast alloy base and polycarbonate lens sealed by one piece, triple blade rubber sealing gasket providing dust, water, high pressure washing and vibration resistance
- Die-cast alloy base has multiple mounting positions, knockouts provide different options, pad provided for each knockout to help with sealing
- IP68 rated goretex breather in base with IP67 rated internal beacons, mirror in the middle
- Contains twin SAE J845 Class 1 beacons (BF600 LED beacons) with the highest EMC rating possible
- Set flash patterns by removing outer lens then BF600 lens, set as per a normal BF600
- Four selectable flash patterns with each beacon including simulated rotate: internal selection of single flash, double flash, quadruple flash and simulated rotation to suit most applications
- Beacon features duplex high optic lens with six high output LEDs: advanced high-optic lens improves the visibility of the six high output LEDs over greater distances
- LED beacons lens top shield significantly increases daytime effective intensity

Specifications

- Multivoltage 10–30VDC; rotation speed 130 RPM
- Maximum current draw of 4.68A @ 12VDC; average current draw of 2.8A @ 12VDC
- Dimensions: height 135.5mm x depth 205mm x width 420mm

Part Numbers

- | | |
|----------|--|
| BF620-00 | Amber LEDs, amber lens, bolt base, eight mounting holes, die-cast alloy base |
| BF620-04 | Amber LEDs, clear lens, bolt base, eight mounting holes, die-cast alloy base |

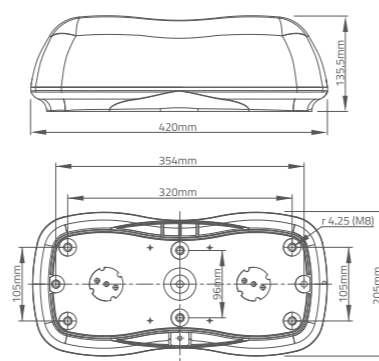

Tough aerodynamic polycarbonate lens
with smooth finish for increased dust resistance and low wind drag.

One-piece rubber triple blade sealing gasket
provides dust, water, high pressure washing and vibration resistance.



Internal high-optics design
directs LED intensity improving visibility.

Four selectable flash patterns
with each beacon including simulated rotation.

Centrally mounted mirror
with highly reflective finish improving visibility.

Twin 2500 lumen LED beacons
SAE J845 Class 1 certified, IP67 rated.



Heavy duty die-cast alloy base
provides maximum durability and heatsinking.

Multiple mounting positions
eight knockouts provide different mounting options.



BF300 LED Beacon

1100 Lumen Solid-state LED Beacon with Die-cast Alloy Base SAE J845 Class 1



Design Features

- Four selectable flash patterns including simulated rotate: internal selection of single flash, double flash, quadruple flash and simulated rotation to suit most applications
- Duplex high-optic lens with four high output LEDs: advanced high optic lens improves the visibility of the four high output LEDs while a lens top shield significantly increases daytime effective intensity, available in clear or amber lens with amber LEDs
- O-ring sealed polycarbonate lens and gel-filled die-cast alloy base: no moving parts makes this beacon very robust with high dust, moisture and vibration resistance, IP67
- Heavy duty die-cast alloy base and heatsink: provides maximum durability and performance
- Bottom or side entry cable with mounting gasket: allows for different mounting options whilst keeping the underside area of the beacon sealed
- Bolt base version feature three hole mount with stainless steel fittings and nyloc nuts
- Suction magnetic base version features combination cigarette lighter and accessory (merit) plug
- Pole mount version features UV stabilised silicone, DIN pole mountable, 90° flexi base

Specifications

- Multivoltage 10–30VDC; rotation speed 90 RPM.
- Maximum current draw of 1.3A @ 12VDC; average current draw of 0.64A @ 12VDC
- Bolt base height 123mm x Ø 132mm; suction magnetic base height 133mm x Ø 165mm
- Flexi pole mount base height 242mm x Ø 132mm

Part Numbers

BF300-00	Amber LEDs, amber lens, bolt base, three hole mount, die-cast alloy
BF300-04	Amber LEDs, clear lens, bolt base, three hole mount, die-cast alloy
BF304-00	Amber LEDs, amber lens, suction magnetic base, 1–3 metre curly cord, cig and merit
BF304-04	Amber LEDs, clear lens, suction magnetic base, 1–3 metre curly cord, cig and merit
BF305-00	Amber LEDs, amber lens, flexi pole mount silicone base, DIN pole suitable
BF305-04	Amber LEDs, clear lens, flexi pole mount silicone base, DIN pole suitable

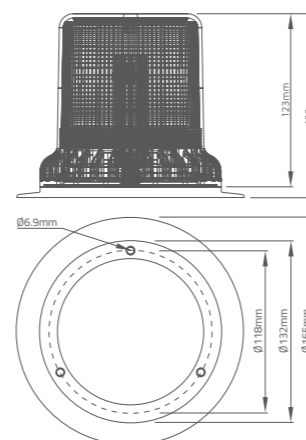

Lens top sunlight shield

significantly increases daytime effective intensity under the harsh Australian sunlight.

Tough polycarbonate external lens

with smooth finish for increased dust resistance and low wind drag.

Internal high-optics design

directs LED intensity improving vertical visibility over greater distances.

Polycarbonate internal Fresnel lens

directs LED intensity improving horizontal visibility over greater distances.

Aluminium core heatsink

provide optimum thermal management for LEDs.

Four high output LEDs

suitable for heavy duty applications.

Four selectable flash patterns

with easy internal selection of single flash, double flash, quadruple flash and simulated rotation, 90 RPM.

IP67 gel-filled base O-ring sealed

very robust with high dust, moisture and vibration resistance.

Heavy duty die-cast alloy base

provides maximum durability and heatsinking.

Rubber mounting gasket supplied

allows for different mounting options whilst keeping the underside area of the beacon sealed at all times, IP67.

Stainless steel fitting

resistant to corrosion with nyloc nuts for vibration resistance.





BF180 LED Beacon

700 Lumen Solid-state LED Beacon
with Durable Gel-filled ABS Base



Design Features

- Four selectable flash patterns including simulated rotate: internal selection of single flash, double flash, quadruple flash and simulated rotation to suit most applications
- Duplex high-optic lens with three high output LEDs: advanced high optic lens improves the visibility of the high output LEDs while a lens top shield significantly increases daytime effective intensity, available in clear or amber lens with amber LEDs
- O-ring sealed polycarbonate lens and gel-filled ABS base: no moving parts makes this beacon very robust with high dust, moisture and vibration resistance, IP67
- Durable black ABS base: internal alloy heatsink for maximum durability and performance
- Bottom or side entry cable with mounting gasket: allows for different mounting options whilst keeping the underside area of the beacon sealed
- Bolt base version feature three hole mount with stainless steel fittings and nyloc nuts
- Suction magnetic base version features combination cigarette lighter and accessory (merit) plug
- Pole mount version features UV stabilised silicone, DIN pole mountable, 90° flexi base

Specifications

- Multivoltage 10–30VDC; rotation speed 90 RPM
- Maximum current draw of 0.65A @ 12VDC; average current draw of 0.4A @ 12VDC
- Bolt base height 120mm x Ø 128mm; suction magnetic base height 131mm x Ø 165mm
- Flexi pole mount base height 240mm x Ø 128mm

Part Numbers

BF180-00	Amber LEDs, amber lens, bolt base, three hole mount, black ABS plastic
BF180-04	Amber LEDs, clear lens, bolt base, three hole mount, black ABS plastic
BF184-00	Amber LEDs, amber lens, suction magnetic base, 1–3 metre curly cord, cig and merit
BF184-04	Amber LEDs, clear lens, suction magnetic base, 1–3 metre curly cord, cig and merit
BF185-00	Amber LEDs, amber lens, flexi pole mount silicone base, DIN pole suitable
BF185-04	Amber LEDs, clear lens, flexi pole mount silicone base, DIN pole suitable

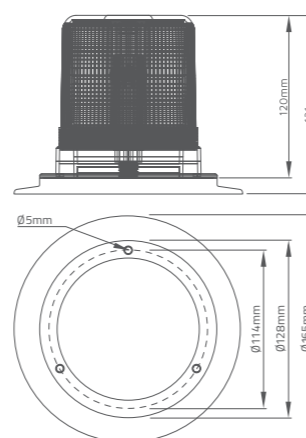

Lens top sunlight shield

significantly increases daytime effective intensity under the harsh Australian sunlight.

Tough polycarbonate external lens

with smooth finish for increased dust resistance and low wind drag.

Internal high-optics design

directs LED intensity improving vertical visibility over greater distances.

Polycarbonate internal Fresnel lens

directs LED intensity improving horizontal visibility over greater distances.

Aluminium core heatsink

provide optimum thermal management for LEDs.

Three high output LEDs

suitable for industrial applications.

Four selectable flash patterns

with easy internal selection of single flash, double flash, quadruple flash and simulated rotation, 90 RPM.

IP67 gel-filled base O-ring sealed

high dust, moisture and vibration resistance.

Durable ABS plastic base

light weight with internal alloy heatsink.

Versatile mounting gasket supplied

allows for different mounting options whilst keeping the underside area of the beacon sealed at all times, IP67.

Stainless steel fitting

resistant to corrosion with nyloc nuts for vibration resistance.

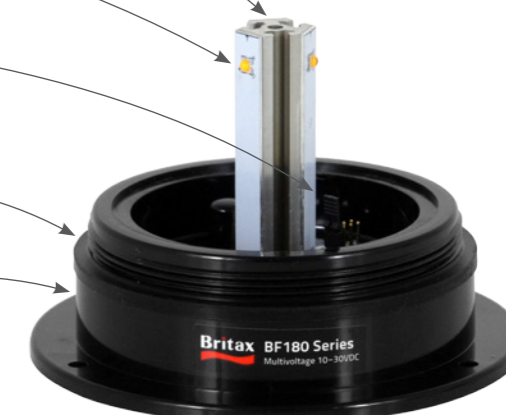



BF700 LED Microbar

Amber Solid-state LED Microbar
with 360° High Intensity Output



The Britax microbar is the lowest profile minibar currently on the market. The compact size allows for easy storage in any vehicle. The microbar provides 360° output exceeding SAE Class 1 standards, making it ideal for trucks, utility and construction vehicles.

Design Features

- 23 built-in selectable flash patterns
- 30 x 1W high intensity, solid-state LEDs
- LEDs rated to 100,000 hours of operation
- Low power function for night time use
- Available in permanent or magnetic mount base
- Dust, water and vibration resistant
- Reverse polarity protected
- Multiple units can be synchronised

Specifications

- Multivoltage: 12–24VDC
- Maximum current draw: 5A @ 12VDC, 2.5A @ 24VDC
- Average current draw: 2.5A @ 12VDC, 1.25A @ 24VDC
- Dimensions: height 37mm x depth 172mm x width 248mm

Part Numbers

BF700-00	Amber LEDs, amber lens, bolt mount
BF700-04	Amber LEDs, clear lens, bolt mount
BF700-05	Amber and green LEDs, clear lens, bolt mount
BF704-00	Amber LEDs, amber lens, magnetic mount
BF704-04	Amber LEDs, clear lens, magnetic mount
BF704-05	Amber and green LEDs, clear lens, magnetic mount

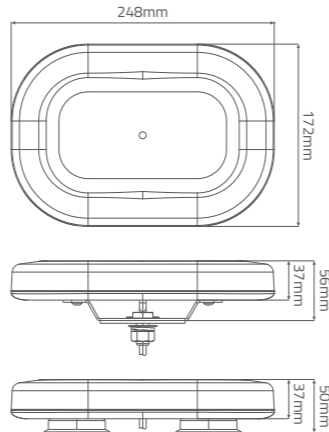

Lens top sunlight shield
significantly increases daytime effective
intensity under the harsh Australian sunlight.

Tough polycarbonate lens
with smooth finish for increased dust resistance and low wind drag.

30 x 1W solid-state LEDs
provide 360° high intensity light output
exceeding SAE Class 1 standards.

Durable ABS O-ring sealed
base provides dust, water and vibration resistance.

23 built-in flash patterns
selectable by momentary switch to blue wire
or button on cigarette plug.

Permanent bolt mount version
Supplied with BF700-00, BF700-04, BF700-05.
Available as a spare part: BF700-MOUNT
Four bolt mount: BF700-MOUNT-4

Suction magnetic mount version
Supplied with BF704-00, BF704-04, BF704-05.





BF400 LED Microbar

Amber Solid-state LED Microbar
with 360° High Intensity Output



BF400 Series LED Microbars provide a compact yet powerful warning solution that offers the flexibility of either permanent or magnetic mounting. The BF400 Series is low profile, uses low maintenance LED technology to maximize light output, and offers multiple user selectable flash patterns.

Design Features

- 20 built-in selectable flash patterns
- 40 x 1W high intensity, solid-state LEDs
- Polycarbonate lens and body
- Dust, water and vibration resistant
- Reverse polarity protected
- Available in single bolt permanent mount
- Available in magnetic mount base
- Magnetic base versions come with lighter plug that includes on/off switch and flash pattern selector
- Approvals: SAE J845 Class I, Reg 65, R10, IP67

Specifications

- Multivoltage: 12–24VDC
- Maximum current draw: 3.3A @ 12VDC, 1.8A @ 24VDC
- Average current draw: 3A @ 12VDC, 1.65A @ 24VDC
- Dimensions: height 56mm (bolt), 49mm (mag) x depth 170mm x width 251mm

Part Numbers

- BF400-04** Amber LEDs, clear lens, amber top, single bolt mount
BF404-04 Amber LEDs, clear lens, amber top, magnetic mount

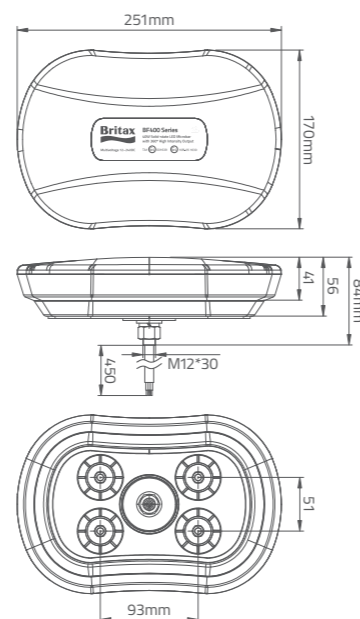

Tough polycarbonate lens
with solid amber finish significantly increases daytime effective intensity.

40 x 1W solid-state LEDs
provide 360° high intensity light output.

Completely sealed lens and base
provides dust, water and vibration resistance, IP67. Breather in-built.

20 built-in flash patterns
user selectable including single, double, quad and rotate.

Single bolt mount version
Single bolt base supplied with BF400-04

Magnetic mount version
Four magnetic mounting feet supplied with BF404-04





Quartz Halogen Beacons

The Britax quartz halogen range of rotating beacons are classic in design and function providing excellent visibility and long lasting construction. Beacon lenses are all made from impact resistant polycarbonate that also provide remarkable colour intensity. The 12 and 24 volt versions are designed to be interchangeable between different vehicles: simply change the globe and move the drive belt and the beacon is converted. Most beacons also feature belt drive for quiet, reliable operation. Some of the heavy duty models feature gear drive for extra resistance against the elements.

Britax reflectors are vacuum metallised to provide a flawless reflective surface. The reflectors are also computer optimised to create the best possible beam pattern for maximum visibility. Different beacons across the range are available with various mounting including bolt mount, pole mount and magnetic base. All beacons are RFI radio frequency interference suppressed to provide conflict-free operation with multiple electronic devices. For more information visit www.britaxbeacons.com.au.



420 Twin QH Beacon

Twin Quartz Halogen Rotators
with Polycarbonate Lens and ABS Base



- Aerodynamically designed tough polycarbonate lens and black ABS body
- Twin rotator with flat mirror, Globes fitted specific to voltage
- Single or multiple bolt mounting on Bolt base version
- 12V or 24V models, Flash rate nominal 160
- 9.2 Amp draw at 12V, 4.6 Amp draw at 24V
- Bolt base Height 133mm x Depth 205mm x Width 420mm
- Suction Magnetic base Height 170mm x Depth 205mm x Width 460mm

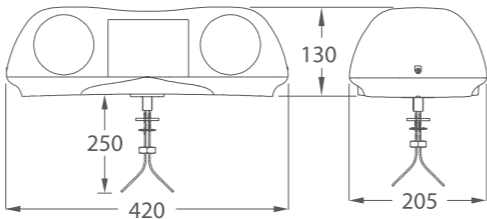

420-00-12V Bolt base, amber Lens 420 minibar 12V Globes, **420-00-24V**, 24V Globes
424-00-12V Suc/Mag, amber lens cigarette plug, 3M cord 12V Globes, **424-00-24V**, 24V Globes

About ESG Asia Pacific

ESG Asia Pacific is an Australian market leader in lighting and safety equipment.

ESG Asia Pacific manufactures and distributes a wide range of automotive products under its four internationally recognised brand names, all of which are synonymous with high quality and performance. ESG Asia Pacific is also the official Australian distributor for Cole Hersee and Kustom Signals.





Brands in the ESG Asia Pacific division include ECCO, Britax, Code 3, Cole Hersee, GE and Xray Vision.

For more information visit www.eccoescg.com/au/en



Spares and accessories

Britax BF Series beacon spares		
Lenses	Amber	Clear
BF620	10510-00	10510-04
BF900	BF900A	BF900C
BF600 BF300 BF180	BF180A	BF180C

Britax DIN Poles to suit flexi-pole mount beacons				
Tube	Single bolt	Side pivot	Side bracket	Two bolt
13109	13109-20	13109-25	13109-30	13109-40
				



ESG Asia Pacific
Freecall 1800 025 921
www.eccoesg.com/au/en

Britax is the registered trademark of, and is used under licence from, a member of the Britax group of companies.