



مدينة إكسبو دبي  
EXPO CITY DUBAI

# EVENT SPACES

Extraordinary venues for  
extraordinary events

V3. Jan 2025

# EXPO CITY DUBAI

## A world-class destination for events and experiences

A visionary city has arrived.

A curated ecosystem for living, leisure and business.

A place where green spaces combine with cutting-edge technologies, where people connect to build a brighter tomorrow.

Within this integrated community, located at the centre of Dubai's future and with the world-class Dubai Exhibition Centre at its doorstep, you'll discover inspiring cultural and educational experiences, leisure facilities, dining options, exercise grounds, retail outlets, parks, playgrounds and much more.

Expo City is an ideal destination for your next event, the perfect host of conferences, exhibitions, concerts and ceremonies, workshops, seminars and product launches, as well as weddings, gala dinners, sports events and celebrations.

More than 30 extraordinary indoor and outdoor spaces are available to hire, from a meeting room or intimate outdoor stage to a large-scale festival or ceremony at Al Wasl Plaza.

Find out more here, or contact [events@expocitydubai.ae](mailto:events@expocitydubai.ae) for enquiries and bookings.

Live for today while looking to the future – only at Expo City Dubai.



# TABLE OF CONTENTS

<b>Map of Dubai</b>	<b>4</b>	Nexus Green Room	36
<b>Expo City Dubai venues</b>	<b>5</b>	Nexus Garden Terrace	37
<b>Al Wasl Plaza</b>	<b>6</b>	Nexus Sunset Terrace	38
Al Wasl Plaza	7	<b>Women's Pavilion</b>	<b>39</b>
Pearl Terrace	8	Women's Pavilion Majlis	40
Al Wasl Spaces	9	Women's Pavilion Multi-Purpose Room	41
<b>Surreal</b>	<b>10</b>	<b>Client Relations Centre</b>	<b>42</b>
Surreal	11	Client Relations Centre	43
<b>Alif</b>	<b>12</b>	<b>Future Forward Business Hub</b>	<b>44</b>
Alif Living Lab	13	Future Forward Business Hub	45
Alif The Bowl	14	<b>Firdaus Studio</b>	<b>46</b>
Alif North Space	15	Scoring Stage	47
<b>Terra</b>	<b>16</b>	Terrace	48
Terra Auditorium	17	<b>Parks &amp; Public Realm</b>	<b>49</b>
Terra Dugong / Oryx	18	Al Forsan Park	50
Terra Terrace	19	Dubai Millennium Amphitheatre	51
Terra Wadi Circle	20	Jubilee Park	52
Terra Rooftop	21	Expo City Arena	53
Terra Taqa Island	22	Garden in The Sky	54
Terra Learning Lab	23	Sustainability Gate	55
Terra Wonder Lab	24	<b>Dubai Exhibition Centre (DEC)</b>	<b>56</b>
<b>Connect Conference Centre</b>	<b>25</b>	<b>Additional Services</b>	<b>57</b>
C3 Plaza	26	Catering	58
C3 Forum	27	Accommodation	59
C3 Auditorium	28	Furniture, fixtures and fittings	60
C3 Hall	29	Technical Services	61
C3 Lounge	30	Accessibility	62
<b>Nexus</b>	<b>31</b>		
Nexus Hub	32		
Nexus Conference Room	33		
Nexus Leaders Lounge	34		
Nexus Event Lounge	35		



# MAP OF DUBAI

Expo City Dubai is conveniently located within easy reach of Al Maktoum, Dubai and Abu Dhabi international airports and is connected by metro and major highways to Dubai Marina, Palm Jumeirah and Al Barsha.



# EXPO CITY DUBAI VENUES

- 1 Al Wasl Plaza
- 2 Surreal
- 3 Alif
- 4 Terra
- 5 Connect Conference Centre
- 6 Nexus
- 7 Women's Pavilion
- 8 Client Relations Centre
- 9 Future Forward Business Hub
- 10 Firdaus Studio
- 11 Al Forsan Park
- 12 Dubai Millennium Amphitheatre
- 13 Jubilee Park
- 14 Expo City Arena
- 15 Garden in the Sky
- 16 Sustainability Gate
- 17 Dubai Exhibition Centre

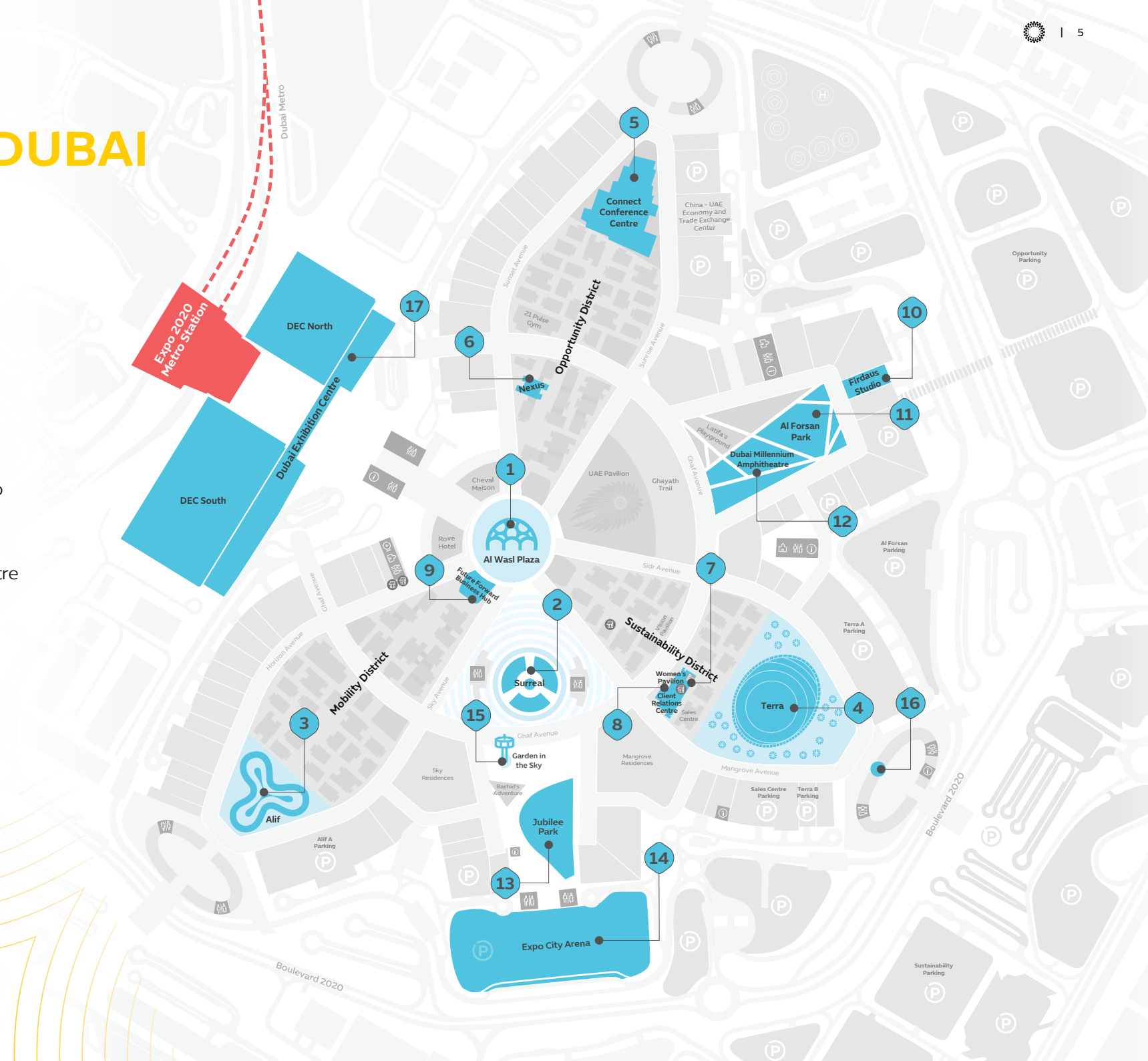

## AL WASL PLAZA

The beating heart of Expo City Dubai, Al Wasl Plaza proudly carries the old name of Dubai, reflecting the area's heritage as a central meeting point that physically and emotionally connects everyone who visits our city.

A shaded, tranquil garden by day, at night Al Wasl transforms into a place for celebration, with its stunning 360-degree projection dome – holder of the Guinness World Record™ for the largest interactive immersive dome – offering a unique venue for multi-sensory shows and performances.





# AL WASL PLAZA

Outdoor circular stage and multi-purpose venue



## Capacity

- 750 seated (banquet style)
- 820 seated (theatre style)
- 1,000 standing (cocktail style)
- 3,000 standing



## Event types

- Performances & concerts
- Celebrations & ceremonies
- Multi-sensory shows
- Gala dinners



## Features

- Stage performance area: 16m
- Dome width: 130m
- Dome height: 67.5m
- Dome total weight: 2,544 tonnes



## Tech specs

- 252 projectors housed in 42 air-conditioned pods projecting on 585 fabric screens
- 27K project resolution
- 251 billion pixels
- 27 immersive audio arrays within a distributed sub bass system featuring 789 loudspeakers and fully integrated audio playback
- 700 lighting fixtures including 28,000 RGB garden pixels



# PEARL TERRACE

Outdoor multi-purpose venue



## Capacity

- 65 seated



## Event types

- Performances
- Talks
- Majlis
- Workshops



## Features

- Amazing AI Wasl projection can support the event



## Tech specs

- Additional tech specifications available on request

- Moonrise Fountain Area
- Sunrise Fountain Area
- Welcome Fountain Area
- Pearl Terrace





# AL WASL SPACES

Al Wasl Plaza is home to a number of intimate spaces, offering beautiful locations for smaller events under the dome.



### Capacity

- 80 seated
- 200 standing



### Event types

- Performances
- Talks
- Workshops



### Features

- Amazing Al Wasl projection can support the event



### Tech specs

- Additional tech specifications available on request

- Moonrise Fountain Area
- Sunrise Fountain Area
- Welcome Fountain Area
- Pearl Terrace

# SURREAL

Expo City Dubai's beautiful water feature is a vibrant, energetic space offering a larger-than-life immersive venue for your event.





# SURREAL

Outdoor circular multi-purpose venue



## Capacity

- 350 seated (banquet style)
- 400 standing (cocktail style)
- 1,000 standing



## Event types

- Performances
- Dinners
- Celebrations



## Features

- Width: 40m
- Height: 18m
- Central spiral sculpture

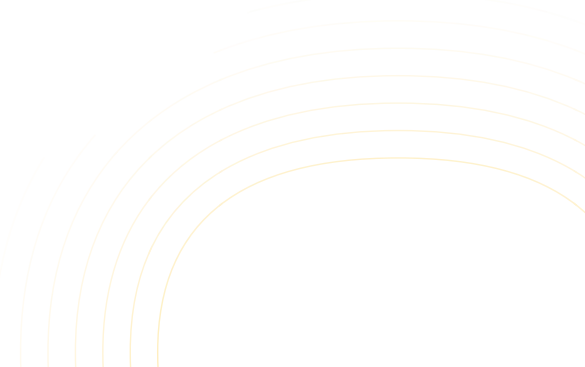

# ALIF

Alif sparks excitement and curiosity about innovation and the future, transporting explorers through time and across new horizons to discover how mobility has driven human progress and enabled us to break new frontiers. What better place to host your inspiring, forward-thinking event?





# ALIF LIVING LAB

Multi-purpose venue

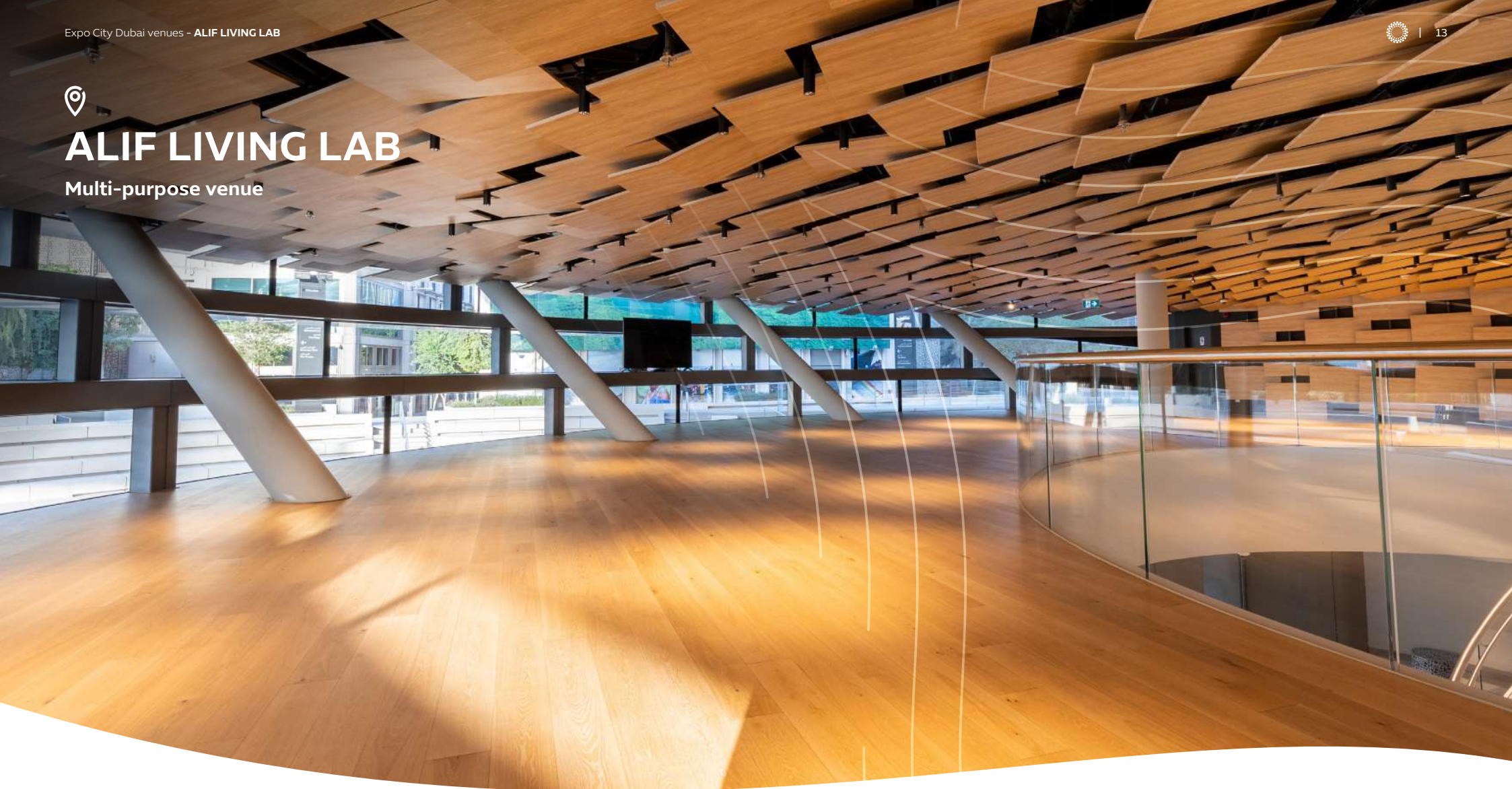

## Capacity

• 100



## Event types

- Conventions
- Workshops
- Gala dinners
- Galleries
- Product launches
- Team building



## Features

- Indoor
- Fit for different layouts



## Tech specs

- Elevator
- 2 x speakers
- 3 x 75" TVs
- 2 microphones



# ALIF THE BOWL

Outdoor amphitheatre-shaped multi-purpose venue



## Capacity

- 500



## Event types

- Entertainment
- Panels
- Workshops
- Product launches
- Graduations



## Features

- Shaded, ambient temperature morning and evening
- Events visible to public as they enter/exit pavilion
- Tensa barriers
- Outdoor accessibility



## Tech specs

- 4 x 380 industrial load power outlets
- 350 kg per sqm maximum weight load capacity



# ALIF NORTH SPACE

Outdoor multi-purpose venue



## Capacity

• 100



## Event types

- Markets
- Sports events
- Entertainment
- Performances
- Product launches
- Car shows



## Features

- Outdoor accessibility
- Some noise disruption as venue is outdoors



## Tech specs

- 2 x 13 amps power available

# TERRA

A one-of-a-kind venue and an architectural marvel, Terra is a stunning building – both inside and out. Designed to be net zero for both energy and water, it epitomises best practice in sustainable design and is an inspirational, versatile venue for your next event.







# TERRA AUDITORIUM

Indoor auditorium with semi-circular stage



## Capacity

• 130



## Event types

- Conferences
- Panels
- Training
- Galleries
- Product launches
- Graduations



## Features

- Semi-circular stage 12m x 6.5m
- Elevator
- Additional breakout function space available



## Tech specs

- 6 power sockets
- Basic sound, lights and video system
- Large format front projection screen
- Backstage 'green room'
- 2 furnished dressing rooms each with private bathroom



# TERRA DUGONG / ORYX

Indoor meeting rooms



## Capacity

- 20 per meeting room



## Event types

- Meetings
- Training
- Workshops



## Features

- Rectangular room 110sqm
- Divisible into 2 meeting rooms, each of 20 capacity
- Breakout venue available outside



## Tech specs

- Conference speaker system with overhead room audio and table-mounted microphones
- 13 amp table sockets
- 2 x 65" LCD screens, connectable to Teams/Webex



# TERRA TERRACE

Outdoor multi-purpose venue

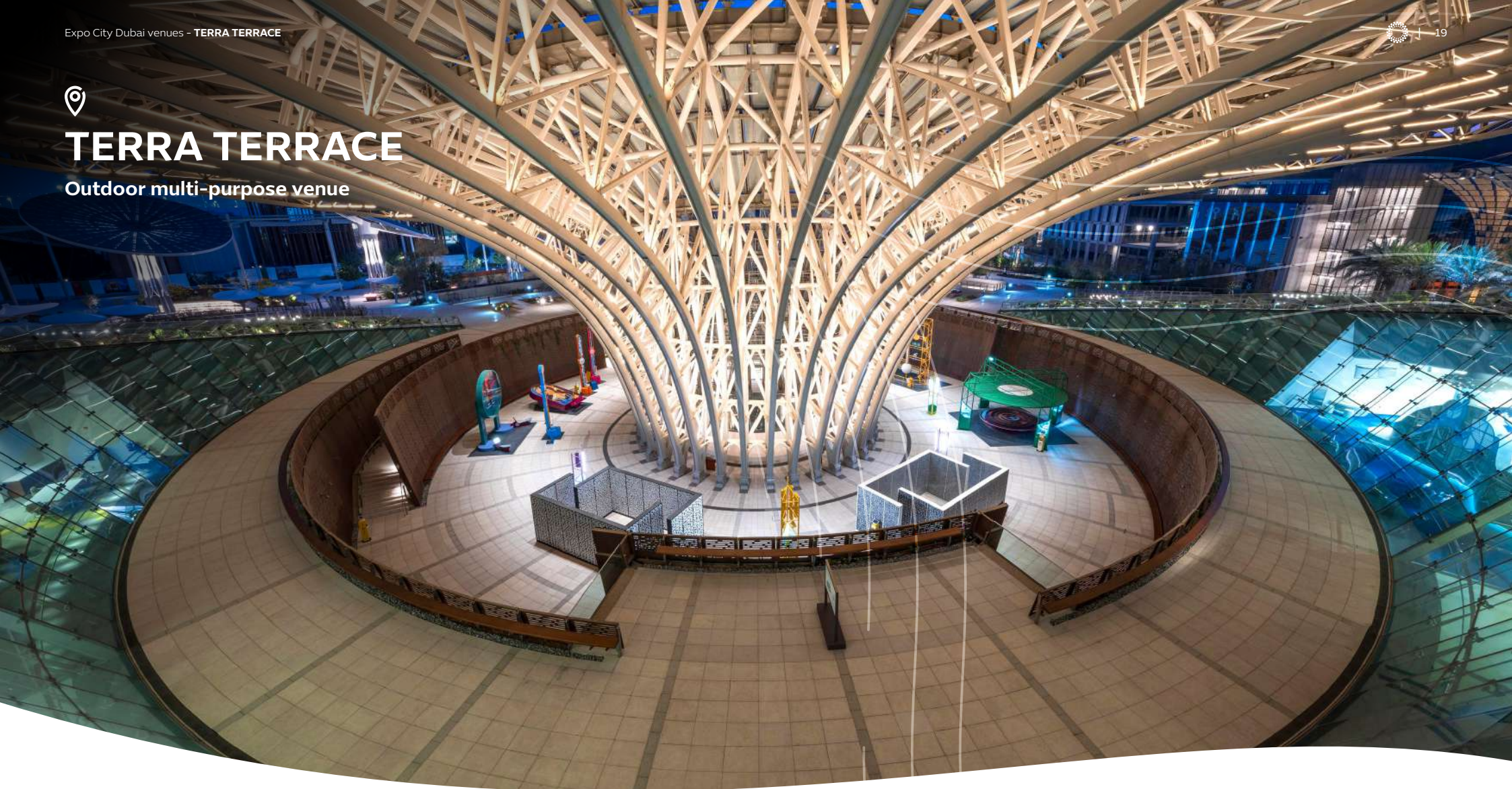

## Capacity

• 275



## Event types

- Gala dinners
- Networking
- Product launches
- Exhibitions
- Performances
- Markets



## Features

- Outdoor sheltered by Terra canopy
- Mix of paved and landscaped area



## Tech specs

- 13 amp sockets available



# TERRA WADI CIRCLE

Outdoor amphitheatre-style multi-purpose venue



## Capacity

• 85



## Event types

- Networking
- Performances
- Product launches
- Galleries



## Features

- Amphitheatre seating of 85sqm
- Some noise disruption as venue is outdoors



## Tech specs

- 13 amp sockets available in Energy Trees

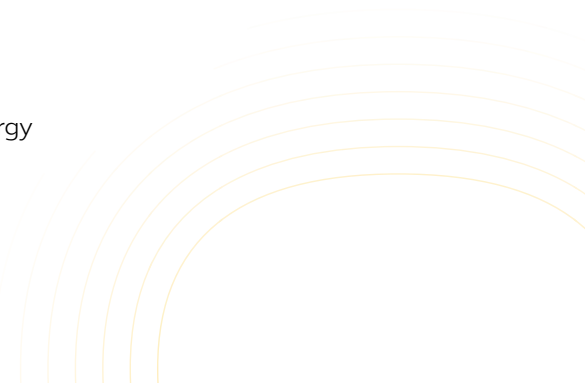



# TERRA ROOFTOP

Outdoor terrace

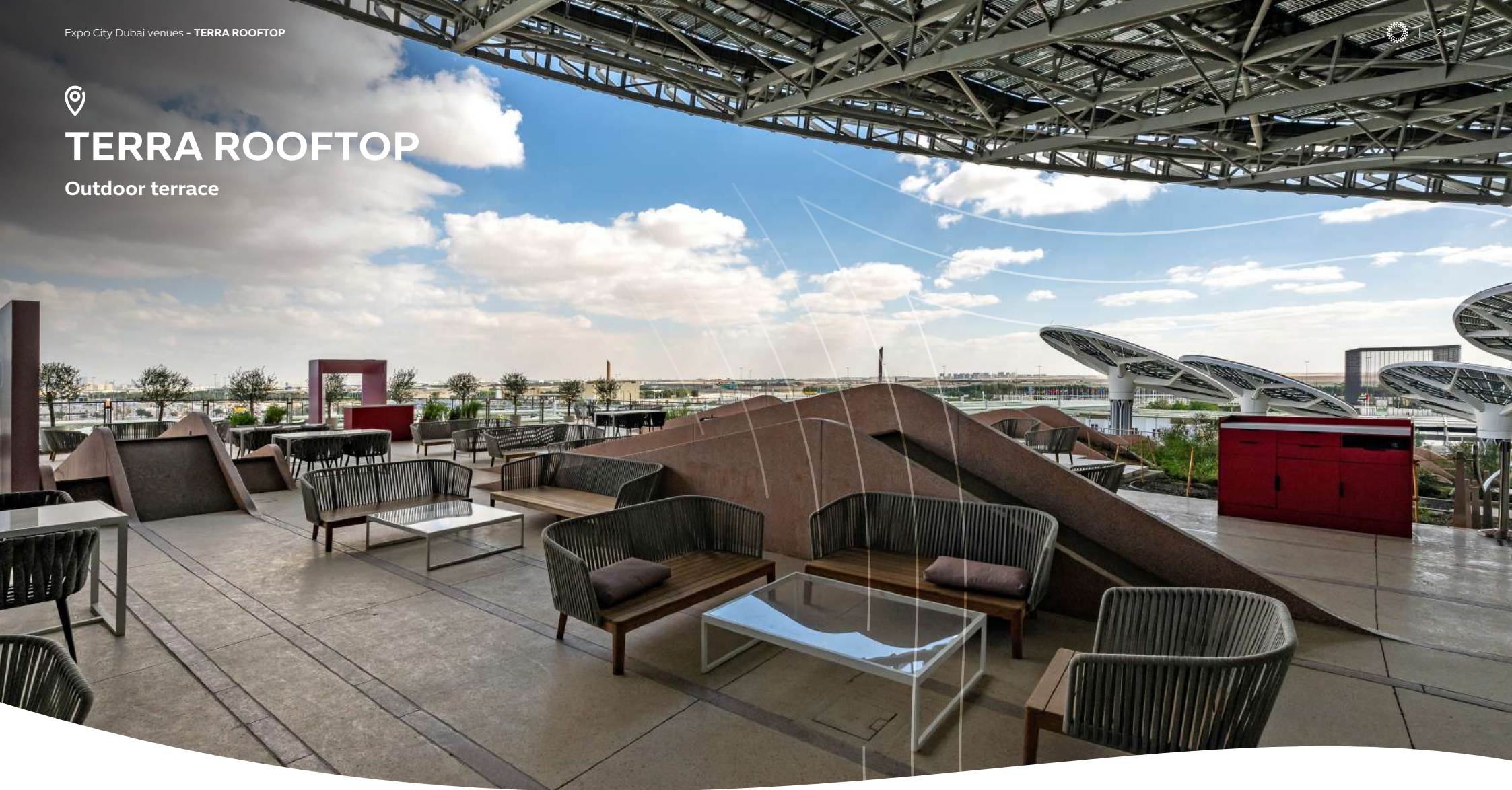

## Capacity

- 150



## Event types

- Dinners
- Networking



## Features

- Shaded by Terra canopy
- Mix of paved and landscaped area



## Tech specs

- 13 amp sockets available



# TERRA TAQA ISLAND

Indoor playground



## Capacity

• 30



## Event types

- Children's events
- Children's parties



## Features

- Pre-installed entertainment projection for children
- Suitable for ages 2-12 years, and 95-145cm



## Tech specs

- Power sockets available



# TERRA LEARNING LAB

Indoor classroom / workshop venue



## Capacity

- 40 (classroom style)
- 50 (standing)
- 70 (theatre style)



## Event types

- Workshops
- Training
- Discussions
- Cocktails
- Receptions



## Features

- Natural light
- Multi-purpose open space
- Breakout areas
- Easy access, located near the entrance



## Tech specs

- Power outlets
- 4 x 55" LED screens



# TERRA WONDER LAB

Indoor classroom / workshop venue



## Capacity

- 50 (classroom style)
- 60 (standing)
- 80 (theatre style)



## Event types

- Workshops
- Training
- Exhibitions
- Networking
- Yoga



## Features

- Natural light
- Private storage space
- Breakout areas
- F&B catering space



## Tech specs

- Power outlets
- 93" LED screen



# CONNECT CONFERENCE CENTRE

Known as C3, the Connect Conference Centre is a distinctive, adaptable space that occupies a unique position in Dubai's mid-sized venue market and can cater to a wide range of business, entertainment and community events.





# C3 PLAZA

Shaded outdoor venue

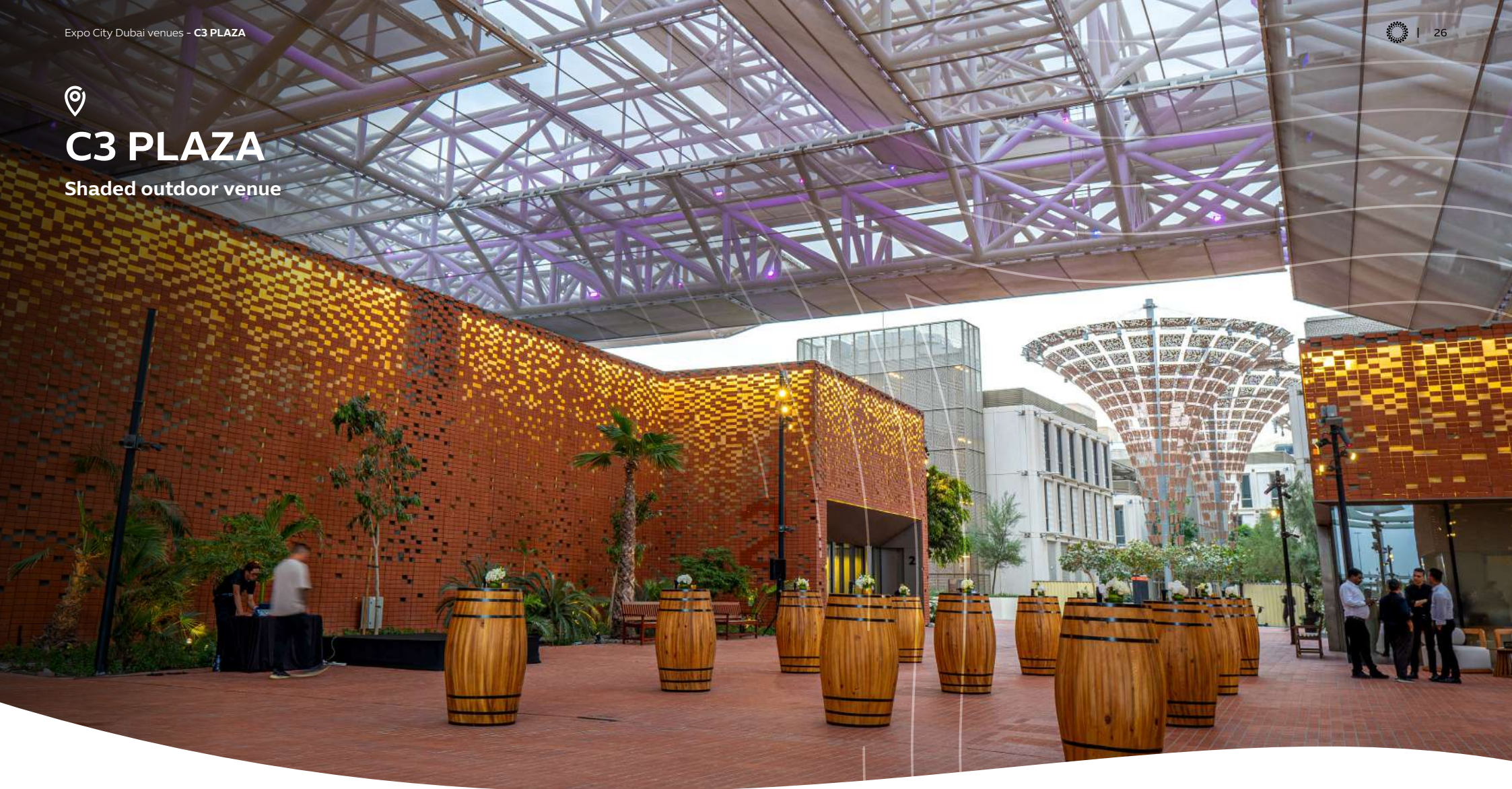

## Capacity

- 1,300 Standing



## Event types

- Gala dinners
- Product launches
- Standing receptions
- Entertainment
- Food festivals
- Weddings
- Wellbeing sessions



## Features

- 1,644 sqm
- Spacious concourse



## Tech specs

- Tech outsourced upon request



# C3 FORUM

Semi outdoor venue



## Capacity

- 140



## Event types

- Entertainment and dance performances
- Lectures
- Talks and panel discussions
- Workshops



## Features

- Acoustically designed
- 153 sqm



## Tech specs

- 4 power outlets 2 x 63 & 2 x 32 amps



# C3 AUDITORIUM

Indoor multi-purpose venue



## Capacity

- 440 Theatre
- 200 Banquet
- 160 Classroom



## Event types

- Conferences
- Seminars
- Workshops
- Training
- Product launches
- Comedy nights
- Graduations
- Performances



## Features

- Acoustically designed
- High ceiling
- Retractable seats
- 436 sqm



## Tech specs

- 3 power outlets 3 x 16 amps
- State-of-the-art AV equipment
- Built-in wide LED screen
- Live streaming capabilities
- Rigging points
- Built-in recording & broadcasting PTZ cameras
- 2 x built-in translation booths, provision for 4 x more
- Induction loop



# C3 HALL

Indoor multi-purpose venue



## Capacity

- 264 Theatre
- 200 Banquet
- 100 Classroom



## Event types

- Conferences
- Seminars
- Workshops
- Training
- Product launches
- Town halls



## Features

- Acoustically designed
- High ceiling
- Customisable space
- 266 sqm



## Tech specs

- 8 power outlets 16 amps
- State-of-the-art AV equipment
- 2 x built-in wide LED screens
- 2 x built-in screens

- with projectors
- Relaying capabilities
- Live streaming capabilities
- Rigging points
- Built-in recording & broadcasting PTZ cameras

# C3 LOUNGE

Indoor meeting room



### Capacity

• 20



### Event types

- Meetings
- Training



### Features

- Offering privacy
- Elegant interior with Majlis seating
- 61 sqm



### Tech specs

- Relaying capabilities
- Built-in speakers
- 2 x TV screens

# NEXUS

Located in the heart of the Opportunity District, Nexus aims to drive collaborative partnerships to tackle some of the greatest challenges and opportunities of our time, and offers a number of versatile venues.





# NEXUS HUB

Indoor multi-purpose venue



## Capacity

- 250



## Event types

- Conferences
- Seminars
- Workshops
- Film screenings
- Networking events



## Features

- Area: 363 sqm



## Tech specs

- 6.24m x 1.92m wall-mounted curved LED screen
- 2 ceiling-mounted PTZ cameras
- Backstage AV equipment
- Front-of-house AV equipment including mics, headsets and lighting controller





# NEXUS CONFERENCE ROOM

Indoor conference room



## Capacity

• 10



## Event types

- Small meetings
- Brainstorming sessions
- Client presentations



## Features

- Area: 26sqm
- Conference table (6m x 1.6m)
- 10 executive chairs



## Tech specs

- 89" TV screen
- Clickshare for wireless presentation
- Video conferencing kit
- Clickshare for wireless presentation
- Wi-Fi



# NEXUS LEADERS LOUNGE

Indoor multi-purpose venue



## Capacity

• 10



## Event types

- Meetings
- Small breakout discussions
- Seminars
- Workshops
- Training
- Product launches



## Features

- Area: 32 sqm
- 10 chairs



# NEXUS EVENT LOUNGE

Indoor multi-purpose venue



## Capacity

- 40 seated
- 75 standing



## Event types

- Product launches
- Workshops
- Celebrations
- Social events



## Features

- Area: 115 sqm



# NEXUS GREEN ROOM

Indoor private room



## Capacity

• 4



## Event types

- Private office
- Interview space
- Prayer room



## Features

- Area: 11 sqm



# NEXUS GARDEN TERRACE

Outdoor multi-purpose venue

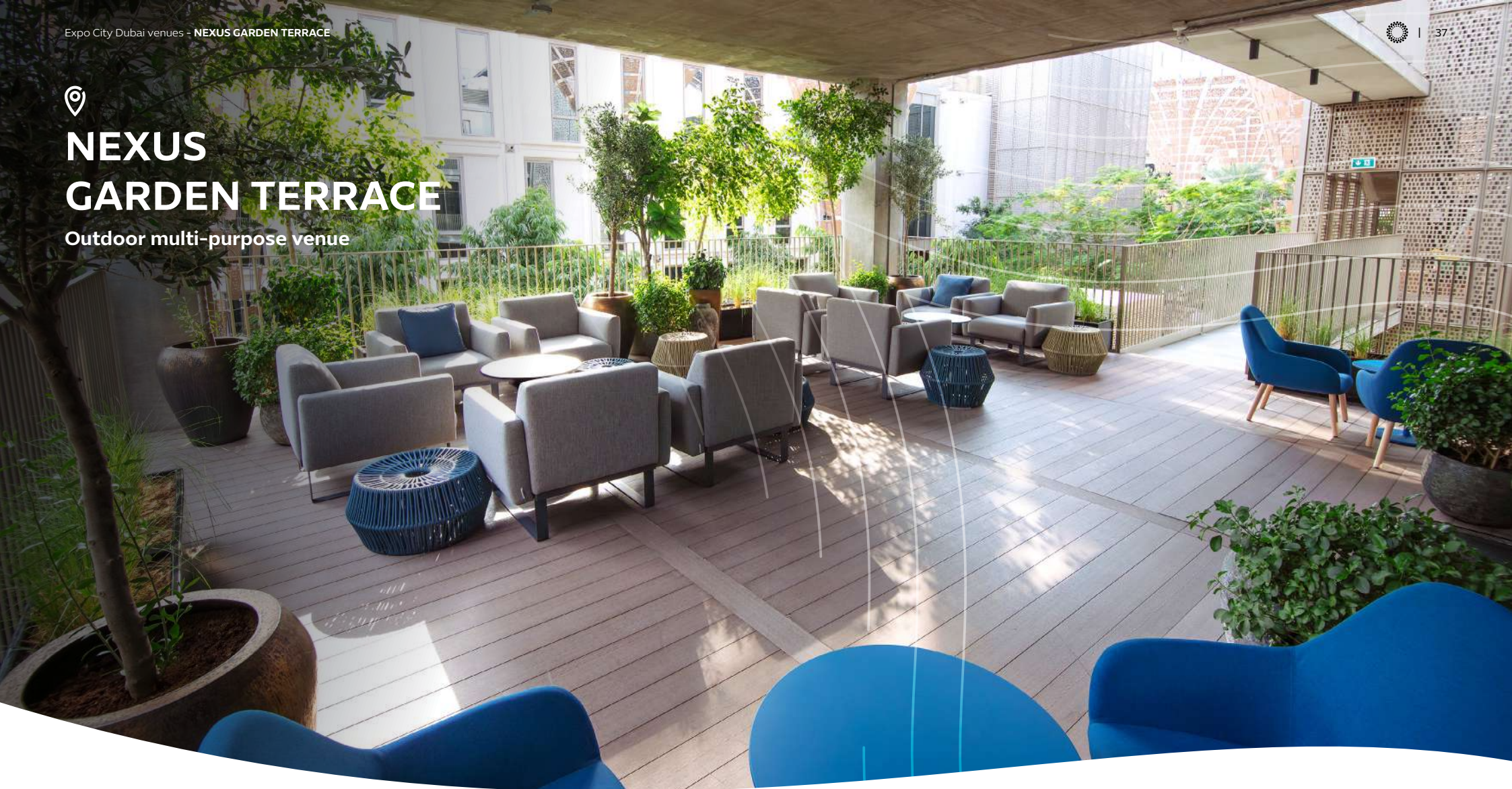

### Capacity

- 25 seated
- 65 standing



### Event types

- Dining
- Corporate events
- Networking events
- Social gatherings



### Features

- Area: 50 sqm

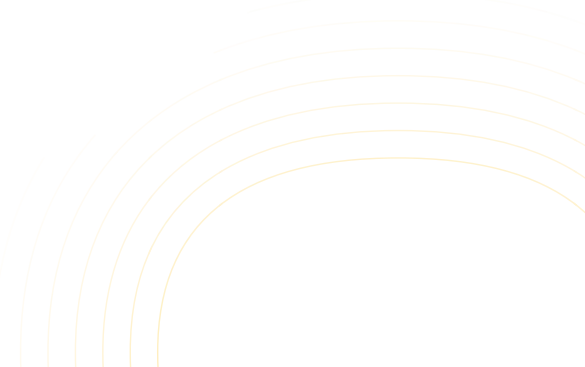



# NEXUS SUNSET TERRACE

Outdoor multi-purpose venue

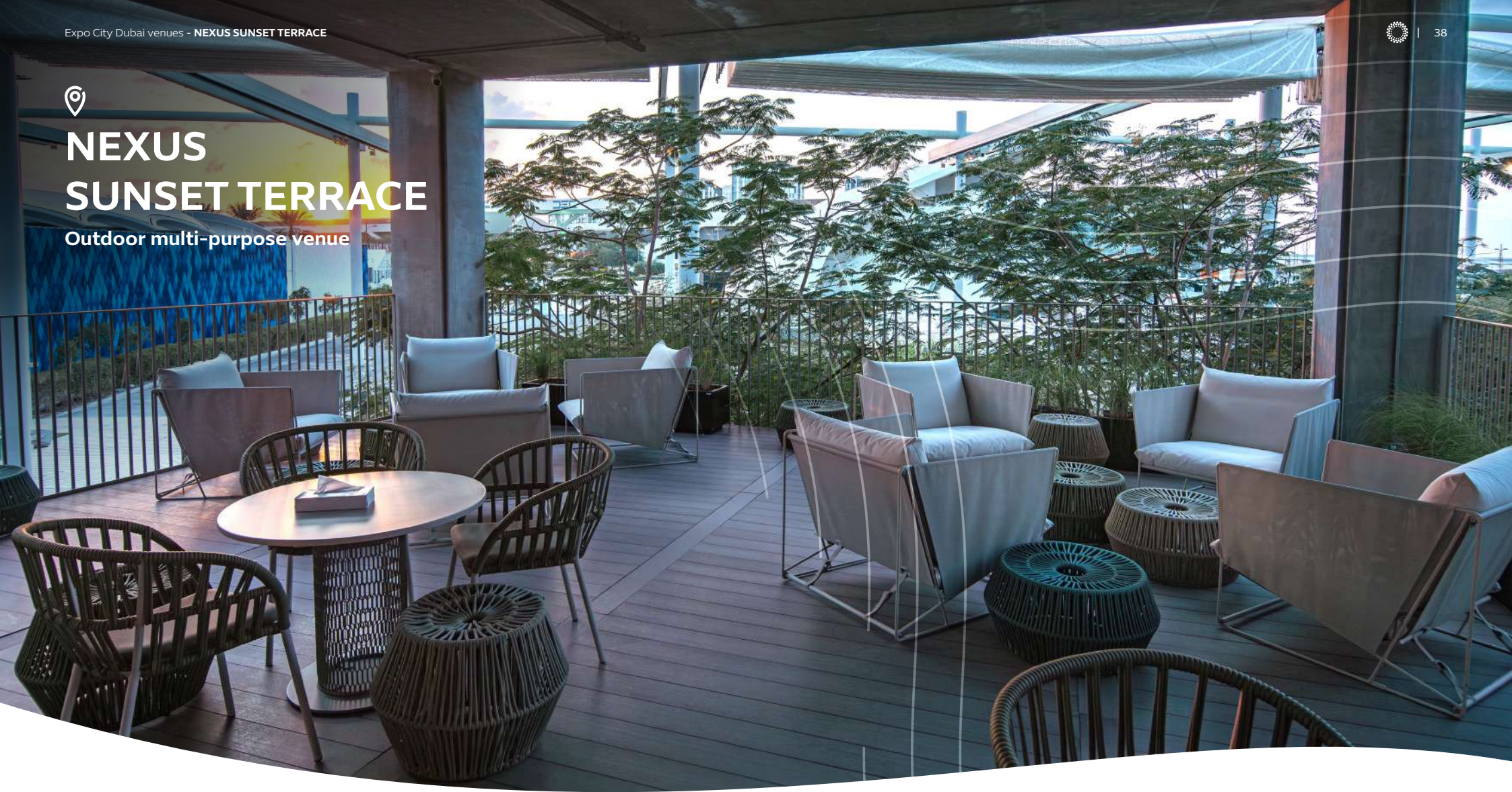

### Capacity

- 25 seated
- 65 standing



### Event types

- Dining
- Corporate events
- Networking events
- Social gatherings



### Features

- Area: 50 sqm

# WOMEN'S PAVILION

Reflecting a commitment to the global goal of achieving gender equality and empowering women, this versatile space offers opportunities for learning, action and dialogue to ensure women and girls are included in addressing the world's most pressing issues.

عالمنا  
المرأة  
WOMEN'S  
PAVILION



# WOMEN'S PAVILION MAJLIS

Indoor multi-purpose venue



## Capacity

• 200



## Event types

- Conferences
- Trainings
- Workshops
- Product launches
- Networking
- Exhibitions
- Performances



## Features

- Modular stage
- Reception desk
- VIP Majlis and green room available on request
- Access to daycare (additional fees apply)



## Tech specs

- 5.13m x 2.16m LED screen, with customisable configuration
- Video conferencing
- Ability to stream directly





# WOMEN'S PAVILION MULTI-PURPOSE ROOM

Indoor multi-purpose venue



## Capacity

- 100 seated



## Event types

- Conferences
- Trainings
- Workshops
- Product launches
- Networking
- Exhibitions
- Performances



## Features

- Two set-up options
- Venue can be used as a breakout space for other Women's Pavilion events
- Reception desk
- Access to daycare (additional fees apply)



## Tech specs

- 1 x 3.84m x 2.16 LED screen
- 2 x ceiling mounted relay screens
- Ceiling mounted dropdown screen and projector

- available in 2<sup>nd</sup> room (if divided)
- Video conferencing available
- Ability to stream directly

# CLIENT RELATIONS CENTRE

This dedicated centre supports Expo City's business community and offers a comprehensive range of Expo City Dubai Authority services, including obtaining a business licence, visa issuance, official documentation services as well as information on community services – ensuring every client's experience is seamless and efficient.





# CLIENT RELATIONS CENTRE

Indoor multi-purpose venue



## Capacity

• 150



## Event types

- Conferences
- Seminars
- Workshops
- Training
- Product launches



## Features

- Various event set-ups available



## Tech specs

- AV available
- Conference calling
- LED display screen

# FUTURE FORWARD BUSINESS HUB

With its range of flexible workspace solutions, this empowering business hub offers meeting rooms and event spaces for companies and individuals.





# FUTURE FORWARD BUSINESS HUB

Indoor multi-purpose venue

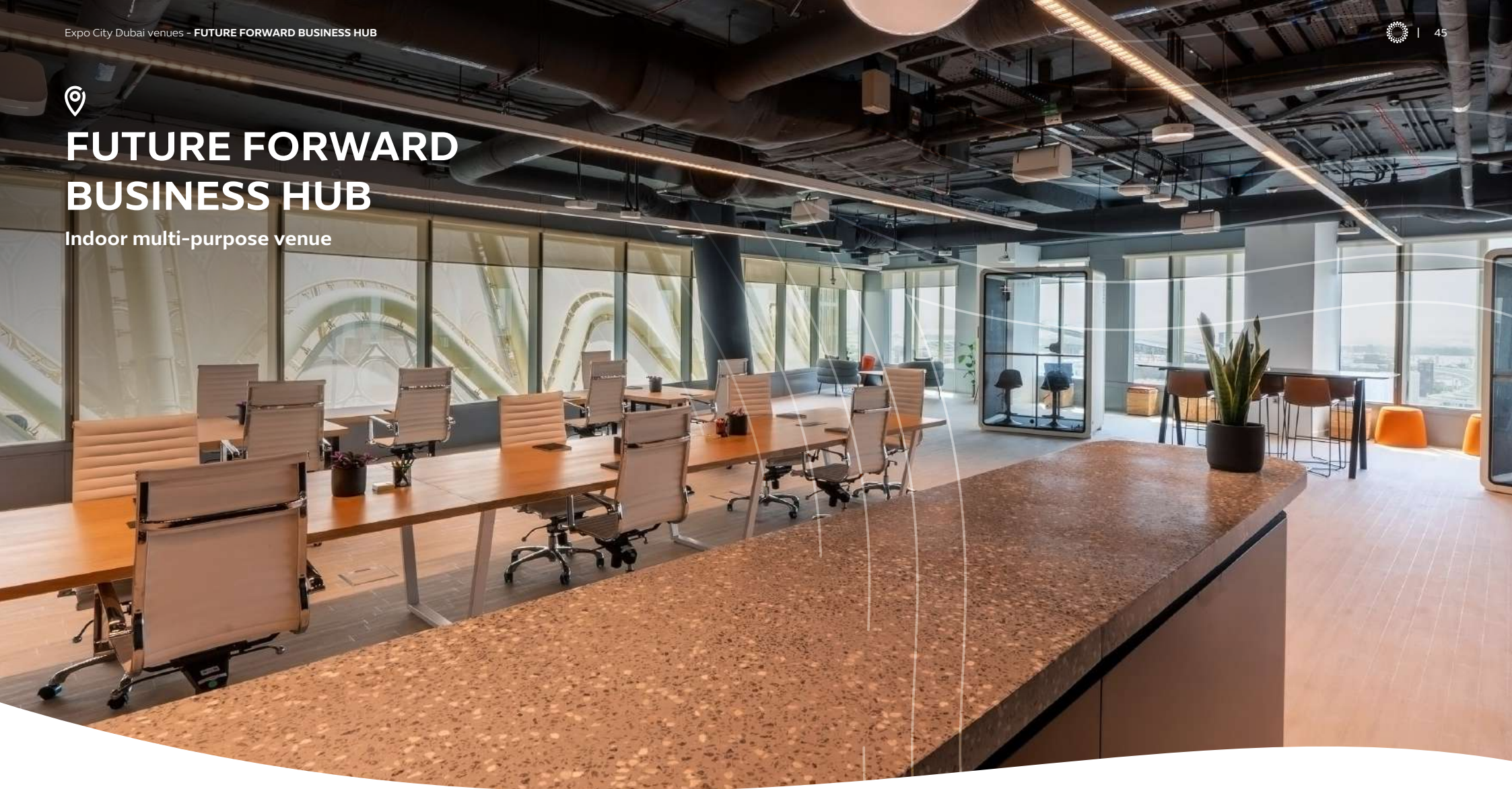

## Capacity

- 100



## Event types

- Workshops
- Training
- Product launches
- Networking events



## Features

- Various event setups available



## Tech specs

- AV available
- Conference calling

# FIRDAUS STUDIO

A beacon of innovation in music production, Firdaus Studio offers a acoustically perfect venue for your next event, whether it's a performance in the Scoring Stage or an outdoor rooftop celebration with beautiful views over the city.





# SCORING STAGE

Indoor multi-purpose venue



## Capacity

- 100



## Event types

- Intimate concerts
- Workshops
- Premieres
- Video shoots
- Art performances



## Features

- W 18 x L 12m
- Green rooms and breakout lounges



## Tech specs

- Advanced audio, video and lighting infrastructure



# TERRACE

Outdoor venue



## Capacity

- 120



## Event types

- Intimate outdoor concerts
- Workshops
- Sundowners
- Networking
- Photoshoots



## Features

- W10 x L 25m



# PARKS & PUBLIC REALM

Take advantage of Expo City Dubai's incredible array of outdoor spaces, open areas and alternative locations – ideal for non-traditional events, large-scale concerts and festivals and smaller community performances.





# AL FORSAN PARK

Outdoor multi-purpose venue

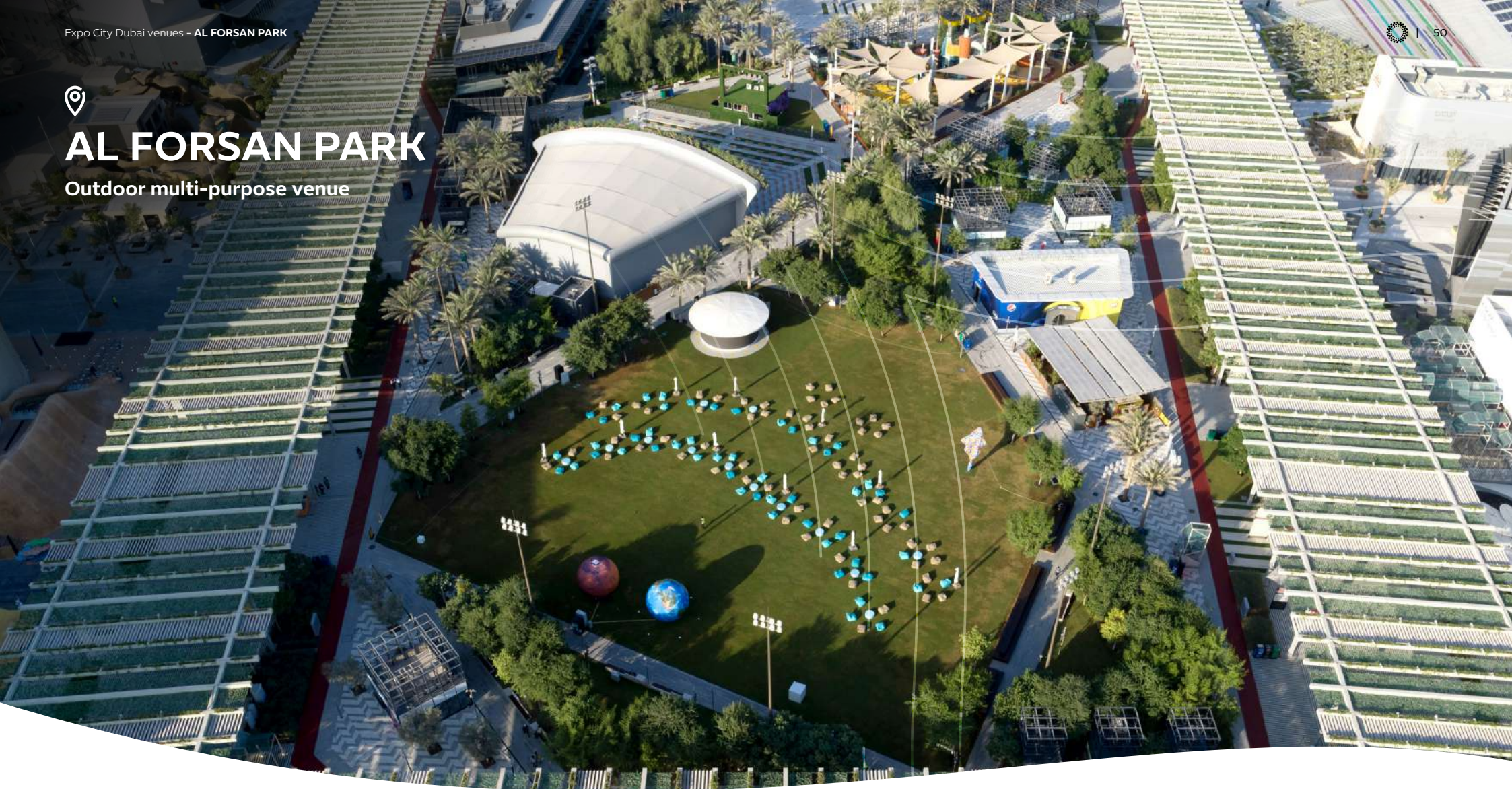

## Capacity

- 2,750 seated (banquet style)
- 3,300 standing (cocktail style)
- 3,750 seated (theatre style)
- 5,000 standing



## Event types

- Concerts
- Performances
- Markets
- Sports events



## Features

- 3,750 sqm
- Hexagonal outdoor space



## Tech specs

- Industrial power sockets
- Additional tech specifications available on request



# DUBAI MILLENNIUM AMPHITHEATRE

Outdoor concert venue



## Capacity

- 1,100 seated (banquet style)
- 1,320 standing (cocktail style)
- 1,500 seated (theatre style)
- 2,000 standing



## Event types

- Concerts
- Performances
- Ceremonies
- Graduations



## Features

- Supernova stage 16m x 15m
- Amphitheatre-style seating



## Tech specs

- 3 industrial power sockets
- Additional tech specifications available on request



# JUBILEE PARK

Outdoor concert venue



## Capacity

- 6,050 seated (banquet style)
- 7,260 standing (cocktail style)
- 8,250 seated (theatre style)
- 11,000 standing



## Event types

- Concerts
- Sports events
- Performances
- Ceremonies
- Graduations



## Features

- 8,500 sqm versatile green space
- Suitable for large-scale events



## Tech specs

- 5 back of house feeder pillars
- 1 front of house feeder pillar
- Additional tech specifications available on request



# EXPO CITY ARENA

Outdoor multi-purpose venue, massive concerts



**Capacity**  
• 70,000



**Event types**  
• Concerts  
• Performances  
• Festivals



**Features**  
• Width 110m  
• Length 295m



**Tech specs**  
• Additional tech specifications available on request



# GARDEN IN THE SKY

Indoor / outdoor observation tower



## Capacity

- 90



## Event types

- Networking
- Drinks receptions



## Features

- Full ride available for rent
- Selected F&B available



## Tech specs

- Limited power sockets



# SUSTAINABILITY GATE

Outdoor multi-purpose venue



**Capacity**  
• 16,600



**Event types**

- Concerts
- Performances
- Product launch



**Features**

- Width 105m
- Length 170m



**Tech specs**

- Additional tech specifications available on request

# DUBAI EXHIBITION CENTRE (DEC)

The world-class Dubai Exhibition Centre, located on the doorstep of Expo City Dubai, is a spectacular, state-of-the-art multi-purpose venue for events of all sizes, from globally significant conferences to concerts, weddings, sports events and more.

Spanning more than 58,000 sqm of flexible space and capable of hosting in excess of 32,000 people, DEC is divided into North and South Halls featuring flexible configurations that can host up to eight major events simultaneously. The venue also houses a range of meeting rooms, VIP suites, and majlises located on the upper gallery level with networking facilities and panoramic views of Expo City Dubai.

DEC, which is managed by Dubai World Trade Centre, has announced a AED 10 billion expansion plan that will see it become the largest purpose-built indoor events and exhibitions venue in the region.

DEC  
مركز دبي للمعارض

DUBAI EXHIBITION CENTRE

South Halls القاعات الجنوبية



# ADDITIONAL SERVICES

To ensure a seamless experience and make your event truly special, Expo City Dubai offers a range of additional features and services, from catering and furniture rental to technology expertise, accommodation and on-site mobility options.





# CATERING



TGP INTERNATIONAL

TGP International is the appointed catering provider for Expo City Dubai, delivering world-class catering solutions through its dedicated catering division.

Known for delivering exceptional creativity, style and detail, TGP Catering combines unmatched industry knowledge with over two decades of experience. Catering for VIP dinners and major brand launches to international mega-events, including COP28 and Expo 2020 Dubai, they are a

trusted partner to deliver F&B excellence to our clients & partners for all their catering requirements.

- World-class catering for all types of events
- 20+ years of experience
- Bespoke menus & packages
- Access to Michelin star chefs
- Full-service catering from office meetings to gala dinners

- Premium bar and interactive experiences
- Tailored dietary requirements

For all catering enquiries contact  
[catering@tgpinternational.com](mailto:catering@tgpinternational.com)

*Conditions: No external F&B is permitted onsite without prior written authorisation, and all events requiring alcohol service must be arranged through TGP Catering to obtain necessary permits.*



# ACCOMMODATION



Overlooking Al Wasl Plaza, Rove Expo City Hotel offers an unbeatable location at the centre of Expo City Dubai and just a short stroll from the metro station and Dubai Exhibition Centre.

This modern, vibrant hotel features a lively open-plan lobby, conference rooms and comfortable workspaces as well as

contemporary rooms, a popular restaurant, 24-hour gym and rooftop infinity pool – all designed with the modern traveller in mind.

Expo City will soon be home to even more accommodation options, including Cheval Maison luxury serviced apartments, set to open in 2025.



# FURNITURE, FIXTURES AND FITTINGS



Each venue is ready to use and comes equipped with furniture, fixtures and fittings, with bathrooms on site or within the vicinity. These amenities can be altered or expanded depending on your event requirements.

Please speak to the Expo City Dubai team who will be happy to advise.





# TECHNICAL SERVICES



Connect 21 is an integrated technology company and subsidiary of Expo City Dubai that delivers cutting-edge technology solutions.

As proud contributors to the success of Expo 2020 Dubai, COP28 UAE and other large-scale global events, the team's expertise

lies in the planning and delivery of safe, secure and seamless technology solutions to enhance clients' connectivity, security and operational efficiency at Expo City and beyond.

Our services include:

- Ultra Connect as a service

- IP telephony
- Surveillance systems (CCTV)
- Access control systems
- LAN as a service
- Audio and video systems
- Video analytics
- Print as a service
- Endpoint management

- End user management
- Consulting services (expert IT guidance)
- Technology event operations
- Technology engineering services

We look forward to helping you plan and deliver an extraordinary experience at Expo City.

Contact us at [contactus@connect21.ae](mailto:contactus@connect21.ae) or **04 555 2030**, or visit our website at [www.connect21.ae](http://www.connect21.ae).



# ACCESSIBILITY



Expo City Dubai has built accessibility into its very fabric to ensure that people of determination fully supported. Features include:

- Dedicated accessible parking
- Wheelchair accessible buggies
- Wheelchair rental
- Accessible toilets
- Step-free access and/or elevators
- Braille signage
- Tactile maps
- Hearing induction loops
- Hearing enhancement systems

For any accessibility-related queries and other requirements, such as sunflower lanyards, etc, our Accessibility team is happy to help.

Please contact them at [accessibility@expocitydubai.ae](mailto:accessibility@expocitydubai.ae)

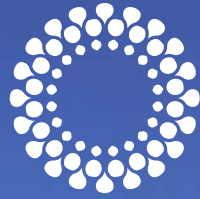

مدينة إكسبو دبي  
EXPO CITY DUBAI

## CONTACT US

For bookings and more information:  
[events@expocitydubai.ae](mailto:events@expocitydubai.ae)

[expocitydubai.com](http://expocitydubai.com)