

Convene 360 Madison Avenue

MEETINGS & EVENTS

360 Madison Ave, New York, NY 10017



Located in Manhattan's Midtown East neighborhood, Convene 360 Madison Avenue is a three-level meeting and event venue. With 17 meeting spaces spanning 68,000 square-feet, the venue is ideal for conferences, company town halls, planning meetings, or any event that requires multiple breakout spaces.

The location boasts a simple and sleek design with a dedicated Welcome Desk and reception area on each floor: four, five, and six. Levels four and five are connected by a central staircase and each feature an 11-foot LED wall, offering additional branding opportunities. A full buyout of all three floors can accommodate approximately 950 guests, and single-floor buyouts have a capacity of 331, 318, and 213, respectively. Convene 360 Madison Avenue provides a white box space allowing for client and event branding opportunities, in-house catering with customization options and dining private to each event, in-room A/V technology supported by an on-site team, and dedicated hospitality resources.

The venue is easily accessible via public transportation and is in close proximity to Grand Central Station.

17
MEETING SPACES

331
MAX ROOM CAPACITY

68,000
SQUARE FEET



FLEXIBLE MEETING & EVENT SPACE



INNOVATIVE TECHNOLOGY



EVENT PLANNING & MANAGEMENT



FULLY STAFFED & SERVICED



ON-SITE GOURMET CATERING



PREMIUM DESIGN



This collateral is based on the latest information reasonably available and may be updated on a periodic basis. Please check with your Convene Account Manager for the latest information.

convene

CONVENE.COM | 888-730-7307

Floor plan & Capacities

4TH FLOOR

LEGEND

- BATHROOMS
- ELEVATORS
- ENTRANCE
- BATHROOMS & RESPITES
- GALLERY SPACES
- MEETING ROOMS
- WELCOME DESK
- BACK OF HOUSE
- DIGITAL SIGNAGE

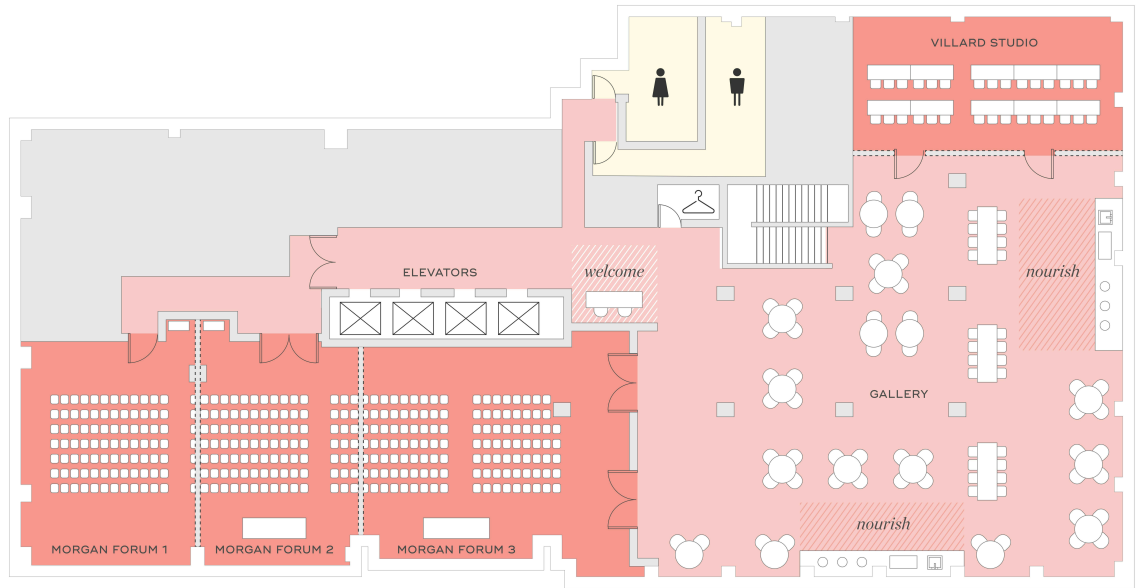

	AREA [SQ FT]	THEATER	CLASSROOM	ROUNDS	CONFERENCE	U-SHAPE	PODS [6-TOP]	EXHIBITION [STANDS]
Morgan Forum [w/ stage]	3962 ft ²	280	120	150	-	-	126	-
Morgan Forum [without stage]	3962 ft ²	331	159	160	-	-	168	-
Morgan Forum 1	1113 ft ²	96	45	40	24	27	36	-
Morgan Forum 2	1121 ft ²	78	39	40	24	21	30	-
Morgan Forum 3	1781 ft ²	156	69	70	36	30	66	-
Morgan Forum 1 & 2	2234 ft ²	174	96	90	-	-	96	-
Morgan Forum 2 & 3	2901 ft ²	235	135	120	-	-	132	-
Villard Studio	967 ft ²	73	30	-	36	21	24	-
Gallery	5571 ft ²	-	-	-	-	-	-	29

Floor plan & Capacities

5TH FLOOR

LEGEND

- BATHROOMS
- ELEVATORS
- ENTRANCE
- BATHROOMS & RESPITES
- GALLERY SPACES
- MEETING ROOMS
- WELCOME DESK
- BACK OF HOUSE
- DIGITAL SIGNAGE



	AREA [SQ FT]	THEATER	CLASSROOM	ROUNDS	CONFERENCE	U-SHAPE	PODS [6-TOP]	EXHIBITION [STANDS]
French Forum [w/ stage]	3,869 ft ²	280	111	140	-	-	102	-
French Forum [without stage]	3,869 ft ²	318	132	140	-	-	150	-
French Forum 1	1,200 ft ²	96	45	50	30	33	48	-
French Forum 2	991 ft ²	73	36	40	18	21	24	-
French Forum 3	1,684 ft ²	144	69	70	36	30	66	-
French Forum 1 & 2	2,191 ft ²	174	93	100	-	-	96	-
French Forum 2 & 3	2,675 ft ²	222	117	100	-	-	102	-
Doyle Studio	706 ft ²	57	27	-	18	18	24	-
Johnson Studio	663 ft ²	54	27	-	18	18	24	-
Emery Studio	770 ft ²	65	36	-	18	18	36	-
Gallery	4,666 ft ²	-	-	-	-	-	-	19

360 Madison Ave, New York, NY 10017

Floor plan & Capacities

6TH FLOOR

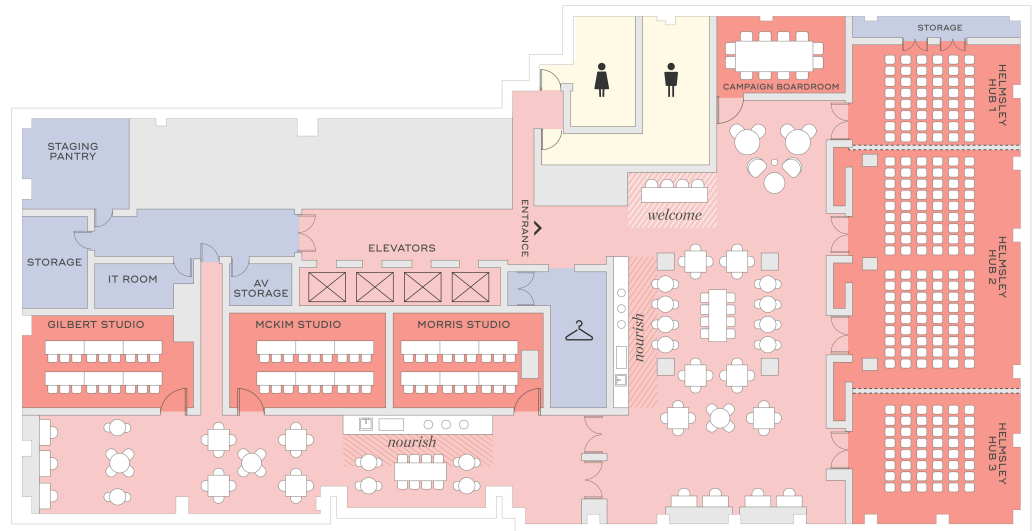
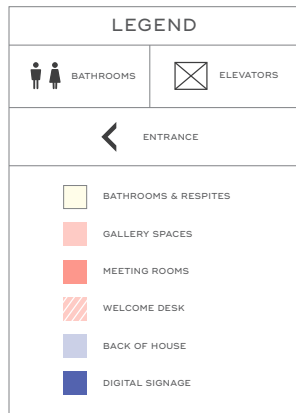

	AREA [SQ FT]	THEATER	CLASSROOM	ROUNDS	CONFERENCE	U-SHAPE	PODS [6-TOP]	EXHIBITION [STANDS]
Helmsley Hub [w/ stage]	3,025 ft ²	213	132	110	-	-	108	-
Helmsley Hub [without stage]	3,025 ft ²	213	144	130	-	-	144	-
Helmsley Hub 1	673 ft ²	48	24	20	18	21	18	-
Helmsley Hub 2	1,518 ft ²	110	72	70	36	33	60	-
Helmsley Hub 3	766ft ²	55	24	20	18	24	30	-
Helmsley Hub 1 & 2	1,439 ft ²	158	108	100	48	45	108	-
Helmsley Hub 2 & 3	2,284 ft ²	165	108	100	48	45	108	-
Morris Studio	591 ft ²	35	18	-	12	12	12	-
McKim Studio	608 ft ²	40	18	-	18	15	18	-
Gilbert Studio	576 ft ²	38	18	-	18	15	12	-
Campaign Boardroom	398 ft ²	-	-	-	13	-	-	-
Gallery	576 ft ²	-	-	-	10	-	-	-

This collateral is based on the latest information reasonably available and may be updated on a periodic basis. Please check with your Convene Account Manager for the latest information.