



etc.venues Manchester, Piccadilly

11 Portland Street, Manchester M1 3HU

- Meetings range from 10 to 300 people
- Located in a contemporary mixed-use building offering views of the city centre, the design of the space reflects the vibrance of Manchester with colorful furnishings and eclectic artwork
- Ideal for corporate trainings and the self-contained private event wing is best suited for conferences or internal meetings

 NEARBY PUBLIC TRANSPORTATION	 TURNKEY SPACES	 SHARED HOSPITALITY RESOURCES
 WIFI INCLUDED	 COMMUNAL CATERING-OF-THE-DAY	 SELECT SIGNAGE OPPORTUNITIES

SQUARE METERS

1,765

MEETING ROOMS

15

LARGEST CAPACITY ROOM

300



ADMIRE



PANORAMA SUITE

etc.venues Manchester, Piccadilly

11 Portland Street, Manchester M1 3HU

EIGHTH FLOOR

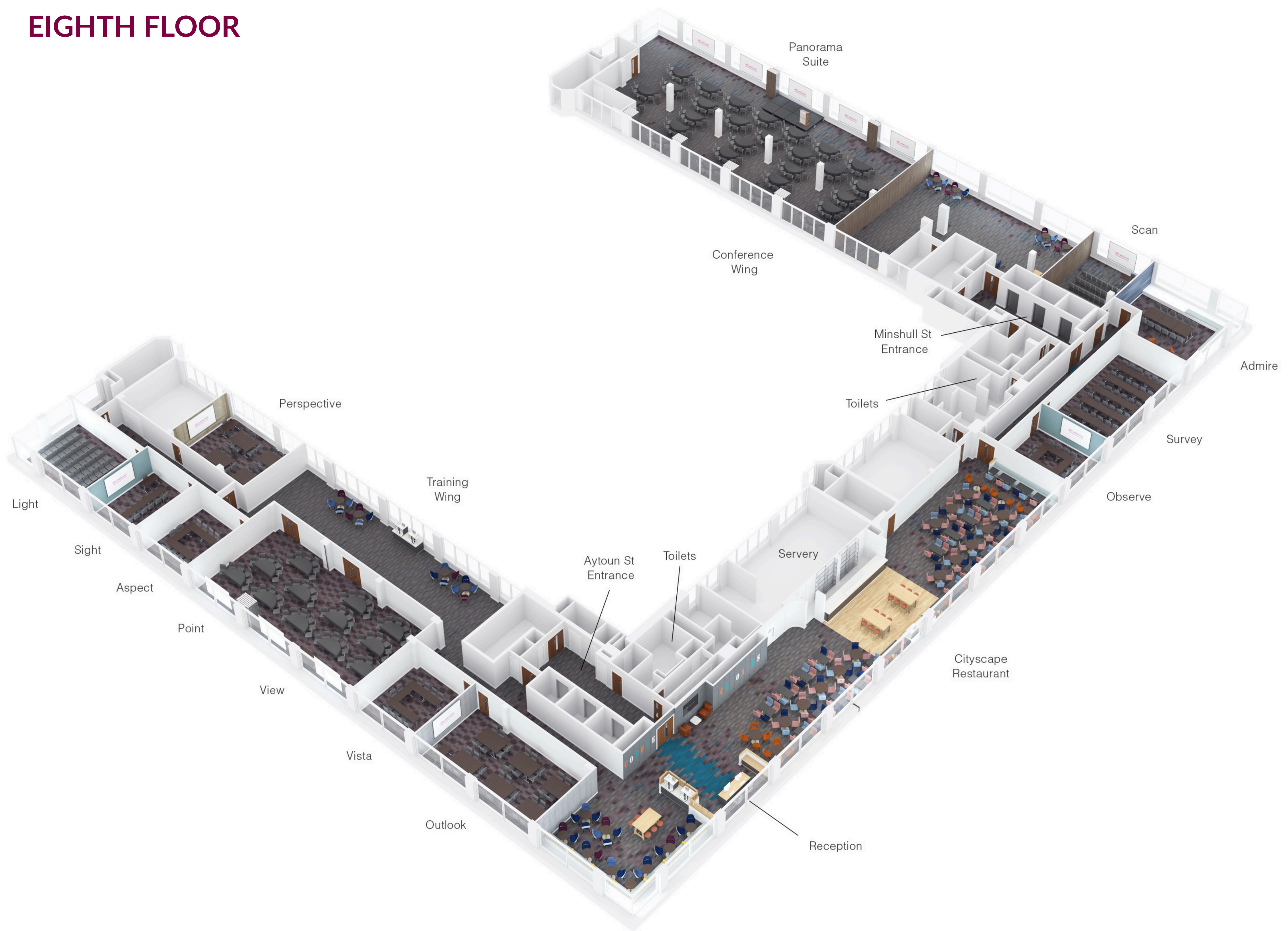

ROOM NAME	AREA [SQ M]	THEATER	BANQUET	CABARET	CLASSROOM	U-SHAPE	BOARDROOM
PANORAMA SUITE	348	300	230	168	136	-	-
PANORAMA LOUNGE	143	-	-	-	-	-	-
PANORAMA 2 + 3	283	250	180	132	106	-	-
PANORAMA 1	51	35	20	18	16	-	-
PANORAMA 2	110	80	70	48	36	-	-
PANORAMA 3	91	55	50	36	18	-	-
VIEWPOINT	124	128	70	72	54	30	48
VIEW	81	88	-	42	36	22	32
POINT	43	35	-	18	18	16	20
SURVEY	60	72	-	36	30	24	28
OUTLOOK	55	56	-	36	30	24	28
LIGHT	41	42	-	24	24	16	20
PERSPECTIVE	45	42	-	24	24	16	20
SCAN	37	35	-	18	16	16	20
OBSERVE	30	24	-	12	12	10	12
VISTA	29	21	-	12	12	10	12
SIGHT	29	21	-	12	10	10	12
ASPECT	29	21	-	12	10	10	12
ADMIRE	62	-	-	-	-	-	10