



Prestige cascade



Saves Space



Saves Time



Saves Money



The Cascade System features multiple, high efficiency, fully modulating, low water content boilers, where off cycle losses are substantially reduced and dissipated heat from stored water is far less than a single large capacity boiler.

TRIANGLE TUBE factory prefabricated boiler manifolds with capacities from 500,000 to 2,000,000 BTU/hr.

prestige cascade

Cascade Kit P/N	# of Manifolds	# of 250, 299 or 399 Boilers	Total Input MBH Note 1	Total Output MBH Note 1 & 2	Net AHRI Rating MBH Note 3	EDR Water ft ² Note 4
CPS 500	1	2 (250)	43.6 - 480	444	386	2,579
CPS 600	1	2 (299)	72.5 - 598	556	484	3,225
CPS 800	1	2 (399)	72.5 - 798	759	660	4,399
CPS 900	1	3 (299)	72.5 - 897	834	726	4,837
CPS 1000	2	4 (250)	43.6 - 960	888	772	5,148
CPS 1200	1	3 (399)	72.5 - 1,197	1,138	990	6,599
CPS 1500	2	5 (299)	72.5 - 1,495	1,390	1210	8,062
CPS 1600	2	4 (399)	72.5 - 1,596	1,518	1,320	8,799
CPS 2000	2	5 (399)	72.5 - 1,995	1,897	1,650	10,999

Cascade Kit P/N	Total Water Content (Gal.)	Total Shipping Weight (lbs)	Length (inches)	Height (inches)	Depth (inches)
CPS 500	23	725	86"	72"	36"
CPS 600	29	829	86"	72"	36"
CPS 800	29	841	86"	72"	36"
CPS 900	39	1,107	113"	72"	36"
CPS 1000	38	1,326	154"	72"	36"
CPS 1200	39	1,125	113"	72"	36"
CPS 1500	59	1,812	181"	72"	36"
CPS 1600	50	1,558	154"	72"	36"
CPS 2000	59	1,842	181"	72"	36"

Note 1: Input and output ratings are shown for sea level applications. The Prestige Solo automatically derates the input at approximately 2% for every 1,000 feet of altitude. No alteration to the boiler or burner system is required.

Note 2: Prestige Solo 399 output ratings are based off a thermal efficiency of 95.1%. Prestige Solo 250 output is based on DOE heating capacity.

Note 3: The IBR rating is based on piping and pick up allowance of 1.15. This allowance should be sufficient for standard radiation requirements.

Note 4: Equivalent Direct Radiation (EDR) is based on 150 Btu/h per square foot at 170°F average supply temperature.

Note 5: Minimum recommended system iron pipe size is based on temperature differential of 20°F.

Note 6: Minimum recommended natural gas header size is based on using schedule 40 metallic pipe 0.30" w.c. pressure drop and 100 feet of total equivalent length at inlet gas pressure of less than 2 psi. Consult National Fuel Gas Code for alternate sizing.

Optional Common Vent System (for 299 and 399 boilers only)

2 Boiler Common Vent Part Number - PSVKIT04

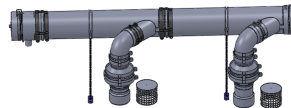

- ULC S636 approved vent system
- Single penetration
- Prefit piping to reduce installation time
- 6" Connection

3 Boiler Common Vent Part Number - PSVKIT05

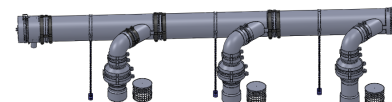

- Terminations and flashing available
- Polypropylene construction
- 6" Connection

Product data

CPS STANDARD EQUIPMENT

- Prestige Solo 250 or 399 boilers
- Cascade manifold
- Hydronic Separator with 3" flanged supply and return connections
- Grundfos circulator (1 per boiler)
- ANSI flange kit
- Air vent
- Installation hardware

OPTIONAL EQUIPMENT

- Common venting manifold kit
- CSD-1 Kits Complete with low water cut-off and fittings