

VENUE HIRE



THE
JOHNNIE WALKER
EXPERIENCE

CONTENT



3	VENUE HIRE	18	FULL VENUE TAKEOVER
4	A VENUE FOR EVERYONE	20	EVENT PACKAGES
5	EVENT SPACE OVERVIEW	22	CATERING
6	LABEL STUDIO	23	EXPERIENCES
9	LEARNING FOR LIFE ACADEMY	26	GIFTING
12	ROOFTOP BAR	27	LOCATION
15	EXPLORER'S BOTHY BAR	28	CONTACT



VENUE HIRE

AT THE JOHNNIE WALKER EXPERIENCE

Whether you're entertaining, learning or celebrating, our landmark city centre location, coupled with the most spectacular views of Edinburgh Castle, means your next event is guaranteed to be unforgettable.

The Johnnie Walker Experience is an immersive eight-floor whisky experience offering immersive tours, unique and beautiful spaces ready for business and pleasure, and sensational drams. We're not just here for whisky drinkers though, we're also here for those looking to try something new.

Located in the heart of Edinburgh's city centre, against the backdrop of the famous castle, our remarkable brand home was purpose-built to deliver world-class experiences and events. We are proud to have been crowned the World's leading Spirit Experience and have earned a Green Tourism Gold Award for sustainable practices.



Each space has been designed to impress, from the incredible skyline views in our Label Studio and two world-class rooftop bars to the modern hub of mixology in our Learning of Life Academy. Each is entirely customisable and fully equipped with the latest technology, including high-quality sound and lighting, superfast WI-FI and high-performance AV systems.

From our passionate bartenders and expert guides to our talented performance artists and brilliant retail staff, our dedicated team will guarantee your event runs smoothly.

A VENUE FOR EVERYONE

Right from the beginning, it was our aim to make The Johnnie Walker Experience truly accessible for all.

Making this a reality is our incredible team, always on hand to support guests and committed to working with 'Euan's Guide' to ensure we meet the highest industry standards for accessibility.

We are proud to have also been awarded a Green Tourism Gold certification, recognising our dedication to sustainability and the environment.

On top of all that, we have also ensured that our drinks menu has something for everyone. You won't just find the best whiskies but also a carefully curated mix of cocktails, spirits, liqueurs, wines and beers, along with an enticing array of mocktails and soft drinks.

If you're looking for a flexible, dynamic venue with spectacular views, top facilities and world class catering, then look no further.



EVENT SPACE & CAPACITY OVERVIEW



DIMENSIONS

SPACE	TOTAL AREA	HEIGHT	LENGTH	WIDTH
<i>Label Studio</i>	205m ²	2.6m*	19.75m	10.64m
<i>Learning For Life Academy</i>	114m ²	2.87m	7.32m	10.82m
<i>Rooftop Bar</i>	152m ²	3.04m	26.2m	12.64m
<i>Explorers' Bothy</i>	172.4m ²	3.9m	13.8m	12.5m

CAPACITY

SEATED	STANDING	THEATRE STYLE	ROUND TABLE	CABARET	BOARDROOM
120	180	130	120	60	-
-	40	-	-	-	10
80	100	-	-	-	-
42	60	-	-	-	-

Capacity is a guide subject to your event set up requirements T&C's apply.
Lowest height is 2687mm, Highest point is 6483mm.

LABEL STUDIO

The largest of our event spaces, the Label Studio offers unrivalled views of Edinburgh's iconic castle, superfast WiFi, hi-spec lighting and AV equipment. Located on the 4th floor, it can be adapted to accommodate up to 180 guests for events as wide and varied as product launches, brand activations, art exhibitions, live music, photoshoots, screenings, fashion shows and press conferences.

STANDING	180
THEATRE STYLE	130
ROUND TABLE	120
CABARET	60



*Capacities subject to change dependent on the need for equipment/stages/dressing.

LABEL STUDIO SPECIFICATIONS

TOTAL AREA	205m ²
CEILING HEIGHT	2.6m
LENGTH	19.75m
WIDTH	10.64m

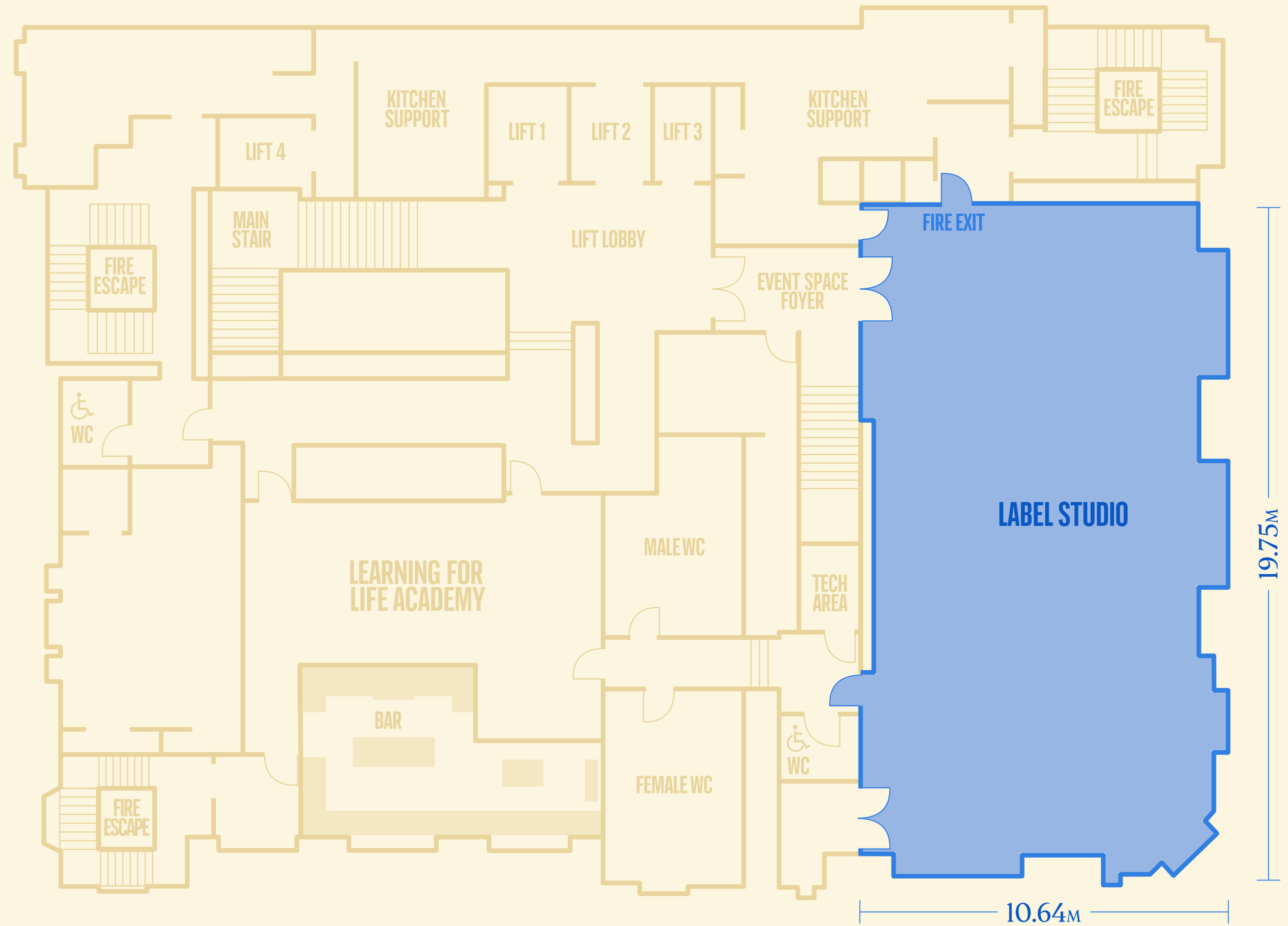



LEARNING FOR LIFE ACADEMY

The Learning for Life Academy is a hub of innovation and creativity – a contemporary space that offers versatility and a range of customisable options on our fourth floor. It can be adapted to provide an intimate workshop space, a place for drinks receptions or act as an annex to the Label Studio next door.

STANDING	40
BOARDROOM	10



LEARNING FOR LIFE ACADEMY SPECIFICATIONS

TOTAL AREA	114m ²
CEILING HEIGHT	2.87m
LENGTH	7.32m
WIDTH	10.82m

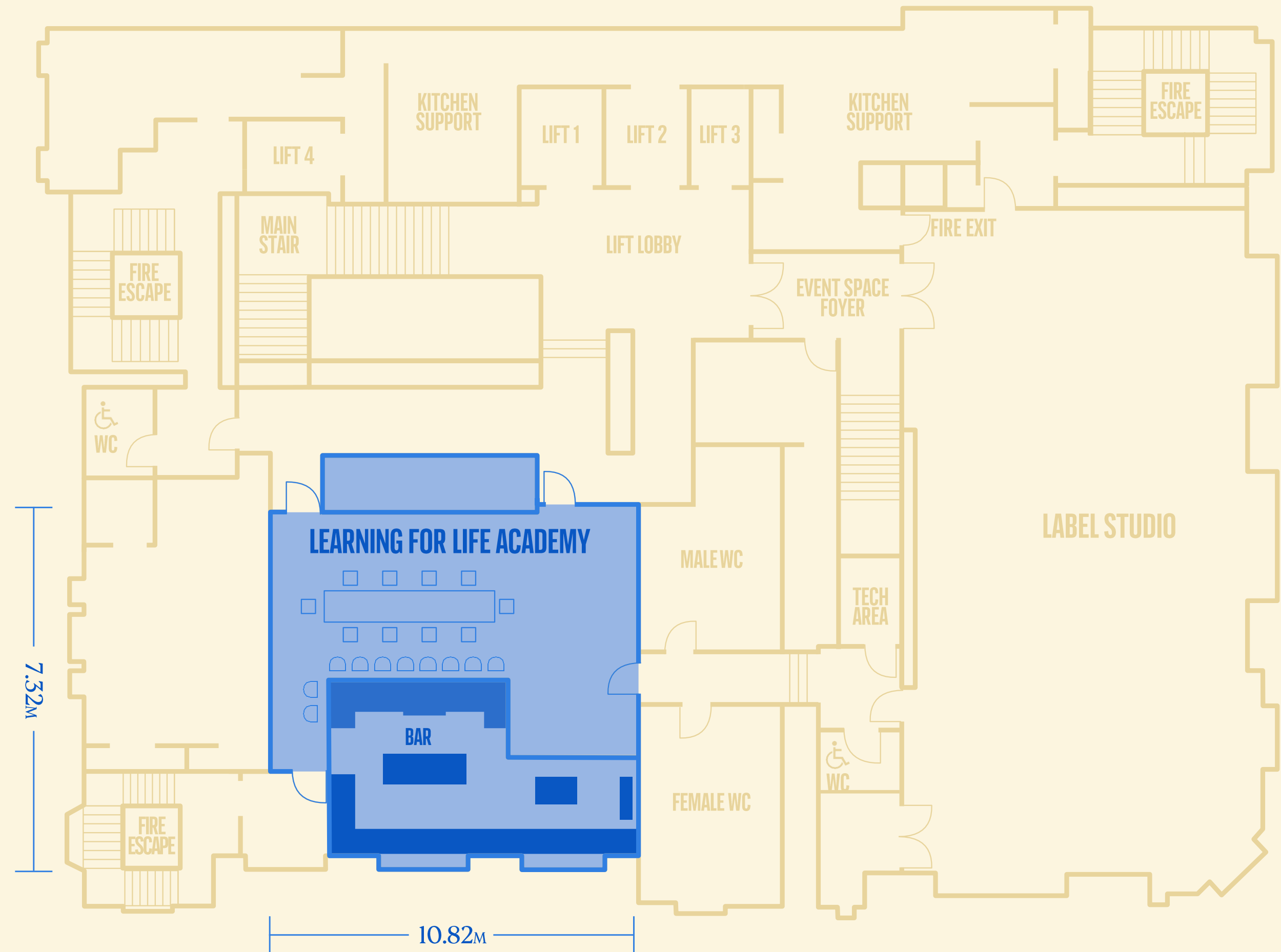



ROOFTOP BAR

With unrivalled skyline views overlooking the castle, outdoor seating, locally sourced cuisine and carefully crafted whisky cocktails, there is no setting anywhere in Edinburgh quite like our rooftop bar.

Available for exclusive hire for private events, this venue will deliver the wow factor you're looking for and is the ideal spot to indulge in world-class food and drink.

STANDING	100
SEATED	80



ROOFTOP BAR SPECIFICATIONS

TOTAL AREA	152m ²
CEILING HEIGHT	3.04m
LENGTH	26.2m
WIDTH	12.64m

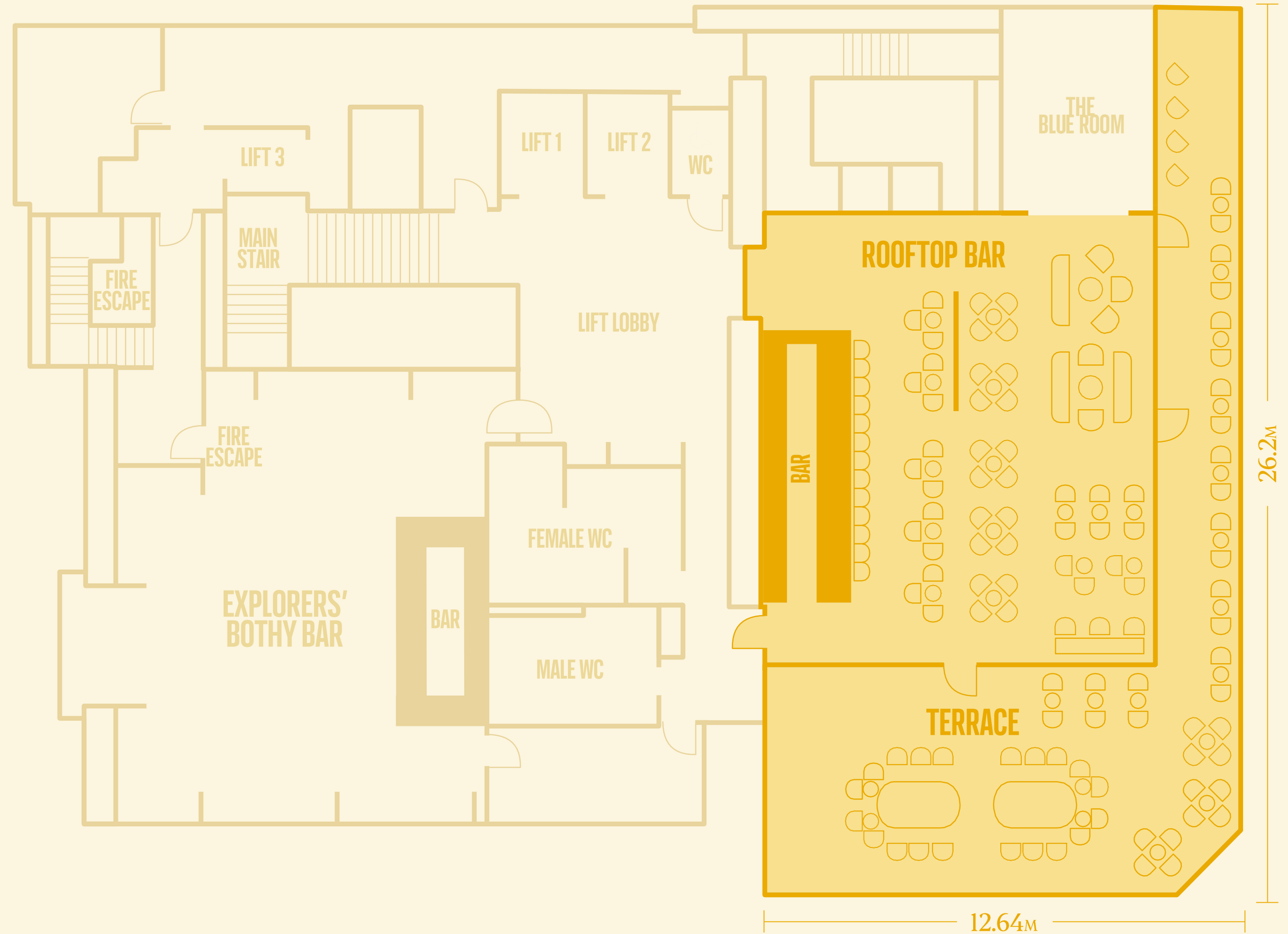



EXPLORERS' BOTHY BAR

Swap ordinary for extraordinary in this cosy rooftop bar. Enjoy cocktails with a creative twist, crafted and served by our expert mixologists.

Perfect for private functions, brand activations, or reception events, this space can be hired exclusively to give your guests an extraordinary experience.

STANDING	60
SEATED	42



EXPLORERS' BOTHY BAR SPECIFICATIONS

TOTAL AREA	172.4m ²
CEILING HEIGHT	3.9m
LENGTH	13.8m
WIDTH	12.5m

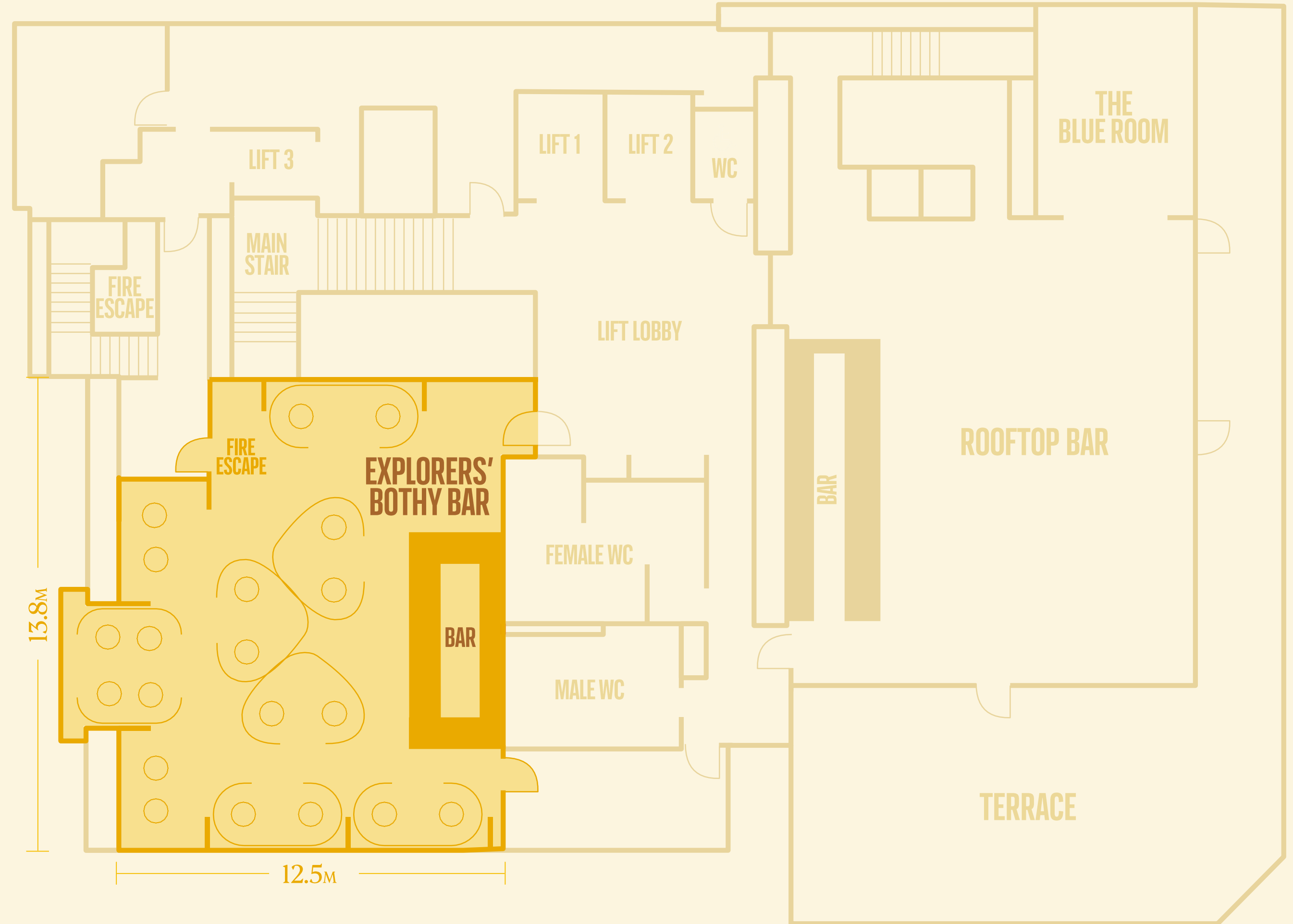



FULL VENUE TAKEOVER

Exclusive hire

The Johnnie Walker Experience is the perfect spot to blow your guests away with breath-taking views of Edinburgh, state-of-the-art facilities, and an incredible experiential retail space. You even have the freedom to customise key touchpoints throughout the venue - such as digital screens, outdoor lighting or even a complete atrium takeover – to magnify your event.

If you're planning a larger-scale event, speak to our team about how you can create a unique experience across eight floors of our building.





LABEL STUDIO EVENT PACKAGES

Host an unforgettable event overlooking Edinburgh Castle with tailor-made event packages.

DRINKS RECEPTION PACKAGE

MIN 60 PERSONS, MAX 180 STANDING

Soak up the views with world-class cocktails and sensational catering with a reception event your guests won't forget.

DAILY DELEGATE RATE PACKAGE

MIN 60 PERSONS, MAX 120 SEATED

There's no better space to host your next meeting, conference or training session than our Label Studio event space. Our DDR package includes modern facilities, delicious refreshments, and a fantastic lunch.

DINNER PACKAGE

MIN 50 PERSONS, MAX 120 PERSONS

The Label Studio dinner package offers an elegant and luxurious option for hosting a sophisticated event. The package is designed to provide a magnificent experience with a world class food menu, selection of beverages and exclusive access to a premium events space.

Minimum numbers apply. Have something special in mind? Our Events Team would be delighted to discuss bespoke packages tailored to your unique needs and preferences.





ENHANCE

YOUR EVENT

If you want to make your event one your guests will never forget, you can add world-class catering, our five-star Johnnie Walker Signature Experience, or personalised gifts for your guests to take home.

CATERING

Food and drink lie at the heart of everything we do at The Johnnie Walker Experience.

Our Scottish roots are evident in all our menus, which have been created with fresh, vibrant and locally sourced ingredients.

Our in-house catering team will work with every client on an individual basis to deliver a flawless, world-class experience that is sure to delight and inspire your guests.

From small-bite cuisine created with great chefs' flair to inventive whisky dinners conceived by culinary artists and ingenious whisky masters, this is about exciting, future-thinking food.





EXPERIENCES



Add a new dimension to your event with our range of whisky experiences. Each offers something completely unique, giving you the chance to impress your guests on a whole new level.

JOHNNIE WALKER SIGNATURE EXPERIENCE



Add a new dimension to your event – this immersive, interactive, full-sensory experience uses light and special effects unlike anything ever seen in Scotland.

Embark on our signature five star whisky tour and join us on an epic sensory journey like no other. Uncover the story of Johnnie Walker, discover your personal flavour profile and enjoy three delicious cocktails tailor made to your tastebuds.

ENJOY THREE TAILORED WHISKY COCKTAILS WITH NON-ALCOHOLIC OPTIONS ALSO AVAILABLE

DURATION	1.5HRS
MAX CAPACITY	22

Tours depart regularly and we can adjust to your schedule on request. Audio guides are available in French, Spanish, German and Mandarin, subject to availability. If you have additional language requests please enquire.

[BOOK HERE](#)

Note: this tour is highly immersive and uses a combination of light, media, music, sensory moments and special effects that may not be suitable for all audiences.



EXPERIENCES



THE JOHNNIE WALKER COLLECTION - A GUIDED TASTING

DURATION: 1 HR

Led by one of the whisky specialists in our Explorers' Bothy bar, this sensory tasting experience offers a curated exploration of Scotland's liquid landscape, with 5 extraordinary expressions from iconic whisky regions like Islay, the Highlands and Speyside, each matured for a minimum of 12 years.

[BOOK HERE](#)



LUXURY WHISKY & SCOTTISH CHOCOLATE TASTING

DURATION: 1.5 HRS

Indulge in a guided tasting journey from our whisky experts, featuring four iconic Johnnie Walker drams, each perfectly paired with a decadent luxury chocolate truffle, created by Iain Burnett, the Highland Chocolatier. Your experience will culminate with a dram of the highly sought-after John Walker & Sons King George V, which includes some of the rarest whiskies from irreplaceable casks from Port Ellen Distillery.

[BOOK HERE](#)



LUXURY CASK DRAW TASTING

DURATION: 1.5 HRS

Designed specifically for whisky connoisseurs and held in our underground cellar, this unparalleled experience offers you the chance to taste exceptional whiskies direct from our private casks, as well as exclusive Johnnie Walker expressions created right here at Princes Street by our master makers.

[BOOK HERE](#)



GIFTING INSPIRATION

Our whisky emporium gives your guests the chance to take home more than just memories. From personalised bottles to bespoke travel items for overseas visitors, we offer a huge range of retail purchases that can add to your experience.

Gift bottles can be engraved with the name of your event, your company, or even the name of each attendee.

What's more, your guests can pinpoint their perfect whisky with our innovative and interactive flavour mapping service – available via our tablets on the shop floor.

Our Events Team will be happy to help you find the best options for you, your budget, and your guests.



LOCATION

The Johnnie Walker Experience is highly accessible wherever your guests are coming from. With excellent air, road and rail routes, it's really easy to get here.

We're located in the heart of Edinburgh's west end and our central location makes travelling green easy. We're just a 15-minute walk from both Haymarket and Waverley Station. And if you're coming from Edinburgh Airport, we're just 30 minutes away via tram or the Airlink bus.



 145 Princes St, Edinburgh EH2 4BL

-  PLACE OF INTEREST
-  DISTRICT
-  TRANSPORT LINK

Haymarket Station:	0.5 MILES	Princes Street Gardens:	0.1 MILES	Festival Square:	0.2 MILES
Edinburgh Castle:	0.6 MILES	City Chambers:	0.8 MILES	Shandwick Place Tram Stop:	0.1 MILES
Grassmarket:	0.6 MILES	Waverley Station:	0.8 MILES	Princes Street Tram Stop:	0.4 MILES
National Museum of Scotland:	0.9 MILES	Scott Monument:	0.6 MILES	St Andrews' Square Tram Stop:	0.8 MILES
Ross Fountain:	0.2 MILES	Edinburgh Bus Station:	0.9 MILES		

GET IN TOUCH

TO FIND OUT HOW WE CAN HELP BRING YOUR
EVENT TO LIFE, FROM CONCEPT TO REALITY,
CONTACT THE EVENTS TEAM AT:

 www.johnniewalkerexperience.com

 [@johnnie-walker-experience](https://www.linkedin.com/company/johnnie-walker-experience)

 [@johnniewalkerexperience](https://www.instagram.com/johnniewalkerexperience)

 www.facebook.com/JohnnieWalkerExperience

 JWPSeventsenquiries@diageo.com



