



 **1957 Thunderbird Restomod**

- *Mid 90's 302 With Mild Cam, Holly Sniper Fuel Injection
- *Tremec 5 Speed Transmission, Aluminum Radiator
- *Rack & Pinion Power Steering, 9" inch Ford Rear end
- *Flaming River Tilt Steering Col. , Dakota Digital Gauges
- *Kwik Wire Fuse Box, Classic Auto A/C, Airbagt Air Ride
- *Power Disc Brakes All Four Corners, 2 Spd. Wipers
- *4 Link Rear W/Panhard Bars, New Fuel/Brake Lines
- *New Gas Tank & Electric Fuel Pump, In Trunk Battery
- *FlowMaster Mufflers, Headers W/ 2 1/2" Exhaust Pipes
- *Body Off Build, Everything New, Powder Coated Frame



WARNING:
To avoid danger of suffocation, keep this
plastic bag away from face.

Holley
SNIPER EFI 2
Holley # 550-510-3XX
QUICKSTART MANUAL
SNIPER 2 EFI INSTALLATION INSTRUCTIONS

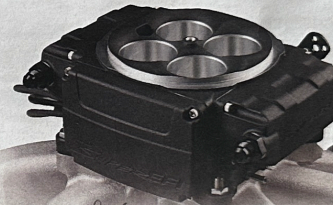

*Fuel pressure regulator - turn stem in to raise pressure
 (original regulator would only go to 60 PSI)*

Congratulations on your purchase of a new Sniper 2 EFI Throttle Body System built by craftsmen to exact standards in our Bowling Green, Kentucky facility. Every Sniper 2 EFI System is extensively tested for functionality before it leaves our facility for "bolt on and go" performance. Each throttle body is serialized ensuring a higher standard of quality control.

Should you experience any problems or need parts assistance that this QuickStart manual or the complete installation manual does not address, contact our technical service department at 1-866-464-6553 or log on to the website for a database of technical information and online support.

For complete technical resources regarding Sniper 2 EFI Ecosystem, please visit:

<https://www.holley.com/sniper2tech> *(page not found)*

*1-866-464-6553
 Quickest response times 8-11 CST Tues-Friday*



Scan with Smart Phone

Never start engine while battery charger is being used!

AMERICAN TOM COVERS
 place amazon.com

Price	Qty	Ext. Price
	1	\$129.95
Total:		\$129.95
Tax:		\$3.54
Shipping:		\$0.00
Total:		\$133.49

DAKOTA DISTRIAL
 AIR FLOW

ELECTRIC

STEP 1b
 57T 61RD
 WIRING

custo
 at
 MANU

ELECT

- ◆ ELECTRON TUNING
- ◆ HIGH POWER
- ◆ AUXILIARY
- ◆ LEFT/RIGHT BANK
- ◆ AUTO-ANTENNA

SNIPER 2

1/29/2021

Airbagit.com
DR courses
product instructions

Compressor Installation Instructions - AirBagIt.com

Airbagit
Air Industries
2,605 S. Hibbert, Mesa
480-668-5448

Auto Culture (602) 253-9365
shop in Phoenix that does
this type of work

AIR ENGINE INSTRUCTIONS

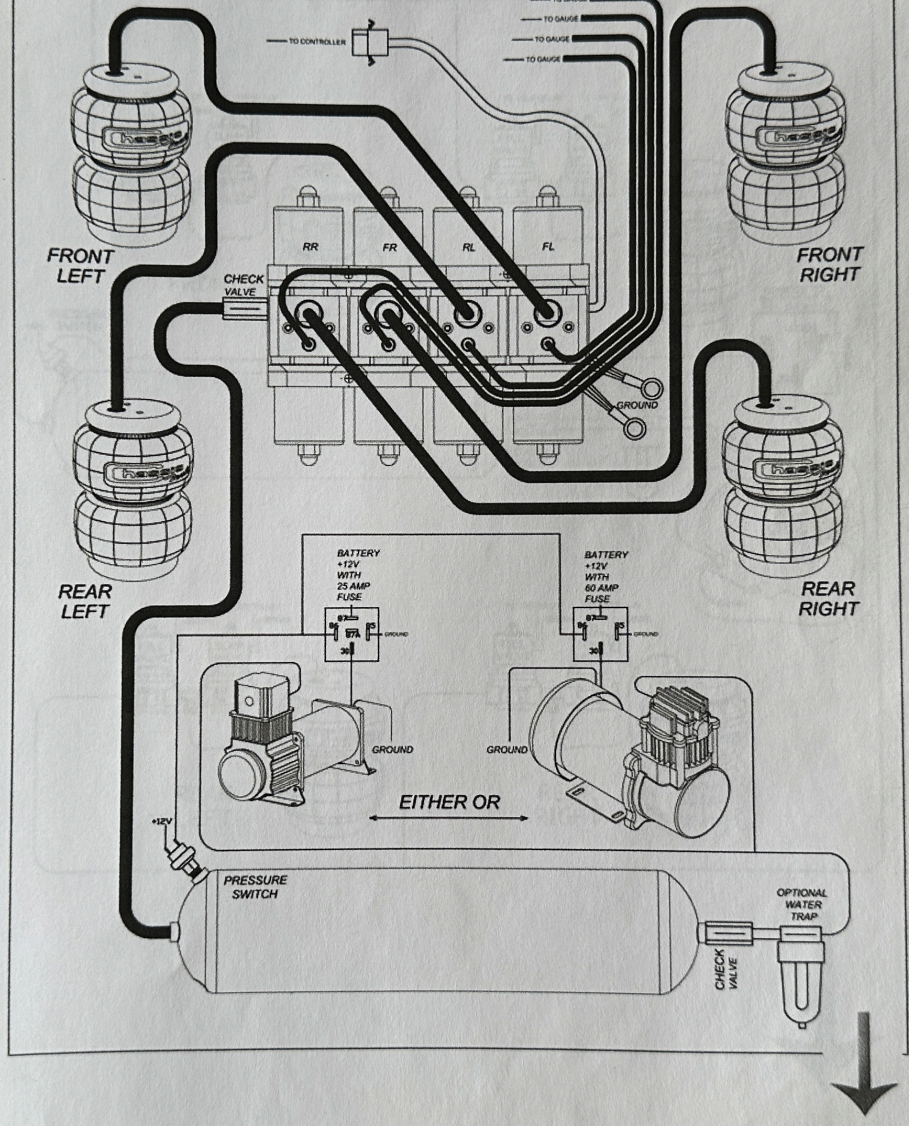

NORTH AMERICAN
CUSTOM COVERS

703400

pg@marketplace.amazon.com

Price	Qty	Ext. Price
9.95	1	\$129.95

ib Total: \$129.95
 Tax: \$9.54
 Shipping: \$0.00
 Total: \$139.49

DAKOTA DIGITAL

AIR COND.

perform
the
e.

ELECTRIC

STEP 1b

STAIR
WIRING

2/16/2021

graphic_A_switch_wiring.gif (1000x907)

Dakota Digital

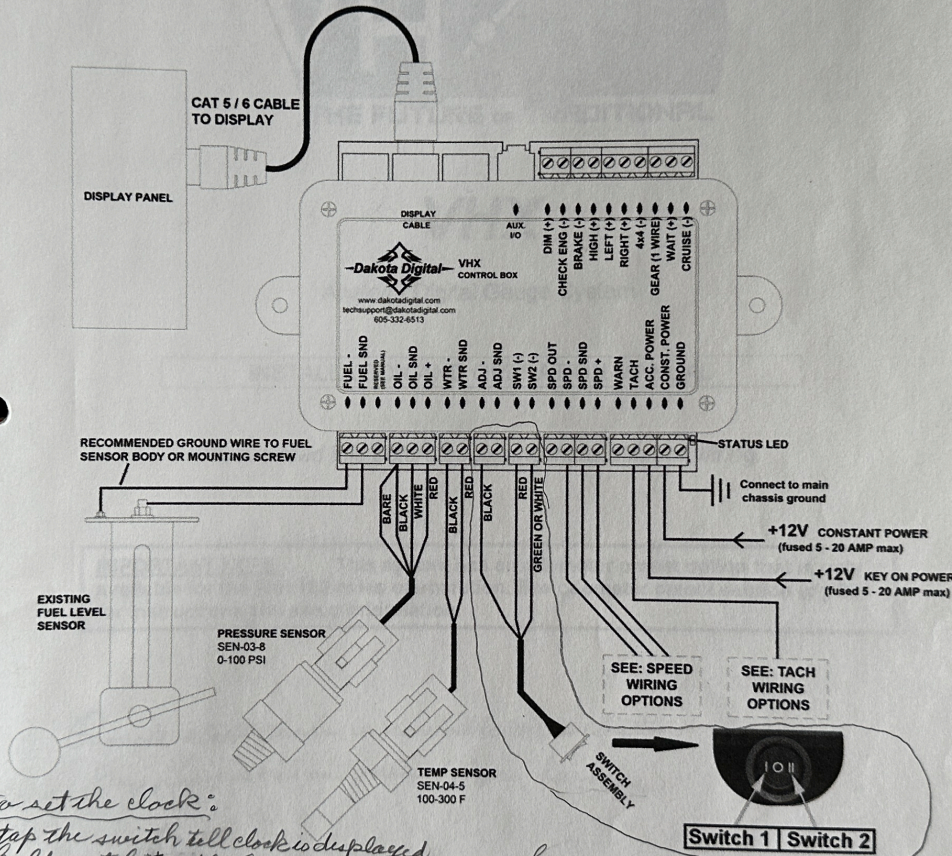

To set the clock:

- ① Tap the switch till clock is displayed
- ② Hold switch #2 till hours begin to flash
- ③ Tap to change hours
- ④ Hold to save the hours & advance to minutes
- ⑤ Repeat this process with a 2-second hold to save your selection

Switches are used to enter setup, perform calibration and access normal use functionality

NORTH AMERICAN CUSTOM COVERS

703400

ps@marketplace.amazon.com

Price	Qty	Ext. Price
9.95	1	\$129.95

Job Total: \$129.95
 Tax: \$9.54
 Shipping: \$0.00
 Total: \$139.49

AIR COND.

perform the ELECTRICAL

STEP 1b

577 GIARD WIRING



CHRYSLER



Car and Truck

Installation Instructions



Mon-Thurs 7AM-4PM CTS, (888)994-9913

NORTH AMERICAN
CUSTOM COVERS

3703400

pg@marketplace.amazon.com

Price	Qty	Ext. Price
9.95	1	\$129.95
Sub Total:		\$129.95
Tax:		\$9.54
Shipping:		\$0.00
Total:		\$139.49

AIR COND.

perform
the
e.

ELECTRIC

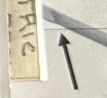

STEP 1b



Congratulations...

Installation Manual

1955-57 FORD THUNDERBIRD

DOCUMENT #1-1074
©2021 ClassicAutoAir / 012.21

Support 1-877-342-5526

SP20 Page 100

*P.29 water Valve diagram
 P.29 front of page see note
 on hand turning of compressor
 oil for system SP20 (Page 100)
 R134A - 24 oz
 Tech support 588-791-6384
 877-342-5526*

 **CONNECT * SERVE * EMPOWER**
woundedwarriorproject.org

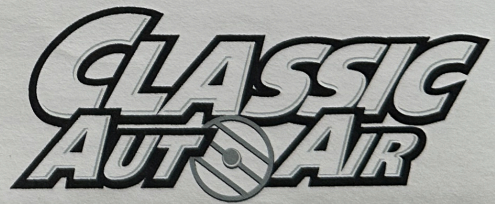

STEP 1b

perform
he
e.
ELECTRIC
PARKING BRAKE

Price / Qty	Est. Price
2395 1	\$129.95
	Tax: \$9.64
	Shipping: \$0.00
	Total: \$139.49

99@markkplace.amazon.com

NORTH AMERICAN
CUSTOM COVERS

2703400

MISC. THUNDERBIRD INFO

User Guide & Installation Manual Power Remote Mount Emergency Brake Kit ASCPB01

WIRING DIAGRAM

5 PIN (use this diagram if your kit came with a 5 pin switch)

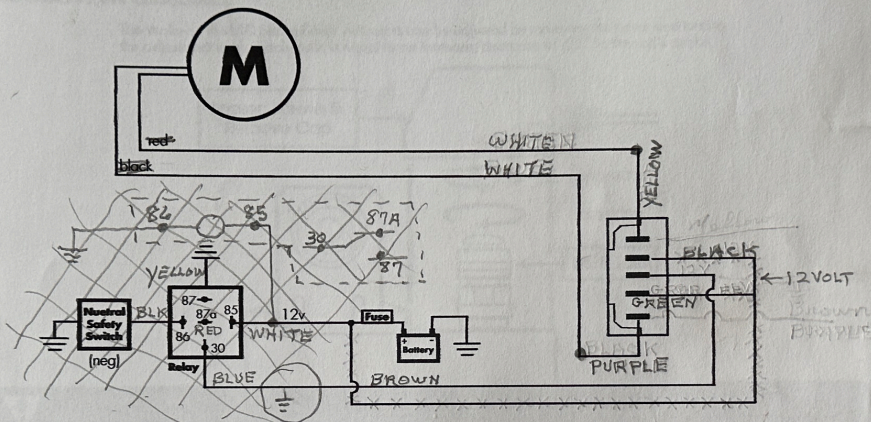

6 PIN (use this diagram if your kit came with a 6 pin switch)

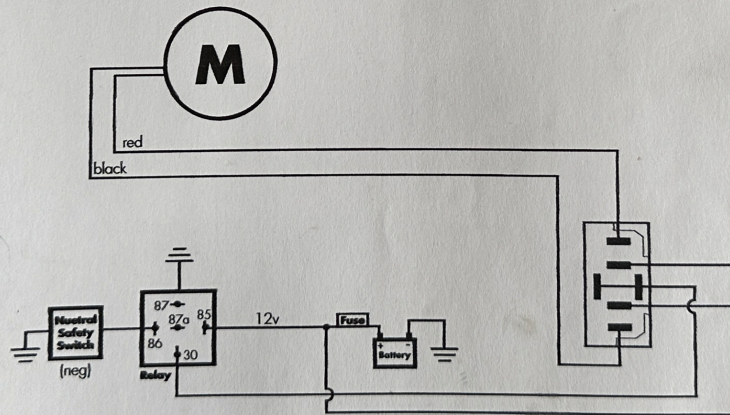

FLAMING RIVER & NORTH AMERICAN CUSTOM COVERS

2703400

pp@marketplace.amazon.com

Price	Qty	Ext. Price
129.95	1	\$129.95

Sub Total:	\$129.95
Tax:	\$9.54
Shipping:	\$0.00
Total:	\$139.49

MISS. TIBIRD IN/RO.

perform
semble the
patience.

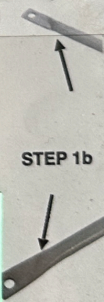

Please Read! This form must be used for all Warranty & Service Repairs



800 Poertner Dr. Berea, Ohio 44017 • 1-800-648-8022 • 440-826-4488 • Fax 440-826-0780
www.flamingriver.com

Date: 11/20/2024

Model Number: 100585	Builder: LF
Description: ASM RS PWR RETEST	Inspector: LF

Serial Number: 118100

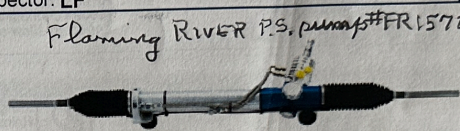

Rack Report:

Test Performed:	Test Method:	Pass/Fail:	Specifications:
Travel	FKL RPA-1100	5.832	Rack travel distance
Road Resistance Pressure	FKL RPA-1100	Pass	FLAMING RIVER FR1632
Torque with Resistance	FKL RPA-1100	Pass	
Flow	FKL RPA-1100	Pass	
Leak	Visual	Pass	
Final Assembly Verification	Visual	Pass	

FLAMING RIVER FR1632

KIT, FITTING PRESS/RETURN RACK

--- WARRANTY DISCLAIMER ---
Customer is responsible to determine the suitability and proper usage of this product. Contact the vehicle's manufacturer or owner's manual for instructions regarding installation of this product. RACING VOIDS ANY AND ALL WARRANTIES

*smaller set screw just snug up
take pressure line off of pump to rack to*

Owner registration information:

Name: _____ (Please complete in permanent records)

Address: _____

Vehicle Make/Model: _____ Date of Purchase: _____

Date of Installation: _____ Place Purchased: _____

Installed by: _____ Purchased by: _____

Flaming River
O rings
GI

Flaming River - Scott
800-648-8022
is the rack Owner/Pactor
racks Pinion or T4 to 78
Mustang II
1-800-841-8123
Head to power steering
pressure control valve
PS-102 or #224
Flaming River Power Steering
Pump Mustang II #FRPMSB-S
w/ser pinion pulley
The greatest casualty is being forgotten.
woundedwarriorproject.org
ol Yorgia 249 63

Warranty Service Information:

Warranty is for one(1) year from original date of purchase on manufacturer's defect implied. Proof of purchase required. Warranty void if not used with Flaming River and warranty information.

All non-warranty services or repairs will be accompanied by a \$50.00 charge plus

Items not covered by warranty: A) Oil Contamination B) Reversed or incorrectly installed C) disassembly of product.

NORTH AMERICAN CUSTOM COVERS

1-877-2703400

marketplace.amazon.com

Price	Qty	Ext. Price
129.95	1	\$129.95
Sub Total:		\$129.95
Tax:		\$9.54
Shipping:		\$0.00
Total:		\$139.49

MISC. BIRD I/M/O.

perform
assemble the
patience.

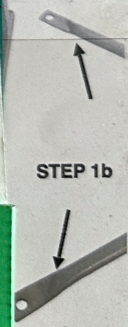

Tire size = P205 x 75 x 14 (2 3/4" wide whitewall)

1995 was last year of 302 W.I.N. engine, 1996 was start of 4.6 litre engine?



**Classic Thunderbird Club International
Dataplate Decoder - 1955 Dataplate**

ASSEMBLY PLANT (Dearborn) BODY STYLE (Thunderbird)
MODEL YEAR (1956) CONSECUTIVE UNIT NO. (All Ford cars assembled)
ENGINE CODE (312 c.i.)¹

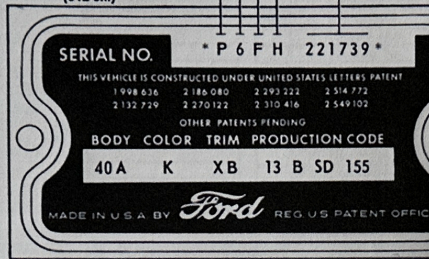

40A K XB 13 B SD 155

BODY TYPE² SCHEDULE
BODY COLOR³ (Fiesta Red) DEALER CO
TRIM COLOR (Red & White) MONTH (Feb)
DAY OF THE MONTH

¹ Either 215 HP w/3-speed transmission/overdrive or 225 HP w/Fordomatic.
² All '55 & '56 models were coded 40A, whereas all '57 models were coded 40.
³ Body color and hard top. If a second letter shows, it indicates a different color for the hardtop.

⁴ 155th automobile (not only Thunderbirds) scheduled to be assembled on February 13, 1956.

⁵ SD signifies a Boston, Mass. dealer ordered this particular car.

Patent data plates are located on the firewall of the engine compartment near the heater duct. There were two basic styles used between 1955 and 1957 models. The large data plates were used on all 1955-56 Thunderbirds and 1957 models until mid-April. The small data plate was phased in during the week of April 15 to April 19, 1957. The smaller data plates were then used on 1957 models until the end of production of the 1957 Thunderbirds Dec. 13, 1957. The small data plates starting in April 1957 did not show the destination code or scheduled item number. On the smaller data plates the transmission type and rear axle ratio were shown following the date code.

NORTH AMERICAN CUSTOM COVERS
77-2703400
v0cpg@marketplace.amazon.com

Price	Qty	Ext. Price
129.95	1	\$129.95
Sub Total:		\$129.95
Tax:		\$9.54
Shipping:		\$0.00
Total:		\$139.49

*T Bird oil filter
Wix 51515, XG16, Motocraft
FLIR, Fram PH8R, PH16
Fram PH16 is 3/4-16 threads
Spin on oil filter threads
Chevy = 13"
Ford, early Chrysler, imports
GM LS, late Ford (22MXX)*

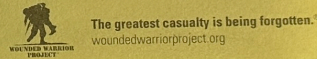

perform
assemble the
patience.

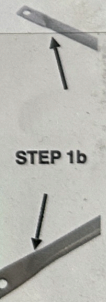

THE GOODGUYS SHOW OFFER!

10% OFF!

STREETSIDECCLASSICS.COM

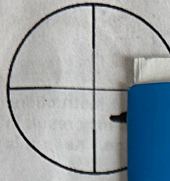

Holley



Owner's Manual

ELECTRONICALLY TUNED AM/FM RECEIVER,
WITH AUXILIARY INPUT
CUSTOM MADE FOR
"THE GREAT CLASSIC VEHICLES!"



- ◆ ELECTRONIC VOLUME AND TUNING CONTROLS
- ◆ HIGH POWER 50 WATTS x 4
- ◆ AUXILIARY INPUT
- ◆ LEFT/RIGHT BALANCE CONTROL
- ◆ AUTO- ANTENNA DRIVE LEAD
- ◆ 4 Channel RCA PRE-AMP INPUTS
- ◆ 4AM 12FM STATION MEMORY
- ◆ SWITCHABLE USA/EURO FREQUENCY SELECTOR
- ◆ FRONT/FEAR FADER

CONCOURS SERIES USA-230

THE AMERICAN CUSTOM COVERS
place.amazon.com

Price	Qty	Ext. Price
\$129.95	1	\$129.95
Sub Total:		\$129.95
Tax:		\$9.54
Shipping:		\$0.00
Total:		\$139.49

Ford 5.0 EFI, 351W, 351, 400
 battery terminal - Ray on
 tech terminal - coil yellow
 work

4	8
3	7
2	6
1	5

front of engine

CYLINDER FIRING ORDER
 1,3,1,2,6,5,4,8
 CONNECT & SERVE & EMPOWER
 woundedwarriorproject.org

Distributor
 Pentronix
 Coil
 SuperStar

Tech support 1-200-444-4444
 • Sniper Stealth 4500 (550-841 Shiny, 550-842 Black, & 550-843 Gold)

Holley.com for Sniper videos
Holley Sniper EFI FUEL INJECTION INSTALLATION MANUAL

Never start the engine while a battery charger is being used